

APPLICATION FOR COMMINGLING OF PRODUCTION (K.A.R. 82-3-123) OR FLUIDS (K.A.R. 82-3-123a) *Commingling ID # _____*

OPERATOR: License # _____ API No. 15 - _____
Name: _____ Spot Description: _____
Address 1: _____ - - - - - Sec. _____ Twp. _____ S. R. _____ East West
Address 2: _____ Feet from North / South Line of Section
City: _____ State: _____ Zip: _____ + _____ Feet from East / West Line of Section
Contact Person: _____ County: _____
Phone: (_____) _____ Lease Name: _____ Well #: _____

1. Name and upper and lower limit of each production interval to be commingled:
Formation: _____ (Perfs): _____
Formation: _____ (Perfs): _____
Formation: _____ (Perfs): _____
Formation: _____ (Perfs): _____
Formation: _____ (Perfs): _____

2. Estimated amount of fluid production to be commingled from each interval:
Formation: _____ BOPD: _____ MCFPD: _____ BWPD: _____
Formation: _____ BOPD: _____ MCFPD: _____ BWPD: _____
Formation: _____ BOPD: _____ MCFPD: _____ BWPD: _____
Formation: _____ BOPD: _____ MCFPD: _____ BWPD: _____
Formation: _____ BOPD: _____ MCFPD: _____ BWPD: _____

3. Plat map showing the location of the subject well, all other wells on the subject lease, and all wells on offsetting leases within a 1/2 mile radius of the subject well, and for each well the names and addresses of the lessee of record or operator.

4. Signed certificate showing service of the application and affidavit of publication as required in K.A.R. 82-3-135a.

For Commingling of PRODUCTION ONLY, include the following:

- 5. Wireline log of subject well. Previously Filed with ACO-1: Yes No
- 6. Complete Form ACO-1 (*Well Completion form*) for the subject well.

For Commingling of FLUIDS ONLY, include the following:

- 7. Well construction diagram of subject well.
- 8. Any available water chemistry data demonstrating the compatibility of the fluids to be commingled.

AFFIDAVIT: I am the affiant and hereby certify that to the best of my current information, knowledge and personal belief, this request for commingling is true and proper and I have no information or knowledge, which is inconsistent with the information supplied in this application.

Submitted Electronically

KCC Office Use Only
 Denied Approved
15-Day Periods Ends: _____
Approved By: _____ Date: _____

Protests may be filed by any party having a valid interest in the application. Protests must be in writing and comply with K.A.R. 82-3-135b and must be filed within 15 days of publication of the notice of application.

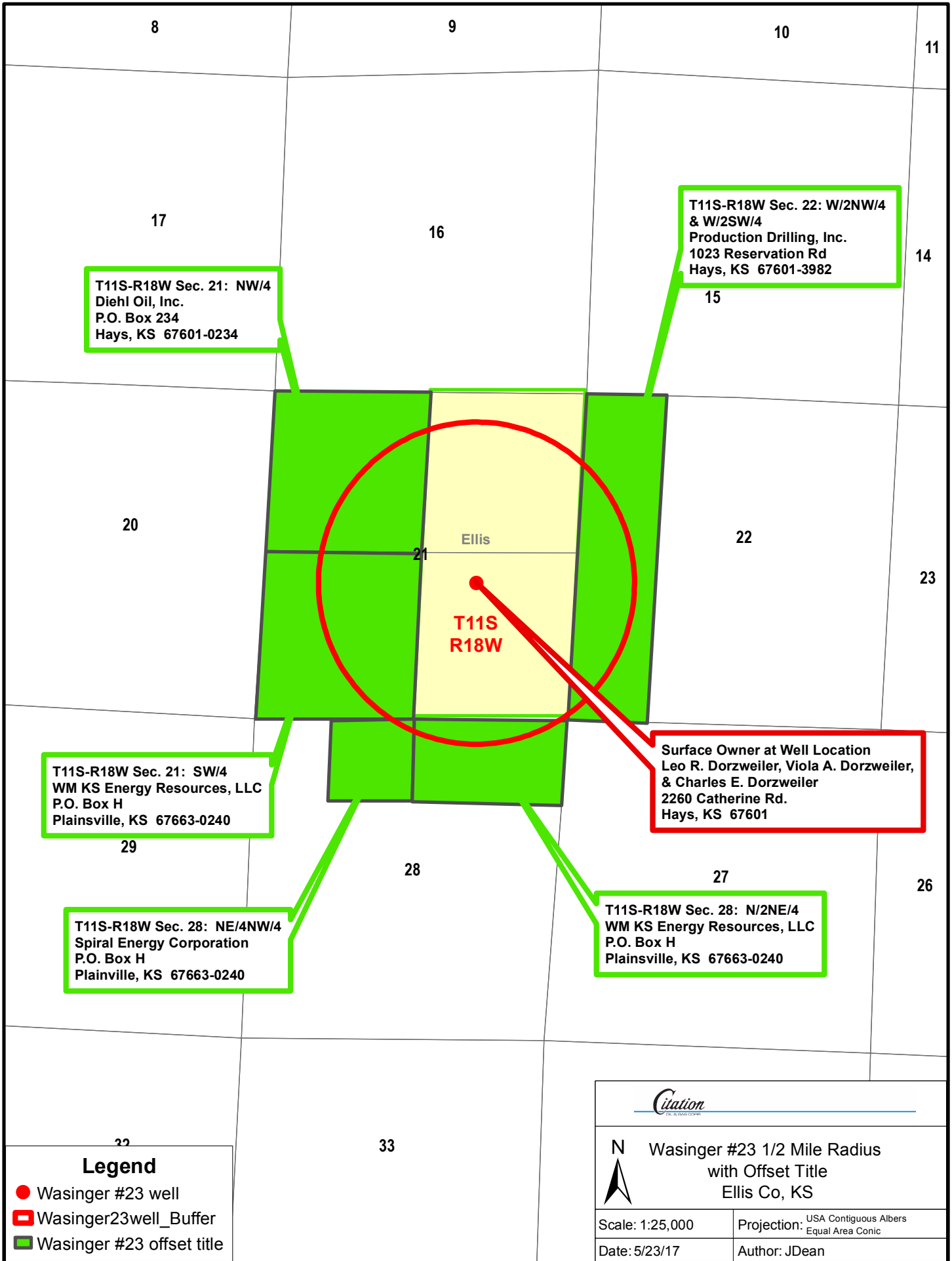

T11S-R18W Sec. 21: NW/4
Diehl Oil, Inc.
P.O. Box 234
Hays, KS 67601-0234

T11S-R18W Sec. 22: W/2NW/4
& W/2SW/4
Production Drilling, Inc.
1023 Reservation Rd
Hays, KS 67601-3982

T11S-R18W Sec. 21: SW/4
WM KS Energy Resources, LLC
P.O. Box H
Plainsville, KS 67663-0240

Surface Owner at Well Location
Leo R. Dorzweiler, Viola A. Dorzweiler,
& Charles E. Dorzweiler
2260 Catherine Rd.
Hays, KS 67601

T11S-R18W Sec. 28: NE/4NW/4
Spiral Energy Corporation
P.O. Box H
Plainville, KS 67663-0240

T11S-R18W Sec. 28: N/2NE/4
WM KS Energy Resources, LLC
P.O. Box H
Plainsville, KS 67663-0240

Legend

- Wasinger #23 well
- ▭ Wasinger23well_Buffer
- Wasinger #23 offset title

Citation

N Wasinger #23 1/2 Mile Radius
with Offset Title
Ellis Co, KS

Scale: 1:25,000	Projection: USA Contiguous Albers Equal Area Conic
Date: 5/23/17	Author: JDean

WELLBORE SCHEMATIC

PROPOSED

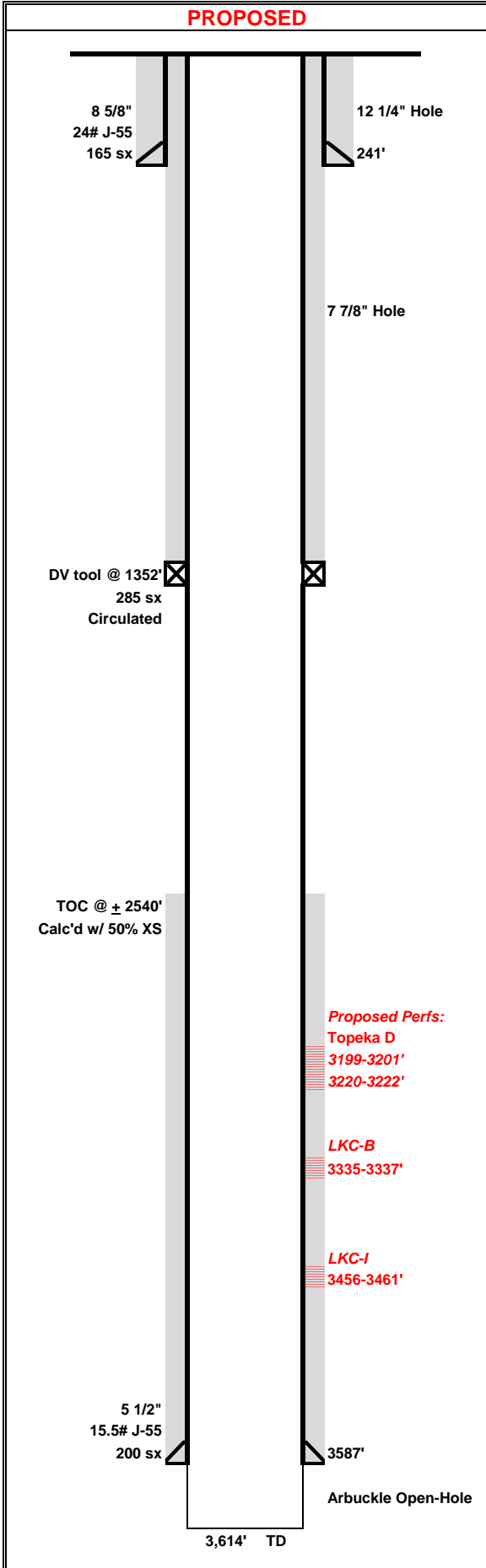

Lease:	Wasinger		Well No.	23	
API No.	15-051-257640000		Status	New Drill	
Location:	2252' FSL & 1660' FEL, NE NW SE Sec. 21, T11S, R18W				
County:	Ellis	State:	KS	Field:	Bemis-Shutts
TD EST.	3614'	GL	2078'	Spud Date:	4/19/2008
PBTD EST.	3614'	KB	2084'	Comp Date:	8/7/2008
Current Perfs/OH:	3199' - 3614'		Current Zone:	Topeka D, LKC, Arbuckle	

Surface Equipment

Unit Make:			Unit Size:		
Unit S/N:			Unit Rotation:		
SPM:			Stroke Length:		
Prime Mover:			Unit Sheave:		
Motor S/N:			Motor RPM:		

Casing Breakdown

	Size	Grade / Wt	Depth	Cement
Surface	8 5/8"	24# J-55	241'	165 sx
Production	5 1/2"	15.5# J-55	3587'	200 sx
Production			DV tool @ 1352'	285 sx
Liner				

Tubing Breakdown

Qty	Description	Footage
TOTAL		0.00'

Rod Breakdown

Qty	Description	Footage
TOTAL		0.00'

Comments

6/17/08 - During OH drill-out, noting fluid loss @ 3609' of ~6-8 BPH. Noted fluid loss increase at 3613.50'. TD @ 3613.5'.

According to Ed Glassman, Wellsite Geologist: Best shows f/ 3602' - 06' & 3610' - 11'.

I.P (8/7/08): 18 BOPD & 1 BWPD. 24.9° API. No CBL was run since it was not required for Arb comp.

Jan'16: 2 BOPD, 16 BWPD TA'd as marginal.

4/26/17: shot static fluid level at 1027' FAP

PREPARED BY: LMCV UPDATED: 4/26/2017

AFFIDAVIT OF PUBLICATION

State of Kansas, Ellis County, ss:

Mary Karst

being first duly sworn, deposes and says:
That he/she is Advertising Manager
of THE HAYS DAILY NEWS, a daily
newspaper printed in the State of Kansas, and
published in and of general circulation in Ellis
County, Kansas, with a general paid circulation
on a yearly basis in Ellis County, Kansas, and
that said newspaper is not a trade, religious or
fraternal publication.

Said newspaper is published daily, except
Saturday, is published at least weekly 50 times a
year, has been so published continuously and
uninterrupted in said county and state for a
period of more than five years prior to the first
publication of said notice; and has been admitted
at the post office of Hays in said county as
second class matter.

That the attached notice is a true copy thereof
and was published in the regular and entire issue
of said newspaper for 1 consecutive day.

the first publication thereof being made as
aforesaid on the 2nd day of June, 2017, with
subsequent publications being made on the
following dates:

20 _____ 20 _____
20 _____ 20 _____
20 _____ 20 _____

Mary Karst

Subscribed and sworn to before me this 2nd
day of June, 2017.

[Signature]
Notary Public

My Appointment expires 5-28-21
Printer's Fee \$62.40
Additional copies \$ _____
Total Fee \$62.40

(Published in The Hays Daily
News Friday, June 2, 2017)
BEFORE THE STATE
CORPORATION
COMMISSION OF THE STATE
OF KANSAS

**NOTICE OF FILING
APPLICATION**

RE: Citation Oil & Gas Corp.
Application for a permit to
authorize the downhole
commingling of the Topoka,
LKC and Arbuckle zones in the
Wasinger 23 well located in Ellis
County, Kansas.

TO: All Oil and Gas Producers,
Unleased Mineral Interest
Owners, Landowners, and all
persons whomsoever concerned.

You, and each of you, are hereby
notified that Citation Oil & Gas
Corp. has filed an application
to commence the downhole
commingling of the Topoka,
LKC and Arbuckle Formations
in the Wasinger 23 well, located
in the NE NW SE of Section 21,
Township 11 South, Range 18
West, Ellis County, Kansas.

Any persons who object to
or protest this application
shall be required to file their
objections or protests with the
Conservation Division of the
State Corporation Commission of
the State of Kansas within fifteen
(15) days from the date of this
publication. These protests shall
be filed pursuant to Commission
regulations and must state
specific reasons why the grant of
the application may cause waste,
violate correlative rights or pollute
the natural resources of the state
of Kansas.

All persons interested or
concerned shall take notice of
the foregoing and shall govern
themselves accordingly.

Citation Oil & Gas Corp.
P.O. Box 690688
Houston, Texas 77269
Phone: 281-891-1000

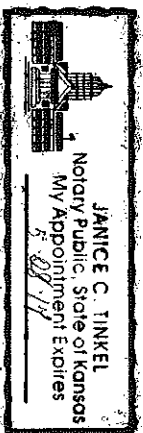

LEGAL PROOF OF PUBLICATION

Account #	Ad Number	Identification	PO	Amount	Cols	Lines
516230	0003092172	BEFORE THE STATE CORPORATION COMMIS		\$304.17	1	51

Attention:

CITATION OIL & GAS CORP.
 PO BOX 690688
 HOUSTON, TX 772690688

In The STATE OF KANSAS
 In and for the County of Sedgwick
 AFFIDAVIT OF PUBLICATION

1 Insertions

Beginning issue of: 05/24/2017

Ending issue of: 05/24/2017

STATE OF KANSAS)
 .SS
 County of Sedgwick)

BEFORE THE STATE CORPORATION COMMISSION OF THE STATE OF KANSAS NOTICE OF FILING APPLICATION

RE: Citation Oil & Gas Corp. -- Application for a permit to authorize the downhole commingling of the Topeka, LKC and Arbuckle zones in the Wasinger 23 well located in Ellis County, Kansas.

TO: All Oil and Gas Producers, Unleased Mineral Interest Owners, Landowners, and all persons whomever concerned.

You, and each of you, are hereby notified that Citation Oil & Gas Corp. has filed an application to commence the downhole commingling of the Topeka, LKC and Arbuckle Formations in the Wasinger 23 well, located in the NE NW SE of Section 21, Township 11 South, Range 18 West, Ellis County, Kansas.

Any persons who object to or protest this application shall be required to file their objections or protests with the Conservation Division of the State Corporation Commission of the State of Kansas within fifteen (15) days from the date of this publication. These protests shall be filed pursuant to Commission regulations and must state specific reasons why the grant of the application may cause waste, violate correlative rights or pollute the natural resources of the state of Kansas.

All persons interested or concerned shall take notice of the foregoing and shall govern themselves accordingly.

Citation Oil & Gas Corp.
 P.O. Box 690688
 Houston, Texas 77269
 Phone: 281-891-1000

Dale Seiwert, of lawful age, being first duly sworn, deposeth and saith: That he is Record Clerk of The Wichita Eagle, a daily newspaper published in the City of Wichita, County of Sedgwick, State of Kansas, and having a general paid circulation on a daily basis in said County, which said newspaper has been continuously and uninterruptedly published in said County for more than one year prior to the first publication of the notice hereinafter mentioned, and which said newspaper has been entered as second class mail matter at the United States Post Office in Wichita, Kansas, and which said newspaper is not a trade, religious or fraternal publication and that a notice of a true copy is hereto attached was published in the regular and entire Morning issue of said The Wichita Eagle from 5/24/2017 to 05/24/2017.

I certify (or declare) under the penalty of perjury that the foregoing is true and correct.



(Signature of Principal Clerk)
 DATED: 5/24/2017



Notary Public Sedgwick County, Kansas

 **JENNIFER RAE BAILEY**
 Notary Public - State of Kansas
 My Appt. Expires 6/14/2017

Conservation Division
266 N. Main St., Ste. 220
Wichita, KS 67202-1513



Phone: 316-337-6200
Fax: 316-337-6211
<http://kcc.ks.gov/>

Pat Apple, Chairman
Shari Feist Albrecht, Commissioner
Jay Scott Emler, Commissioner

Sam Brownback, Governor

June 19, 2017

Sandra Goncalves
Citation Oil & Gas Corp
14077 Cutten Rd
Houston, TX 77269-0688

RE: Approved Commingling CO061701
Wasinger 23
API No. 15-051-25764-00-01

Dear Ms. Goncalves:

Your Application for Commingling (ACO-4) for the above described well has been reviewed and approved by the Kansas Corporation Commission (KCC) per K.A.R. 82-3-123. Notice was examined and found to be proper per K.A.R. 82-3-135a. No protest had been filed within the 15-day protest period.

Based upon the depth of the Arbuckle formation perforations, total oil production shall not exceed 100 BOPD and total gas production shall not exceed 50% of the absolute open flow (AOF).

File form ACO-1 upon completion of the well to commingle.

Sincerely,

Rick Hestermann
Production Department

