

BEREXCO, LLC  
 GUSTUS LEASE  
 SE.1/4, SECTION 9, T11S, R19W  
 ELLIS COUNTY, KANSAS

ROCK ROAD (MENDOTA RD.) DIRT ROAD

**Notes:**

1. Set metal post at location site.
2. All flagging Red & Yellow.
3. Overhead power available at S.1/4 of E. line, Sec.9.
4. Kansas One Call System Inc. should be notified before excavation (1-800-344-7233).
5. CAUTION; Various pipelines in Sec.9.
6. Cattle in pasture at date of staking.
7. Contact landowner for best access.
8. Original location (560'FSL 2200'FEL) fell at the base of a steep hill, moved original location 40' east per instructions and representative.

\*Ingress and egress to location as shown on this plot is per usage only and may not be legally opened for public use. Contact landowner, tenant and county road department for access.

DIRT

(180TH AVE.) ROAD

ROAD

(YOCEMENTO RD.)

ROCK

FLAGGED GATE (CLOSED)

Drillsite Location  
 Gustus #10  
 560'FSL 2160'FEL  
 Ground Elevation = 2045

Y = 284132 X = 1593328

State Plane-NAD 27-Kansas North

Latitude 39.104662

Longitude -99.433495

WGS 84-NAD 83

NO

ROAD

(SALINE RIVER RD.)

SCALE 1" = 1000'

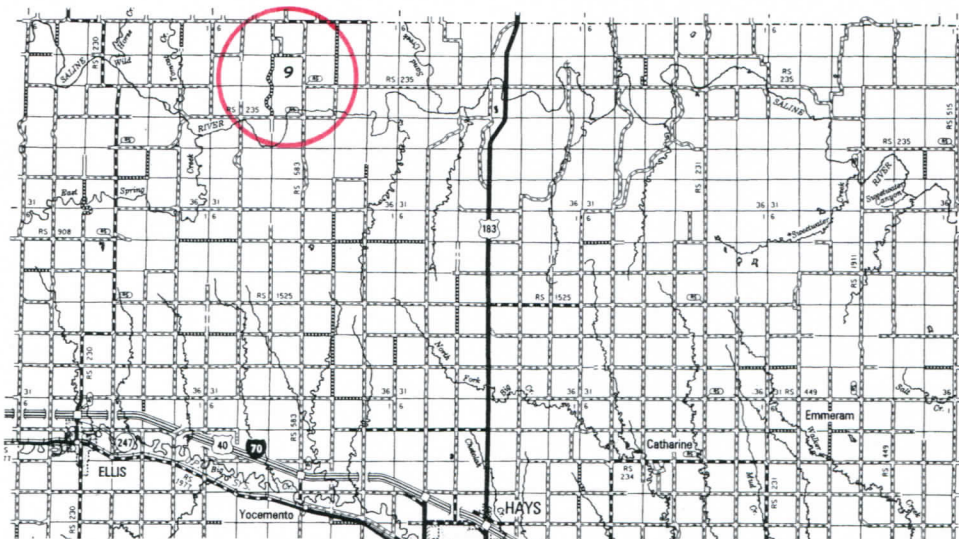

\* Controlling data is based upon the best maps and photographs available to us and upon a regular section of land containing 640 acres.  
 \* Approximate section lines were determined using the normal standard of care of oilfield surveyors practicing in the state of Kansas. The section corners, which establish the precise section lines, were not necessarily located, and the exact location of the drillsite location in the section is not guaranteed. Therefore, the operator securing this service and accepting this plot and all other parties relying thereon agree to hold Central Kansas Oilfield Services, Inc., its officers and employees harmless from all losses, costs and expenses and said entities released from any liability from incidental or consequential damages.  
 \* Elevations derived from National Geodetic Vertical Datum.

Date April 28, 2017