



00-16s-32w-999
CRD NO.

00-16s-32w
DMT NO.

PRO-STAKE

LLC

13419
INVOICE NO.



Construction Site Staking

P.O. Box 2324 Garden City, Kansas 67846
Office/Fax: (620) 276-6159 - Cell: (620) 272-1499
burt@prostakellc.com

Shakespeare Oil Company, Inc.
OPERATOR

Scott County, Kansas
COUNTY

07 16s 32w
Sec. Twp. Rng.

Schwalter #1-7
LEASE NAME

480' FNL - 2220' FWL
LOCATION SPOT

3009.4'
GR ELEVATION

38.683895003
NAD 83 LAT

100.900110891
NAD 83 LONG

SCALE: 1" = 1000'
DATE STAKED: May 23rd, 2017
MEASURED BY: Bryen M.
DRAWN BY: Pierce R.
AUTHORIZED BY: Alex B.
DATE REVISED:



LEGEND

- ⊙ irr. well
- G— gas line
- ▭ gravel/sand rd.
- ⊕ water hydrant
- W— water line
- ▭ gravel trail/lease rd.
- ⊕ tank battery
- E— transmission powerline
- ▭ dirt rd.
- ⊙ staked loc.
- +—+— 3 phase powerline
- ▭ dirt trail/lease rd.
- ⊙ prod. well/aband. well
- · · single phase powerline
- ▭ Hwy/blacktop rd.
- ⊙ house
- x—x— fence

DIRECTIONS: From the center of Scott City, KS at the intersection of Hwy 96/W. 5th St. & Hwy 83/Main St. - Now go 14.8 miles North on Hwy 83/Main St. - Now go 1 mile West on Hwy 95/E. Rd. 290 to the NE corner of section 07-16s-32w - Now go approx. 0.5 mile West to ingress stake SSW into at field entrance - Now go approx. 0.1 mile South-southwest through wheat into staked location

Final ingress must be verified with landowner or operator.

*This drawing does not constitute a monumented survey or a land survey plat.
This drawing is for construction purposes only.*

LANDOWNER: Luke & Millicent Schwalter: 219-374-6556 **TENANT:** Chaston Hoeme: 620-874-2376

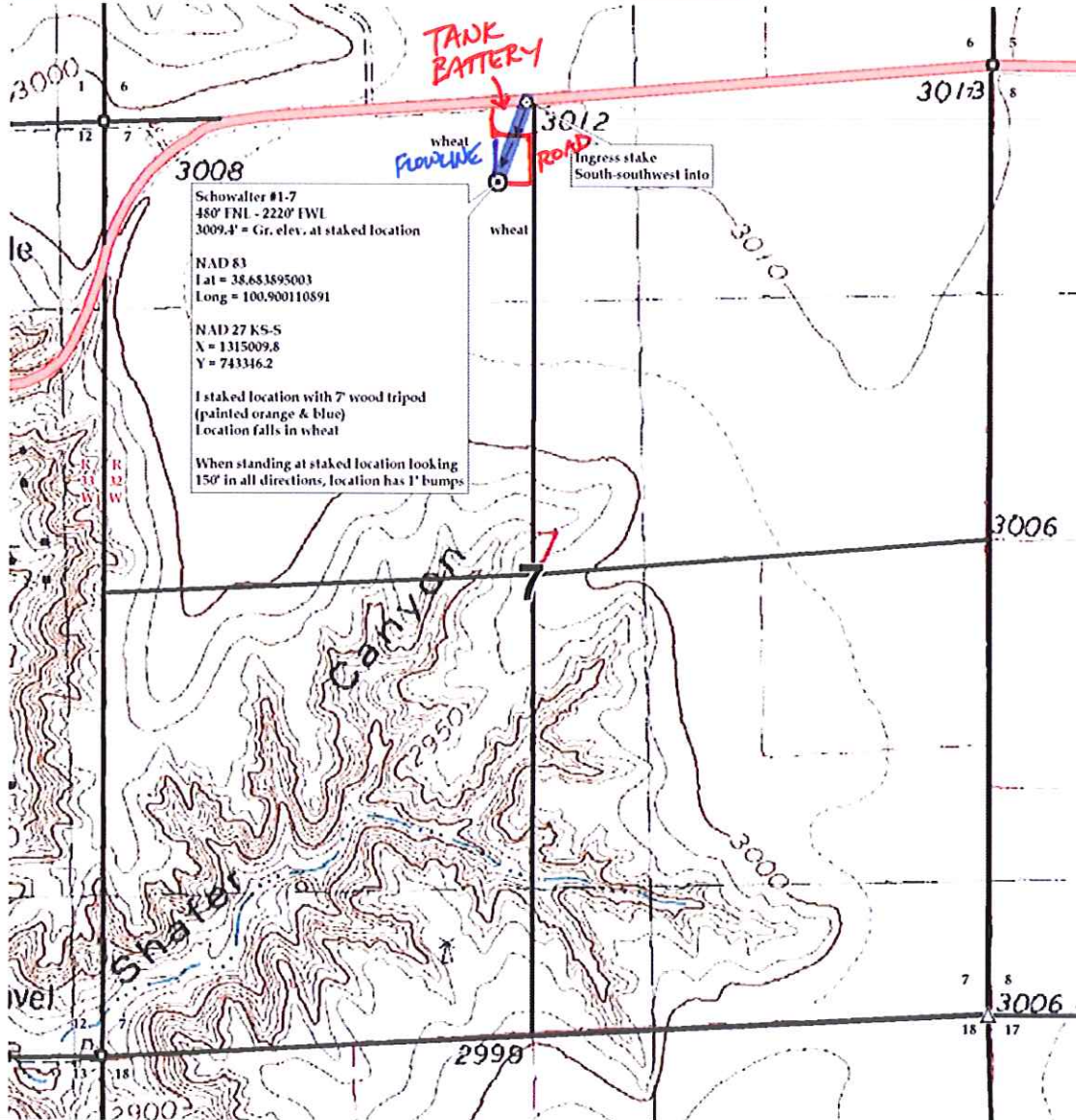

PRELIMINARY NON-BINDING ESTIMATE OF TANKS, FLOWLINE + ROAD