

Fall & Associates
 Stake and Elevation Service
 P.O. Box 222
 Pretty Prairie, KS. 67570
 785-243-7506

Date 11-7-18

Invoice Number 1105181

MURFIN DRILLING	2-12			McClurg
Operator	Number			Farm Name
Cheyenne-KS	12	2s	37w	1860'FSL 1320'FEL
County-State	S	T	R	Location

Murfin Driling
 250 N Market
 Suite 300
 Wichita, KS. 67202

Elevation 3375 Gr.
 Ordered By: Shauna

Scale 1"=1000'

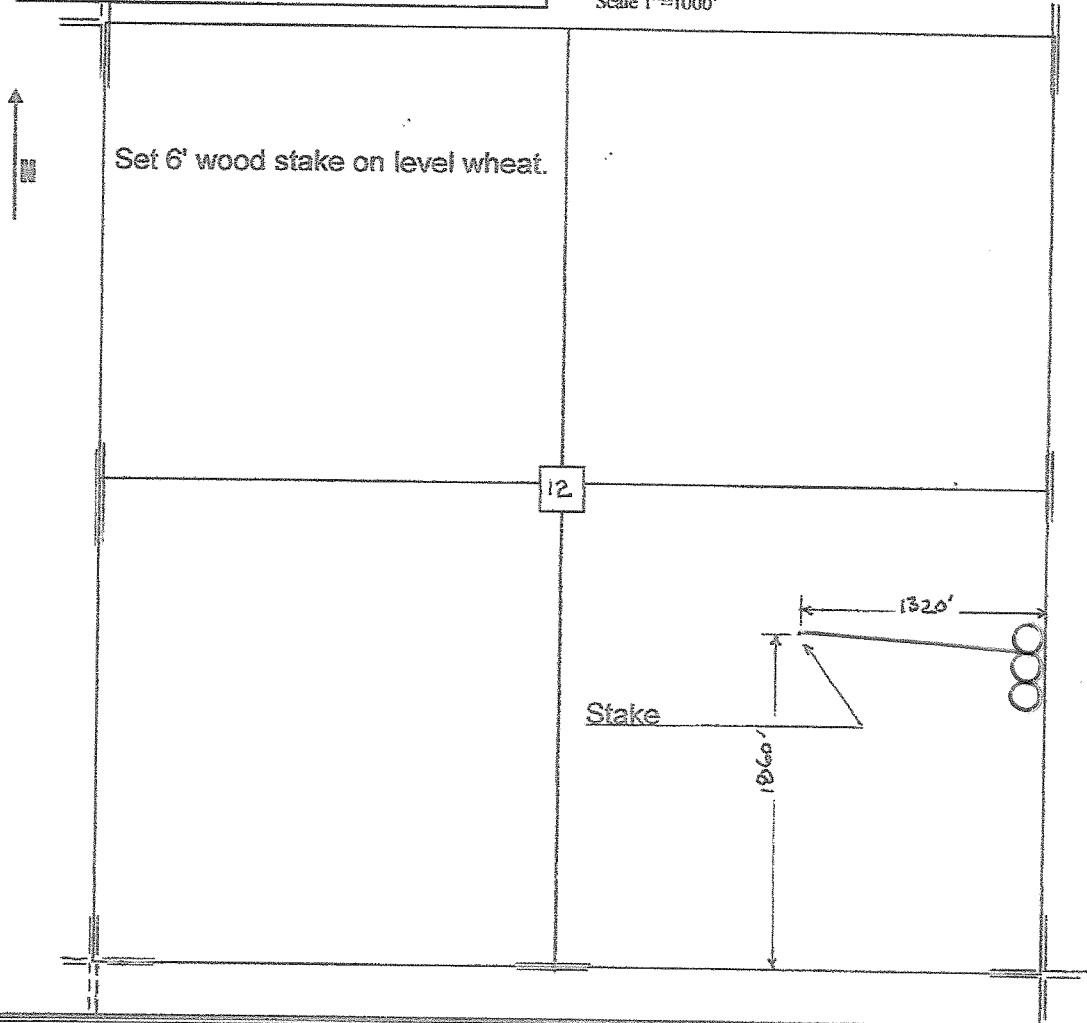

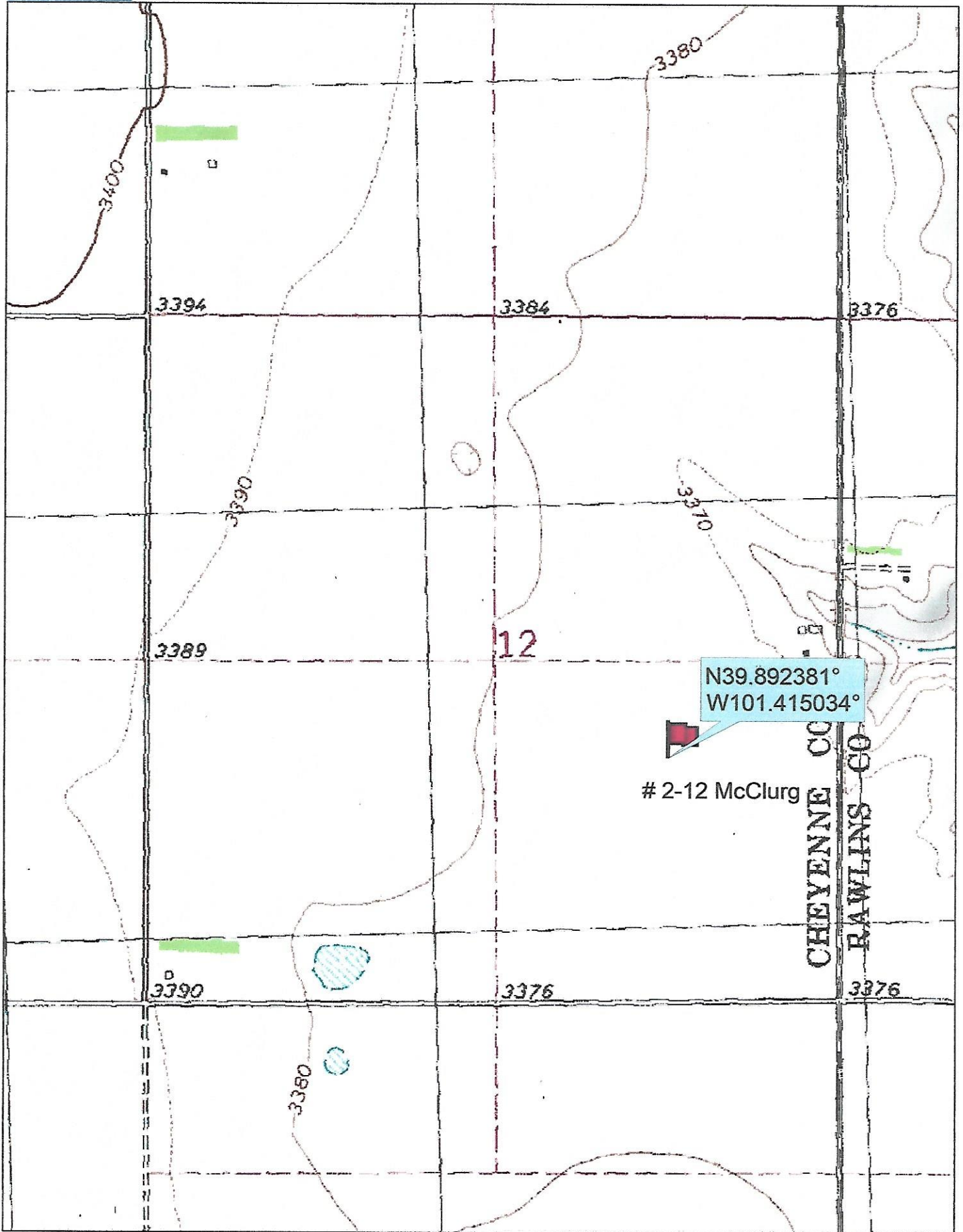

Data use subject to license.

© DeLorme. Topo North America™ 9.

www.delorme.com

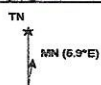

Scale 1 : 12,000

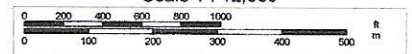

1" = 1,000.0 ft

Data Zoom 13-1