

Proposed Plan of Construction  
River Bend 3  
Sec 26 T24S-R32W  
Finney County, KS

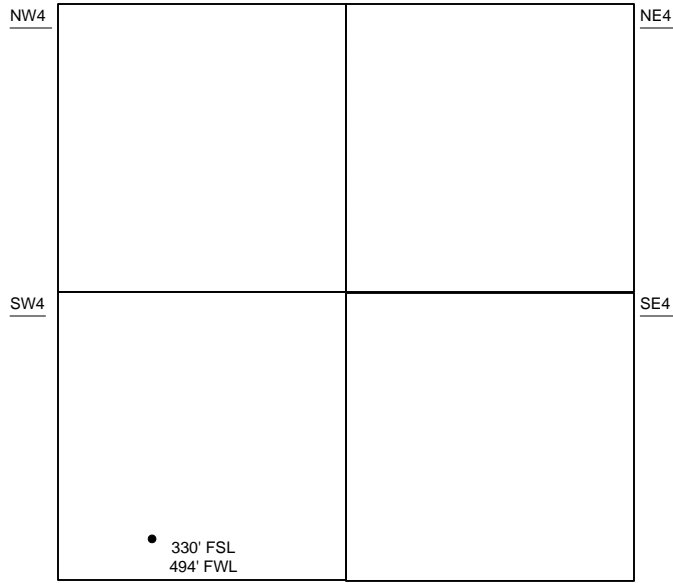

Sec 26 - T24S - R32W

SW/4

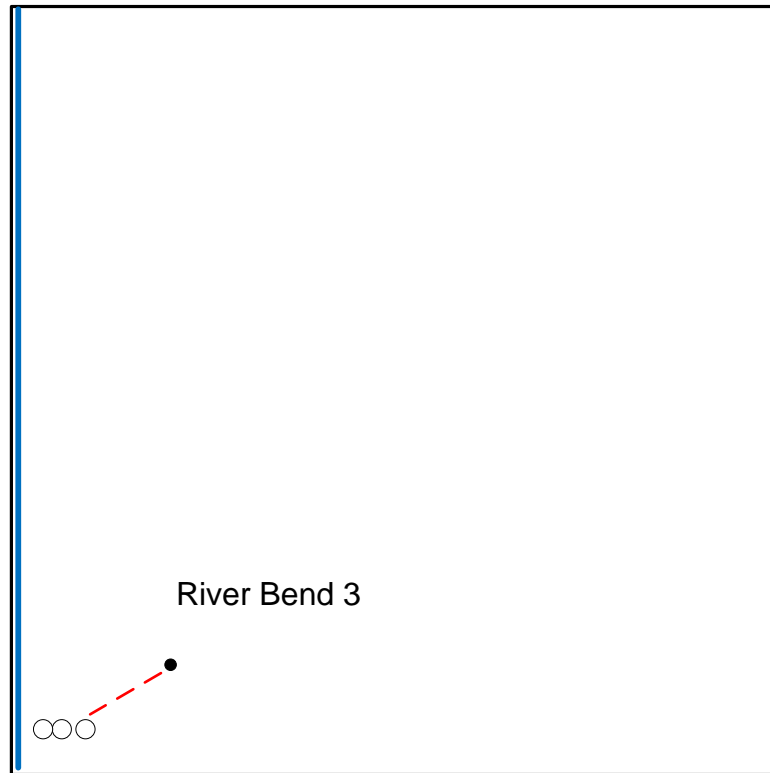

The Tank Battery for the Reeve 1 is located SW of the SW quarter

- Well Location
- Proposed Lease Roads
- - - Proposed Pipeline
- Proposed Tank Battery
- Proposed Power Lines
- - - Existing Pipeline

Proposed Details of  
SW/4 Sec 26 - T24S - R32W

Note-Drawing **Not** to Scale