

VINCENT OIL CORPORATION
 KEOUGH LEASE
 SW.1/4, SECTION 34, T28S, R23W
 FORD COUNTY, KANSAS

(WHIRLWIND RD.) NO ROAD

Notes:

1. Set (3) tall wood stakes at location site.
2. All flagging Red & Yellow.
3. Overhead power available at S. line, Sec.34.
4. Kansas One Call System Inc. should be notified before excavation (1-800-344-7233).
5. CAUTION; Various pipelines in Sec.34.
6. Section 34 is irregular.
7. Contact landowner for best access.

TANK BATTERY

ROAD

(121 ROAD)

GRAVEL

KEOUGH #4-34

KEOUGH #5-34
2528

34

Drillsite Location
 Keough #7-34
 2582'FSL 2409'FWL
 Ground Elevation = 2535

Y = 329600 X = 1616350
 State Plane-NAD 27-Kansas South
 Latitude 37.564399434
 Longitude -99.823642421
 NAD 27

GRAVEL (WILBURN RD.) ROAD

ROAD

NO

(122 ROAD)

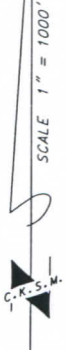

*Ingress and egress to location as shown on this plot is per usage only and may not be legally opened for public use. Contact landowner, tenant and county road department for access.

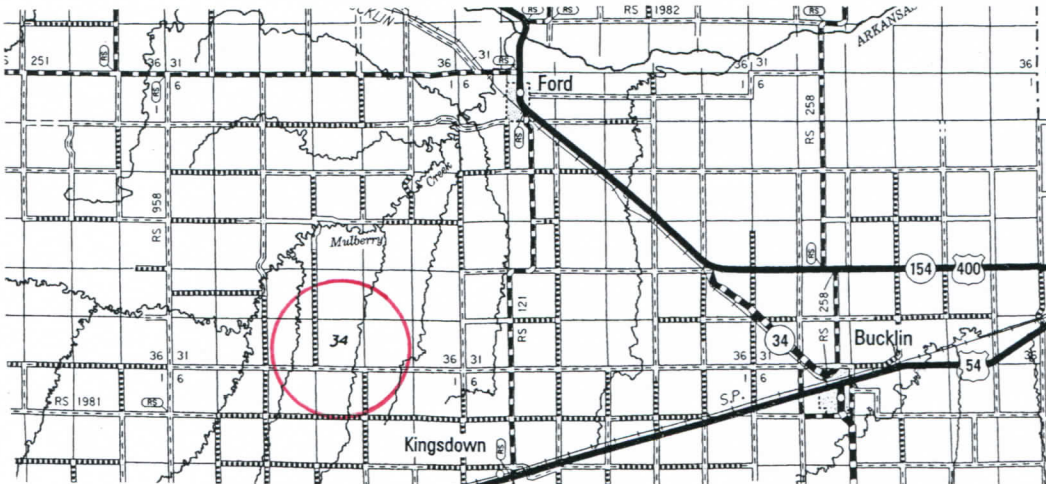

* Controlling data is based upon the best maps and photographs available to us and upon a regular section of land containing 640 acres.
 * Approximate section lines were determined using the normal standard of care of oilfield surveyors practicing in the state of Kansas. The section corners, which establish the precise section lines, were not necessarily located, and the exact location of the drillsite location in the section is not guaranteed. Therefore, the operator securing this service and accepting this plot and all other parties relying thereon agree to hold Central Kansas Oilfield Services, Inc., its officers and employees harmless from all losses, costs and expenses and said entities released from any liability from incidental or consequential damages.
 * Elevations derived from National Geodetic Vertical Datum.

Date August 31, 2017