

**APPLICATION FOR COMMINGLING OF PRODUCTION (K.A.R. 82-3-123) OR FLUIDS (K.A.R. 82-3-123a)** *Commingling ID # \_\_\_\_\_*

OPERATOR: License # \_\_\_\_\_ API No. 15 - \_\_\_\_\_  
Name: \_\_\_\_\_ Spot Description: \_\_\_\_\_  
Address 1: \_\_\_\_\_ - - - - - Sec. \_\_\_\_\_ Twp. \_\_\_\_\_ S. R. \_\_\_\_\_  East  West  
Address 2: \_\_\_\_\_ Feet from  North /  South Line of Section  
City: \_\_\_\_\_ State: \_\_\_\_\_ Zip: \_\_\_\_\_ + \_\_\_\_\_ Feet from  East /  West Line of Section  
Contact Person: \_\_\_\_\_ County: \_\_\_\_\_  
Phone: ( \_\_\_\_\_ ) \_\_\_\_\_ Lease Name: \_\_\_\_\_ Well #: \_\_\_\_\_

1. Name and upper and lower limit of each production interval to be commingled:  
Formation: \_\_\_\_\_ (Perfs): \_\_\_\_\_  
Formation: \_\_\_\_\_ (Perfs): \_\_\_\_\_  
Formation: \_\_\_\_\_ (Perfs): \_\_\_\_\_  
Formation: \_\_\_\_\_ (Perfs): \_\_\_\_\_  
Formation: \_\_\_\_\_ (Perfs): \_\_\_\_\_

2. Estimated amount of fluid production to be commingled from each interval:  
Formation: \_\_\_\_\_ BOPD: \_\_\_\_\_ MCFPD: \_\_\_\_\_ BWPD: \_\_\_\_\_  
Formation: \_\_\_\_\_ BOPD: \_\_\_\_\_ MCFPD: \_\_\_\_\_ BWPD: \_\_\_\_\_  
Formation: \_\_\_\_\_ BOPD: \_\_\_\_\_ MCFPD: \_\_\_\_\_ BWPD: \_\_\_\_\_  
Formation: \_\_\_\_\_ BOPD: \_\_\_\_\_ MCFPD: \_\_\_\_\_ BWPD: \_\_\_\_\_  
Formation: \_\_\_\_\_ BOPD: \_\_\_\_\_ MCFPD: \_\_\_\_\_ BWPD: \_\_\_\_\_

3. Plat map showing the location of the subject well, all other wells on the subject lease, and all wells on offsetting leases within a 1/2 mile radius of the subject well, and for each well the names and addresses of the lessee of record or operator.

4. Signed certificate showing service of the application and affidavit of publication as required in K.A.R. 82-3-135a.

**For Commingling of PRODUCTION ONLY, include the following:**

- 5. Wireline log of subject well. Previously Filed with ACO-1:  Yes  No
- 6. Complete Form ACO-1 (*Well Completion form*) for the subject well.

**For Commingling of FLUIDS ONLY, include the following:**

- 7. Well construction diagram of subject well.
- 8. Any available water chemistry data demonstrating the compatibility of the fluids to be commingled.

**AFFIDAVIT:** I am the affiant and hereby certify that to the best of my current information, knowledge and personal belief, this request for commingling is true and proper and I have no information or knowledge, which is inconsistent with the information supplied in this application.

**Submitted Electronically**

**KCC Office Use Only**  
 Denied  Approved  
15-Day Periods Ends: \_\_\_\_\_  
Approved By: \_\_\_\_\_ Date: \_\_\_\_\_

*Protests may be filed by any party having a valid interest in the application. Protests must be in writing and comply with K.A.R. 82-3-135b and must be filed within 15 days of publication of the notice of application.*

Proof of Publication

State of Kansas,  
County of Lane, ss:

of lawful age, being duly sworn upon oath states that he/she is the editor of THE DIGHTON HERALD.

THAT said newspaper has been published at least weekly 50 times a year and has been so published for at least five years prior to the first publication of the attached notice.

THAT said newspaper was entered as second class matter at the post office of its publication;

THAT said newspaper has a general paid circulation on a daily, weekly, monthly, or yearly basis in LANE County, Kansas and is NOT a trade, religious or fraternal publication and has been printed and published in LANE County, Kansas.

THE ATTACHED was published on the following dates in a regular issue of said newspaper:

1st Publication was made on the 25 day of Oct, 20 17

2nd Publication was made on the \_\_\_ day of \_\_\_, 20 \_\_\_

3rd Publication was made on the \_\_\_ day of \_\_\_, 20 \_\_\_

4th Publication was made on the \_\_\_ day of \_\_\_, 20 \_\_\_

5th Publication was made on the \_\_\_ day of \_\_\_, 20 \_\_\_

6th Publication was made on the \_\_\_ day of \_\_\_, 20 \_\_\_

Publication fee \$ 5940  
Affidavit, Notary's Fees \$ \_\_\_\_\_  
Additional Copies @ \_\_\_\_\_ \$ \_\_\_\_\_  
Total Publication Fee \$ 5940

Dawn Wendel  
(Signed)

Witness my hand this 25 day of Oct, 20 17

SUBSCRIBED and SWORN to before me this 25 day of Oct, 20 17.

Kelley C. Anderson  
(Notary Public)

My commission expires 2-7-2018

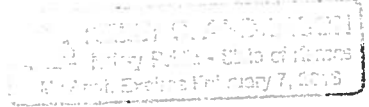

(First published in The DIGHTON HERALD Wednesday, October 25, 2017)

Memorandum of Notification

RE: Flatirons Resources LLC - Application for Commingling of Production in the Long Dixon 42-10 well, located in Lane County, Kansas T16S, R28W Section 10 S2NWSENE

TO: All Oil and Gas Producers, Unleased acreage Mineral Interest Owners, Landowners, and all persons concerned within one-half mile radius of said well.

You, and each of you, are hereby notified that Flatirons Resources LLC has filed to commingle production in the Long Dixon 42-10 oil well. This well is located 1700 Feet from the North Line, 990 Feet from the East line, Section 10, Township 16S, Range 28W, Lane County Kansas

Any persons who object to or protest this application shall be required to file their objections or protest with the Conservation Division of the State Corporation Commission of the State of Kansas within thirty (30) days for the date of this publication. These protests shall be filed pursuant to Commission regulations and must state specific reasons why granting the application may cause a waste, violate correlative rights or pollute the natural resources of the State of Kansas.

All persons interested or concerned shall take notice of the foregoing and shall govern themselves accordingly.

Flatirons Resources LLC  
11080 Circle Point Road  
Suite #180  
Westminster, Colorado  
80020

# Proof of Publication

State of Kansas,  
County of Gray, ss:

\_\_\_\_\_ of lawful age, being duly sworn upon oath states that he/she is the editor of **THE JACKSONIAN**.

THAT said newspaper has been published at least weekly 50 times a year and has been so published for at least five years prior to the first publication of the attached notice.

THAT said newspaper was entered as second class matter at the post office of its publication;

THAT said newspaper has a general paid circulation on a daily, weekly, monthly, or yearly basis in GRAY County, Kansas and is NOT a trade, religious or fraternal publication and has been printed and published in GRAY County, Kansas.

THE ATTACHED was published on the following dates in a regular issue of said newspaper:

- 1st Publication was made on the 25 day of Oct, 20 17
- 2nd Publication was made on the \_\_\_\_\_ day of \_\_\_\_\_, 20 \_\_\_\_\_
- 3rd Publication was made on the \_\_\_\_\_ day of \_\_\_\_\_, 20 \_\_\_\_\_
- 4th Publication was made on the \_\_\_\_\_ day of \_\_\_\_\_, 20 \_\_\_\_\_
- 5th Publication was made on the \_\_\_\_\_ day of \_\_\_\_\_, 20 \_\_\_\_\_
- 6th Publication was made on the \_\_\_\_\_ day of \_\_\_\_\_, 20 \_\_\_\_\_

Publication fee \$ 5850  
 Affidavit, Notary's Fees \$ \_\_\_\_\_  
 Additional Copies \_\_\_\_\_ @ \_\_\_\_\_ \$ \_\_\_\_\_  
 Total Publication Fee \$ 5850

Dawn Wendel  
(Signed)

Witness my hand this 25 day of Oct, 20 17

SUBSCRIBED and SWORN to before me this 25

day of Oct, 20 17.

Kelly C Anderson  
(Notary Public)

My commission expires 2.7.2018

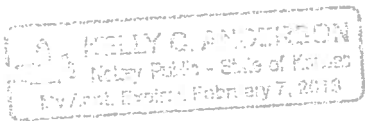

(First published in The DIGHTON HERALD Wednesday, October 25, 2017)

## Memorandum of Notification

RE: Flatirons Resources LLC - Application for Commingling of Production in the Lawrence 22-14 well, located in Lane County, Kansas T16S, R28W Section 14 NESWSE1/4

TO: All Oil and Gas Producers, Unleased acreage Mineral Interest Owners, Landowners, and all persons concerned within one-half mile radius of said well.

You, and each of you, are hereby notified that Flatirons Resources LLC has filed to commingle production in the Lawrence 22-14 oil well. This well is located 2080 Feet from the North Line, 1920 Feet from the West line, Section 14, Township 16S, Range 28W, Lane County Kansas

Any persons who object to or protest this application shall be required to file their objections or protest with the Conservation Division of the State Corporation Commission of the State of Kansas within thirty (30) days for the date of this publication. These protests shall be filed pursuant to Commission regulations and must state specific reasons why granting the application may cause a waste, violate correlative rights or pollute the natural resources of the State of Kansas.

All persons interested or concerned shall take notice of the foregoing and shall govern themselves accordingly.

Flatirons Resources LLC  
11080 Circle Point Road  
Suite #180  
Westminster, Colorado  
80020

e  
e  
ll  
s,  
it  
it  
s  
e  
d  
e  
ir

**DIGHTON HERALD**  
 BOX 426  
 DIGHTON KS 67839  
 (620) 397-5347

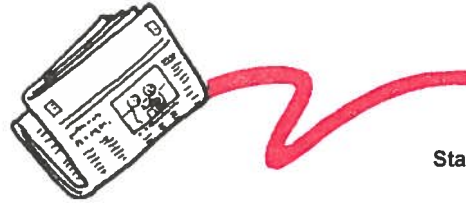

Statement Date 10/31/17

Account Number FLATR7

Page 1

FLATIRON RESOURCES  
 11080 CIRCLE PT RD STE 180  
 WESTMINSTER CO 80020

Amount Due 117.90

DATE	INVOICE NO.	TYPE	DESCRIPTION	CHARGES	CREDITS	BALANCE
10/25/17	051148	Inv	LAWRENCE 22-14 WELL	58.50		58.50
10/25/17	051149	Inv	LONG DIXON 42-10 WELL	59.40		117.90

FINANCE CHARGE 2% PER MONTH ANNUAL RATE  
 24% PER YEAR APPLIED TO PREVIOUS BALANCE

CURRENT	1-30 DAYS	31-60 DAYS	OVER 60 DAYS	FINANCE CHARGE	AMOUNT DUE
					117.90

KANSAS CORPORATION COMMISSION  
OIL & GAS CONSERVATION DIVISION

**CERTIFICATION OF COMPLIANCE WITH THE  
KANSAS SURFACE OWNER NOTIFICATION ACT**

Form KSONA-1  
July 2014  
Form Must Be Typed  
Form must be Signed  
All blanks must be Filled

*This form must be submitted with all Forms C-1 (Notice of Intent to Drill); CB-1 (Cathodic Protection Borehole Intent); T-1 (Request for Change of Operator Transfer of Injection or Surface Pit Permit); and CP-1 (Well Plugging Application). Any such form submitted without an accompanying Form KSONA-1 will be returned.*

Select the corresponding form being filed:  C-1 (Intent)  CB-1 (Cathodic Protection Borehole Intent)  T-1 (Transfer)  CP-1 (Plugging Application)

OPERATOR: License # 34038  
Name: Flatirons Resources LLC  
Address 1: 11080 Circle Point Road #180  
Address 2: \_\_\_\_\_  
City: Westminster State: CO Zip: 80020 + \_\_\_\_\_  
Contact Person: Jeffery Jones  
Phone: ( 720 ) 636-9624 Fax: ( 303 ) 292-2506  
Email Address: jeffj@flatironsllc.com

Well Location:  
\_\_\_\_ - \_\_\_\_ SE NW Sec. 14 Twp. 16 S. R. 28  East  West  
County: Lane  
Lease Name: Lawrence Well #: 22-14

*If filing a Form T-1 for multiple wells on a lease, enter the legal description of the lease below:*

**Surface Owner Information:**

Name: Stacy and Angela Lawrence  
Address 1: 305 N. Elm  
Address 2: \_\_\_\_\_  
City: Shields State: KS Zip: 67839 + \_\_\_\_\_

*When filing a Form T-1 involving multiple surface owners, attach an additional sheet listing all of the information to the left for each surface owner. Surface owner information can be found in the records of the register of deeds for the county, and in the real estate property tax records of the county treasurer.*

*If this form is being submitted with a Form C-1 (Intent) or CB-1 (Cathodic Protection Borehole Intent), you must supply the surface owners and the KCC with a plat showing the predicted locations of lease roads, tank batteries, pipelines, and electrical lines. The locations shown on the plat are preliminary non-binding estimates. The locations may be entered on the Form C-1 plat, Form CB-1 plat, or a separate plat may be submitted.*

**Select one of the following:**

- I certify that, pursuant to the Kansas Surface Owner Notice Act (House Bill 2032), I have provided the following to the surface owner(s) of the land upon which the subject well is or will be located: 1) a copy of the Form C-1, Form CB-1, Form T-1, or Form CP-1 that I am filing in connection with this form; 2) if the form being filed is a Form C-1 or Form CB-1, the plat(s) required by this form; and 3) my operator name, address, phone number, fax, and email address.
- I have not provided this information to the surface owner(s). I acknowledge that, because I have not provided this information, the KCC will be required to send this information to the surface owner(s). To mitigate the additional cost of the KCC performing this task, I acknowledge that I must provide the name and address of the surface owner by filling out the top section of this form and that I am being charged a \$30.00 handling fee, payable to the KCC, which is enclosed with this form.

*If choosing the second option, submit payment of the \$30.00 handling fee with this form. If the fee is not received with this form, the KSONA-1 form and the associated Form C-1, Form CB-1, Form T-1, or Form CP-1 will be returned.*

I hereby certify that the statements made herein are true and correct to the best of my knowledge and belief.

Date: 10/30/2017 Signature of Operator or Agent: [Signature] Title: Managing Director

# Lawrence 22-14

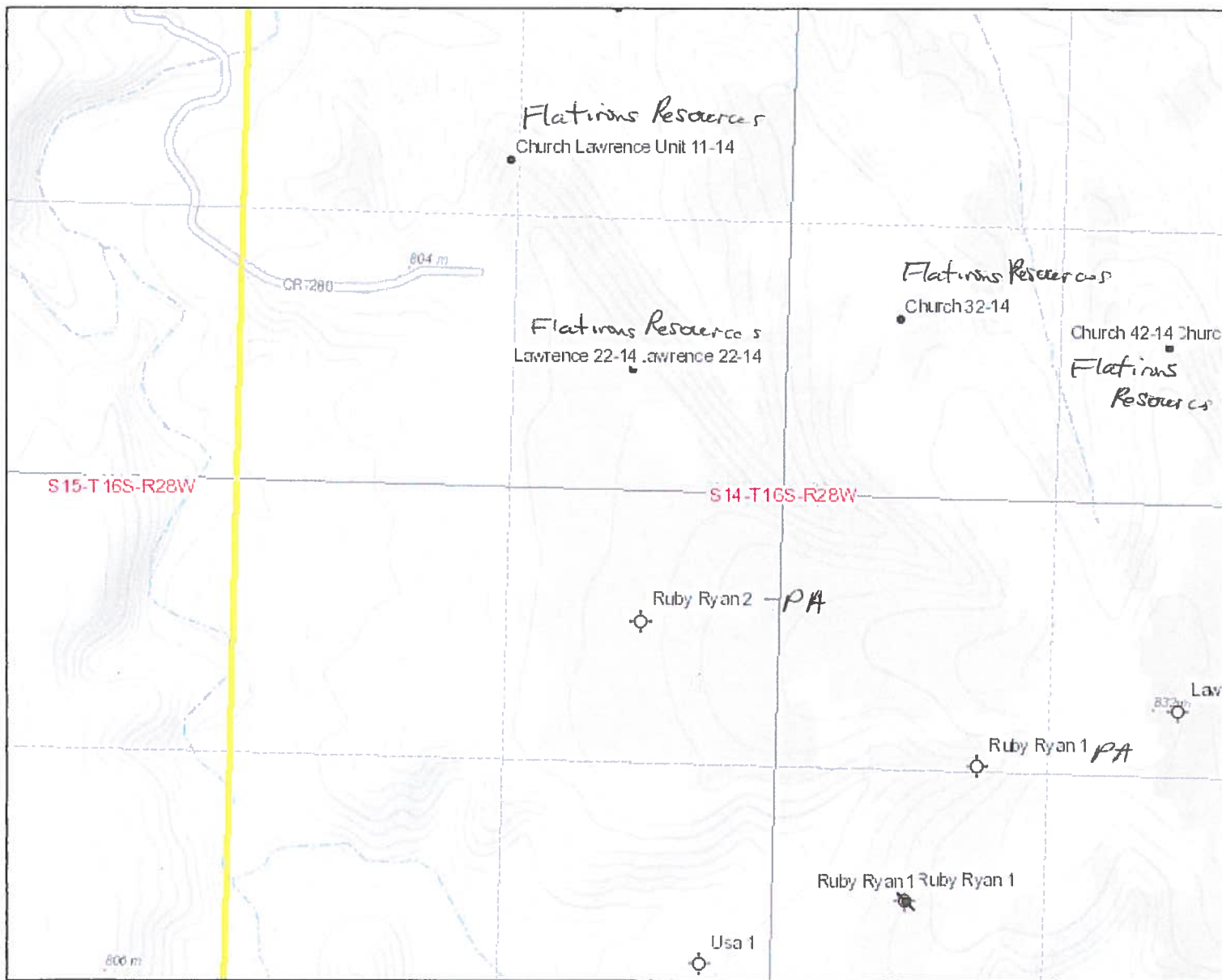

October 31, 17

0  
0  
Sources: Esri, HER  
USGS, FAO, NPS, N



**Affidavit of Notice Served**

Re: Application for: Commingle of Production  
Well Name: Lawrence 22-14 Legal Location: NE SWSENW Sec 14 T16S R28W

The undersigned hereby certifies that he / she is a duly authorized agent for the applicant, and that on the day 18<sup>th</sup> October, 2017, a true and correct copy of the application referenced above was delivered or mailed to the following parties:

Note: A copy of this affidavit must be served as a part of the application.

Name  
Lawrence, Stacy + Angela n/w  
Clare Production Co  
William Miller  
Joseph Rachwalak  
Sky W. Gomer  
Global Geodata  
Aska LLC  
Joseph Alfano  
Linda A. Avila  
Stephan Sevoyan  
Steven Shaddock  
Lafon Royalties

Address (Attach additional sheets if necessary)  
305 N. Elm Dighton, Kansas 67837  
P.O. Box 20736 Billings, Montana 59104  
7784 S. La Fayette Ct Centennial Colo 80122  
3 Bobcat Lane Littleton, Colo 80127  
4885 Dry Stone Drive Colo Springs, Colo 80923  
9150 E. Crestline Ave Greenwood Village Colo 80111  
2431 Red Ranch Drive Grand Junction 81505  
124 Silver Leaf Way Castle Rock Colo 80105  
6165 S. Oswego Street Greenwood Village Colo 80111  
8976 S. Edgewood Lane Littleton Colo 80133  
925 ST Andrews Lane Louisville Colo 80027  
1475 Ward Circle Franktown Colo 80116

I further attest that notice of the filing of this application was published in the Dighton Herald, the official county publication of Lane county. A copy of the affidavit of this publication is attached.

Signed this 31 day of Oct, 2017

Sharon Wells  
Applicant or Duly Authorized Agent

Subscribed and sworn to before me this 31<sup>st</sup> day of October, 2017

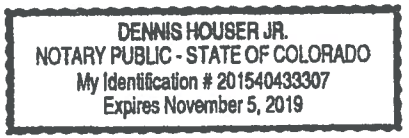

[Signature]  
Notary Public  
My Commission Expires: 11/5/19

Protests may be filed by any party having a valid interest in the application. Petitions for protests shall be in writing and shall clearly identify the name and address of the protestant and the title of the application. The petition shall include a clear and concise statement of the direct and substantial interest of the protestant in the proceedings, including the manner in which the protestant may be affected, and the nature, extent, character and grounds of the protest. Protestants shall serve the protest upon the applicant by mail or personal service at the same time or before the protestant files the protest with the Conservation Division. Protests must be filed within 30 days of the publication notice of the application.

Conservation Division  
266 N. Main St., Ste. 220  
Wichita, KS 67202-1513



Phone: 316-337-6200  
Fax: 316-337-6211  
<http://kcc.ks.gov/>

Pat Apple, Chairman  
Shari Feist Albrecht, Commissioner  
Jay Scott Emler, Commissioner

Sam Brownback, Governor

November 9, 2017

Flatirons Resources LLC  
Circlepoint Corporate Cntr II  
11080 Circle Point Rd, Ste #180  
Westminster, CO 80020

RE: Approved Commingling CO101705  
Lawrence #22-14  
API No. 15-101-22181-00-01

Dear Mr. Jones:

Your Application for Commingling (ACO-4) for the above described well has been reviewed and approved by the Kansas Corporation Commission (KCC) per K.A.R. 82-3-123. Notice was examined and found to be proper per K.A.R. 82-3-135a. No protest had been filed within the 15-day protest period.

Based upon the depth of the Cherokee formation perforations, total oil production shall not exceed 200 BOPD and total gas production shall not exceed 50% of the absolute open flow (AOF).

File form ACO-1 upon completion of the well to commingle.

Sincerely,

Rick Hestermann  
Production Department