

For KCC Use:  
Effective Date: \_\_\_\_\_  
District # \_\_\_\_\_  
SGA?  Yes  No

KANSAS CORPORATION COMMISSION 1371675  
OIL & GAS CONSERVATION DIVISION

Form C-1  
March 2010

Form must be Typed  
Form must be Signed  
All blanks must be Filled

**NOTICE OF INTENT TO DRILL**

Must be approved by KCC five (5) days prior to commencing well

Form KSONA-1, Certification of Compliance with the Kansas Surface Owner Notification Act, MUST be submitted with this form.

Expected Spud Date: \_\_\_\_\_  
month day year

OPERATOR: License# \_\_\_\_\_  
Name: \_\_\_\_\_  
Address 1: \_\_\_\_\_  
Address 2: \_\_\_\_\_  
City: \_\_\_\_\_ State: \_\_\_\_\_ Zip: \_\_\_\_\_ + \_\_\_\_\_  
Contact Person: \_\_\_\_\_  
Phone: \_\_\_\_\_

CONTRACTOR: License# \_\_\_\_\_  
Name: \_\_\_\_\_

Well Drilled For:	Well Class:	Type Equipment:
<input type="checkbox"/> Oil	<input type="checkbox"/> Enh Rec	<input type="checkbox"/> Infield
<input type="checkbox"/> Gas	<input type="checkbox"/> Storage	<input type="checkbox"/> Pool Ext.
	<input type="checkbox"/> Disposal	<input type="checkbox"/> Wildcat
<input type="checkbox"/> Seismic ; _____ # of Holes	<input type="checkbox"/> Other	<input type="checkbox"/> Mud Rotary
<input type="checkbox"/> Other: _____		<input type="checkbox"/> Air Rotary
		<input type="checkbox"/> Cable

If OWWO: old well information as follows:

Operator: \_\_\_\_\_  
Well Name: \_\_\_\_\_  
Original Completion Date: \_\_\_\_\_ Original Total Depth: \_\_\_\_\_

Directional, Deviated or Horizontal wellbore?  Yes  No  
If Yes, true vertical depth: \_\_\_\_\_  
Bottom Hole Location: \_\_\_\_\_  
KCC DKT #: \_\_\_\_\_

Spot Description: \_\_\_\_\_  
\_\_\_\_\_ - \_\_\_\_\_ - \_\_\_\_\_ Sec. \_\_\_\_\_ Twp. \_\_\_\_\_ S. R. \_\_\_\_\_  E  W  
(Q/Q/Q/Q) \_\_\_\_\_ feet from  N /  S Line of Section  
\_\_\_\_\_ feet from  E /  W Line of Section  
Is SECTION:  Regular  Irregular?

(Note: Locate well on the Section Plat on reverse side)

County: \_\_\_\_\_  
Lease Name: \_\_\_\_\_ Well #: \_\_\_\_\_  
Field Name: \_\_\_\_\_  
Is this a Prorated / Spaced Field?  Yes  No  
Target Formation(s): \_\_\_\_\_  
Nearest Lease or unit boundary line (in footage): \_\_\_\_\_  
Ground Surface Elevation: \_\_\_\_\_ feet MSL  
Water well within one-quarter mile:  Yes  No  
Public water supply well within one mile:  Yes  No  
Depth to bottom of fresh water: \_\_\_\_\_  
Depth to bottom of usable water: \_\_\_\_\_  
Surface Pipe by Alternate:  I  II  
Length of Surface Pipe Planned to be set: \_\_\_\_\_  
Length of Conductor Pipe (if any): \_\_\_\_\_  
Projected Total Depth: \_\_\_\_\_  
Formation at Total Depth: \_\_\_\_\_  
Water Source for Drilling Operations:  
 Well  Farm Pond  Other: \_\_\_\_\_  
DWR Permit #: \_\_\_\_\_  
(Note: Apply for Permit with DWR )  
Will Cores be taken?  Yes  No  
If Yes, proposed zone: \_\_\_\_\_

**AFFIDAVIT**

The undersigned hereby affirms that the drilling, completion and eventual plugging of this well will comply with K.S.A. 55 et. seq.

It is agreed that the following minimum requirements will be met:

1. Notify the appropriate district office **prior** to spudding of well;
2. A copy of the approved notice of intent to drill **shall be** posted on each drilling rig;
3. The minimum amount of surface pipe as specified below **shall be set** by circulating cement to the top; in all cases surface pipe **shall be set** through all unconsolidated materials plus a minimum of 20 feet into the underlying formation.
4. If the well is dry hole, an agreement between the operator and the district office on plug length and placement is necessary **prior to plugging**;
5. The appropriate district office will be notified before well is either plugged or production casing is cemented in;
6. If an ALTERNATE II COMPLETION, production pipe shall be cemented from below any usable water to surface within **120 DAYS** of spud date. Or pursuant to Appendix "B" - Eastern Kansas surface casing order #133,891-C, which applies to the KCC District 3 area, alternate II cementing must be completed within 30 days of the spud date or the well shall be plugged. **In all cases, NOTIFY district office** prior to any cementing.

**Submitted Electronically**

<p><b>For KCC Use ONLY</b></p> <p>API # 15 - _____</p> <p>Conductor pipe required _____ feet</p> <p>Minimum surface pipe required _____ feet per ALT. <input type="checkbox"/> I <input type="checkbox"/> II</p> <p>Approved by: _____</p> <p><b>This authorization expires:</b> _____ (This authorization void if drilling not started within 12 months of approval date.)</p> <p>Spud date: _____ Agent: _____</p>
--

**Remember to:**

- File Certification of Compliance with the Kansas Surface Owner Notification Act (KSONA-1) with Intent to Drill;
- File Drill Pit Application (form CDP-1) with Intent to Drill;
- File Completion Form ACO-1 within 120 days of spud date;
- File acreage attribution plat according to field proration orders;
- Notify appropriate district office 48 hours prior to workover or re-entry;
- Submit plugging report (CP-4) after plugging is completed (within 60 days);
- Obtain written approval before disposing or injecting salt water.
- If well will not be drilled or permit has expired (See: authorized expiration date) please check the box below and return to the address below.

**Well will not be drilled or Permit Expired** Date: \_\_\_\_\_  
Signature of Operator or Agent: \_\_\_\_\_

E  
 W



For KCC Use ONLY

API # 15 - \_\_\_\_\_

### IN ALL CASES PLOT THE INTENDED WELL ON THE PLAT BELOW

In all cases, please fully complete this side of the form. Include items 1 through 5 at the bottom of this page.

Operator: \_\_\_\_\_

Lease: \_\_\_\_\_

Well Number: \_\_\_\_\_

Field: \_\_\_\_\_

Number of Acres attributable to well: \_\_\_\_\_

QTR/QTR/QTR/QTR of acreage: \_\_\_\_\_ - \_\_\_\_\_ - \_\_\_\_\_ - \_\_\_\_\_

Location of Well: County: \_\_\_\_\_

\_\_\_\_\_ feet from  N /  S Line of Section

\_\_\_\_\_ feet from  E /  W Line of Section

Sec. \_\_\_\_\_ Twp. \_\_\_\_\_ S. R. \_\_\_\_\_  E  W

Is Section:  Regular or  Irregular

**If Section is Irregular, locate well from nearest corner boundary.**

Section corner used:  NE  NW  SE  SW

### PLAT

Show location of the well. Show footage to the nearest lease or unit boundary line. Show the predicted locations of lease roads, tank batteries, pipelines and electrical lines, as required by the Kansas Surface Owner Notice Act (House Bill 2032). You may attach a separate plat if desired.

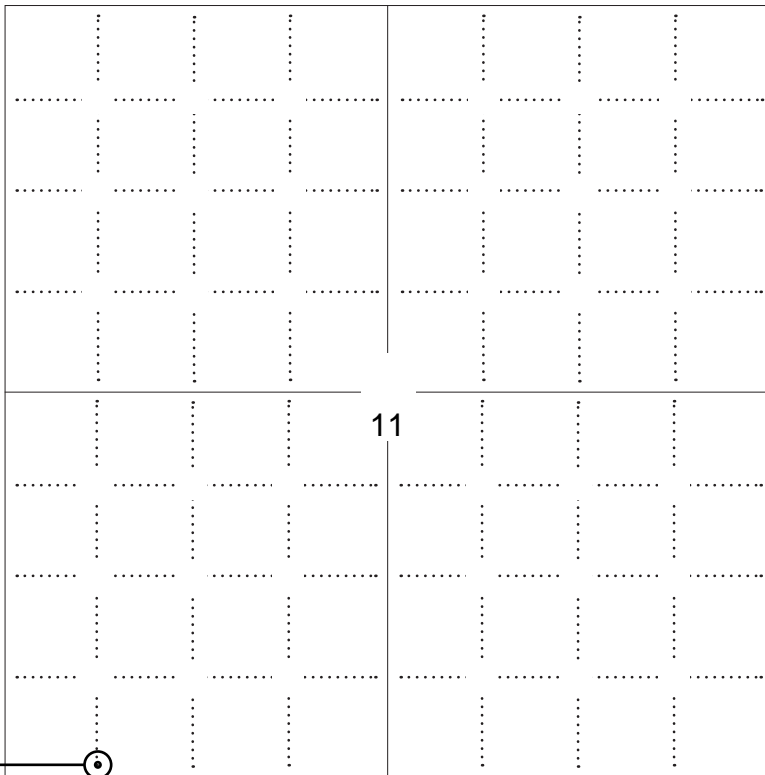

### LEGEND

- Well Location
- Tank Battery Location
- Pipeline Location
- Electric Line Location
- Lease Road Location



NOTE: In all cases locate the spot of the proposed drilling location.

90 ft.

In plotting the proposed location of the well, you must show:

1. The manner in which you are using the depicted plat by identifying section lines, i.e. 1 section, 1 section with 8 surrounding sections, 4 sections, etc.
2. The distance of the proposed drilling location from the south / north and east / west outside section lines.
3. The distance to the nearest lease or unit boundary line (in footage).
4. If proposed location is located within a prorated or spaced field a certificate of acreage attribution plat must be attached: (C0-7 for oil wells; CG-8 for gas wells).
5. The predicted locations of lease roads, tank batteries, pipelines, and electrical lines.



**APPLICATION FOR SURFACE PIT**

*Submit in Duplicate*

Operator Name:		License Number:	
Operator Address:			
Contact Person:		Phone Number:	
Lease Name & Well No.:		Pit Location (QQQQ): ____ - ____ - ____ - ____	
Type of Pit: <input type="checkbox"/> Emergency Pit <input type="checkbox"/> Burn Pit <input type="checkbox"/> Settling Pit <input type="checkbox"/> Drilling Pit <input type="checkbox"/> Workover Pit <input type="checkbox"/> Haul-Off Pit <i>(If WP Supply API No. or Year Drilled)</i>		Pit is: <input type="checkbox"/> Proposed <input type="checkbox"/> Existing If Existing, date constructed: _____ Pit capacity: _____ (bbls)	
Is the pit located in a Sensitive Ground Water Area? <input type="checkbox"/> Yes <input type="checkbox"/> No		Chloride concentration: _____ mg/l <i>(For Emergency Pits and Settling Pits only)</i>	
Is the bottom below ground level? <input type="checkbox"/> Yes <input type="checkbox"/> No		Artificial Liner? <input type="checkbox"/> Yes <input type="checkbox"/> No	
How is the pit lined if a plastic liner is not used?			
Pit dimensions (all but working pits):    _____ Length (feet)    _____ Width (feet) <input type="checkbox"/> N/A: Steel Pits Depth from ground level to deepest point: _____ (feet) <input type="checkbox"/> No Pit			
If the pit is lined give a brief description of the liner material, thickness and installation procedure.		Describe procedures for periodic maintenance and determining liner integrity, including any special monitoring.	
Distance to nearest water well within one-mile of pit: _____ feet    Depth of water well _____ feet		Depth to shallowest fresh water _____ feet. Source of information: <input type="checkbox"/> measured <input type="checkbox"/> well owner <input type="checkbox"/> electric log <input type="checkbox"/> KDWR	
<b>Emergency, Settling and Burn Pits ONLY:</b> Producing Formation: _____ Number of producing wells on lease: _____ Barrels of fluid produced daily: _____ Does the slope from the tank battery allow all spilled fluids to flow into the pit? <input type="checkbox"/> Yes <input type="checkbox"/> No		<b>Drilling, Workover and Haul-Off Pits ONLY:</b> Type of material utilized in drilling/workover: _____ Number of working pits to be utilized: _____ Abandonment procedure: _____ _____ Drill pits must be closed within 365 days of spud date.	
Submitted Electronically			

<b>KCC OFFICE USE ONLY</b>			
		<input type="checkbox"/> Liner <input type="checkbox"/> Steel Pit <input type="checkbox"/> RFAC <input type="checkbox"/> RFAS	
Date Received: _____		Permit Number: _____	
		Permit Date: _____    Lease Inspection: <input type="checkbox"/> Yes <input type="checkbox"/> No	



### CERTIFICATION OF COMPLIANCE WITH THE KANSAS SURFACE OWNER NOTIFICATION ACT

*This form must be submitted with all Forms C-1 (Notice of Intent to Drill); CB-1 (Cathodic Protection Borehole Intent); T-1 (Request for Change of Operator Transfer of Injection or Surface Pit Permit); and CP-1 (Well Plugging Application). Any such form submitted without an accompanying Form KSONA-1 will be returned.*

Select the corresponding form being filed:  C-1 (Intent)  CB-1 (Cathodic Protection Borehole Intent)  T-1 (Transfer)  CP-1 (Plugging Application)

OPERATOR: License # \_\_\_\_\_  
Name: \_\_\_\_\_  
Address 1: \_\_\_\_\_  
Address 2: \_\_\_\_\_  
City: \_\_\_\_\_ State: \_\_\_\_\_ Zip: \_\_\_\_\_ + \_\_\_\_\_  
Contact Person: \_\_\_\_\_  
Phone: ( \_\_\_\_\_ ) \_\_\_\_\_ Fax: ( \_\_\_\_\_ ) \_\_\_\_\_  
Email Address: \_\_\_\_\_

Well Location:  
\_\_\_\_ - \_\_\_\_ - \_\_\_\_ - \_\_\_\_ Sec. \_\_\_\_ Twp. \_\_\_\_ S. R. \_\_\_\_  East  West  
County: \_\_\_\_\_  
Lease Name: \_\_\_\_\_ Well #: \_\_\_\_\_

*If filing a Form T-1 for multiple wells on a lease, enter the legal description of the lease below:*

**Surface Owner Information:**

Name: \_\_\_\_\_  
Address 1: \_\_\_\_\_  
Address 2: \_\_\_\_\_  
City: \_\_\_\_\_ State: \_\_\_\_\_ Zip: \_\_\_\_\_ + \_\_\_\_\_

*When filing a Form T-1 involving multiple surface owners, attach an additional sheet listing all of the information to the left for each surface owner. Surface owner information can be found in the records of the register of deeds for the county, and in the real estate property tax records of the county treasurer.*

*If this form is being submitted with a Form C-1 (Intent) or CB-1 (Cathodic Protection Borehole Intent), you must supply the surface owners and the KCC with a plat showing the predicted locations of lease roads, tank batteries, pipelines, and electrical lines. The locations shown on the plat are preliminary non-binding estimates. The locations may be entered on the Form C-1 plat, Form CB-1 plat, or a separate plat may be submitted.*

**Select one of the following:**

- I certify that, pursuant to the Kansas Surface Owner Notice Act (House Bill 2032), I have provided the following to the surface owner(s) of the land upon which the subject well is or will be located: 1) a copy of the Form C-1, Form CB-1, Form T-1, or Form CP-1 that I am filing in connection with this form; 2) if the form being filed is a Form C-1 or Form CB-1, the plat(s) required by this form; and 3) my operator name, address, phone number, fax, and email address.
- I have not provided this information to the surface owner(s). I acknowledge that, because I have not provided this information, the KCC will be required to send this information to the surface owner(s). To mitigate the additional cost of the KCC performing this task, I acknowledge that I must provide the name and address of the surface owner by filling out the top section of this form and that I am being charged a \$30.00 handling fee, payable to the KCC, which is enclosed with this form.

*If choosing the second option, submit payment of the \$30.00 handling fee with this form. If the fee is not received with this form, the KSONA-1 form and the associated Form C-1, Form CB-1, Form T-1, or Form CP-1 will be returned.*

I Submitted Electronically

I

**IN ALL CASES PLOT THE INTENDED WELL ON THE PLAT BELOW**

*Plat of acreage attributable to a well in a prorated or spaced field*

**If the intended well is in a prorated or spaced field, please fully complete this side of the form.** If the intended well is in a prorated or spaced field complete the plat below showing that the well will be properly located in relationship to other wells producing from the common source of supply. Please show all the wells and within 1 mile of the boundaries of the proposed acreage attribution unit for gas wells and within 1/2 mile of the boundaries of the proposed acreage attribution unit for oil wells.

API No. 15 - \_\_\_\_\_  
 Operator: F.G. Holl Company, L.L.C.  
 Lease: ZOE/GARRETT UNIT  
 Well Number: 1-11  
 Field: Wildcat  
 Number of Acres attributable to well: \_\_\_\_\_  
 QTR / QTR / QTR of acreage: S/2 - SW - SW

Location of Well: County: Stafford  
 90 \_\_\_\_\_ feet from  N /  S Line of Section  
 635 \_\_\_\_\_ feet from  E /  W Line of Section  
 Sec. 11 Twp. 21 S. R. 14  East  West

Is Section:  Regular or  Irregular

**If Section is Irregular, locate well from nearest corner boundary.**

Section corner used:  NE  NW  SE  SW

**PLAT**

*(Show location of the well and shade attributable acreage for prorated or spaced wells.)  
 (Show footage to the nearest lease or unit boundary line.)*

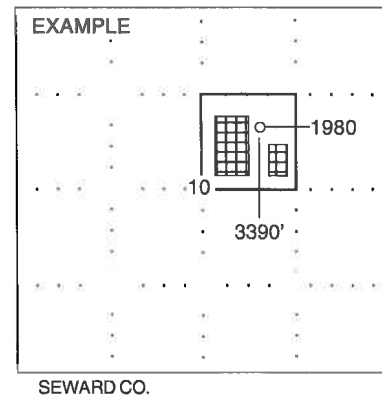
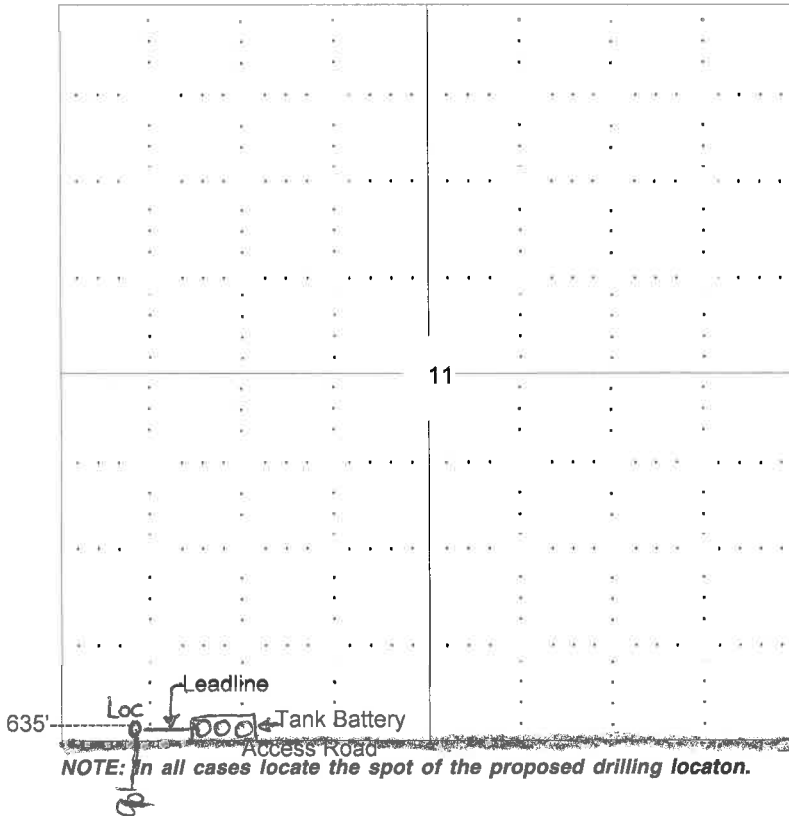

**In plotting the proposed location of the well, you must show:**

1. The manner in which you are using the depicted plat by identifying section lines, i.e. 1 section, 1 section with 8 surrounding sections, 4 sections, etc.
2. The distance of the proposed drilling location from the section's south / north and east / west.
3. The distance to the nearest lease or unit boundary line.
4. If proposed location is located within a prorated or spaced field a certificate of acreage attribution plat must be attached: (C0-7 for oil wells; CG-8 for gas wells).

**DECLARATION FOR UNITIZED OPERATIONS  
ZOE-GARRETT OIL AND GAS UNIT**

KNOW ALL MEN BY THESE PRESENTS: THAT,

WHEREAS, F. G. Holl Company, L.L.C., is the owner of all working interest in the following described Oil and Gas Leases, all in Stafford County, KS:

- 1) Lease: HIPP-11;14 (521012)  
Dated: 12/4/2012  
Lessor: Hipp, Beverly; Hipp, Gene B.; Hipp, Billie  
Lessee: F. G. Holl Co., L. L. C.  
Leased Premises: Sec.14-21S-14W: N/2 NW/4;  
Sec.11-21S-14W: S/2 SW/4;  
Gross Acres: 160  
Recorded: Book 235 / Page 153, STAFFORD County, KS ROD  
Subject to Partial Release: Recorded Book 266 / Page 389
  
- 2) Lease: DIECKGRAFE-11;14 (530013)  
Dated: 12/27/2012  
Lessor: Dieckgrafe, Vickie Curtis fka Vickie Curtis  
Lessee: F. G. Holl Co., L. L. C.  
Leased Premises: Sec. 14-21S-14W: N/2 NW/4;  
Sec. 11-21S-14W: S/2 SW/4;  
Gross Acres: 160  
Recorded: Book 237 / Page 65, STAFFORD County, KS ROD  
Subject to Partial Release: Recorded Book 266 / Page 389
  
- 3) Lease: CURTIS,L-11;14 (531013)  
Dated: 12/31/2012  
Lessor: Curtis, L .J.; Curtis, Janie  
Lessee: F. G. Holl Co., L. L. C.  
Leases Premises: Sec. 14-21S-14W: N/2 NW/4;  
Sec. 11-21S-14W: S/2 SW/4;  
Gross Acres: 160  
Recorded: Book 237 / Page 67, STAFFORD County, KS ROD  
Subject to Partial Release: Recorded Book 266 / Page 389
  
- 4) Lease: STOUT-11;14 (532013)  
Dated: 2/4/2013  
Lessor: Stout, Edward L., IV  
Lessee: F. G. Holl Co., L. L. C.  
Leased Premises: Sec. 14-21S-14W: S/2 NW/4; N/2 NW/4;  
Sec. 11-21S-14W: S/2 SW/4;  
Gross Acres: 240  
Recorded: Book 237 / Page 69, STAFFORD County, KS ROD
  
- 5) Lease: KORBA-11;14 (533013)  
Dated: 2/6/2013  
Lessor: Korba, Martha Lee aka Martha S. Korba; Korba, Thomas M.  
Lessee: F. G. Holl Co., L. L. C.  
Leased Premises: Sec. 14-21S-14W: S/2 NW/4; N/2 NW/4;  
Sec. 11-21S-14W: S/2 SW/4;  
Gross Acres: 240  
Recorded: Book 237 / Page 71, STAFFORD County, KS ROD

- 6) Lease: HOOSIER-11;14 (534013)  
 Dated: 1/30/2013  
 Lessor: Hoosier, Theresa M.; Hoosier, William III  
 Lessee: F. G. Holl Co., L. L. C.  
 Leased Premises: 14-21S-14W: S/2 NW/4;  
 11-21S-14W: S/2 SW/4;  
 Gross Acres: 160  
 Recorded: Book 237 / Page 73, STAFFORD County, KS ROD
- 7) Lease: MORLOCK-11;14 (535013)  
 Dated: 12/31/2012  
 Lessor: Morlock, Tammy Curtis, f/k/a Tammy Curtis; Morlock, Monte  
 Lessee: F. G. Holl Co., L. L. C.  
 Leased Premises: Sec. 14-21S-14W: N/2 NW/4;  
 Sec. 11-21S-14W: S/2 SW/4;  
 Gross Acres: 160  
 Recorded: Book 237 / Page 63, STAFFORD County, KS ROD  
 Subject to Partial Release: Recorded Book 266 / Page 389
- 8) Lease: CURTIS-11;14 (536013)  
 Dated: 12/27/2012  
 Lessor: Curtis, William; Curtis, Marguerite  
 Lessee: F. G. Holl Co., L. L. C.  
 Leased Premises: Sec. 14-21S-14W: N/2 NW/4;  
 Sec. 11-21S-14W: S/2 SW/4;  
 Gross Acres: 160  
 Recorded: Book 237 / Page 61, STAFFORD County, KS ROD  
 Subject to Partial Release: Recorded Book 266 / Page 389
- 9) Lease: MACY-11;14 (537013)  
 Dated: 12/31/2012  
 Lessor: Macy, Cheri Curtis f/k/a Cheri Curtis; Macy, Bruce  
 Lessee: F. G. Holl Co., L. L. C.  
 Leased Premises: Sec. 14-21S-14W: N/2 NW/4;  
 Sec. 11-21S-14W: S/2 SW/4;  
 Gross Acres: 160  
 Recorded: Book 237 / Page 59, STAFFORD County, KS ROD  
 Subject to Partial Release: Recorded Book 266 / Page 389
- 10) Lease: CLARDY-11;14 (564013)  
 Dated: 1/31/2013  
 Lessor: Clardy, Margaret C.  
 Lessee: F. G. Holl Co., L. L. C.  
 Leased Premises: Sec. 14-21S-14W: S/2 NW/4;  
 Sec. 11-21S-14W: S/2 SW/4;  
 Gross Acres: 160  
 Recorded: Book 237 / Page 860, STAFFORD County, KS ROD
- 11) Lease: CORNWELL-11;14 (612013)  
 Dated: 8/5/2013  
 Lessor: Cornwell, John James; Cornwell, Renee M  
 Lessee: F. G. Holl Co., L. L. C.  
 Leased Premises: Sec. 14-21S-14W: S/2 NW/4; N/2 NW/4;  
 Sec. 11-21S-14W: S/2 SW/4;  
 Gross Acres: 240  
 Recorded: Book 241 / Page 331, STAFFORD County, KS ROD

- 12) Lease: HOWARD-11,14 (632013)  
 Dated: 3/31/2013  
 Lessor: Howard, Ruth Maureen; Howard, David Paul  
 Lessee: F. G. Holl Co., L. L. C.  
 Leased Premises: Sec. 14-21S-14W: S/2 NW/4; N/2 NW/4  
 Sec. 11-21S-14W: S/2 SW/4  
 Gross Acres: 240  
 Recorded: Book 242 / Page 653, STAFFORD County, KS ROD
- 13) Lease: GAGER-11,14 (666013)  
 Dated: 11/20/2013  
 Lessor: Gager, Robert William  
 Lessee: F. G. Holl Co., L. L. C.  
 Leased Premises: Sec. 14-21S-14W: S/2 NW/4; N/2 NW/4;  
 Sec. 11-21S-14W: S/2 SW/4;  
 Gross Acres: 240  
 Recorded: Book 243 / Page 391, STAFFORD County, KS ROD
- 14) Lease: CURTIS, S.M.-11;14 (697014)  
 Dated: 1/27/2014  
 Lessor: Curtis, Steven Mark  
 Lessee: F. G. Holl Co., L. L. C.  
 Leases Premises: Sec. 14-21S-14W: S/2 NW/4;  
 Sec. 11-21S-14W: S/2 SW/4;  
 Gross Acres: 160  
 Recorded: Book 245 / Page 626, STAFFORD County, KS ROD  
 Extended: Book 256 / Page 900, STAFFORD County, KS ROD
- 15) Lease: CURTIS, MANUEL-11,14 (808015)  
 Dated: 11/20/2015  
 Lessor: Curtis, Cathy Manuel a/k/a Mary Cathleen Curtis  
 Lessee: F. G. Holl Co., L. L. C.  
 Leased Premises: Sec. 14-21S-14W: S/2 NW/4;  
 Sec. 11-21S-14W: S/2 SW/4;  
 Gross Acres: 160  
 Recorded: Book 256 / Page 897, STAFFORD County, KS ROD  
 Subject to Partial Release: Recorded Book 266 / Page 429
- 16) Lease: GARRETT-14 (815017)  
 Dated: 4/18/2017  
 Lessor: Garrett, Randall L.; Garrett, Jeanie A.  
 Lessee: F. G. Holl Co., L. L. C.  
 Leased Premises: 14-21S-14W: N/2 NW/4;  
 Gross Acres: 80  
 Recorded: Book 264 / Page 80, STAFFORD County, KS ROD
- 17) Lease: HUTCHINSON, D.C. TR-11,14 (816017)  
 Dated: 5/31/2017  
 Lessor: Hutchinson, Donald Curtis, Jr. Rev Trust u/t/a 10/26/2010  
 Lessee: F. G. Holl Co., L. L. C.  
 Leased Premises: Sec. 14-21S-14W: S/2 NW/4;  
 Sec. 11-21S-14W: S/2 SW/4;  
 Gross Acres: 160  
 Recorded: Book 264 / Page 588, STAFFORD County, KS ROD  
 Subject to Partial Release: Recorded Book 266 / Page 389



18) Lease: HUTCHINSON, CYNTHIA TR-11,14 (817017)  
 Dated: 5/31/2017  
 Lessor: Hutchinson, Cynthia L. Trust No. 1 u/t/a 12/16/1986  
 Lessee: F. G. Holl Co., L. L. C.  
 Leased Premises: Sec. 14-21S-14W: S/2 NW/4;  
 Sec. 11-21S-14W: S/2 SW/4;  
 Gross Acres: 160  
 Recorded: Book 264 / Page 586, STAFFORD County, KS ROD  
 Subject to Partial Release: Recorded Book 266 / Page 389

WHEREAS, under the terms of each of the above leases, the lessee is granted the right and privilege to consolidate the oil and/or gas leasehold estate with other oil and/or gas leasehold estates to form a consolidated oil and/or gas leasehold estate not to exceed a total of ten (10) acres, plus a tolerance of ten percent (10%) to conform to Governmental Survey quarter sections; WHEREAS, the undersigned desire to exercise the consolidation and pooling rights granted to them under each of the leases hereinabove specifically described;

NOW THEREFORE, the undersigned, pursuant to consolidation and pooling provisions of said oil and gas leases do hereby designate and describe **in Stafford County, KS:**

Sec. 11-21S-14W: E 660 feet of W 965 feet of S 420 feet of S/2 SW/4 of Sec. 11; (6.36 acres) and Sec. 14-21S-14W: E 660 feet of W 965 feet of N 240 feet of N/2 NW/4 of Sec 14; (3.64 acres)

covering an area of 10 acres, as a consolidated and pooled oil and gas leasehold estate for the purpose of exploration, development and production of oil and gas, and do hereby consolidate and pool the oil and gas leasehold estate under each of the above-described oil and gas leases with the other so as to form a consolidated and pooled oil and gas leasehold estate of 10 acres, in accordance with the terms, provisions and conditions of said oil and gas leases.

EXECUTED this 26<sup>th</sup> day of October, 2017.

F. G. HOLL COMPANY, L.L.C.

By: Margery L. Nagel  
 Margery L. Nagel, Managing Member

State of KANSAS }  
 }ss:  
 County of SEDGWICK }

This instrument was acknowledged before me this 26<sup>th</sup> day of October, by Margery L. Nagel, Managing Member of F.G. HOLL COMPANY, L.L.C.

My commission expires: 4/30/2018

Betty H. Spotswood  
 Notary Public - Betty H. Spotswood



Conservation Division  
266 N. Main St., Ste. 220  
Wichita, KS 67202-1513



Phone: 316-337-6200  
Fax: 316-337-6211  
<http://kcc.ks.gov/>

Pat Apple, Chairman  
Shari Feist Albrecht, Commissioner  
Jay Scott Emler, Commissioner

Sam Brownback, Governor

November 01, 2017

Franklin R. Greenbaum  
F. G. Holl Company L.L.C.  
9431 E CENTRAL STE 100  
WICHITA, KS 67206-2563

Re: Drilling Pit Application  
ZOE/GARRETT UNIT 1-11  
SW/4 Sec.11-21S-14W  
Stafford County, Kansas

Dear Franklin R. Greenbaum:

District staff has inspected the above referenced location and has determined that the reserve pit shall be constructed **without slots**, the bottom shall be flat and reasonably level and the free fluids must be removed. The fluids are to be removed from the reserve pit as soon as the Hutchinson Salt section has been drilled through and displacement of the fluids into the reserve pit has occurred. The fluids should be removed again within 72 hours after drilling operations have ceased.

**If production casing is set all completion fluids shall be removed from the working pits daily. NO completion fluids or non-exempt wastes shall be placed in the reserve pit.**

The fluids should be taken to an authorized disposal well. Please call the District Office at (620) 682-7933 when the fluids have been removed. Please file form CDP-5 (August 2008), Exploration and Production Waste Transfer, through KOLAR within 30 days of fluid removal.

**A copy of this letter should be posted in the doghouse along with the approved Intent to Drill.** If you have any questions or concerns please feel free to contact the District Office at (620) 682-7933.