

# CENTRAL KANSAS SURVEYING & MAPPING

2344 Washington - Great Bend, Kansas 67530 - (316) 792-5754 or (316) 792-2873

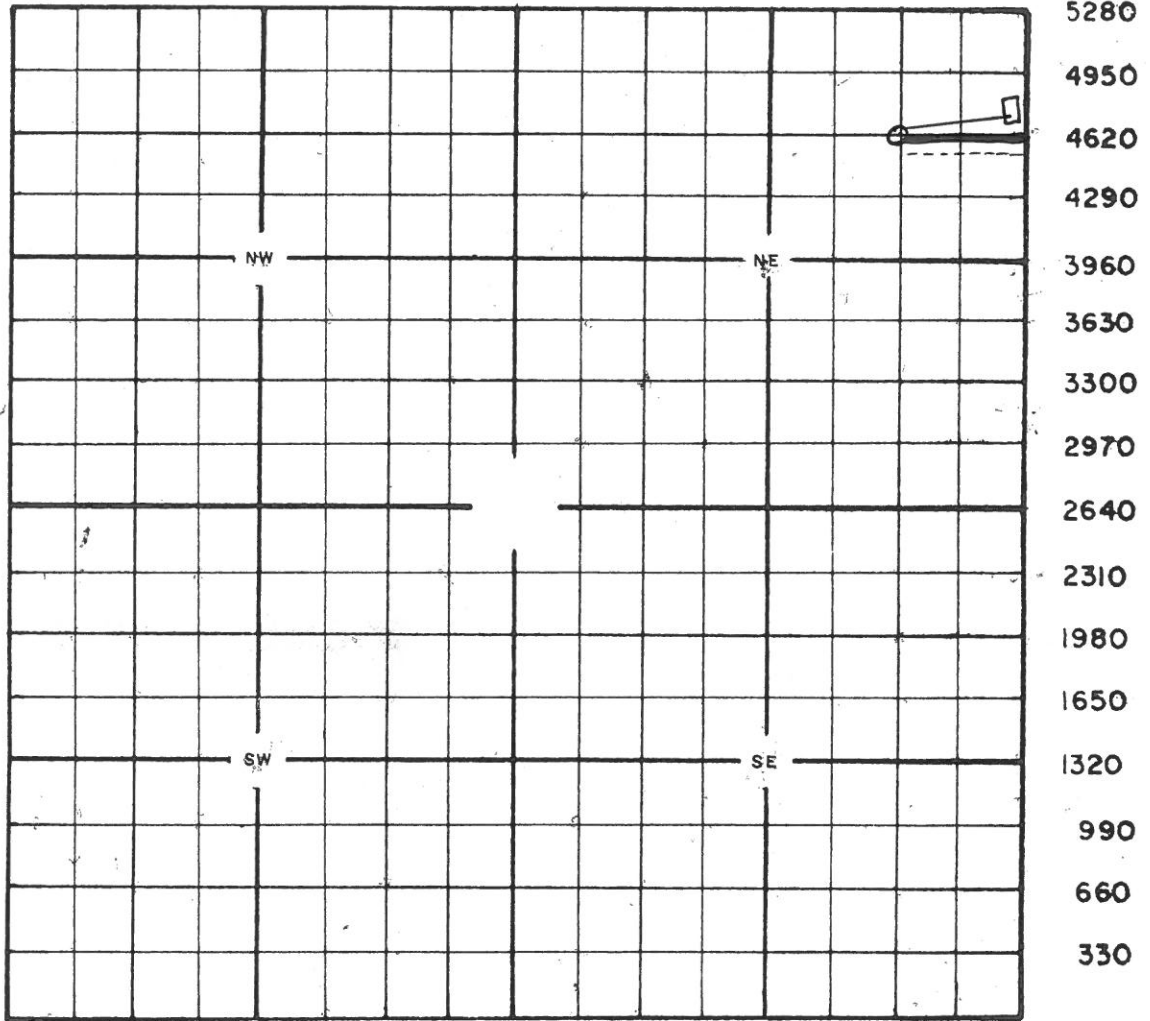
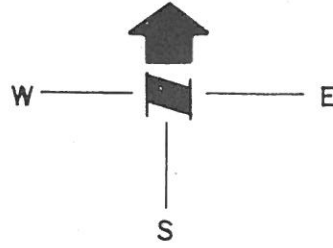

5280  
4950  
4620  
4290  
3960  
3630  
3300  
2970  
2640  
2310  
1980  
1650  
1320  
990  
660  
330

**BEAR PETROLEUM, LLC  
STEJSKAL LEASE  
NE. 1/4, SECTION 16, T21S, R20W  
PAWNEE COUNTY, KANSAS**

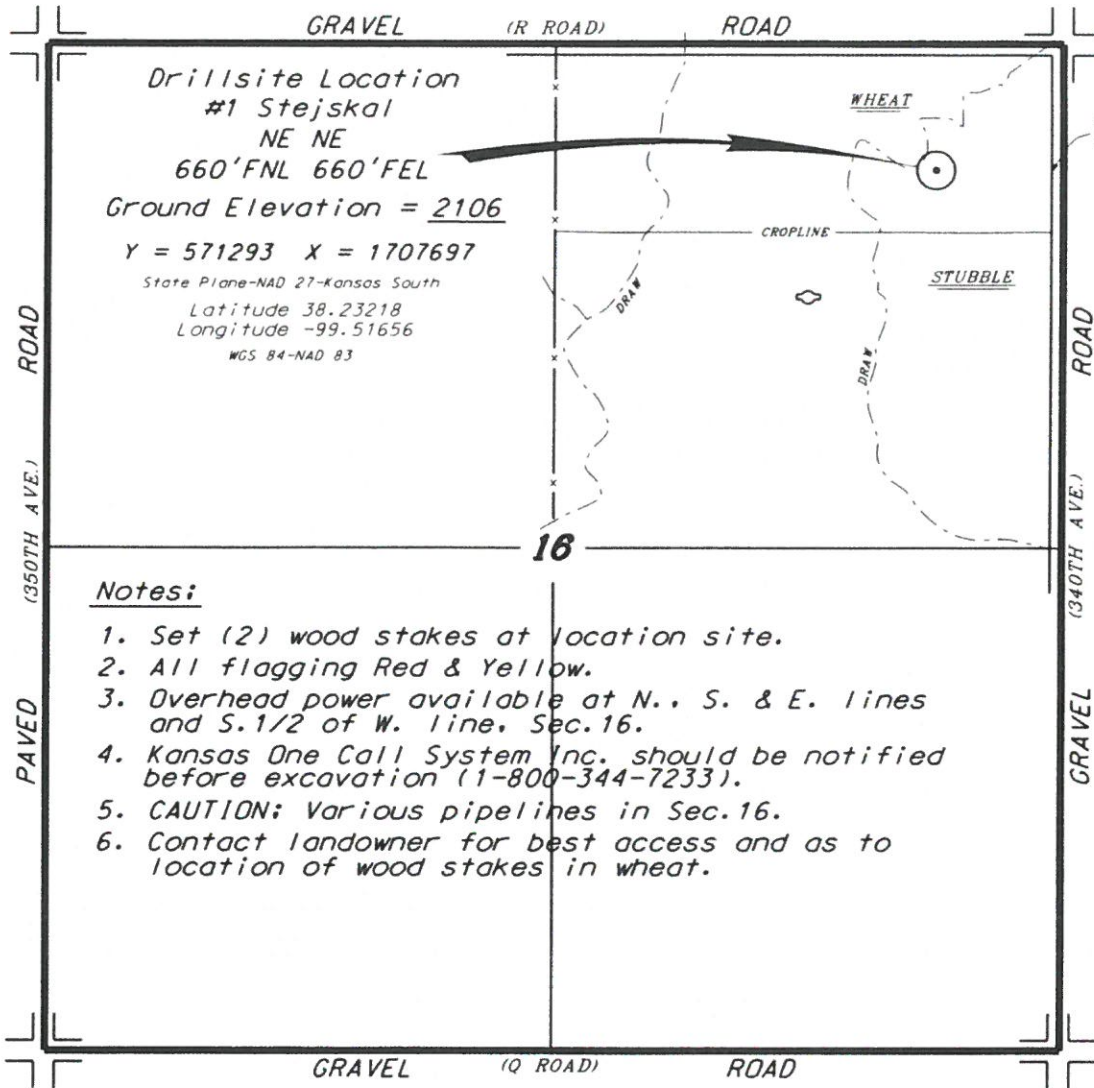

\* Ingress and egress to location as shown on this plot is per usage only and may not be legally opened for public use. Contact landowner, tenant and county road department for access.

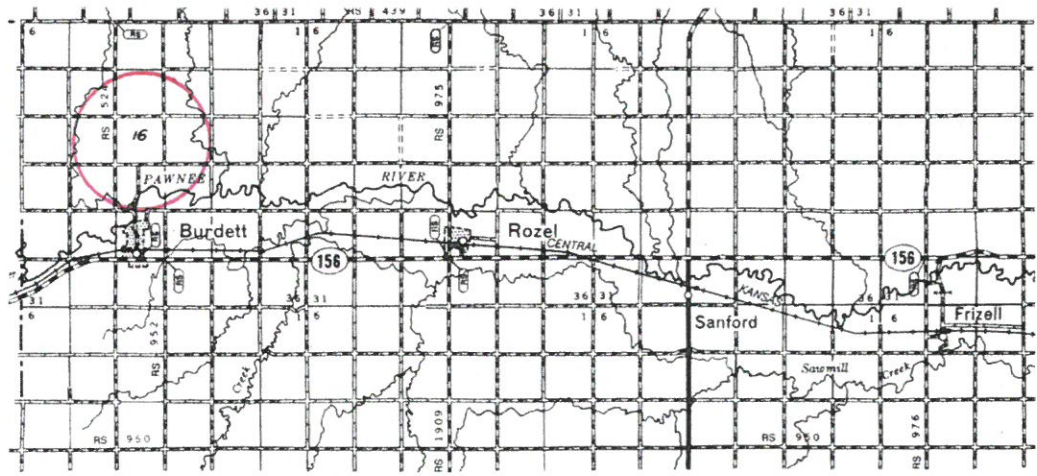

Controlling data is based upon the best maps and photographs available to us and upon a regular section of land containing 640 acres.  
Approximate section lines were determined using the normal standard of care of oilfield surveyors practicing in the state of Kansas. The section corners, which establish the precise section lines, were not necessarily located, and the exact location of the drillsite location in the section is not guaranteed. Therefore, the operator, securing this service and accepting this plot and all other parties relying thereon agree to hold Central Kansas Oilfield Services, Inc., its officers and employees harmless from all losses, costs and expenses and said entities released from any liability from incidental or consequential damages.  
Elevations derived from National Geodetic Vertical Datum.

Date January 24, 2018



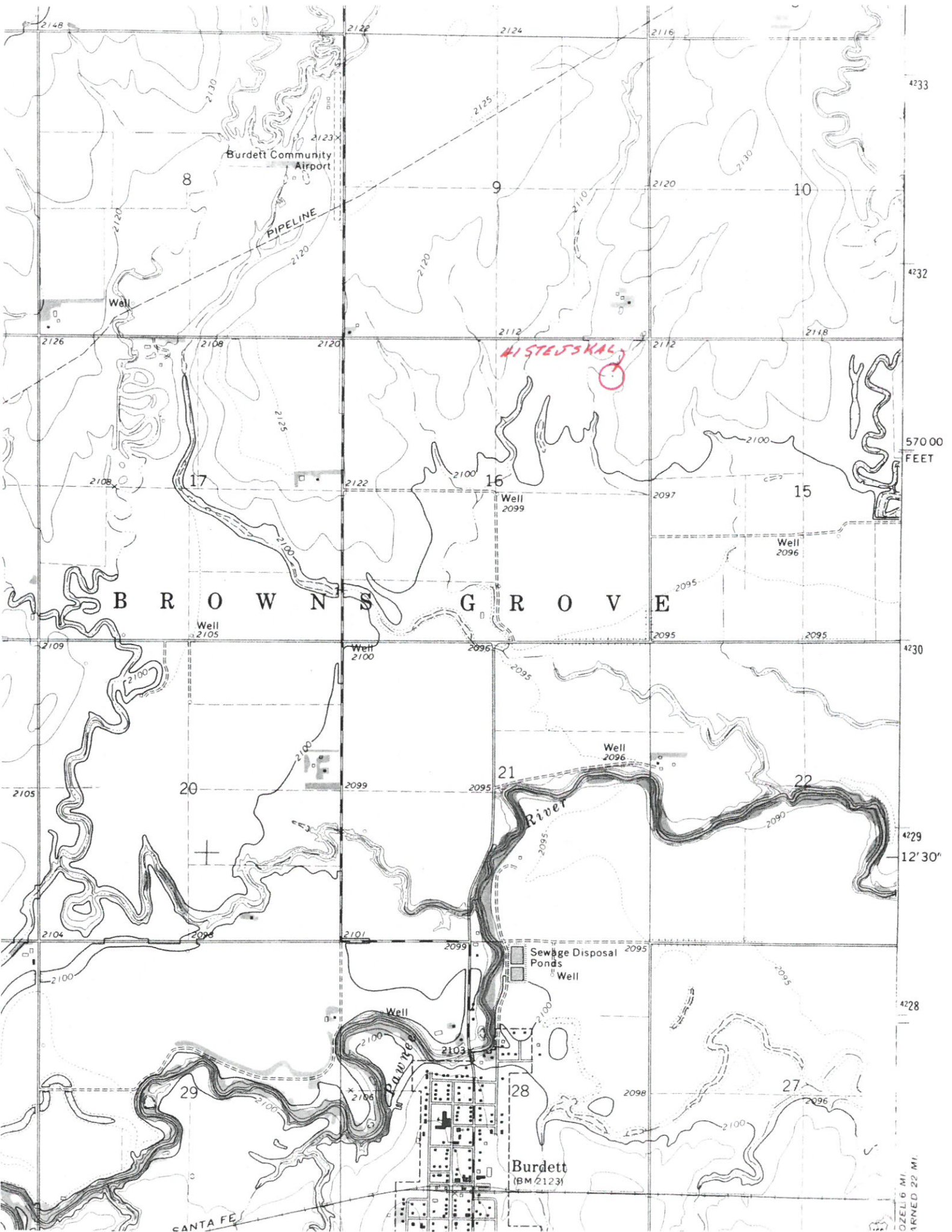

Burdett Community  
Airport

PIPELINE

Wall

HISTEUSKALY

B R O W N S G R O V E

River

Sewage Disposal  
Ponds

Burdett  
(BM 21231)

SANTA FE

57000  
FEET

SCALE 6 MI.  
ARNED 22 MI.