

L.D. DRILLING, INC.
HICKERT FARMS LEASE
N. 1/2, SECTION 27, T6S, R25W
GRAHAM COUNTY, KANSAS

Directions:

From the intersection of Highway 24 and Highway 283 (in Hill City, Kansas) go 10.0 miles West on Highway 24, then go 9.0 miles North, then go 4.0 miles West, then go 1.0 miles North to the NW corner of Section 27, then 0.93 miles East to a flag on the south edge of road, then go 0.23 miles South to location.

DIRT (AA ROAD) FLAGGED ROAD OPPOSITE LOC. ROAD

Drillsite Location
 Hickert Farms #1-27
 1199'FNL 2452'FEL
 Ground Elevation = 2557
 Y = 433818 X = 1408547
 State Plane-NAD 27-Kansas North
 Latitude 39.505698
 Longitude -100.096681
 NGS 84-NAD 83

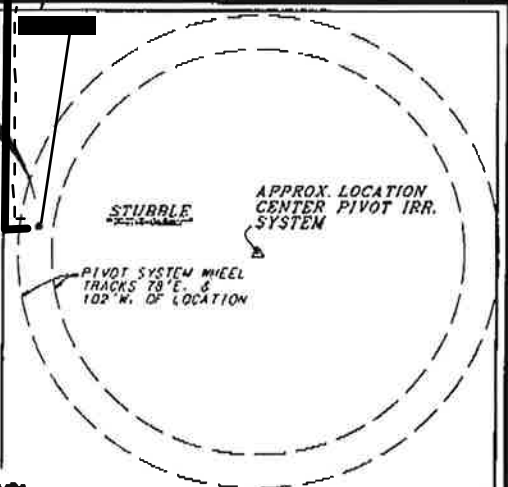

GRAVEL (130TH AVE.) ROAD

ROAD (140TH AVE.) DIRT

27

Notes:

1. Set (2) wood stakes at location site.
2. All flogging Red & Yellow.
3. Overhead power available at N. & W. lines. Sec.27 and at the SE. corner of Sec.27.
4. Kansas One Call System Inc. should be notified before excavation (1-800-344-7233).
5. CAUTION: Various pipelines in Sec.27.
6. Contact landowner for best access.
7. Drillsite area will require approximately a 1'cut/fill.

GRAVEL (Z ROAD) ROAD

* Ingress and egress to location as shown on this plat is per usage only and may not be legally opened for public use. Contact landowner, tenant and county road department for access.

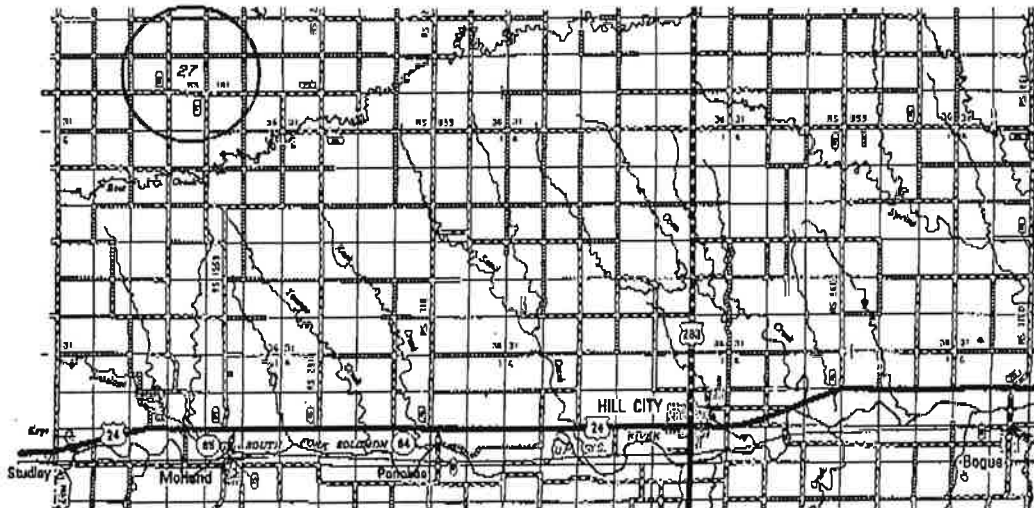

• Controlling data is based upon the best maps and photographs available to us and upon a regular section of land containing 640 acres.
 • Approximate section lines were determined using the normal standard of care of oilfield surveyors practicing in the state of Kansas. The section corners, which establish the precise section lines, were not necessarily located, and the exact location of the drillsite location in the section is not guaranteed. Therefore, the operator securing this service and accepting this plat and all other parties relying thereon agree to hold Central Kansas Oilfield Services, Inc., its officers and employees harmless from all losses, costs and expenses and said entities released from any liability from incidental or consequential damages.
 • Elevations derived from National Geodetic Vertical Datum.

Date October 26, 2017