

ADVANTAGE ELEVATIONS

OIL FIELD SURVEYORS

BOX 8604 - PRATT, KS 67124
(620) 672-6491

45181

INVOICE NO.

VAL ENERGY INC.

OPERATOR

4-1

NO

SILVER CREEK V OWWO

FARM

COWLEY

COUNTY

1
S

33s
T

5e
R

SE NW NE

LOCATION

ELEVATION: 1296' GR



VAL ENERGY INC.
125 N Market, Ste 1110
Wichita, KS 67202

AUTHORIZED BY: Todd Allam

SCALE: 1" = 1000'

Set 5' T-post & stake at
point of highest meter
reading.

Level to slight slope pasture.

Approx. Footages:

990' FNL & 1650' FEL of Sec.

GPS Coordinates: 37.21272
-96.83060
NAD83

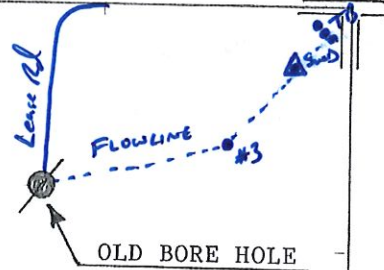

DATE STAKED: 4/5/18