

VINCENT OIL CORPORATION
 CLOSE LEASE
 SW. 1/4, SECTION 2, T29S, R23W
 FORD COUNTY, KANSAS

GRAVEL (WILBURD RD.) ROAD

Notes:

1. Marked spot on ground at drillsite location, set wood stake at alternate location.
2. All flagging Red & Yellow.
3. Overhead power available at N. & S. lines, Sec. 2.
4. Kansas One Call System Inc. should be notified before excavation (1-800-344-7233).
5. CAUTION: Various pipelines in Sec. 2.
6. Section 2 is irregular.
7. Contact landowner for best access.
8. Set alternate location per instructions.

ROAD

(122 ROAD)

DIRT

ROAD

NO

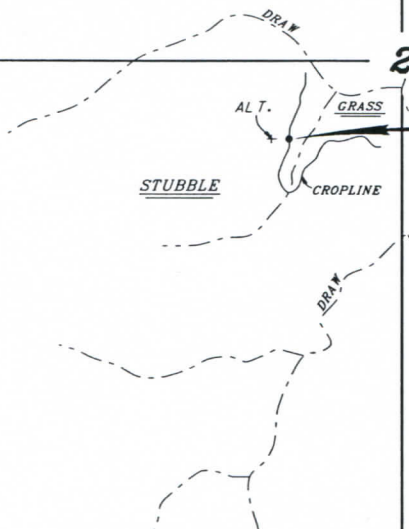

Drillsite Location
 Close #2-2
 2230'FSL 2055'FWL
 Ground Elevation = 2530
 Y = 323630 X = 1621400
 State Plane-NAD 27-Kansas South
 Latitude 37.548200461
 Longitude -99.805933075
 NAD 27

*Alternate Location
 (90' west of Loc.)
 2230'FSL 1965'FWL
 Ground Elevation = 2534
 Y = 323630 X = 1621310
 Latitude 37.548197
 Longitude -99.806243

GRAVEL (WILDFIRE RD.) TANK BATTERY ROAD

*Ingress and egress to location as shown on this plat is per usage only and may not be legally opened for public use. Contact landowner, tenant and county road department for access.

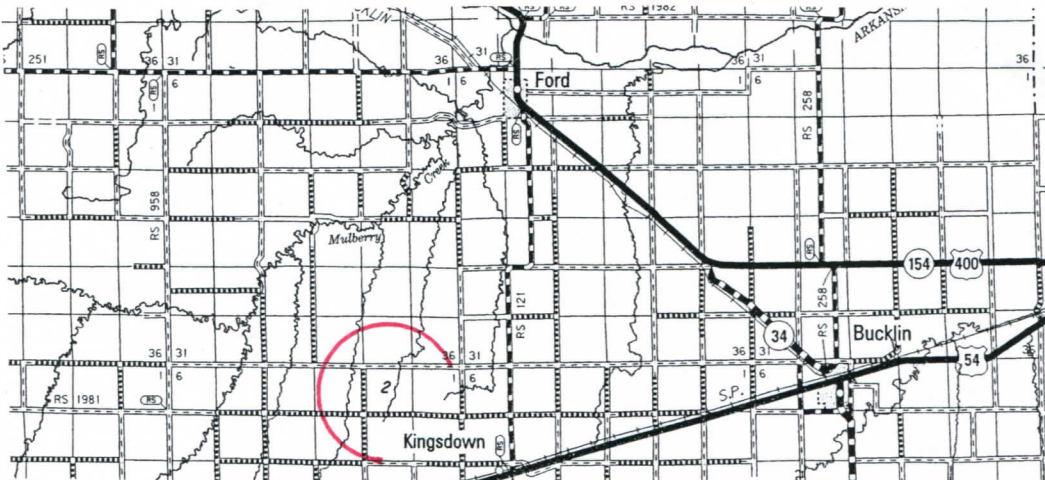

* Controlling data is based upon the best maps and photographs available to us and upon a regular section of land containing 640 acres.

* Approximate section lines were determined using the normal standard of care of oilfield surveyors practicing in the state of Kansas. The section corners, which establish the precise section lines, were not necessarily located, and the exact location of the drillsite location in the section is not guaranteed. Therefore, the operator securing this service and accepting this plat and all other parties relying thereon agree to hold Central Kansas Oilfield Services, Inc., its officers and employees harmless from all losses, costs and expenses and said entities released from any liability from incidental or consequential damages.

* Elevations derived from National Geodetic Vertical Datum.

Date June 21, 2018

