

For KCC Use:

Effective Date: _____

District # _____

SGA? Yes No

KANSAS CORPORATION COMMISSION
OIL & GAS CONSERVATION DIVISION

Form C-1

March 2010

Form must be Typed
Form must be Signed
All blanks must be Filled

NOTICE OF INTENT TO DRILL

Must be approved by KCC five (5) days prior to commencing well

Form KSONA-1, Certification of Compliance with the Kansas Surface Owner Notification Act, MUST be submitted with this form.

Expected Spud Date: _____
month day year

OPERATOR: License# _____

Name: _____

Address 1: _____

Address 2: _____

City: _____ State: _____ Zip: _____ + _____

Contact Person: _____

Phone: _____

CONTRACTOR: License# _____

Name: _____

Well Drilled For:

Well Class:

Type Equipment:

- | | | | |
|---|-----------------------------------|------------------------------------|-------------------------------------|
| <input type="checkbox"/> Oil | <input type="checkbox"/> Enh Rec | <input type="checkbox"/> Infield | <input type="checkbox"/> Mud Rotary |
| <input type="checkbox"/> Gas | <input type="checkbox"/> Storage | <input type="checkbox"/> Pool Ext. | <input type="checkbox"/> Air Rotary |
| | <input type="checkbox"/> Disposal | <input type="checkbox"/> Wildcat | <input type="checkbox"/> Cable |
| <input type="checkbox"/> Seismic ; _____ # of Holes | <input type="checkbox"/> Other | | |
| <input type="checkbox"/> Other: _____ | | | |

If OWWO: old well information as follows:

Operator: _____

Well Name: _____

Original Completion Date: _____ Original Total Depth: _____

Directional, Deviated or Horizontal wellbore? Yes No

If Yes, true vertical depth: _____

Bottom Hole Location: _____

KCC DKT #: _____

Spot Description: _____

_____ - _____ - _____ Sec. _____ Twp. _____ S. R. _____ E W
(Q/Q/Q/Q) _____ feet from N / S Line of Section

_____ feet from E / W Line of Section

Is SECTION: Regular Irregular?

(Note: Locate well on the Section Plat on reverse side)

County: _____

Lease Name: _____ Well #: _____

Field Name: _____

Is this a Prorated / Spaced Field? Yes No

Target Formation(s): _____

Nearest Lease or unit boundary line (in footage): _____

Ground Surface Elevation: _____ feet MSL

Water well within one-quarter mile: Yes No

Public water supply well within one mile: Yes No

Depth to bottom of fresh water: _____

Depth to bottom of usable water: _____

Surface Pipe by Alternate: I II

Length of Surface Pipe Planned to be set: _____

Length of Conductor Pipe (if any): _____

Projected Total Depth: _____

Formation at Total Depth: _____

Water Source for Drilling Operations:

Well Farm Pond Other: _____

DWR Permit #: _____

(Note: Apply for Permit with DWR)

Will Cores be taken? Yes No

If Yes, proposed zone: _____

AFFIDAVIT

The undersigned hereby affirms that the drilling, completion and eventual plugging of this well will comply with K.S.A. 55 et. seq.

It is agreed that the following minimum requirements will be met:

1. Notify the appropriate district office **prior** to spudding of well;
2. A copy of the approved notice of intent to drill **shall be** posted on each drilling rig;
3. The minimum amount of surface pipe as specified below **shall be set** by circulating cement to the top; in all cases surface pipe **shall be set** through all unconsolidated materials plus a minimum of 20 feet into the underlying formation.
4. If the well is dry hole, an agreement between the operator and the district office on plug length and placement is necessary **prior to plugging**;
5. The appropriate district office will be notified before well is either plugged or production casing is cemented in;
6. If an ALTERNATE II COMPLETION, production pipe shall be cemented from below any usable water to surface within **120 DAYS** of spud date. Or pursuant to Appendix "B" - Eastern Kansas surface casing order #133,891-C, which applies to the KCC District 3 area, alternate II cementing must be completed within 30 days of the spud date or the well shall be plugged. **In all cases, NOTIFY district office** prior to any cementing.

Submitted Electronically

For KCC Use ONLY

API # 15 - _____

Conductor pipe required _____ feet

Minimum surface pipe required _____ feet per ALT. I II

Approved by: _____

This authorization expires: _____
(This authorization void if drilling not started within 12 months of approval date.)

Spud date: _____ Agent: _____

Remember to:

- File Certification of Compliance with the Kansas Surface Owner Notification Act (KSONA-1) with Intent to Drill;
- File Drill Pit Application (form CDP-1) with Intent to Drill;
- File Completion Form ACO-1 within 120 days of spud date;
- File acreage attribution plat according to field proration orders;
- Notify appropriate district office 48 hours prior to workover or re-entry;
- Submit plugging report (CP-4) after plugging is completed (within 60 days);
- Obtain written approval before disposing or injecting salt water.
- If well will not be drilled or permit has expired (See: authorized expiration date) please check the box below and return to the address below.

Well will not be drilled or Permit Expired Date: _____
Signature of Operator or Agent:

E
 W

For KCC Use ONLY

API # 15 - _____

IN ALL CASES PLOT THE INTENDED WELL ON THE PLAT BELOW

In all cases, please fully complete this side of the form. Include items 1 through 5 at the bottom of this page.

Operator: _____

Lease: _____

Well Number: _____

Field: _____

Number of Acres attributable to well: _____

QTR/QTR/QTR/QTR of acreage: _____ - _____ - _____ - _____

Location of Well: County: _____

_____ feet from N / S Line of Section

_____ feet from E / W Line of Section

Sec. _____ Twp. _____ S. R. _____ E W

Is Section: Regular or Irregular

If Section is Irregular, locate well from nearest corner boundary.

Section corner used: NE NW SE SW

PLAT

Show location of the well. Show footage to the nearest lease or unit boundary line. Show the predicted locations of lease roads, tank batteries, pipelines and electrical lines, as required by the Kansas Surface Owner Notice Act (House Bill 2032). You may attach a separate plat if desired.

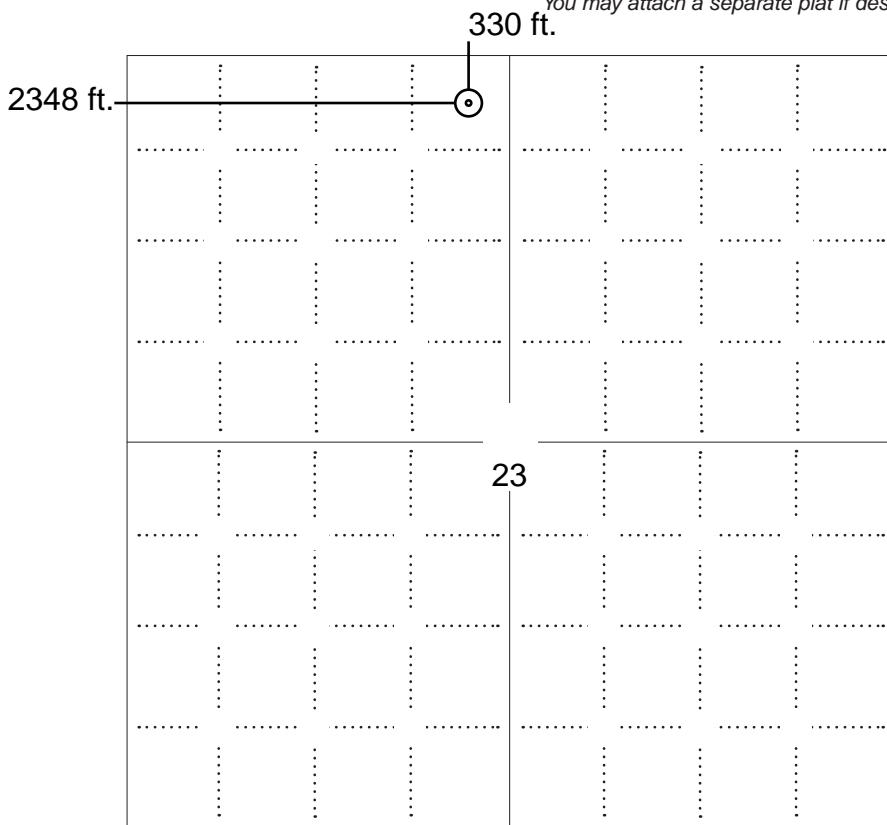

LEGEND

- Well Location
- Tank Battery Location
- Pipeline Location
- - - - Electric Line Location
- ▬ Lease Road Location

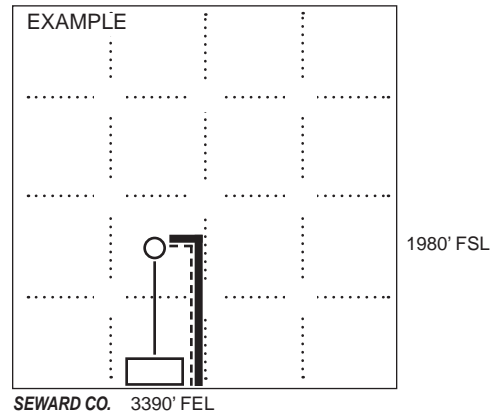

NOTE: In all cases locate the spot of the proposed drilling locaton.

In plotting the proposed location of the well, you must show:

1. The manner in which you are using the depicted plat by identifying section lines, i.e. 1 section, 1 section with 8 surrounding sections, 4 sections, etc.
2. The distance of the proposed drilling location from the south / north and east / west outside section lines.
3. The distance to the nearest lease or unit boundary line (in footage).
4. If proposed location is located within a prorated or spaced field a certificate of acreage attribution plat must be attached: (C0-7 for oil wells; CG-8 for gas wells).
5. The predicted locations of lease roads, tank batteries, pipelines, and electrical lines.

KANSAS CORPORATION COMMISSION
OIL & GAS CONSERVATION DIVISION

Form CDP-1
May 2010
Form must be Typed

APPLICATION FOR SURFACE PIT

Submit in Duplicate

Operator Name: _____		License Number: _____	
Operator Address: _____			
Contact Person: _____		Phone Number: _____	
Lease Name & Well No.: _____		Pit Location (QQQQ): _____-_____-_____-_____	
Type of Pit: <input type="checkbox"/> Emergency Pit <input type="checkbox"/> Burn Pit <input type="checkbox"/> Settling Pit <input type="checkbox"/> Drilling Pit <input type="checkbox"/> Workover Pit <input type="checkbox"/> Haul-Off Pit <i>(If WP Supply API No. or Year Drilled)</i>		Pit is: <input type="checkbox"/> Proposed <input type="checkbox"/> Existing If Existing, date constructed: _____ Pit capacity: _____ (bbls)	
Is the pit located in a Sensitive Ground Water Area? <input type="checkbox"/> Yes <input type="checkbox"/> No		Chloride concentration: _____ mg/l <i>(For Emergency Pits and Settling Pits only)</i>	
Is the bottom below ground level? <input type="checkbox"/> Yes <input type="checkbox"/> No		Artificial Liner? <input type="checkbox"/> Yes <input type="checkbox"/> No	
How is the pit lined if a plastic liner is not used? _____			
Pit dimensions (all but working pits): _____ Length (feet) _____ Width (feet) <input type="checkbox"/> N/A: Steel Pits Depth from ground level to deepest point: _____ (feet) <input type="checkbox"/> No Pit			
If the pit is lined give a brief description of the liner material, thickness and installation procedure.		Describe procedures for periodic maintenance and determining liner integrity, including any special monitoring.	
Distance to nearest water well within one-mile of pit: _____ feet Depth of water well _____ feet		Depth to shallowest fresh water _____ feet. Source of information: <input type="checkbox"/> measured <input type="checkbox"/> well owner <input type="checkbox"/> electric log <input type="checkbox"/> KDWR	
Emergency, Settling and Burn Pits ONLY: Producing Formation: _____ Number of producing wells on lease: _____ Barrels of fluid produced daily: _____ Does the slope from the tank battery allow all spilled fluids to flow into the pit? <input type="checkbox"/> Yes <input type="checkbox"/> No		Drilling, Workover and Haul-Off Pits ONLY: Type of material utilized in drilling/workover: _____ Number of working pits to be utilized: _____ Abandonment procedure: _____ _____ Drill pits must be closed within 365 days of spud date.	
Submitted Electronically			

KCC OFFICE USE ONLY			
<input type="checkbox"/> Liner <input type="checkbox"/> Steel Pit <input type="checkbox"/> RFAC <input type="checkbox"/> RFAS			
Date Received: _____ Permit Number: _____ Permit Date: _____ Lease Inspection: <input type="checkbox"/> Yes <input type="checkbox"/> No			

KANSAS CORPORATION COMMISSION
OIL & GAS CONSERVATION DIVISION

Form KSONA-1
January 2014
Form Must Be Typed
Form must be Signed
All blanks must be Filled

**CERTIFICATION OF COMPLIANCE WITH THE
KANSAS SURFACE OWNER NOTIFICATION ACT**

This form must be submitted with all Forms C-1 (Notice of Intent to Drill); CB-1 (Cathodic Protection Borehole Intent); T-1 (Request for Change of Operator Transfer of Injection or Surface Pit Permit); and CP-1 (Well Plugging Application). Any such form submitted without an accompanying Form KSONA-1 will be returned.

Select the corresponding form being filed: C-1 (Intent) CB-1 (Cathodic Protection Borehole Intent) T-1 (Transfer) CP-1 (Plugging Application)

OPERATOR: License # _____
Name: _____
Address 1: _____
Address 2: _____
City: _____ State: _____ Zip: _____ + _____
Contact Person: _____
Phone: (_____) _____ Fax: (_____) _____
Email Address: _____

Well Location:
____ - ____ - ____ - ____ Sec. ____ Twp. ____ S. R. ____ East West
County: _____
Lease Name: _____ Well #: _____
If filing a Form T-1 for multiple wells on a lease, enter the legal description of the lease below:

Surface Owner Information:

Name: _____
Address 1: _____
Address 2: _____
City: _____ State: _____ Zip: _____ + _____

When filing a Form T-1 involving multiple surface owners, attach an additional sheet listing all of the information to the left for each surface owner. Surface owner information can be found in the records of the register of deeds for the county, and in the real estate property tax records of the county treasurer.

If this form is being submitted with a Form C-1 (Intent) or CB-1 (Cathodic Protection Borehole Intent), you must supply the surface owners and the KCC with a plat showing the predicted locations of lease roads, tank batteries, pipelines, and electrical lines. The locations shown on the plat are preliminary non-binding estimates. The locations may be entered on the Form C-1 plat, Form CB-1 plat, or a separate plat may be submitted.

Select one of the following:

- I certify that, pursuant to the Kansas Surface Owner Notice Act (House Bill 2032), I have provided the following to the surface owner(s) of the land upon which the subject well is or will be located: 1) a copy of the Form C-1, Form CB-1, Form T-1, or Form CP-1 that I am filing in connection with this form; 2) if the form being filed is a Form C-1 or Form CB-1, the plat(s) required by this form; and 3) my operator name, address, phone number, fax, and email address.
- I have not provided this information to the surface owner(s). I acknowledge that, because I have not provided this information, the KCC will be required to send this information to the surface owner(s). To mitigate the additional cost of the KCC performing this task, I acknowledge that I must provide the name and address of the surface owner by filling out the top section of this form and that I am being charged a \$30.00 handling fee, payable to the KCC, which is enclosed with this form.

If choosing the second option, submit payment of the \$30.00 handling fee with this form. If the fee is not received with this form, the KSONA-1 form and the associated Form C-1, Form CB-1, Form T-1, or Form CP-1 will be returned.

I Submitted Electronically

I

COMN7VA1

BOOK 1025 PAGE 0209

Kans. - Okla. - Colo.

OIL AND GAS LEASE

THIS AGREEMENT, Entered into this 10th day of March, 2018, between, James W. VanZant and Kathryn A. VanZant, husband and wife, 22207 West Stateline Road, Braman, OK 74632, hereinafter called lessor, and Energy Partners, L.L.C., 8918 W. 21st Street North, Ste. 200, #304, Wichita, KS 67205, hereinafter called lessee, does witness:

1. That lessor, for and in consideration of the sum of Ten and More Dollars (\$10.00) in hand paid and of the covenants and agreements hereinafter contained to be performed by the lessee, has this day granted, leased, and let and by these presents does hereby grant, lease, and let exclusively unto the lessee the hereinafter described land, with any reversionary rights therein, and with the right to unitize this lease or any part thereof with other oil and gas leases as to all or any part of the lands covered thereby as hereinafter provided, for the purpose of carrying on geological, geophysical and other exploratory work thereon, including core drilling and the drilling, mining, and operating for, producing and saving all of the oil, gas, gas condensate, gas distillate, casinghead gasoline and their respective constituent vapors, and all other gases, found thereon, the exclusive right of injecting water, brine, and other fluids and substances into the subsurface strata, and for constructing roads, laying pipe lines, building tanks, storing oil, building power stations, electrical lines and other structures thereon necessary or convenient for the economical operation of said land, to produce, save, take care of, and manufacture all of such substances, and the injection of water, brine, and other substances into the subsurface strata, said tract of land being situated in the County of Kansas, State of Kansas, and described as follows:

The North Half of the Northwest Quarter (N2NW4) of Section 23, Township 34 South, Range 1 West

containing 77.10 acres, more or less.

- This lease shall remain in force for a term of three (3) years (called "primary term") and as long thereafter as oil, gas, casinghead gas, casinghead gasoline or any of the products covered by this lease is produced.
- The lessee shall deliver to lessor as royalty, free of cost, on the lease, or into the pipe line to which lessee may connect its wells the equal one-eighth part of all oil produced and saved from the leased premises, or at the lessee's option may pay to the lessor for such one-eighth royalty the market price at the wellhead for oil of like grade and gravity prevailing on the day such oil is run into the pipe line or into storage tanks.
- The lessee shall pay to the lessor, as a royalty, one-eighth (1/8th) of the proceeds received by the lessee from the sale of gas, gas condensate, gas distillate, casinghead gas, gas used for the manufacture of gasoline or any other product, and all other gases, including their constituent parts, produced from the land herein leased. If such gas is not sold by the lessee, lessee may pay or tender annually at or before the end of each yearly period during which such gas is not sold, as a shut-in royalty, whether one or more wells, an amount equal to one dollar per net mineral acre, and while shut-in said royalty is so paid or tendered, it will be considered under all provisions of this lease that gas is being produced in paying quantities. The first yearly period during which such gas is not sold shall begin on the date the first well is completed for production of gas.
- This lease is a paid-up lease and may be maintaining during primary term without further payments or drilling operations.
- In the event said lessor owns a less interest in the above described land than the entire and undivided fee simple estate therein then the royalties herein provided for shall be paid to said lessor only in the proportion which his interest bears to the whole and undivided fee; however, in the event the title to any interest in said land should revert to lessor, or his heirs, or his or their grantee, this lease shall cover such reversion.
- The lessee shall have the right to use, free of cost, gas and oil; water from existing wells or ponds of the lessor may only be used upon written permission of lessor. When required by lessor, the lessee shall bury its pipe lines below plow depth and shall pay for damage caused by its operations on said land. No well shall be drilled nearer than 200 feet to the house or barn now on said premises without written consent of the lessor. Lessee shall have the right at any time during, or after the expiration of the lease to remove all machinery fixtures, houses, buildings and other structures placed on said premises, including the right to draw and remove all casing.
- If the estate of either party hereto is assigned (and the privilege of assigning in whole or in part is expressly allowed), the covenants hereof shall extend to the heirs, devisees, executors, administrators, successors, and assigns, but no change or division in ownership of the land, or royalties, however accomplished, shall operate to enlarge the obligations or diminish the rights of lessee, and no change of ownership in the land or in the royalties or any sum due under this lease shall be binding on the lessee until it has been furnished with either the original recorded instrument of conveyance or a duly certified copy thereof, or a certified copy of the will of any deceased owner and of the probate thereof, or certified copy of the proceedings showing appointment of an administrator of the estate of any deceased owner, whichever is appropriate together with all original recorded instruments of conveyance or duly certified copies thereof necessary in showing a complete chain of title back to lessor of the full interest claimed, and all advance payments of rentals made hereunder before receipt of said documents shall be binding on any direct or indirect assignee, grantee, devisee, or administrator, executor, or heir of lessor.
- Lessor hereby warrants and agrees to defend the title to the land herein described and agrees that the lease, at its option, may pay and discharge in whole or in part any taxes, mortgages or other liens existing, levied, or assessed on or against the above described lands and, in event it exercises such options it shall be subrogated to the rights of any holder or holders thereof and may reimburse itself by applying to the discharge of any such mortgage tax or other lien, any royalty accruing hereunder.
- If after the expiration of the primary term, production of oil or gas should cease from any cause, this lease shall not terminate if lessee commences additional drilling or well reworking operations within one hundred-twenty (120) days thereafter, or if as the expiration of the primary term, oil or gas is not being produced on said land, but lessee is then engaged in drilling or well reworking operations thereon, then in either event, this lease shall remain in force so long as operations are prosecuted either on the same well or any other well thereafter commenced with no cessation of more than one hundred-twenty(120) consecutive days, and if they result in production of oil or gas, this lease shall remain in effect so long thereafter as there is production of oil or gas under any provision of this lease.
- Lessee may at any time surrender or cancel this lease in whole or in part by delivering or mailing such release to the lessor, or by placing same of record in the proper county. In case said lease is surrendered and canceled as to only a portion of the acreage covered thereby, then all payments and liabilities thereafter accruing under the terms of said lease as to the portion canceled shall cease and determine, but as to the portion of the acreage not released the terms and provisions of this lease shall continue and remain in full force and effect for all purposes.
- All provisions hereof, express or implied, shall be subject to all federal and state laws and the orders, rules, or regulations (and interpretations thereof) of all governmental agencies administering the same, and this lease shall not be in any way terminated wholly or partially nor shall the lessee be liable in damages for failure to comply with any of the express or implied provisions hereof if such failure accords with any such laws, orders, rules or regulations (or interpretations thereof). If lessee should be prevented during the last six months of the primary term hereof from drilling a well hereunder by the order of any constituted authority having jurisdiction thereof, the primary term of this lease shall continue until six months after said order is suspended.
- Lessee, at its option, is hereby given the right and power to pool or combine into one or more units the land covered by this lease, or any portion thereof, with other land covered by another lease, or leases when, in lessee's judgment, it is necessary or advisable to do so in order to properly develop and operate said lease premises so as to promote the conservation of such minerals in and under said land, such pooling to be in a unit or units not exceeding 40 acres each in the event of an oil well, or into a unit or units not exceeding 640 acres each in the event of a gas and/or condensate or distillate well, plus a tolerance of ten percent (10%) to conform to Governmental Survey quarter sections. Lessee shall execute in writing and file for record in the county in which the land is situated an instrument identifying and describing the pooled acreage. The entire acreage so pooled into a unit or units shall be treated for all purposes, except the payments of royalties on production from the pooled unit, as if it were included in this lease. If production is found on any part of the pooled acreage it shall be treated as if production is had from this lease whether any well is located on the land covered by this lease or not. Any well drilled on any such unit shall be and constitute a well hereunder. In lieu of the royalties elsewhere herein specified lessor shall receive on production from the unit so pooled only such portion of the royalty stipulated herein as the amount of his net royalty interest therein on an acreage basis bears to the total mineral acreage so pooled in the particular unit involved.
- This lease and all its terms, conditions, and stipulations shall extend to and be binding on all successors of said lessor and lessee.

See Exhibit "A" Attached hereto and made a part hereof.

IN WITNESS WHEREOF, we sign the day and year first above written.

James W. VanZant
James W. VanZant

Kathryn A. VanZant
Kathryn A. VanZant

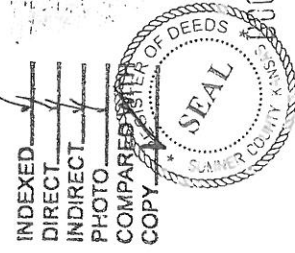

INDEXED
DIRECT
INDIRECT
PHOTO
COMPARED
COPY
State of Kansas, Sumner County SS:
Filed for record on the 10th day of March, 2018 A.D. at 8:00 o'clock P.M. and recorded in photo Book 1025 at page 209 fees \$ 3.00

BOOK 1025 PAGE 0209

ACKNOWLEDGEMENT FOR INDIVIDUAL (Kans., Okla., and Colo.)

STATE OF KANSAS)
)
COUNTY OF Seawea) ss.

April Before me, the undersigned, a Notary Public, within and for said county and state on this 19th day of March, 2018, personally appeared James W. VanZant and Kathryn A. VanZant, husband and wife, to me personally known to be the identical person(s) whom executed the within and foregoing instrument and acknowledged to me that they executed the same as their free and voluntary act and deed for the uses and purpose therein set forth. IN WITNESS WHEREOF, I have hereunto set my hand and official seal the day and year last above written.

My commission expires 7-24-18

[Signature]

Notary Public

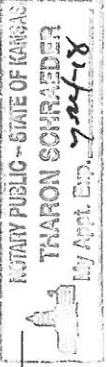

ACKNOWLEDGMENT FOR CORPORATION

STATE OF KANSAS)
)
COUNTY OF _____) ss.

On this _____ day of October, A.D., 2018, before me, the undersigned, a Notary Public in and for the county and state aforesaid, personally appeared _____, to me personally known to be the identical person who signed the name of the maker thereof to the within and foregoing instrument and acknowledged to me that _____ executed the same as _____ free and Voluntary act and deed, and as the free and voluntary act and deed of said corporation, for the uses and purposes therein set forth.

Given under my hand and seal the day and year last above written.

My commission expires _____

Notary Public

EXHIBIT "A"

Attached to and made a part of that certain Oil and Gas Lease dated ~~March~~ ^{April} 19~~th~~, 2018, by and between James W. VanZant and Katheryn A. VanZant, husband and wife, as Lessor to Energy Partners, L.L.C., as Lessee, covering the North Half of the Northwest Quarter (N2NW4) of Section 23, Township 34 South, Range 01 West, Sumner County, Kansas.

1. Lessee is hereby granted the option, but not the obligation, at any time prior to the expiration of the primary term of this lease, to extend the primary term of this lease for Three (3) years by the sum of the same amount paid for the primary term of this lease for the lands covered by this lease. This option may be exercised by Lessee by tender of said sum by check or draft payable to Lessor, delivered to Lessor or deposited in the United States mail, postage prepaid, addressed to Lessor. Upon the clearance of such check or draft and the receipt of good funds by Lessor, such tender, the primary term of this lease shall be automatically extended by said years, to the tenor and effect as if said extended term had been originally expressed in this lease; subject, however, in all other respects, to the provisions and conditions of this lease.
2. ~~The undersigned hereby gives permission to Energy Partners, L.L.C., and/or its assigns to enter the above described property with the necessary seismograph equipment for the purpose of conducting a seismic survey. Energy Partners, L.L.C. and/or its assigns shall conduct all operations in a careful, diligent, workmanlike manner. Necessary line clearance and tree trimming is authorized. Energy Partners, L.L.C. will not conduct seismic surveying on leased property at a time when rain or moisture has rendered the surface of the ground susceptible to deep tire tracks or ruts. Energy Partners, L.L.C. will use its best efforts to protect the integrity of the surface of said lease in as near as reasonably possible to its current condition.~~
3. Lessee will consult with Lessor to determine the best path for ingress and egress and to best protect the lands as to cause as little interference as reasonably possible to landowners and or tenants operations and use for living, farming, and ranching.
4. In granting permission to Energy Partners, L.L.C. and/or its assigns, Energy Partners, L.L.C. and/or its assigns agrees to protect and hold harmless Lessor from any claims and damages that may result from this work. Energy Partners, L.L.C. and/or its assigns shall pay to Lessor and/or its Fee Tenant, crop damage fees commensurate with current crop values at time of said damage; total fee to be paid by check or draft within 10 days following conclusion of said survey.

I certify that I have the legal right to grant Energy Partners, L.L.C. permission to conduct seismic operations across the premises described herein and agree to the conditions of this general survey request.

Signed for Identification:

James W. VanZant

Katheryn A. VanZant

For KCC Use ONLY

API # 15 - _____

IN ALL CASES PLOT THE INTENDED WELL ON THE PLAT BELOW

In all cases, please fully complete this side of the form. Include items 1 through 5 at the bottom of this page.

Operator: ENERGY PARTNERS, LLC
 Lease: VANZANT
 Well Number: 1
 Field: MIRT EAST

Number of Acres attributable to well: _____
 QTR/QTR/QTR/QTR of acreage: _____ - NE - NE - NW

Location of Well: County: SUMNER
 _____ 330 _____ feet from N / S Line of Section
 _____ 2348 _____ feet from E / W Line of Section
 Sec. 23 Twp. 34 S. R. 1 E W

Is Section: Regular or Irregular

If Section is Irregular, locate well from nearest corner boundary.

Section corner used: NE NW SE SW

PLAT

Show location of the well. Show footage to the nearest lease or unit boundary line. Show the predicted locations of lease roads, tank batteries, pipelines and electrical lines, as required by the Kansas Surface Owner Notice Act (House Bill 2032). You may attach a separate plat if desired.

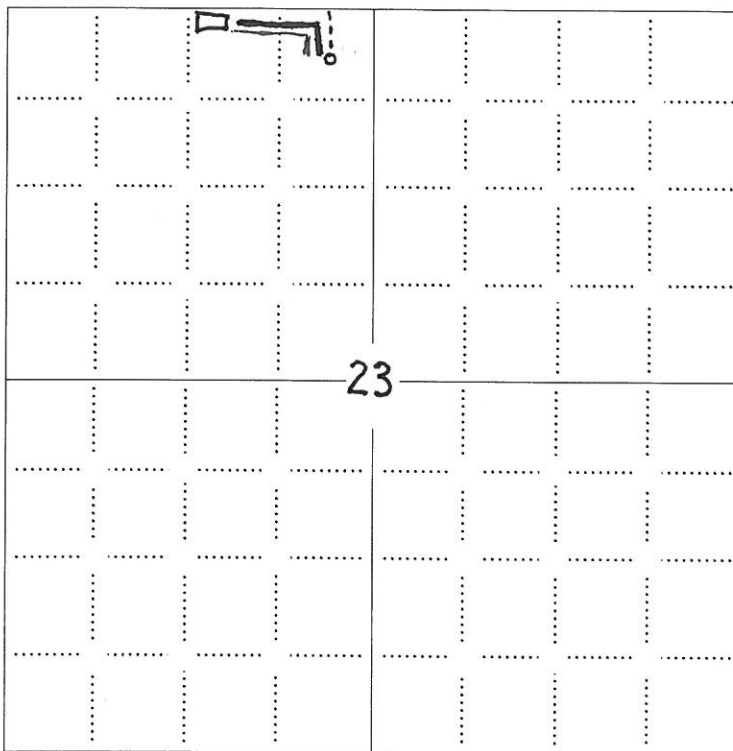

LEGEND

- Well Location
- Tank Battery Location
- Pipeline Location
- Electric Line Location
- Lease Road Location

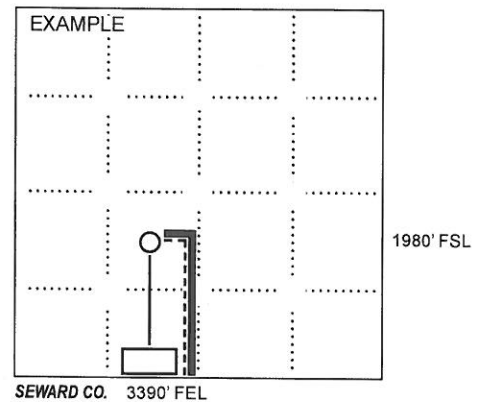

NOTE: In all cases locate the spot of the proposed drilling locaton.

In plotting the proposed location of the well, you must show:

1. The manner in which you are using the depicted plat by identifying section lines, i.e. 1 section, 1 section with 8 surrounding sections, 4 sections, etc.
2. The distance of the proposed drilling location from the south / north and east / west outside section lines.
3. The distance to the nearest lease or unit boundary line (in footage).
4. If proposed location is located within a prorated or spaced field a certificate of acreage attribution plat must be attached: (CO-7 for oil wells; CG-8 for gas wells).
5. The predicted locations of lease roads, tank batteries, pipelines, and electrical lines.

NOTICE

Nearest Lease or Unit Boundary Line

K.A.R. 82-3-108 provides that all oil and gas well locations must comply with setback requirements, unless an exception has been granted by the Commission. Depending upon whether the subject well is an oil well or gas well, and also depending upon the county in which the well is located, the setback may be 330 feet or 165 feet from the nearest lease or unit boundary.

This Intent to Drill (“C-1”) form indicates that the distance between the well and the nearest lease or unit boundary will comply with the setback requirement. Accordingly, the C-1 has been approved. However, the C-1 also stated that the well location is very near a boundary line of a Section or a Quarter-Section. This notice is being sent as a courtesy reminder, in case an error was made on the C-1.

As the operator of the proposed well, you must independently verify that the proposed well location complies with the applicable regulatory setback. If at any time it should appear that a well does not comply with the regulatory setback, the well may be subject to being shut-in pending Commission approval of an application for a well location exception. In addition, if such an application is not granted by the Commission, you may be required to plug the well.

If the proposed well location will comply with the regulatory setback, this notice may be disregarded. Please contact the KCC Production Department with any questions or concerns.



Conservation Division
266 N. Main St., Ste. 220
Wichita, KS 67202-1513

Phone: 316-337-6200
Fax: 346-337-6211
<http://kcc.ks.gov/>

Dwight D. Keen, Chair
Shari Feist Albrecht, Commissioner
Jay Scott Emler, Commissioner

Laura Kelly, Governor

March 22, 2019

Jay Ablah
Energy Partners, LLC
8918 WEST 21ST STREET NORTH #200-304
WICHITA, KS 67205

Re: Drilling Pit Application
VanZant 1
NW/4 Sec.23-34S-01W
Sumner County, Kansas

Dear Jay Ablah:

District staff has inspected the above referenced location and has determined that the reserve pit shall be constructed **without slots**, the bottom shall be flat and reasonably level and the free fluids must be removed. The fluids are to be removed from the reserve pit as soon as the Hutchinson Salt section has been drilled through and displacement of the fluids into the reserve pit has occurred. The fluids should be removed again within 72 hours after drilling operations have ceased.

KEEP PITS away from draw/drainage.
KEEP PITS on south side of stake.

If production casing is set all completion fluids shall be removed from the working pits daily. NO completion fluids or non-exempt wastes shall be placed in the reserve pit.

The fluids should be taken to an authorized disposal well. Please call the District Office at (316) 337-7400 when the fluids have been removed. Please file form CDP-5 (August 2008), Exploration and Production Waste Transfer, through KOLAR within 30 days of fluid removal.

A copy of this letter should be posted in the doghouse along with the approved Intent to Drill. If you have any questions or concerns please feel free to contact the District Office at (316) 337-7400.