

H & B PETROLEUM CORPORATION
 SALEM LEASE
 SE.1/4, SECTION 6, T21S, R12W
 STAFFORD COUNTY, KANSAS

SAND (NE. 210TH ST.) ROAD

Notes:

1. Set wood stake at location site.
2. All flagging Red & Yellow.
3. Overhead power available at E. line, W.1/4 of S. line and S.1/4 of W. line, Sec.6.
4. Kansas One Call System Inc. should be notified before excavation (1-800-344-7233).
5. CAUTION; Various pipelines in Sec.6.
6. Contact landowner for best access.
7. Location fell in heavy trees on 6/27/18, set temporary point at site. Returned on 8/2/18 after the clearing of trees to set location.

SAND (NE. 30TH AVE.) ROAD

ROAD (NE. 40TH AVE.) PAVED

Drillsite Location
 Salem #1
 330'FSL 1382'FEL
 Ground Elevation = 1857

Y = 575531 X = 1948565

State Plane-NAD 27-Kansas South
 Latitude 38.24711
 Longitude -98.67951
 WGS 84-NAD 83

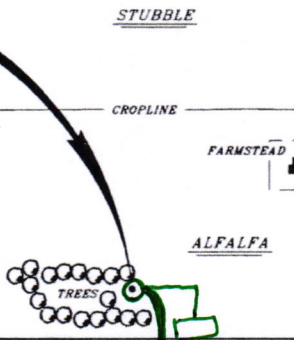

SAND (NE. 200TH ST.) ROAD

* Ingress and egress to location as shown on this plat is for usage only and may not be legally opened for public use. Contact landowner, tenant and county road department for access.

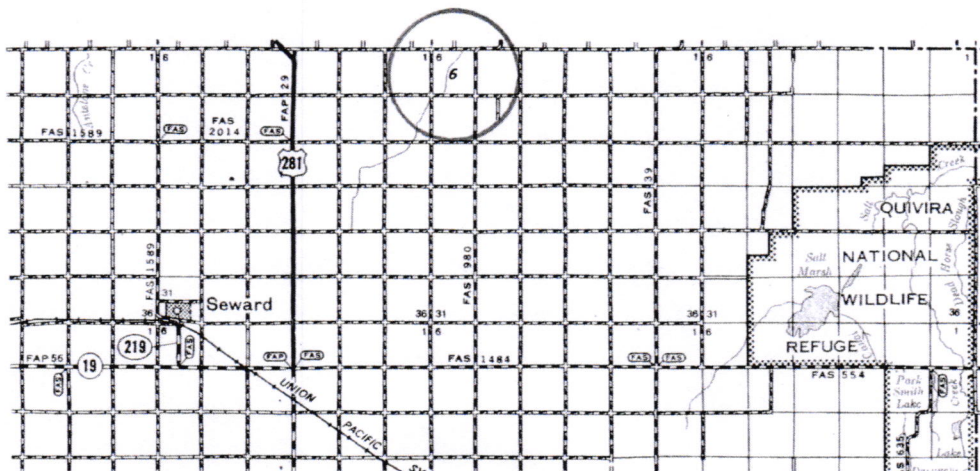
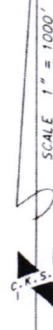

• Controlling data is based upon the best maps and photographs available to us and upon a regular section of land containing 360 acres.
 • Approximate section lines were determined using the normal standard of care of oilfield surveyors practicing in the state of Kansas. The section corners, which establish the precise section lines, were not necessarily located, and the exact location of the drillsite location in the section is not guaranteed. Therefore, the operator securing this service and accepting this plat and all other parties relying thereon agree to hold Central Kansas Oilfield Services, Inc., its officers and employees harmless from all losses, costs and expenses and said entities released from any liability from incidental or consequential damages.
 • Elevations derived from National Geodetic Vertical Datum.

Date August 2, 2018

CENTRAL KANSAS OILFIELD SERVICES, INC. (620)792-1977