

Mull Drilling Company, Inc.  
Proposed Location of Roads, Lines and Tank Battery

Well Name:	Phillips #1-20
Well Location:	2250' FSL & 779' FWL
	Section 20-T24S-R23W
	Hodgeman County, KS



North

Southwest Quarter of Section 20, Township 24 South, Range 23 West

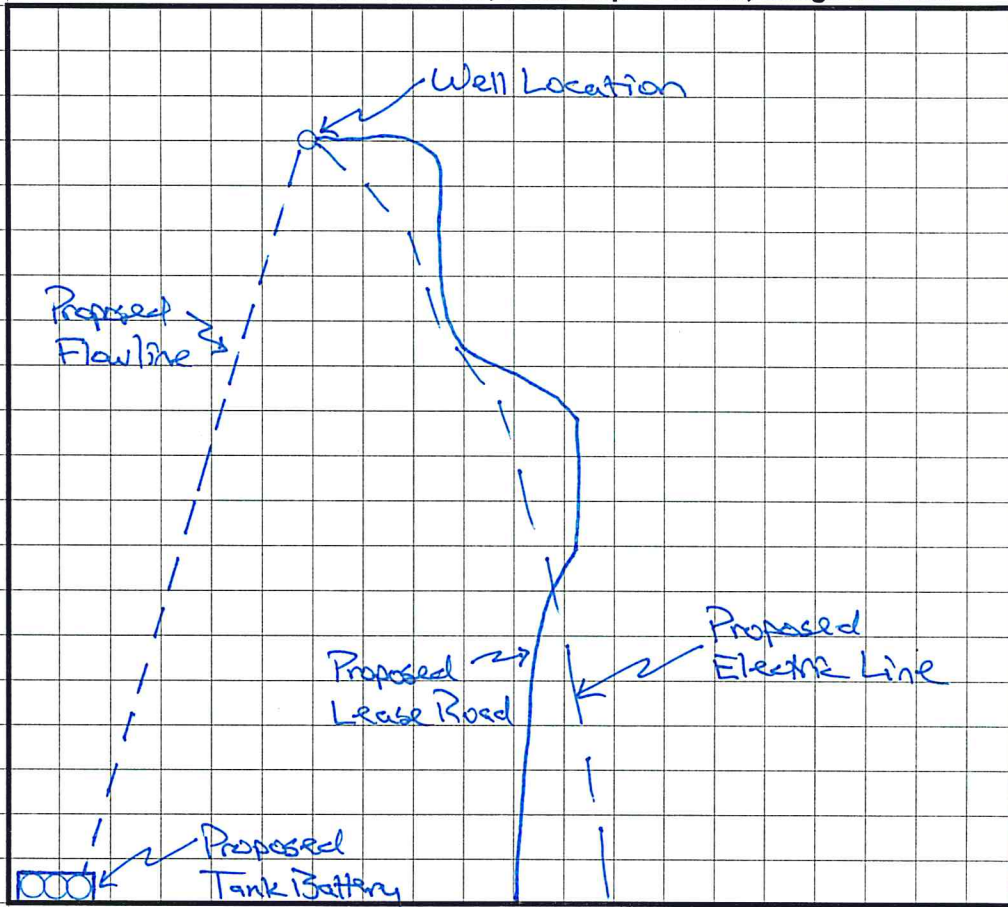

County Road C

