

AMERICAN OIL, LLC  
TOWNS LEASE  
SE.1/4, SECTION 18, T9S, R20W  
ROOKS COUNTY, KANSAS

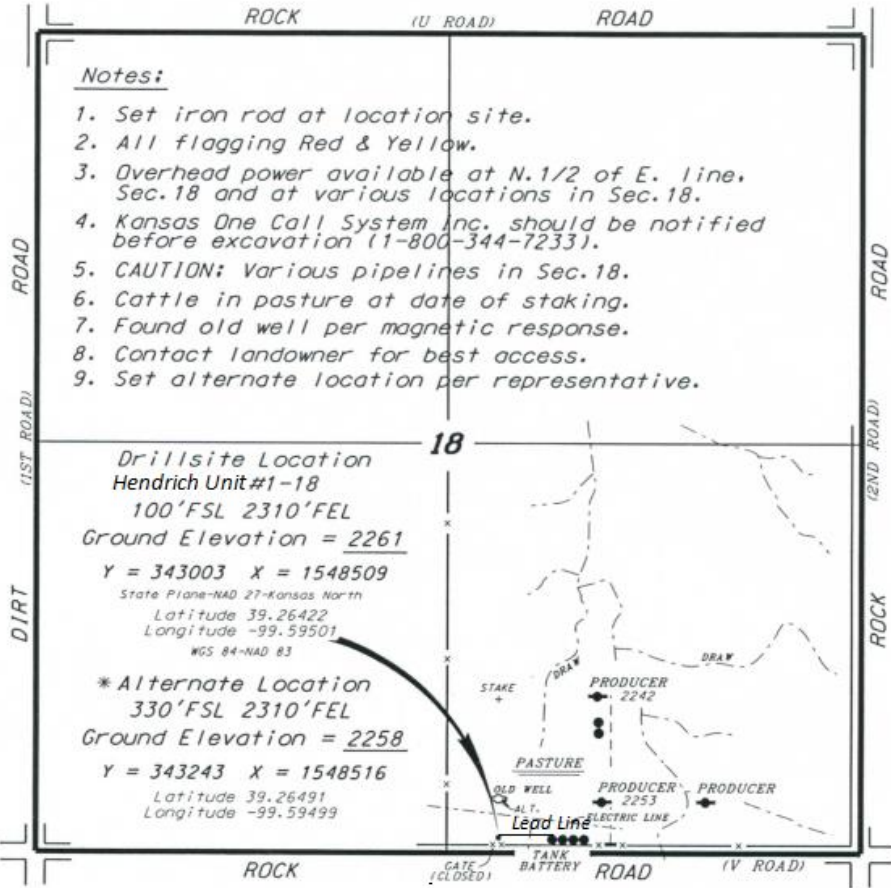

**Notes:**

1. Set iron rod at location site.
2. All flagging Red & Yellow.
3. Overhead power available at N.1/2 of E. line, Sec.18 and at various locations in Sec.18.
4. Kansas One Call System Inc. should be notified before excavation (1-800-344-7233).
5. CAUTION: Various pipelines in Sec.18.
6. Cattle in pasture at date of staking.
7. Found old well per magnetic response.
8. Contact landowner for best access.
9. Set alternate location per representative.

\* Ingress and egress to location as shown on this plat is per usage only and may not be legally opened for public use. Contact landowner, tenant and county road department for access.

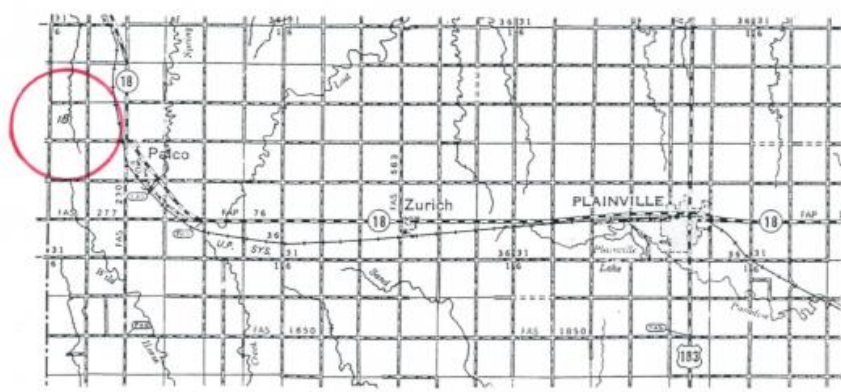

\* Controlling data is based upon the best maps and photographs available to us and upon a regular section of land containing 640 acres.