



**Fall & Associates**  
 Stake and Elevation Service  
 P.O. Box 222  
 Pretty Prairie, KS. 67570  
 785-243-7506

Date 11-27-18

Invoice Number 1124181

MURFIN DRILLING	1-12			CWA 'F'
Operator	Number			Farm Name
Cheyenne-KS	12	2s	37w	1800'FSL 330'FWL
County-State	S	T	R	Location

Murfin Drilling  
 250 N. Water  
 Suite 300  
 Wichita, KS. 7202

Elevation 3387 Gr.

Ordered By: Shauna

Scale 1"=1000'

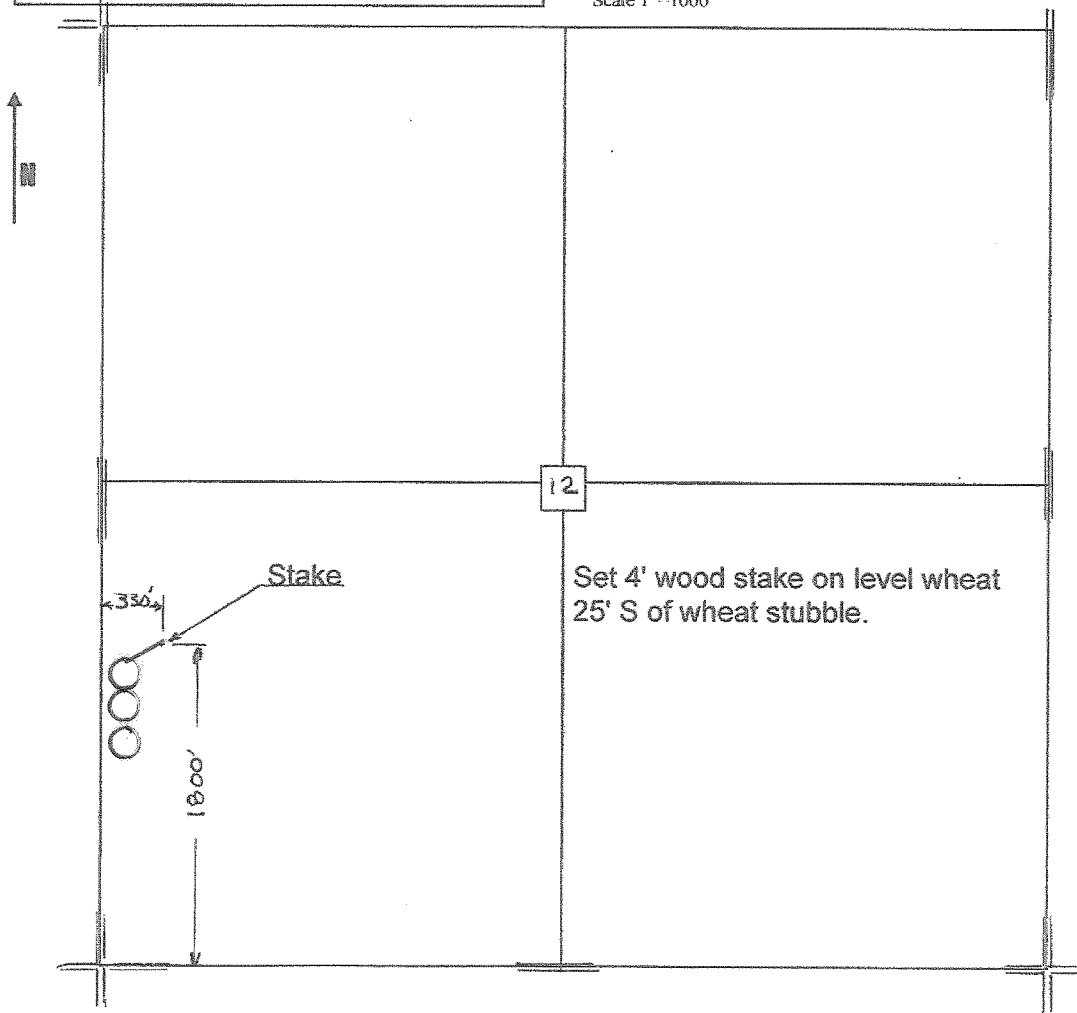

Set 4' wood stake on level wheat  
 25' S of wheat stubble.

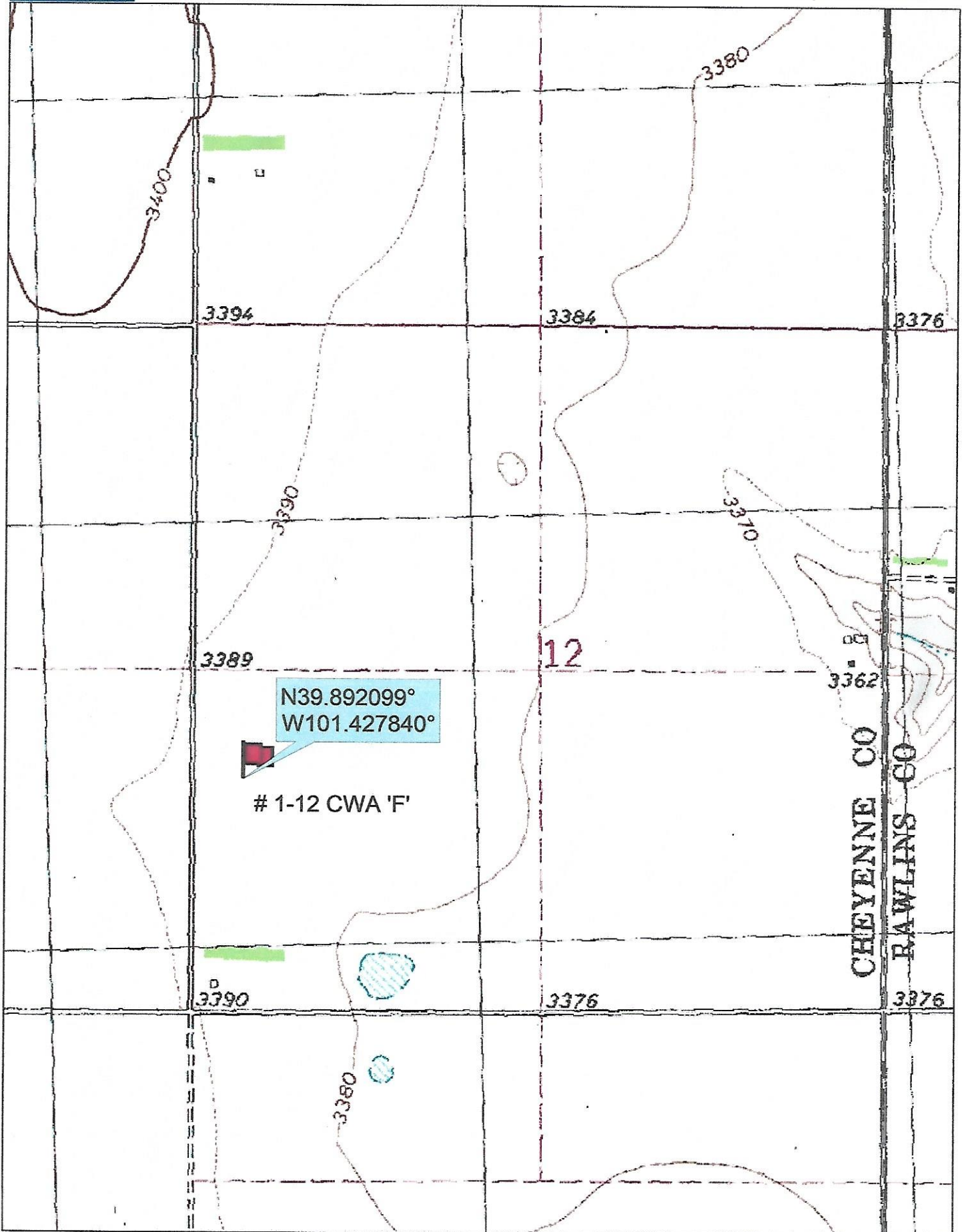

Data use subject to license.

© DeLorme. Topo North America™ 9.

www.delorme.com

