

Proposed Plan of Construction
River Bend 8
Sec 34 T24S-R32W
Finney County, KS

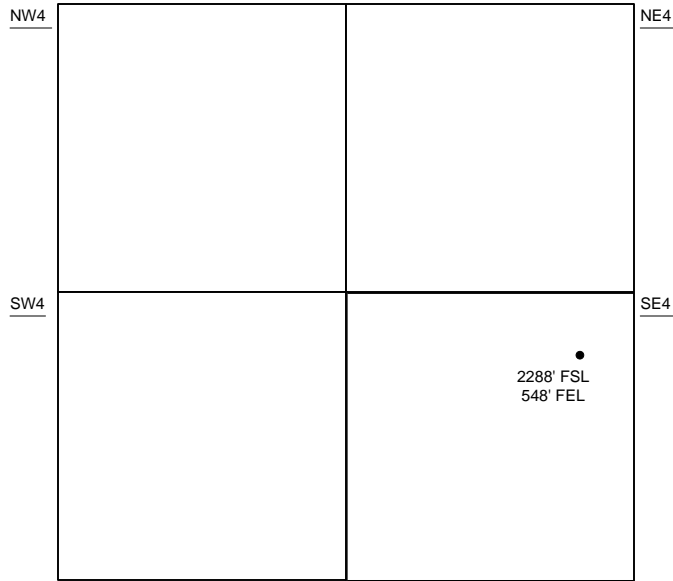

Sec 34 – T24S – R32W

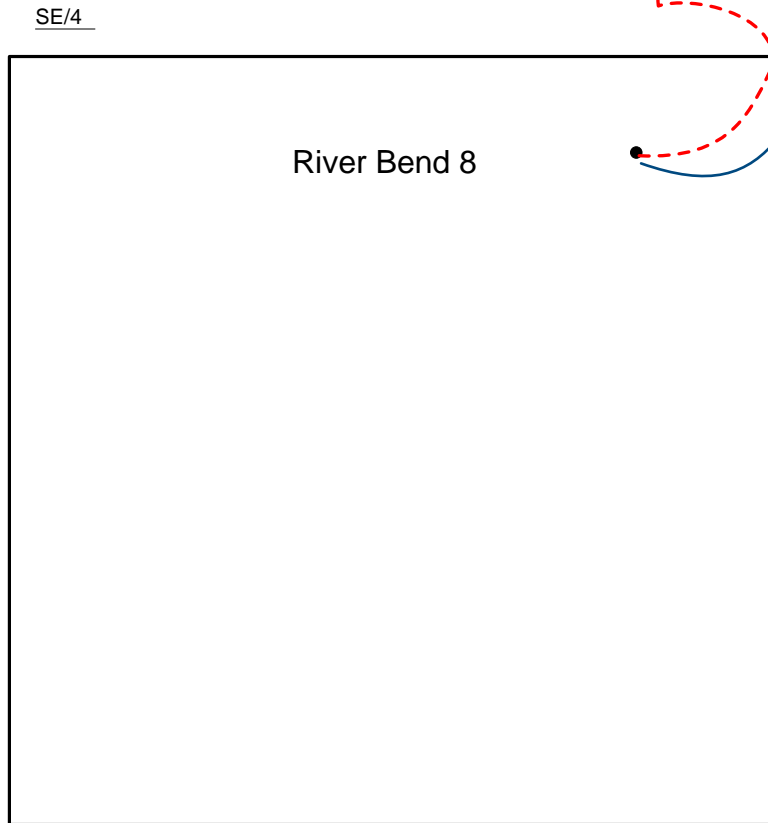

The Tank Battery for the River Bend 8 will be located NE of the well. Existing N. Pebble/River Bend tank battery.

- Well Location
- Proposed Lease Roads
- - - Proposed Pipeline
- Proposed Tank Battery
- Proposed Power Lines
- - - Existing Pipeline

Proposed Details of
SE/4 Sec 34 – T24S – R32W

Note-Drawing **Not** to Scale