

24

19

25

30

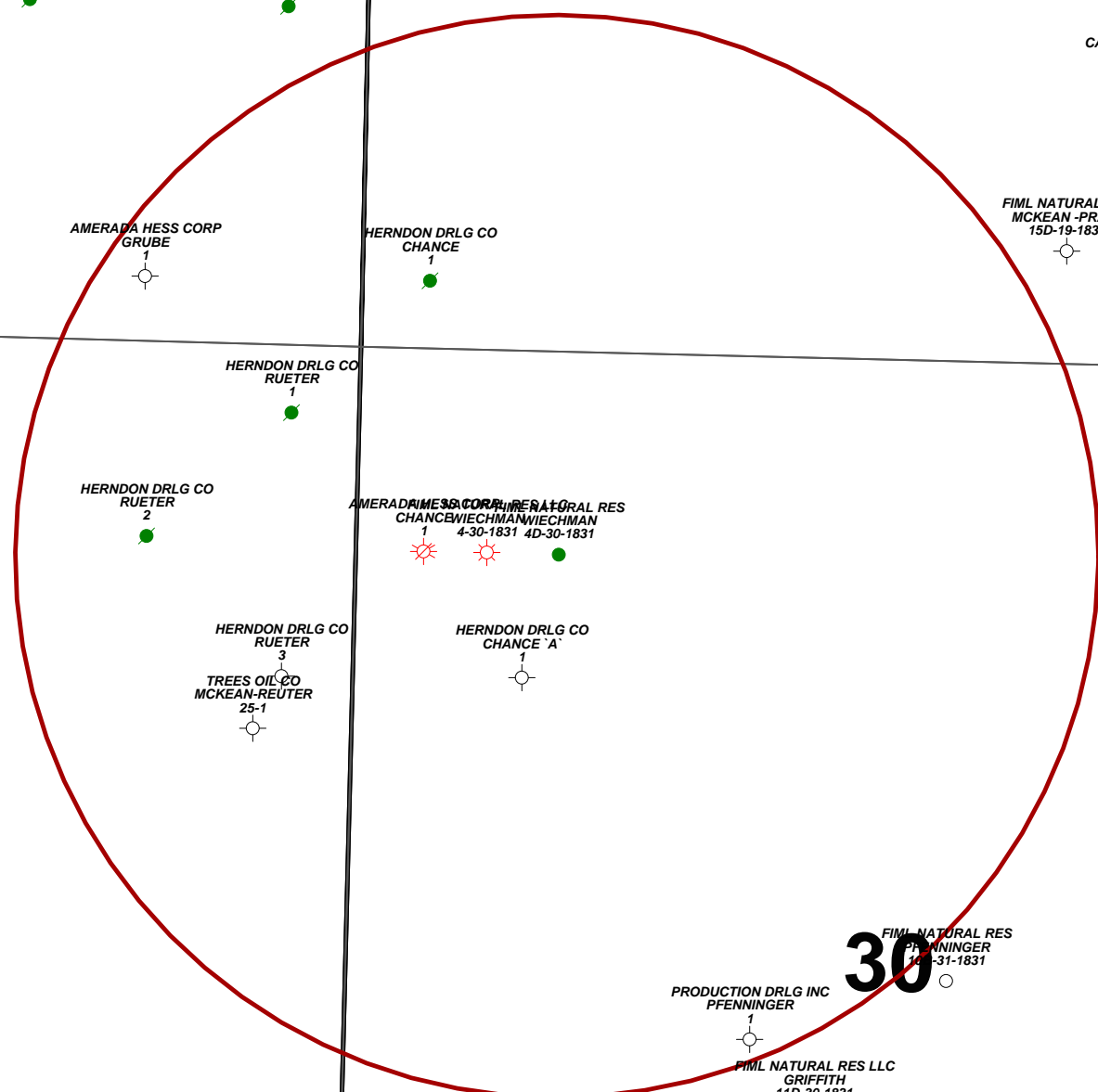

SLAWSON DONALD C
GRUBE /A/
1

BEREN CORPORATION
GRUBE 1
2

BEREN CORPORATION
GRUBE 3

BEREN CORPORATION
GRUBE 1

FIML NATURAL RES
WIECHMAN
12-19-1831

CAR REN INC
MCKEAN
1-19

FIML NATURAL RES
MCKEAN -PRATT
15D-19-1831

FIML NATURAL RES
PRATT
16-19-1831

BEREXCO INC
BECKLEY
1

AMERADA HESS CORP
GRUBE 1

HERNDON DRLG CO
CHANCE
1

HERNDON DRLG CO
RUETER
1

HERNDON DRLG CO
RUETER
2

AMERADA HESS CORPORATION
CHANCE WIECHMAN WIECHMAN
4-30-1831 4D-30-1831

FIML NATURAL
MCKEAN 1
1-30-18

FIML NATURAL RES
MCKEAN Tr
1C-30-1831

HERNDON DRLG CO
RUETER
3

TREES OIL CO
MCKEAN-RUETER
25-1

HERNDON DRLG CO
CHANCE 'A'
1

FIML Natural Resources

1/2 Mile Radius Plat

Weichman 4D-30-1831

Application to Commingle



POSTED WELL DATA

Operator
Well Name
Well Number



WELL SYMBOLS

○ Location Only

● Oil Well

☀ Gas Well

○ Dry Hole

● Plugged & Abandoned Oil Well

☀ Plugged & Abandoned Gas Well

PRODUCTION DRLG INC
PFENNINGER
1

FIML NATURAL RES LLC
GRIFFITH
11D-30-1831

FIML NATURAL RES
GRIFFITH
14A-30-1831