



APPLICATION FOR COMMINGLING OF PRODUCTION (K.A.R. 82-3-123) OR FLUIDS (K.A.R. 82-3-123a) *Commingling ID #* _____

OPERATOR: License # _____ API No. 15 - _____
Name: _____ Spot Description: _____
Address 1: _____ - - - - - Sec. _____ Twp. _____ S. R. _____ East West
Address 2: _____ Feet from North / South Line of Section
City: _____ State: _____ Zip: _____ + _____ Feet from East / West Line of Section
Contact Person: _____ County: _____
Phone: (_____) _____ Lease Name: _____ Well #: _____

1. Name and upper and lower limit of each production interval to be commingled:
Formation: _____ (Perfs): _____
Formation: _____ (Perfs): _____
Formation: _____ (Perfs): _____
Formation: _____ (Perfs): _____
Formation: _____ (Perfs): _____

2. Estimated amount of fluid production to be commingled from each interval:
Formation: _____ BOPD: _____ MCFPD: _____ BWPD: _____
Formation: _____ BOPD: _____ MCFPD: _____ BWPD: _____
Formation: _____ BOPD: _____ MCFPD: _____ BWPD: _____
Formation: _____ BOPD: _____ MCFPD: _____ BWPD: _____
Formation: _____ BOPD: _____ MCFPD: _____ BWPD: _____

3. Plat map showing the location of the subject well, all other wells on the subject lease, and all wells on offsetting leases within a 1/2 mile radius of the subject well, and for each well the names and addresses of the lessee of record or operator.

4. Signed certificate showing service of the application and affidavit of publication as required in K.A.R. 82-3-135a.

For Commingling of PRODUCTION ONLY, include the following:

- 5. Wireline log of subject well. Previously Filed with ACO-1: Yes No
- 6. Complete Form ACO-1 (*Well Completion form*) for the subject well.

For Commingling of FLUIDS ONLY, include the following:

- 7. Well construction diagram of subject well.
- 8. Any available water chemistry data demonstrating the compatibility of the fluids to be commingled.

AFFIDAVIT: I am the affiant and hereby certify that to the best of my current information, knowledge and personal belief, this request for commingling is true and proper and I have no information or knowledge, which is inconsistent with the information supplied in this application.

Submitted Electronically

KCC Office Use Only
 Denied Approved
15-Day Periods Ends: _____
Approved By: _____ Date: _____

Protests may be filed by any party having a valid interest in the application. Protests must be in writing and comply with K.A.R. 82-3-135b and must be filed within 15 days of publication of the notice of application.

AFFIDAVIT OF NOTICE SERVED

RE: Application for Commingling of Production

Well Name: Phillip #2-26

Legal Location: SW/NW/NE/NW Section 26-13S-31W, Gove County, Kansas

The undersigned hereby certifies that he/she is a duly authorized agent for the applicant, and that on the 22nd day of August, 2012, a true and correct copy of the application referenced above was delivered or mailed to the following parties:

Ritchie Exploration, Inc., 8100 E. 22nd North, Bldg 700, Wichita, KS 67226
Shakespeare Oil Company, Inc., 202 W. Main, Salem, IL 62881
Grand Mesa Operating Company, 1700 N. Waterfront Pkwy, B600,
Wichita, KS 67206-5514

I further attest that notice of the filing of this application was published in **The Gove County Advocate**, the official county publication of **Gove County, Kansas** and the **Wichita Eagle**, Wichita, Kansas. Copies of these affidavits of publication are attached.

Signed this 22nd day of August, 2012.

~~GRAND MESA OPERATING COMPANY~~

Applicant of Duly Authorized Agent: _____

Ronald N. Sinclair, President

Subscribed and sworn to before me this 22nd day of August, 2012.

Notary Public: _____

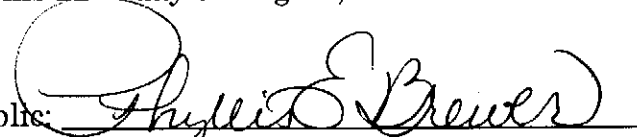
Phyllis E. Brewer, Notary Public
11817 W. Jamesburg St.
Wichita, KS 67212

My Commission Expires: July 21, 2015

BEFORE THE STATE CORPORATION COMMISSION
OF THE STATE OF KANSAS
NOTICE OF FILING APPLICATION

RE: Grand Mesa Operating Company, License #9855– Application for a commingling of production for the Phillip #2-26, located in Gove County, Kansas.

TO: All Oil & Gas Producers, Unleased Mineral Interest Owners, Landowners and all persons concerned.

You, and each of you, are hereby notified that Grand Mesa Operating Company – has filed an application for commingling production or fluids from the Lansing and the Ft. Scott Formations. The subject well, the Phillip #2-26, is located 344 feet from the north line and 1491 feet from the west line in the SW NW NE NW of Section 26, Township 13 South, Range 31 West, Gove County, Kansas.

Any persons who object to or protest this application shall be required to file their objections or protest with the Conservation Division of the State Corporation Commission of the State of Kansas within fifteen (15) days of the publication of this notice. These protests shall be filed pursuant to Commission regulations and must state specific reasons why granting the application may cause waste, violate correlative rights or pollute the natural resources of the State of Kansas.

All persons interested or concerned shall take notice of the foregoing and shall govern themselves accordingly.

Grand Mesa Operating Company
Ronald N. Sinclair, President
1700 N. Waterfront Pkwy, Bldg 600
Wichita, KS 67206-5514
(316) 265-3000

13S/31W

22

Ritchie Exploration, Inc.

Grand Mesa Operating

27

Grand Mesa Operating

23

Shakespeare Oil Co.

1/2 MILE

Phillip 2-26

Grand Mesa Operating

Phillip 3-26

Phillip 1-26

26

Grand Mesa Operating

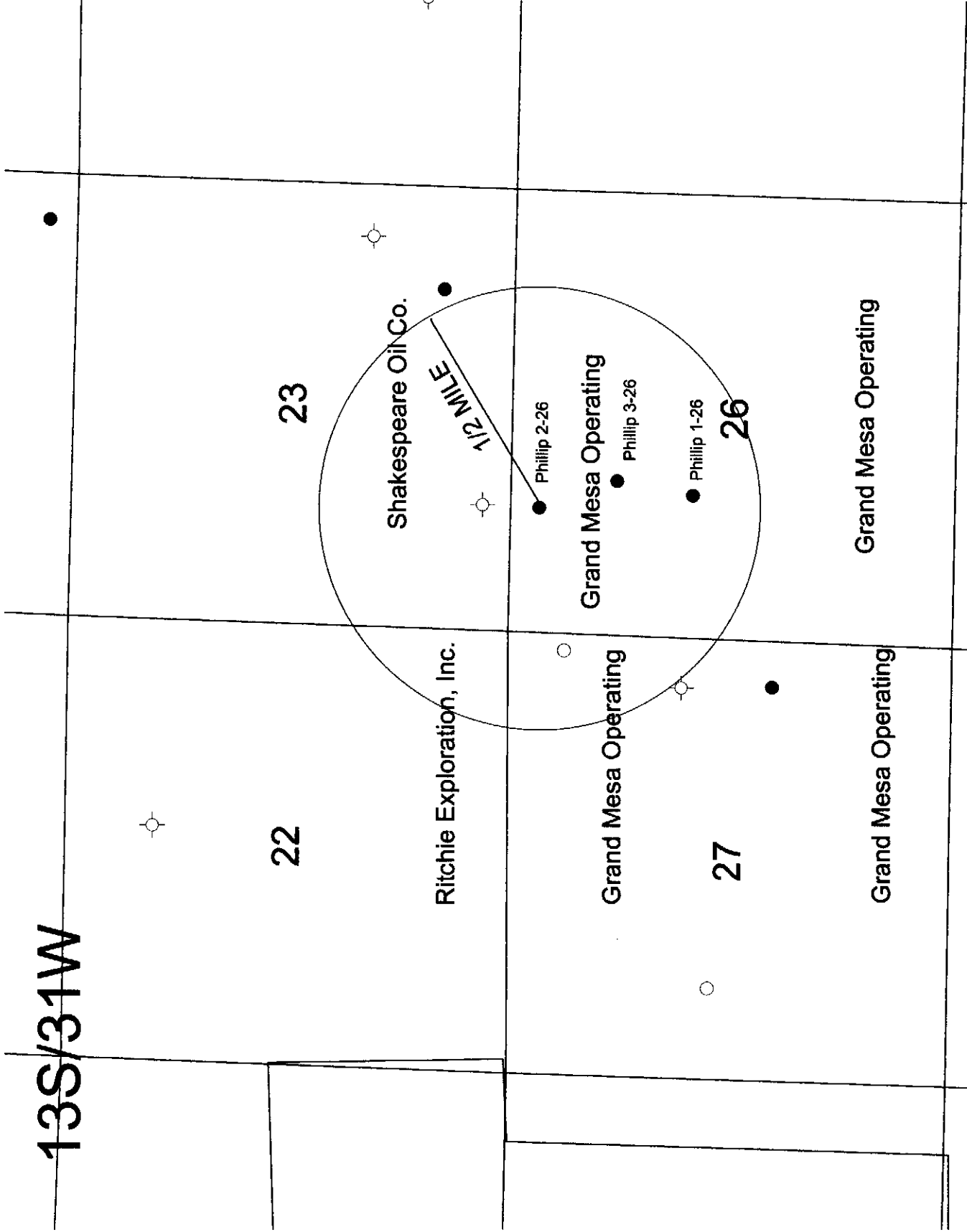



CONFIDENTIAL

WELL COMPLETION FORM

Form Must Be Typed
Form must be Signed
All blanks must be Filled

WELL HISTORY - DESCRIPTION OF WELL & LEASE

OPERATOR: License # 9855
Name: Grand Mesa Operating Company
Address 1: 1700 N WATERFRONT PKWY BLDG 600
Address 2: _____
City: WICHITA State: KS Zip: 67206 + 5514
Contact Person: Ronald N. Sinclair
Phone: (316) 265-3000
CONTRACTOR: License # 30606
Name: Murfin Drilling Co., Inc.
Wellsite Geologist: Kent R. Matson
Purchaser: NCRA

Designate Type of Completion:

- New Well Re-Entry Workover
- Oil WSW SWD SIOW
 Gas D&A ENHR SIGW
 OG GSW Temp. Abd.
 CM (Coal Bed Methane)
 Cathodic Other (Core, Expl., etc.): _____

If Workover/Re-entry: Old Well Info as follows:

Operator: _____
Well Name: _____
Original Comp. Date: _____ Original Total Depth: _____
 Deepening Re-perf. Conv. to ENHR Conv. to SWD
 Conv. to GSW
 Plug Back: _____ Plug Back Total Depth
 Commingled Permit #: _____
 Dual Completion Permit #: _____
 SWD Permit #: _____
 ENHR Permit #: _____
 GSW Permit #: _____

<u>06/06/2012</u>	<u>06/17/2012</u>	<u>07/13/2012</u>
Spud Date or Recompletion Date	Date Reached TD	Completion Date or Recompletion Date

API No. 15 - 15-063-22005-00-00
Spot Description: _____
SW_NW_NE_NW Sec. 26 Twp. 13 S. R. 31 East West
344 Feet from North / South Line of Section
1491 Feet from East / West Line of Section
Footages Calculated from Nearest Outside Section Corner:
 NE NW SE SW
County: Gove
Lease Name: PHILLIP Well #: 2-26
Field Name: Wildcat
Producing Formation: Lwr. Ft. Scott & Lansing
Elevation: Ground: 2867 Kelly Bushing: 2872
Total Depth: 4632 Plug Back Total Depth: 4609
Amount of Surface Pipe Set and Cemented at: 213 Feet
Multiple Stage Cementing Collar Used? Yes No
If yes, show depth set: 2378 Feet
If Alternate II completion, cement circulated from: 2378
feet depth to: 0 w/ 300 sx cm.

Drilling Fluid Management Plan

(Data must be collected from the Reserve Pit)

Chloride content: 8000 ppm Fluid volume: 900 bbls
Dewatering method used: Evaporated
Location of fluid disposal if hauled offsite:
Operator Name: _____
Lease Name: _____ License #: _____
Quarter _____ Sec. _____ Twp. _____ S. R. _____ East West
County: _____ Permit #: _____

AFFIDAVIT

I am the affiant and I hereby certify that all requirements of the statutes, rules and regulations promulgated to regulate the oil and gas industry have been fully complied with and the statements herein are complete and correct to the best of my knowledge.

Submitted Electronically

KCC Office Use ONLY

- Letter of Confidentiality Received
Date: 08/13/2012
 Confidential Release Date: _____
 Wireline Log Received
 Geologist Report Received
 UIC Distribution
ALT I II III Approved by: Deanna Garrison Date: 08/16/2012



1090306

Operator Name: Grand Mesa Operating Company Lease Name: PHILLIP Well #: 2-26
 Sec. 26 Twp. 13 S. R. 31 East West County: Gove

INSTRUCTIONS: Show important tops and base of formations penetrated. Detail all cores. Report all final copies of drill stems tests giving interval tested, time tool open and closed, flowing and shut-in pressures, whether shut-in pressure reached static level, hydrostatic pressures, bottom hole temperature, fluid recovery, and flow rates if gas to surface test, along with final chart(s). Attach extra sheet if more space is needed. Attach complete copy of all Electric Wire-line Logs surveyed. Attach final geological well site report.

Drill Stem Tests Taken <input checked="" type="checkbox"/> Yes <input type="checkbox"/> No <i>(Attach Additional Sheets)</i> Samples Sent to Geological Survey <input checked="" type="checkbox"/> Yes <input type="checkbox"/> No Cores Taken <input type="checkbox"/> Yes <input checked="" type="checkbox"/> No Electric Log Run <input checked="" type="checkbox"/> Yes <input type="checkbox"/> No Electric Log Submitted Electronically <input checked="" type="checkbox"/> Yes <input type="checkbox"/> No <i>(If no, Submit Copy)</i> List All E. Logs Run: Attached	<input checked="" type="checkbox"/> Log Formation (Top), Depth and Datum <input type="checkbox"/> Sample <table style="width:100%; border: none;"> <tr> <td style="width:60%; border: none;">Name Attached</td> <td style="width:20%; border: none;">Top Attached</td> <td style="width:20%; border: none;">Datum Attached</td> </tr> </table>	Name Attached	Top Attached	Datum Attached
Name Attached	Top Attached	Datum Attached		

CASING RECORD <input checked="" type="checkbox"/> New <input type="checkbox"/> Used							
Report all strings set-conductor, surface, intermediate, production, etc.							
Purpose of String	Size Hole Drilled	Size Casing Set (In O.D.)	Weight Lbs. / Ft.	Setting Depth	Type of Cement	# Sacks Used	Type and Percent Additives
Surface	12.25	8.625	24	213	Common	165	3% CC, 2% Gel
Production	7.875	5.50	15.5	4630	EA-2	175	1/4#sx Flocele

ADDITIONAL CEMENTING / SQUEEZE RECORD				
Purpose:	Depth Top Bottom	Type of Cement	# Sacks Used	Type and Percent Additives
<input type="checkbox"/> Perforate <input checked="" type="checkbox"/> Protect Casing <input type="checkbox"/> Plug Back TD <input type="checkbox"/> Plug Off Zone	0-2378	SMD	300	

Shots Per Foot	PERFORATION RECORD - Bridge Plugs Set/Type Specify Footage of Each Interval Perforated	Acid, Fracture, Shot, Cement Squeeze Record <i>(Amount and Kind of Material Used)</i>	Depth
4	4413-4418	750gals RWR-1 15% Acid w/additives	4413-4418
4	4179-4184	1,000gals HC-1 15% Acid w/additives	4413-4418

TUBING RECORD: Size: <u>2.875</u> Set At: <u>4566</u> Packer At: _____		Liner Run: <input type="checkbox"/> Yes <input checked="" type="checkbox"/> No	
Date of First, Resumed Production, SWD or ENHR: <u>07/13/2012</u>		Producing Method: <input type="checkbox"/> Flowing <input checked="" type="checkbox"/> Pumping <input type="checkbox"/> Gas Lift <input type="checkbox"/> Other (Explain) _____	
Estimated Production Per 24 Hours	Oil Bbls. <u>72</u>	Gas Mcf <u>0</u>	Water Bbls. <u>16</u>
		Gas-Oil Ratio	Gravity <u>35</u>

DISPOSITION OF GAS: <input type="checkbox"/> Vented <input type="checkbox"/> Sold <input type="checkbox"/> Used on Lease <i>(If vented, Submit ACO-18.)</i>	METHOD OF COMPLETION: <input type="checkbox"/> Open Hole <input checked="" type="checkbox"/> Perf. <input type="checkbox"/> Dually Comp. <input checked="" type="checkbox"/> Commingled <i>(Submit ACO-5) (Submit ACO-4)</i> <input type="checkbox"/> Other (Specify) _____	PRODUCTION INTERVAL: <u>4179-4184'</u> <u>4413-4418'</u>
-------------------------------------------------------------------------------------------------------------------------------------------------------------------	--------------------------------------------------------------------------------------------------------------------------------------------------------------------------------------------------------------------------------------------------------------------------------------	----------------------------------------------------------------

Form	ACO1 - Well Completion
Operator	Grand Mesa Operating Company
Well Name	PHILLIP 2-26
Doc ID	1090306

All Electric Logs Run

CPDCN Micro Log
AI Shallow Focused Elect Log
Micro Log
Dual Receiver Cmt Bnd Log

Form	ACO1 - Well Completion
Operator	Grand Mesa Operating Company
Well Name	PHILLIP 2-26
Doc ID	1090306

Tops

Bs/Stone Corral	2374	+498
Heebner	3890	-1018
Lansing	3932	-1060
Muncie Creek	4087	-1215
Stark	4170	-1298
Marmaton	4272	-1400
Little Osage	4398	-1526
Mississippian	4550	-1678
LTD	4636	



CONSOLIDATED
Oil Well Services, LLC

TICKET NUMBER 33968

LOCATION Oakley

FOREMAN Fuzzie

miles 5

PO Box 884, Chanute, KS 66720
620-431-9210 or 800-467-8676

FIELD TICKET & TREATMENT REPORT

CEMENT

KS

DATE	CUSTOMER #	WELL NAME & NUMBER	SECTION	TOWNSHIP	RANGE	COUNTY
6-6-12	3372	Phillip 2-26	26	13	31	Gove

CUSTOMER	TRUCK #	DRIVER	TRUCK #	DRIVER
Grand Mesa Operating	463	Cody R		
	429	Wes F		

CITY	STATE	ZIP CODE

Oakley
5-Gove
red
5-2-16
35-PdP
12-15

JOB TYPE Surface HOLE SIZE 12 1/4 HOLE DEPTH 213' CASING SIZE & WEIGHT 8 5/8
 CASING DEPTH 213' DRILL PIPE _____ TUBING _____ OTHER _____
 SLURRY WEIGHT 14.7 SLURRY VOLUME 1.36 WATER gal/ft 6.5 CEMENT LEFT in CASING 20'
 DISPLACEMENT 12.2 DISPLACEMENT PSI _____ MIX PSI _____ RATE _____

REMARKS: Safety meeting on margin #24. Rig up and circulate.
Mix 165sks class 'A' 390cc 290gal. Displace 12 1/4 BBL
and shut in. Cement did circulate approx 5 BBLs to pit

Thanks Fuzzie
+ crew

ACCOUNT CODE	QUANTITY or UNITS	DESCRIPTION of SERVICES or PRODUCT	UNIT PRICE	TOTAL
5405	1	PUMP CHARGE	1085 ⁰⁰	1085 ⁰⁰
5406	20	MILEAGE	5 ⁰⁰	100 ⁰⁰
5407	7.840m	Tow mileage delivery (min)	410 ⁰⁰	410 ⁰⁰
11045	165sks	Class 'A' cement	17 ⁰⁵	2912 ²⁵
1102	465#	Calcium chloride	0 ⁸⁹	413 ⁸⁵
1148	310#	Bentonite	0 ²⁵	77 ⁵⁰
		Subtotal		4998 ⁰⁰
		less 1090		499 ⁸⁰
		Subtotal		4498 ²⁴
		SALES TAX		246 ⁵⁹
		ESTIMATED TOTAL		4745 ³³

Revin 3737

AUTHORIZATION [Signature]

TITLE Pusher 250310

DATE 6-6-12

I acknowledge that the payment terms, unless specifically amended in writing on the front of the form or in the customer's account records, at our office, and conditions of service on the back of this form are in effect for services identified on this form.

JOB LOG

SWIFT Services, Inc.

DATE 7/20/12 PAGE NO.

CUSTOMER Grand Mesa WELL NO. 2-26 LEAS Phillips JOB TYPE 2-stage long string TICKET NO. 23121

CHART NO.	TIME	RATE (BPM)	VOLUME (BBL) (GAL)	PUMPS		PRESSURE (PSI)		DESCRIPTION OF OPERATION AND MATERIALS
				T	C	TUBING	CASING	
								175sk EA-2 / 300sk SMD w/ 4" Floate 5 1/2" x 15.5" casing / 4633' TD 4632 DV tool "54 2308" Centralizer 3, 4, 6, 8, 10, 12, 14 53 Basket "54, 2
	2300							on loc TRK 114
	2315							stent 5 1/2" x 15.5" casing in well
18 Jan	0100							Drop ball - circulate - ROTATE
	0140		32					Pump 500 gal mud flush + 20 bbl KCL flesh
	0150	4 1/2	42			250		mix EA-2 cement 175 sk @ 15.3 ppg wash out pump & line.
	0155							Drop latch down plug (1st stage)
	0200	6 1/2	54			250		Displace plug w/ H ₂ O
		6 1/2	56			300		Displace plug w/ mud
	0215	6 1/2	110			1450		Land plug Release pressure to truck - dried up wash truck circulate. Drop bomb
	0220					1100		open DV tool
	0225							circulate well
	0445		7					Plug RH - MH 30sk - 20sk
	0500	6 1/2	135			200		mix SMD cement 50sk 280sk @ 11.2 ppg Drop 2nd stage plug
	0515	4 1/2				250		Displace plug
		4 1/2	40			450		— cement to surface. — {30sk to pit}
	0530	4 1/2	56			1500		Land plug - close DV Release pressure to truck - dried up
	0535							wash truck Pack up
	0610							job complete Thun T.J. Blaine, Dave, & Doug

Pro-Stim Chemicals LLC

67442

Acidizing Report

Date 7-2-12

Customer <u>Grand Mesa</u>		Pro-Stim Chemical Yard <u>Dighton</u>		Pro-Stim Number <u>A6</u>	
Well Name & Number <u>Phillip 2-26</u>		Field		Formation Spot	
County <u>Gove</u>	State <u>KS</u>	BHT	YD	Interval <u>4413 Top Perf - 4418</u>	

Well Type: Completion Recompletion Workover Oil Gas Water Disposal Perf OH

Job Pumped Via: Tubing Casing Annulus CTU Combination Plug Depth Packer Depth 4350

Casing Size: <u>5 1/2</u>	GRD	WT	Depth	Tubing Size: <u>2 7/8</u>	GRD	WT	Spot
Casing Vol. <u>1.5</u>	Tbg Vol	<u>25.2</u>	Ann Vol	OH Vol	Total Displacement		
Maximum Pressure	Tubing	Casing	Proposed Pump Time	AOL	Leave Loc		

Special Instructions: 750 gals RWR-1 15% Acid
8 gals PAS-8

Treatment Record

Time	Type Fluid	Rate BPM	Increment Vol Bbls	Cum Vol Bbls	Pressure		Observations
					Tubing	Casing	
							Safety Meeting
							Pre Test to _____ psi
<u>2</u>	<u>Acid</u>	<u>2.7</u>		<u>5</u>	<u>20</u>		<u>start balls</u>
<u>8</u>	<u>Acid</u>	<u>1.0</u>		<u>10</u>	<u>-10</u>		<u>Balls gone (10 @ 20 balls)</u>
<u>11</u>	<u>Acid</u>	<u>2.7</u>		<u>18</u>	<u>40</u>		<u>Acid gone</u>
<u>14</u>	<u>Flush</u>	<u>0</u>		<u>26.6</u>	<u>60</u>		<u>hole loaded</u>
<u>16</u>	<u>Flush</u>	<u>0</u>		<u>27</u>	<u>800</u>		<u>max pressure</u>
<u>17</u>	<u>Flush</u>	<u>.2</u>		<u>27.6</u>	<u>750</u>		
<u>22</u>	<u>Flush</u>	<u>.2</u>		<u>28.6</u>	<u>670</u>		
<u>27</u>	<u>Flush</u>	<u>1.0</u>		<u>31.6</u>	<u>750</u>		
<u>29</u>	<u>Flush</u>	<u>1.5</u>		<u>34.3</u>	<u>560</u>		
<u>30</u>	<u>Flush</u>	<u>2.0</u>		<u>35.8</u>	<u>650</u>		
<u>34</u>	<u>Flush</u>	<u>2.0</u>		<u>45</u>	<u>650</u>		<u>Total load pumped</u>

Treatment Synopsis

Avg Inj Rate	Fluid BPM	Total Injected		H2O <u>27</u>	Acid <u>18</u>	Oil
Treating Pres	Max <u>800</u>	Final <u>650</u>	Avg.	ISIP <u>600</u>	5SI <u>450</u>	10SI <u>380</u> 15SI <u>290</u>
Customer Representative				Pro-Stim Supervisor	<u>Shannon M.</u>	

Pro-Stim Chemicals, LLC

P.O. Box 25
Cheyenne Wells, CO 80810

JUL 23 2012

Invoice

Date	Invoice #
7/17/2012	67442

Bill To
Grand Mesa Operating Co. 1700 N. Waterfront Pkwy - Bldg 600 Wichita, KS 67206-6614

Ship To

Requested By	Terms	Ship	Lease
	Net 30	7/2/2012	PHILLIPS #2-26

Quantity	Item Code	Description	Price Each	Amount
750	RWR-1 15%	GALLONS	2.82	2,115.00
8	PAS-8	GALLONS	16.10	128.80
30	KCL BIOCID - 2%	BRLS	3.16	94.80
10	BALLS - BIO-DEGRADEA...	EACH	7.00	70.00
1	BALL LAUNCHER		80.00	80.00
1	DUMP JOB		158.00	158.00T
4	TRUCK TIME	HOURS	95.00	380.00T
		Sales Tax - GOVE CO.	8.05%	43.31

			Total	\$3,069.91
--	--	--	--------------	------------

Phone #	Fax #	E-mail
719-767-8071	719-767-5925	prostim@hotmail.com

DP

Acidizing Report

PRO-STIM CHEMICALS

67453
Date 7-3-12

Customer GRAND MESA	Pro-Stim Chemical Yard DIGHTON	Pro-Stim Number
Well Name & Number Phillip 2-26	Field	Formation Fordscott Spot
County Gove State KS	BHT	YD
		Interval 4413 - 4418

Well Type: Completion Recompletion Workover Oil Gas Water Disposal Perf OH

Job Pumped Via: Tubing <input type="checkbox"/> Casing <input type="checkbox"/> Annulus <input type="checkbox"/> CTU <input type="checkbox"/> Combination <input type="checkbox"/>	Plug Depth	Packer Depth 4350
Casing Size: 5 1/2	GRD	WT
Casing Vol.	Tbg Vol	Ann Vol
Maximum Pressure	Tubing	Casing
	Proposed Pump Time	AOL
		Leave Loc

Special Instructions: **1000 Gal 15% 36 5-3000 4-S-262**
28 BBLs 2% KCL 5 Pas-Q 3 AF 150
4 AC-307

Treatment Record

Time	Type Fluid	Rate BMP	Increment Vol Bbls	Cum Vol Bbls	Pressure		Observations
					Tubing	Casing	
							Safety Meeting
							Pre Test to _____ psi
1	Acid	3.5		8	0	0	
5	Acid	3.5		15	0	0	
24	Acid	3.5		24	0	0	Acid Conc
25	Flush	3.5		26.1	0	0	Loaded
27	Flush	2		28	200	0	
30	Flush	3		31	500	0	
33	Flush	3		35	550	0	
35	Flush	3		39	620	0	
36	Flush	3.5		42	750	0	
38	Flush	3.5		46	780	0	
40	Flush	3.5		50	800	0	
42	Flush	3.5		52	800	0	

Ball Action

Treatment Synopsis

Avg Inj Rate	Fluid BPM 3	Total Injected	H2O 28	Acid 24	Oil
Treating Pres.	Max 800	Final 800	Avg. 700	ISIP 750	5'SI 490
Customer Representative	[Signature]		Pro-Stim Supervisor	10'SI 380	15'SI 340

Pro-Stim Chemicals, LLC

P.O. Box 25
Cheyenne Wells, CO 80810

JUL 23 2012

Invoice

Date	Invoice #
7/17/2012	67453

Bill To
Grand Mesa Operating Co. 1700 N. Waterfront Pkwy - Bldg 600 Wichita, KS 67206-6614

Ship To

Requested By	Terms	Ship	Lease
	Net 30	7/3/2012	PHILLIPS #2-26

Quantity	Item Code	Description	Price Each	Amount
1,000	15% HCl ACID	GALLONS	1.78	1,780.00
28	S-3000	GALLONS	23.56	659.68
15	PAS-8	GALLONS	16.10	241.50
4	AC-307	GALLONS	18.61	74.44
4	S-262	GALLONS	14.36	57.44
3	AI-150	GALLONS	20.15	60.45
1	DUMP JOB		158.00	158.00T
15	BALLS - BIO-DEGRADEA...	EACH	7.00	105.00
1	BALL LAUNCHER		80.00	80.00
30	KCL BIOCIDES - 2%	BRLS	3.16	94.80
3.5	TRUCK TIME	HOURS	95.00	332.50T
		Sales Tax - GOVE CO.	8.05%	39.49

			Total	\$3,683.30
--	--	--	--------------	-------------------

Phone #	Fax #	E-mail
719-767-8071	719-767-5925	prostim@hotmail.com

**GRAND
MESA**

OPERATING COMPANY

(316) 265-3000
FAX: (316) 265-3455

1700 N. WATERFRONT PARKWAY
BLDG. 600
WICHITA, KANSAS 67206-5514

August 22, 2012

Ritchie Exploration, Inc.
8100 E. 22nd North, Bldg 700
Wichita, KS 67226

RE: Application for Commingling
Phillip #2-26; SW/NW/NE/NW Sec. 26-13S-31W
Gove County, Kansas

To Whom It May Concern:

Per Kansas Corporation Commission (KCC) regulations 82-3-123 and 82-3-135(a) Grand Mesa Operating Company is providing notice to you regarding the commingling of wellbore production in the above-described well. Please find the attached "APPLICATION FOR COMMINGLING OF PRODUCTION OR FLUIDS", KCC form ACO-4. If you have any questions, please contact me at (316) 265-3000.

Very truly yours,

GRAND MESA OPERATING COMPANY

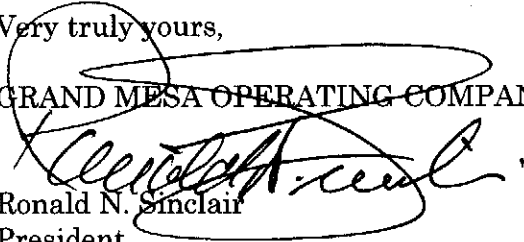
Ronald N. Sinclair
President

RNS;peb

Enclosures

**GRAND
MESA**

OPERATING COMPANY

(316) 265-3000
FAX: (316) 265-3455

1700 N. WATERFRONT PARKWAY
BLDG. 600
WICHITA, KANSAS 67208-6514

August 22, 2012

Shakespeare Oil Company, Inc.
202 W. Main
Salem, IL 62881

RE: Application for Commingling
Phillip #2-26; SW/NW/NE/NW Sec. 26-13S-31W
Gove County, Kansas

To Whom It May Concern:

Per Kansas Corporation Commission (KCC) regulations 82-3-123 and 82-3-135(a) Grand Mesa Operating Company is providing notice to you regarding the commingling of wellbore production in the above-described well. Please find the attached "APPLICATION FOR COMMINGLING OF PRODUCTION OR FLUIDS", KCC form ACO-4. If you have any questions, please contact me at (316) 265-3000.

Very truly yours,

~~GRAND MESA OPERATING COMPANY~~

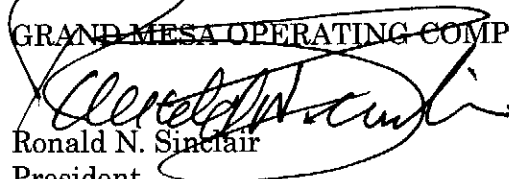
Ronald N. Sinclair
President

RNS;peb

Enclosures

AFFIDAVIT

STATE OF KANSAS \
- SS.
County of Sedgwick /

Mark Fletchall, of lawful age, being first duly sworn, deposeth and saith: That he is Record Clerk of The Wichita Eagle, a daily newspaper published in the City of Wichita, County of Sedgwick, State of Kansas, and having a general paid circulation on a daily basis in said County, which said newspaper has been continuously and uninterruptedly published in said County for more than one year prior to the first publication of the notice hereinafter mentioned, and which said newspaper has been entered as second class mail matter at the United States Post Office in Wichita, Kansas, and which said newspaper is not a trade, religious or fraternal publication and that a notice of a true copy is hereto attached was published in the regular and entire Morning issue of said The Wichita Eagle for 1 issues, that the first publication of said notice was

made as aforesaid on the 20th of

August A.D. 2012, with

subsequent publications being made on the following dates:

And affiant further says that he has personal knowledge of the statements above set forth and that they are true.

Mark Fletchall

Subscribed and sworn to before me this

20th day of August, 2012

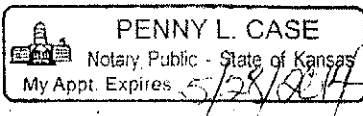

Penny L. Case

Notary Public Sedgwick County, Kansas

Printer's Fee : \$110.80

LEGAL PUBLICATION

PUBLISHED IN THE WICHITA EAGLE
AUGUST 20, 2012 (3202281)
BEFORE THE STATE CORPORATION COMMISSION

NOTICE OF FILING APPLICATION

RE: Grand Mesa Operating Company, License #9855- Application for a commingling of production for the Phillip #2-26, located in Gove County, Kansas.

TO: All Oil & Gas Producers, Unleased Mineral Interest Owners, Landowners and all persons concerned.

You, and each of you, are hereby notified that Grand Mesa Operating Company - has filed an application for commingling production or fluids from the Lansing and the Ft. Scott Formations. The subject well, the Phillip #2-26, is located 344 feet from the north line and 1491 feet from the west line in the SW NW NE NW of Section 26, Township 13 South, Range 31 West, Gove County, Kansas.

Any persons who object to or protest this application shall be required to file their objections or protest with the Conservation Division of the State Corporation Commission of the State of Kansas within fifteen (15) days of the publication of this notice. These protests shall be filed pursuant to Commission regulations and must state specific reasons why granting the application may cause waste, violate correlative rights or pollute the natural resources of the State of Kansas.

All persons interested or concerned shall take notice of the foregoing and shall govern themselves accordingly.

Grand Mesa Operating Company
Ronald N. Sinclair, President
1700 N. Waterfront Pkwy, Bldg 600
Wichita, KS 67206-5514
(316) 265-3000

AFFIDAVIT OF PUBLICATION
State of Kansas,
Gove County, ss:

Roxanne Broeckelman,
being first duly sworn, deposes and
says: That she is
co-publisher of

Gove County Advocate, a weekly
newspaper printed in the State of
Kansas, and published in and of
general circulation in Gove County,
Kansas, with a general paid
circulation on a weekly basis in
Gove County, Kansas, and that said
newspaper is not a trade, religious
or fraternal publication.

Said newspaper is a weekly
published at least 50 times a year;
and has been so published
continuously and uninterruptedly in
said county and state for a period of
more than five years prior to the first
publication of said notice; and has
been admitted at the post office in
Quinter in said county as periodical
class mail matter.

That the attached notice is a true
copy thereof and was published in
the regular and entire issue of said
newspaper for one
consecutive week(s), the first
publication thereof being made as
aforesaid on the 22nd day
of August, 2012,
with subsequent publications being
made on the following dates:

Printer's Fee \$ 23.45
Additional Copies \$ _____
Affidavit Fees \$ 2.00
Total Publication Fees . \$ 25.45

Roxanne Broeckelman

Subscribed and sworn to before me
this 22nd day of
August, 2012

Linda L. Zerr
Notary Public

My commission expires:
January 8, 2013

LEGAL ADVERTISING
(Published in the Gove County Advocate,
Quinter, KS, Wed., August 22, 2012 - 1t)
BEFORE THE STATE CORPORATION
COMMISSION OF THE STATE OF KANSAS
NOTICE OF FILING APPLICATION
RE: Grand Mesa Operating Company, License
#9855 – Application for a commingling of pro-
duction for the Phillip #2-26, located in Gove
County, Kansas.
TO: All Oil & Gas Producers, Unleased Mineral
Interest Owners, Landowners and all persons
concerned.

You, and each of you, are hereby notified
that Grand Mesa Operating Company – has
filed an application for commingling production
or fluids from the Lansing and the Ft. Scott
Formations. The subject well, the Phillip #2-26,
is located 344 feet from the north line and 1491
feet from the west line in the SW NW NE NW
of Section 26, Township 13 South, Range 31
West, Gove County, Kansas.

Any persons who object to or protest this
application shall be required to file their objec-
tions or protest with the Conservation Division
of the State Corporation Commission of the
State of Kansas within fifteen (15) days of the
publication of this notice. These protests shall
be filed pursuant to Commission regulations
and must state specific reasons why granting
the application may cause waste, violate correl-
ative rights or pollute the natural resources of
the State of Kansas.

All persons interested or concerned shall
take notice of the foregoing and shall govern
themselves accordingly.

Grand Mesa Operating Company
Ronald N. Sinclair, President
1700 N. Waterfront Pkwy, Bldg 600
Wichita, KS 67206-5514
(316) 265-3000

LINDA L. ZERR
NOTARY PUBLIC
STATE OF KANSAS
My Appt. Exp. 1-8-2013

September 6, 2012

Ronald N. Sinclair
Grand Mesa Operating Company
1700 N Waterfront Pkwy, Bldg 600
Wichita, KS 67206-5514

RE: Approved Commingling CO081234
Phillip 2-26, Sec.26-T13S-R31W, Gove County
API No. 15-063-22005-00-00

Dear Mr. Sinclair:

Your Application for Commingling (ACO-4) for the above described well has been reviewed and approved by the Kansas Corporation Commission (KCC) per K.A.R. 82-3-123. Notice was examined and found to be proper per K.A.R. 82-3-135a. No protest had been filed within the 15-day protest period. This application, which was received by the KCC on August 27, 2012, concerns approval to simultaneously produce from the following sources of supply through the same tubing string in the same wellbore:

Source of Supply	Estimated Current Production			Perf Depth
	BOPD	MCFPD	BWPD	
Lansing	69.0	0.0	16.0	4179-4184
Lwr. Ft. Scott	3.0	0.0	0.0	4413-4418
Total Estimated Current Production	72.0	0.0	16.0	

Based upon the depth of the Lwr. Ft. Scott formation perforations, total oil production shall not exceed 200 BOPD and total gas production shall not exceed 50% of the absolute open flow (AOF).

Commingling ID number CO081234 has been assigned to this approved application. Use this number for well completion reports (ACO-1) and other correspondence that may concern this approved commingling.

Sincerely,

Rick Hestermann
Production Department