



**APPLICATION FOR COMMINGLING OF PRODUCTION (K.A.R. 82-3-123) OR FLUIDS (K.A.R. 82-3-123a)** *Commingling ID #* \_\_\_\_\_

OPERATOR: License # \_\_\_\_\_ API No. 15 - \_\_\_\_\_  
Name: \_\_\_\_\_ Spot Description: \_\_\_\_\_  
Address 1: \_\_\_\_\_ - - - - - Sec. \_\_\_\_\_ Twp. \_\_\_\_\_ S. R. \_\_\_\_\_  East  West  
Address 2: \_\_\_\_\_ Feet from  North /  South Line of Section  
City: \_\_\_\_\_ State: \_\_\_\_\_ Zip: \_\_\_\_\_ + \_\_\_\_\_ Feet from  East /  West Line of Section  
Contact Person: \_\_\_\_\_ County: \_\_\_\_\_  
Phone: ( \_\_\_\_\_ ) \_\_\_\_\_ Lease Name: \_\_\_\_\_ Well #: \_\_\_\_\_

1. Name and upper and lower limit of each production interval to be commingled:  
Formation: \_\_\_\_\_ (Perfs): \_\_\_\_\_  
Formation: \_\_\_\_\_ (Perfs): \_\_\_\_\_  
Formation: \_\_\_\_\_ (Perfs): \_\_\_\_\_  
Formation: \_\_\_\_\_ (Perfs): \_\_\_\_\_  
Formation: \_\_\_\_\_ (Perfs): \_\_\_\_\_

2. Estimated amount of fluid production to be commingled from each interval:  
Formation: \_\_\_\_\_ BOPD: \_\_\_\_\_ MCFPD: \_\_\_\_\_ BWPD: \_\_\_\_\_  
Formation: \_\_\_\_\_ BOPD: \_\_\_\_\_ MCFPD: \_\_\_\_\_ BWPD: \_\_\_\_\_  
Formation: \_\_\_\_\_ BOPD: \_\_\_\_\_ MCFPD: \_\_\_\_\_ BWPD: \_\_\_\_\_  
Formation: \_\_\_\_\_ BOPD: \_\_\_\_\_ MCFPD: \_\_\_\_\_ BWPD: \_\_\_\_\_  
Formation: \_\_\_\_\_ BOPD: \_\_\_\_\_ MCFPD: \_\_\_\_\_ BWPD: \_\_\_\_\_

3. Plat map showing the location of the subject well, all other wells on the subject lease, and all wells on offsetting leases within a 1/2 mile radius of the subject well, and for each well the names and addresses of the lessee of record or operator.

4. Signed certificate showing service of the application and affidavit of publication as required in K.A.R. 82-3-135a.

**For Commingling of PRODUCTION ONLY, include the following:**

- 5. Wireline log of subject well. Previously Filed with ACO-1:  Yes  No
- 6. Complete Form ACO-1 (*Well Completion form*) for the subject well.

**For Commingling of FLUIDS ONLY, include the following:**

- 7. Well construction diagram of subject well.
- 8. Any available water chemistry data demonstrating the compatibility of the fluids to be commingled.

**AFFIDAVIT:** I am the affiant and hereby certify that to the best of my current information, knowledge and personal belief, this request for commingling is true and proper and I have no information or knowledge, which is inconsistent with the information supplied in this application.

**Submitted Electronically**

**KCC Office Use Only**  
 Denied  Approved  
15-Day Periods Ends: \_\_\_\_\_  
Approved By: \_\_\_\_\_ Date: \_\_\_\_\_

*Protests may be filed by any party having a valid interest in the application. Protests must be in writing and comply with K.A.R. 82-3-135b and must be filed within 15 days of publication of the notice of application.*

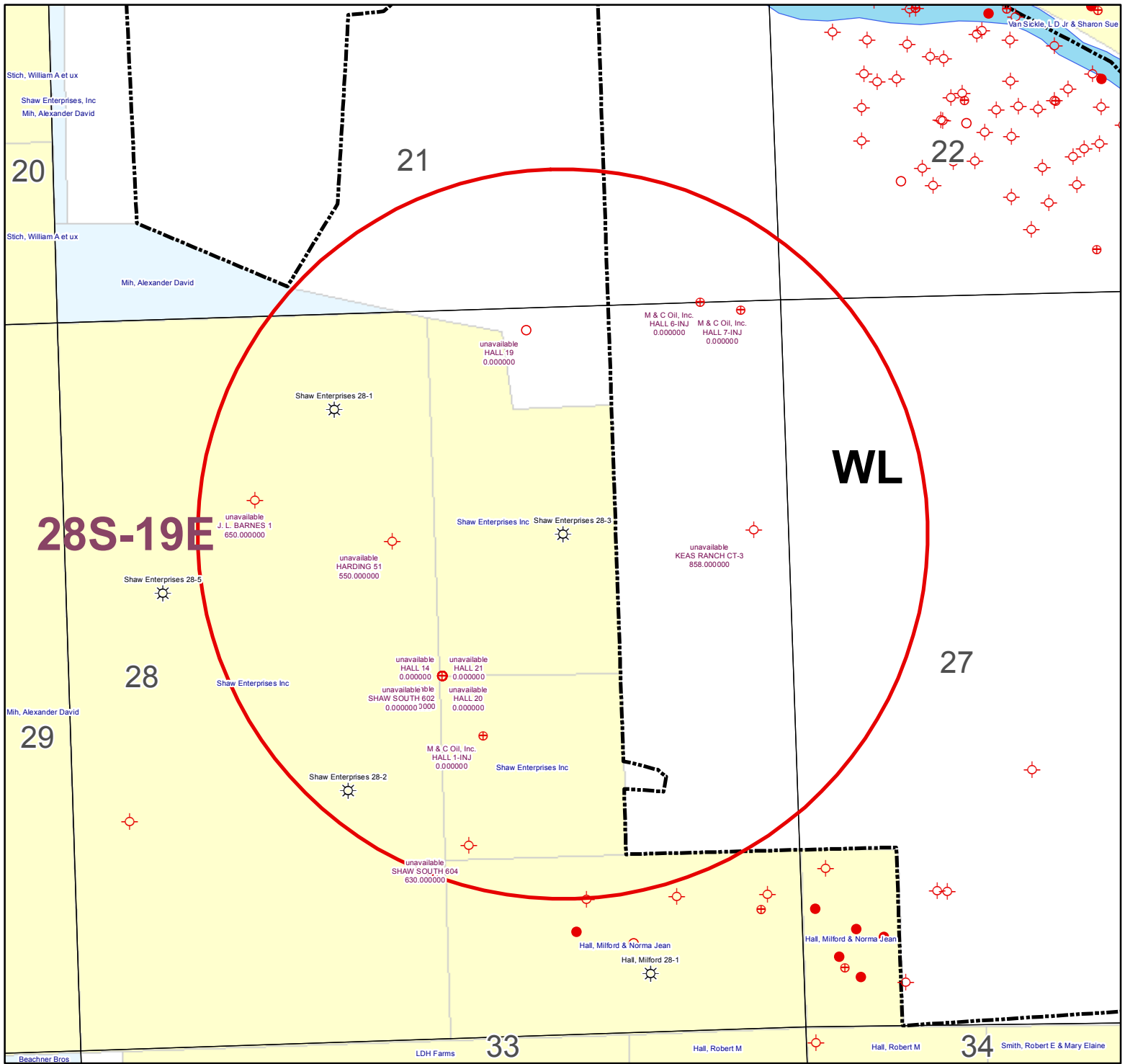

**KGS STATUS**

◇	DA/PA
⊕	EOR
☀	GAS
△	INJ/SWD
●	OIL
★	OIL/GAS
○	OTHER

Shaw Enterprises 28-3  
 28-28S-19E  
 1" = 1,000'



BEFORE THE STATE CORPORATION COMMISSION OF THE STATE OF KANSAS  
**NOTICE OF FILING APPLICATION**

RE: In the Matter of **Postrock Midcontinent Production, LLC** Application for Commingling of Production in the **Shaw Enterprises 28-3** located in **Neosho County, Kansas**.

TO: All Oil & Gas Producers, Unleased Mineral Interest Owners, Landowners, and all persons whomever concerned.

You, and each of you, are hereby notified that **Postrock Midcontinent Production, LLC** has filed an application to commingle the **Summit, Mulky, Croweburg, Fleming, Tebo, Neutral, Rowe, Riverton and Cattleman** producing formations at the **Shaw Enterprises 28-3**, located in the **NE NE SW NE, S28-T28S-R19E, Approximately 1645 FNL & 1635 FEL, Neosho County, Kansas**.

Any persons who object to or protest this application shall be required to file their objections or protest with the Conservation Division of the State Corporation Commission of the State of Kansas within fifteen (15) days from the date of this publication. These protests shall be filed pursuant to Commission regulations and must state specific reasons why granting the application may cause waste, violate correlative rights or pollute the natural resources of the State of Kansas.

All persons interested or concerned shall take notice of the foregoing and shall govern themselves accordingly. All person and/or companies wishing to protest this application are required to file a written protest with the Conservation Division of the Kansas Oil and Gas Commission.

Upon the receipt of any protest, the Commission will convene a hearing and protestants will be expected to enter an appearance either through proper legal counsel or as individuals, appearing on their own behalf.

**Postrock Midcontinent Production, LLC**  
210 Park Avenue, Suite 2750  
Oklahoma City, Oklahoma 73102  
(405) 660-7704

A COPY OF THE AFFIDAVIT OF PUBLICATION MUST ACCOMPANY ALL APPLICATIONS

**Affidavit of Publication**

STATE OF KANSAS, NEOSHO COUNTY, ss:  
*Rhonda Howerter*, being first duly sworn, deposes and says: That *she* is *Classified Manager* of *THE CHANUTE TRIBUNE*, a daily newspaper printed in the State of Kansas, and published in and of general circulation in Neosho County, Kansas, with a general paid circulation on a daily basis in Neosho County, Kansas, and that said newspaper is not a trade, religious or fraternal publication.

Said newspaper is a daily published at least weekly 50 times a year: has been so published continuously and uninterruptedly in said county and state for a period of more than five years prior to the first publication of said notice; and has been admitted at the post office of Chanute, in said county as second class matter.

That the attached notice is a true copy thereof and was published in the regular and entire issue of said newspaper for 1 consecutive time, the first publication thereof being made as aforesaid on the 16 day of January ~~2012~~ 2013 with subsequent publications being made on the following dates:

\_\_\_\_\_, 2012 \_\_\_\_\_, 2012  
\_\_\_\_\_, 2012 \_\_\_\_\_, 2012

Rhonda Howerter

Subscribed and sworn to and before me this 16 day of January 2013

[Signature]  
Notary Public

My commission expires: January 9, 2015  
Printer's Fee ..... \$ 67.34  
Affidavit, Notary's Fee ..... \$ 3.00  
Additional Copies ..... \$ \_\_\_\_\_  
Total Publication Fees ..... \$ 70.34

SHANNA L. GUIOT  
Notary Public - State of Kansas  
My Appt. Expires 1-9-15

**AFFIDAVIT**

STATE OF KANSAS \
- SS.
County of Sedgwick /

Mark Fletchall, of lawful age, being first duly sworn, deposeth and saith: That he is Record Clerk of The Wichita Eagle, a daily newspaper published in the City of Wichita, County of Sedgwick, State of Kansas, and having a general paid circulation on a daily basis in said County, which said newspaper has been continuously and uninterruptedly published in said County for more than one year prior to the first publication of the notice hereinafter mentioned, and which said newspaper has been entered as second class mail matter at the United States Post Office in Wichita, Kansas, and which said newspaper is not a trade, religious or fraternal publication and that a notice of a true copy is hereto attached was published in the regular and entire Morning issue of said The Wichita Eagle for 1 issues, that the first publication of said notice was

made as aforesaid on the 17th of

January A.D. 2013, with

subsequent publications being made on the following dates:

And affiant further says that he has personal knowledge of the statements above set forth and that they are true.

*Mark Fletchall*

Subscribed and sworn to before me this

17th day of January, 2013

PENNY L. CASE
Notary Public - State of Kansas
My Appt. Expires 5/28/2014

*Penny L Case*
Notary Public Sedgwick County, Kansas

Printer's Fee : \$132.40

LEGAL PUBLICATION
PUBLISHED IN THE WICHITA EAGLE
JANUARY 17, 2013 (3227058)
BEFORE THE STATE CORPORATION
COMMISSION OF THE STATE OF KANSAS
NOTICE OF FILING APPLICATION
RE: In the Matter of Postrock Midcontinent
Production, LLC Application for
Commingle of Production in the
Shaw Enterprises 28-3 located in
Neosho County, Kansas.
TO: All Oil & Gas Producers, Unleased
Mineral Interest Owners, Landowners,
and all persons whomsoever concerned.
You, and each of you, are hereby
notified that Postrock Midcontinent
Production, LLC has filed an application
to commingle the Summit, Mulky,
Croweburg, Fleming, Tebo, Neutral,
Rowe, Riverton and Cattleman producing
formations at the Shaw Enterprises
28-3, located in the NE NE SW NE,
S28-T28S-R19E, Approximately 1645 FNL
& 1635 FEL, Neosho County, Kansas.
Any persons who object to or protest
this application shall be required to file their
objections or protest with the Conservation
Division of the State Corporation
Commission of the State of Kansas within
fifteen (15) days from the date of this
publication. These protests shall be filed
pursuant to Commission regulations and
must state specific reasons why granting
the application may cause waste, violate
correlative rights or pollute the natural
resources of the State of Kansas.
All persons interested or concerned
shall take notice of the foregoing and shall
govern themselves accordingly. All person
and/or companies wishing to protest this
application are required to file a written
protest with the Conservation Division of
the Kansas Oil and Gas Commission.
Upon the receipt of any protest, the
Commission will convene a hearing and
protestants will be expected to enter an
appearance either through proper legal
counsel or as individuals, appearing on
their own behalf.
Postrock Midcontinent Production, LLC
210 Park Avenue, Suite 2750
Oklahoma City, Oklahoma 73102
(405) 660-7704

**Affidavit of Notice Served**

Re: Application for: APPLICATION FOR COMMINGLING OF PRODUCTION OR FLUIDS ACO-4

Well Name: SHAW ENTERPRISESE 28-3 Legal Location: NENESWNE S28-T28S-R19E

The undersigned hereby certifies that he / she is a duly authorized agent for the applicant, and that on the day 11<sup>th</sup> of FEBRUARY, 2013, a true and correct copy of the application referenced above was delivered or mailed to the following parties:

*Note: A copy of this affidavit must be served as a part of the application.*

Name

Address (Attach additional sheets if necessary)

**SEE ATTACHED**

I further attest that notice of the filing of this application was published in the CHANUTE TRIBUNE, the official county publication of NEOSHO county. A copy of the affidavit of this publication is attached.

Signed this 11<sup>th</sup> day of FEBRUARY, 2013

[Signature]  
Applicant or Duly Authorized Agent

Subscribed and sworn to before me this 11<sup>th</sup> day of FEBRUARY, 2013



Jennifer R. Beal  
Notary Public

My Commission Expires: July 20, 2014

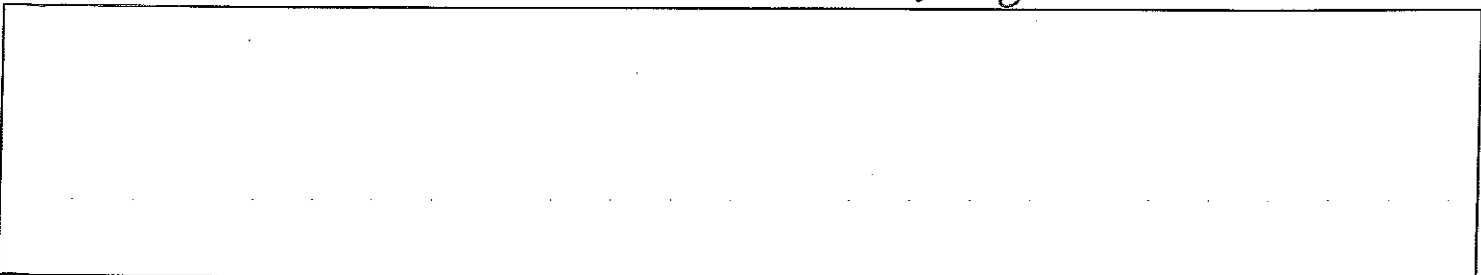

**SHAW ENTERPRISES 28-3**

<b>LEGAL LOCATION</b>	<b>SPOT</b>	<b>CURR_OPERA</b>	<b>ADDRESS</b>
S28-T28S-R19E	SW NW NW SE	<b>M &amp; C Oil, Inc.</b>	PO BOX 427, INDIANOLA, NE 68034
S28-T28S-R19E	NE NE NE	<b>M &amp; C Oil, Inc.</b>	PO BOX 427, INDIANOLA, NE 68034
S28-T28S-R19E	NE NE NE	<b>M &amp; C Oil, Inc.</b>	PO BOX 427, INDIANOLA, NE 68034

**SHAW ENTERPRISES 28-3**

**21-28S-19E**

**S2S2 less**

Leroy & Elaine Castagno Rev. Family Trust (1/4)

PO BOX 1204

Pittsburg, KS 66762

Shaw Enterprises Inc (3/4)

11600 160th Rd

Chanute, KS 66720

**22-28S-19E**

**SW4**

SR Farm LLC

C/O Daniel J. Haake

11900 College Blvd, Ste 310

Overland Park, KS 66210

**27-28S-19E**

**W2 less tract**

SR Farm LLC

C/O Daniel J. Haake

11900 College Blvd, Ste 310

Overland Park, KS 66210

**28-28S-19E**

**tract in NE4 NE4**

Leroy & Elaine Castagno Rev. Family Trust (1/4)

PO BOX 1204

Pittsburg, KS 66762

Shaw Enterprises Inc (3/4)

11600 160th Rd

Chanute, KS 66720

**E2 E2 less tracts**

SR Farm LLC

C/O Daniel J. Haake

11900 College Blvd, Ste 310

Overland Park, KS 66210

**Tract in NE4 SE4**

Elk Creek Agricultural Limited Partnership (1/4)

14 Woodsborough

Houston, TX 77055

Shaw Enterprises Inc (3/4)

11600 160th Rd

Chanute, KS 66720



SHAW ENTERPRISES 28-3-APPLICATION FOR COMMINGLING OF PRODUCTION OR FLUIDS

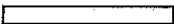

Offset Operators, Unleased Mineral Owners and Landowners acreage

(Attach additional sheets if necessary)

Name:

Legal Description of Leasehold:

SEE ATTACHED

Multiple horizontal lines for data entry under the 'Name' and 'Legal Description of Leasehold' headers.

I hereby certify that the statements made herein are true and correct to the best of my knowledge and belief.

*[Handwritten signature]*

Applicant or Duly Authorized Agent

Subscribed and sworn before me this 11<sup>th</sup> day of FEBRUARY, 2013

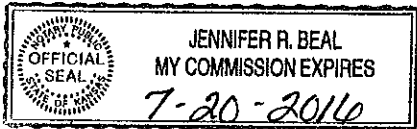

*Jennifer R. Beal*

Notary Public

My Commission Expires:

*July 20, 2016*

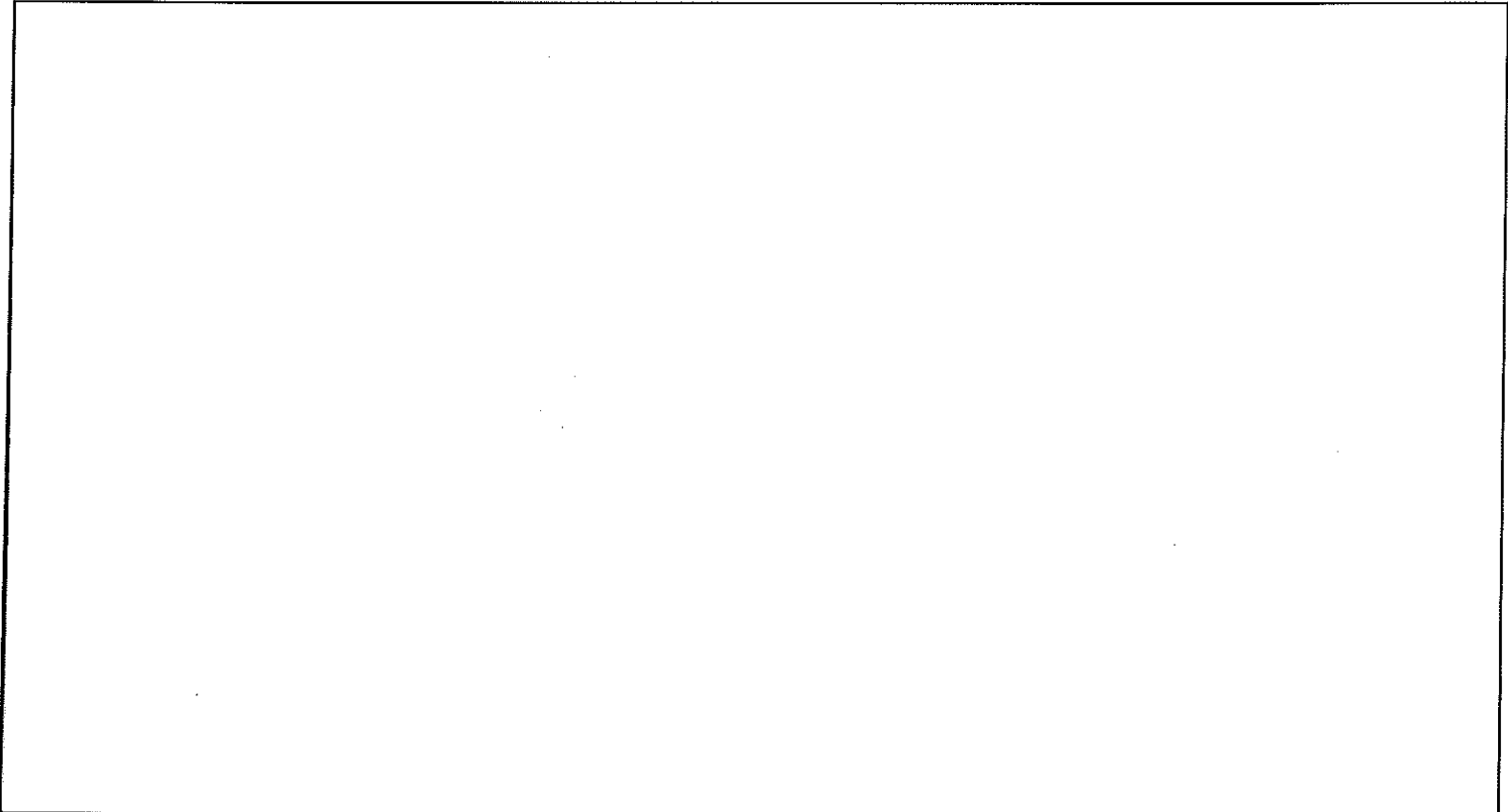

**SHAW ENTERPRISES 28-3**

<b>LEGAL LOCATION</b>	<b>SPOT</b>	<b>CURR_OPERA</b>	<b>ADDRESS</b>
S28-T28S-R19E	SW NW NW SE	M & C Oil, Inc.	PO BOX 427, INDIANOLA, NE 68034
S28-T28S-R19E	NE NE NE	M & C Oil, Inc.	PO BOX 427, INDIANOLA, NE 68034
S28-T28S-R19E	NE NE NE	M & C Oil, Inc.	PO BOX 427, INDIANOLA, NE 68034

**SHAW ENTERPRISES 28-3**

**21-28S-19E**

**S2S2 less**

Leroy & Elaine Castagno Rev. Family Trust (1/4)

PO BOX 1204

Pittsburg, KS 66762

Shaw Enterprises Inc (3/4)

11600 160th Rd

Chanute, KS 66720

**22-28S-19E**

**SW4**

SR Farm LLC

C/O Daniel J. Haake

11900 College Blvd, Ste 310

Overland Park, KS 66210

**27-28S-19E**

**W2 less tract**

SR Farm LLC

C/O Daniel J. Haake

11900 College Blvd, Ste 310

Overland Park, KS 66210

**28-28S-19E**

**tract in NE4 NE4**

Leroy & Elaine Castagno Rev. Family Trust (1/4)

PO BOX 1204

Pittsburg, KS 66762

Shaw Enterprises Inc (3/4)

11600 160th Rd

Chanute, KS 66720

**E2 E2 less tracts**

SR Farm LLC

C/O Daniel J. Haake

11900 College Blvd, Ste 310

Overland Park, KS 66210

**Tract in NE4 SE4**

Elk Creek Agricultural Limited Partnership (1/4)

14 Woodsborough

Houston, TX 77055

Shaw Enterprises Inc (3/4)

11600 160th Rd

Chanute, KS 66720

Conservation Division  
Finney State Office Building  
130 S. Market, Rm. 2078  
Wichita, KS 67202-3802



Phone: 316-337-6200  
Fax: 316-337-6211  
<http://kcc.ks.gov/>

Mark Sievers, Chairman  
Thomas E. Wright, Commissioner  
Shari Feist Albrecht, Commissioner

Sam Brownback, Governor

February 26, 2013

Clark Edwards  
PostRock Midcontinent Production LLC  
Oklahoma Tower  
210 Park Ave, Ste 2750  
Oklahoma City, OK 73102

RE: Approved Commingling CO021313  
Shaw Enterprises 28-3, Sec. 28-T28S-R19E, Neosho County  
API No. 15-133-27542-00-00

Dear Mr. Edwards:

Your Application for Commingling (ACO-4) for the above described well, received by the KCC on February 15, 2013, has been reviewed and approved by the Kansas Corporation Commission (KCC) per K.A.R. 82-3-123. Notice was examined and found to be proper per K.A.R. 82-3-135a. No protest had been filed within the 15-day protest period.

Based upon the depth of the Riverton formation perforations, total oil production shall not exceed 100 BOPD and total gas production shall not exceed 50% of the absolute open flow (AOF).

**File form ACO-1 upon re-completion of the well to commingle.**

Commingling ID number CO021313 has been assigned to this approved application. Use this number for well completion reports (ACO-1) and other correspondence that may concern this approved commingling.

Sincerely,

Rick Hestermann  
Production Department