



APPLICATION FOR COMMINGLING OF PRODUCTION (K.A.R. 82-3-123) OR FLUIDS (K.A.R. 82-3-123a) *Commingling ID #* _____

OPERATOR: License # _____ API No. 15 - _____
Name: _____ Spot Description: _____
Address 1: _____ Sec. _____ Twp. _____ S. R. _____ East West
Address 2: _____ Feet from North / South Line of Section
City: _____ State: _____ Zip: _____ + _____ Feet from East / West Line of Section
Contact Person: _____ County: _____
Phone: (_____) _____ Lease Name: _____ Well #: _____

1. Name and upper and lower limit of each production interval to be commingled:
Formation: _____ (Perfs): _____
Formation: _____ (Perfs): _____
Formation: _____ (Perfs): _____
Formation: _____ (Perfs): _____
Formation: _____ (Perfs): _____

2. Estimated amount of fluid production to be commingled from each interval:
Formation: _____ BOPD: _____ MCFPD: _____ BWPD: _____
Formation: _____ BOPD: _____ MCFPD: _____ BWPD: _____
Formation: _____ BOPD: _____ MCFPD: _____ BWPD: _____
Formation: _____ BOPD: _____ MCFPD: _____ BWPD: _____
Formation: _____ BOPD: _____ MCFPD: _____ BWPD: _____

3. Plat map showing the location of the subject well, all other wells on the subject lease, and all wells on offsetting leases within a 1/2 mile radius of the subject well, and for each well the names and addresses of the lessee of record or operator.

4. Signed certificate showing service of the application and affidavit of publication as required in K.A.R. 82-3-135a.

For Commingling of PRODUCTION ONLY, include the following:

- 5. Wireline log of subject well. Previously Filed with ACO-1: Yes No
- 6. Complete Form ACO-1 (*Well Completion form*) for the subject well.

For Commingling of FLUIDS ONLY, include the following:

- 7. Well construction diagram of subject well.
- 8. Any available water chemistry data demonstrating the compatibility of the fluids to be commingled.

AFFIDAVIT: I am the affiant and hereby certify that to the best of my current information, knowledge and personal belief, this request for commingling is true and proper and I have no information or knowledge, which is inconsistent with the information supplied in this application.

Submitted Electronically

KCC Office Use Only
 Denied Approved
15-Day Periods Ends: _____
Approved By: _____ Date: _____

Protests may be filed by any party having a valid interest in the application. Protests must be in writing and comply with K.A.R. 82-3-135b and must be filed within 15 days of publication of the notice of application.



CONFIDENTIAL WELL COMPLETION FORM

WELL HISTORY - DESCRIPTION OF WELL & LEASE

OPERATOR: License # 30606
Name: Murfin Drilling Co., Inc.
Address 1: 250 N WATER STE 300
Address 2: _____
City: WICHITA State: KS Zip: 67202 + 1216
Contact Person: Leon Rodak
Phone: (316) 267-3241
CONTRACTOR: License # 30606
Name: Murfin Drilling Co., Inc.
Wellsite Geologist: Tom Funk
Purchaser: MV Purchasing

Designate Type of Completion:

- New Well Re-Entry Workover
- Oil WSW SWD SLOW
- Gas D&A ENHR SIGW
- OG GSW Temp. Abd.
- CM (Coal Bed Methane)
- Cathodic Other (Core, Expl., etc.): _____

If Workover/Re-entry: Old Well Info as follows:

Operator: _____
Well Name: _____
Original Comp. Date: _____ Original Total Depth: _____

Deepening Re-perf. Conv. to ENHR Conv. to SWD

Conv. to GSW

Plug Back: _____ Plug Back Total Depth _____

Commingled Permit #: _____

Dual Completion Permit #: _____

SWD Permit #: _____

ENHR Permit #: _____

GSW Permit #: _____

<u>02/13/2012</u>	<u>02/22/2012</u>	<u>03/07/2012</u>
Spud Date or Recompletion Date	Date Reached TD	Completion Date or Recompletion Date

API No. 15 - 15-193-20840-00-00

Spot Description: _____
NE SW NE SW Sec. 29 Twp. 10 S. R. 34 East West
1896 Feet from North / South Line of Section
1816 Feet from East / West Line of Section

Footages Calculated from Nearest Outside Section Corner:
 NE NW SE SW

County: Thomas

Lease Name: Kruto Well #: 1-29

Field Name: _____

Producing Formation: Lower Pawnee, Johnson

Elevation: Ground: 3245 Kelly Bushing: 3258

Total Depth: 4915 Plug Back Total Depth: 4862

Amount of Surface Pipe Set and Cemented at: 252 Feet

Multiple Stage Cementing Collar Used? Yes No

If yes, show depth set: 2757 Feet

If Alternate II completion, cement circulated from: 2757
feet depth to: 0 w/ 180 sx cmf.

Drilling Fluid Management Plan

(Data must be collected from the Reserve Pit)

Chloride content: 17300 ppm Fluid volume: 300 bbls

Dewatering method used: Evaporated

Location of fluid disposal if hauled offsite: _____

Operator Name: _____

Lease Name: _____ License #: _____

Quarter _____ Sec. _____ Twp. _____ S. R. _____ East West

County: _____ Permit #: _____

AFFIDAVIT

I am the affiant and I hereby certify that all requirements of the statutes, rules and regulations promulgated to regulate the oil and gas industry have been fully complied with and the statements herein are complete and correct to the best of my knowledge.

Submitted Electronically

KCC Office Use ONLY

- Letter of Confidentiality Received
Date: 05/15/2012
- Confidential Release Date: _____
- Wireline Log Received
- Geologist Report Received
- UIC Distribution
- ALT I II III Approved by: NAOMI JAMES Date: 05/15/2012



1081245

Operator Name: Murfin Drilling Co., Inc. Lease Name: Kruto Well #: 1-29
 Sec. 29 Twp. 10 S. R. 34 East West County: Thomas

INSTRUCTIONS: Show important tops and base of formations penetrated. Detail all cores. Report all final copies of drill stems tests giving interval tested, time tool open and closed, flowing and shut-in pressures, whether shut-in pressure reached static level, hydrostatic pressures, bottom hole temperature, fluid recovery, and flow rates if gas to surface test, along with final chart(s). Attach extra sheet if more space is needed. Attach complete copy of all Electric Wire-line Logs surveyed. Attach final geological well site report.

Drill Stem Tests Taken <input checked="" type="checkbox"/> Yes <input type="checkbox"/> No <i>(Attach Additional Sheets)</i> Samples Sent to Geological Survey <input checked="" type="checkbox"/> Yes <input type="checkbox"/> No Cores Taken <input type="checkbox"/> Yes <input checked="" type="checkbox"/> No Electric Log Run <input checked="" type="checkbox"/> Yes <input type="checkbox"/> No Electric Log Submitted Electronically <input checked="" type="checkbox"/> Yes <input type="checkbox"/> No <i>(If no, Submit Copy)</i> List All E. Logs Run: Dual Induction Dual Compensated Microresistivity	<input type="checkbox"/> Log Formation (Top), Depth and Datum <input type="checkbox"/> Sample Name Top Datum See Attachment
--	---

CASING RECORD <input checked="" type="checkbox"/> New <input type="checkbox"/> Used							
Report all strings set-conductor, surface, intermediate, production, etc.							
Purpose of String	Size Hole Drilled	Size Casing Set (In O.D.)	Weight Lbs. / Ft.	Setting Depth	Type of Cement	# Sacks Used	Type and Percent Additives
Surface	12.2500	8.6250	23	225	Common	225	3% cc
Production	7.8750	5.5000	15.5	4888	EA2	175	

ADDITIONAL CEMENTING / SQUEEZE RECORD				
Purpose:	Depth Top Bottom	Type of Cement	# Sacks Used	Type and Percent Additives
___ Perforate				
___ Protect Casing	-			
___ Plug Back TD	-			
___ Plug Off Zone	-			

Shots Per Foot	PERFORATION RECORD - Bridge Plugs Set/Type Specify Footage of Each Interval Perforated	Acid, Fracture, Shot, Cement Squeeze Record (Amount and Kind of Material Used)	Depth
4	4629 - 4634 Lower Pawnee	750 gal 15% MCA	
4	4722 - 4727 Johnson	750 gal 15% MCA	

TUBING RECORD: Size: <u>2 7/8</u> Set At: <u>4768</u> Packer At: <u>NA</u> Liner Run: <input type="checkbox"/> Yes <input checked="" type="checkbox"/> No	
Date of First, Resumed Production, SWD or ENHR. <u>03/20/2012</u>	Producing Method: <input type="checkbox"/> Flowing <input checked="" type="checkbox"/> Pumping <input type="checkbox"/> Gas Lift <input type="checkbox"/> Other (Explain) _____
Estimated Production Per 24 Hours	Oil Bbls. <u>121</u> Gas Mcf <u> </u> Water Bbls. <u>42</u> Gas-Oil Ratio <u> </u> Gravity <u>32</u>

DISPOSITION OF GAS: <input type="checkbox"/> Vented <input type="checkbox"/> Sold <input type="checkbox"/> Used on Lease <i>(If vented, Submit ACO-18.)</i>	METHOD OF COMPLETION: <input type="checkbox"/> Open Hole <input checked="" type="checkbox"/> Perf. <input type="checkbox"/> Dually Comp. <input type="checkbox"/> Commingled <i>(Submit ACO-5)</i> <i>(Submit ACO-4)</i> <input type="checkbox"/> Other (Specify) _____	PRODUCTION INTERVAL: <u>4629 - 4727</u>
---	--	--

Affidavit of Notice Served

Re: Application for: Commingling of Production or Fluids

Well Name: Kruto #1-29 Legal Location: NE SW NE SW Sec. 29-10S-34W

The undersigned hereby certifies that he / she is a duly authorized agent for the applicant, and that on the day 26th of March, 2013, a true and correct copy of the application referenced above was delivered or mailed to the following parties:

Note: A copy of this affidavit must be served as a part of the application.

Name	Address (Attach additional sheets if necessary)
------	---

I further attest that notice of the filing of this application was published in the Colby Free Press, the official county publication of Thomas County county. A copy of the affidavit of this publication is attached.

Signed this 26th day of March, 2013

Applicant of Duly Authorized Agent

Subscribed and sworn to before me this 26th day of March, 2013

Notary Public

My Commission Expires: 4.8.2015

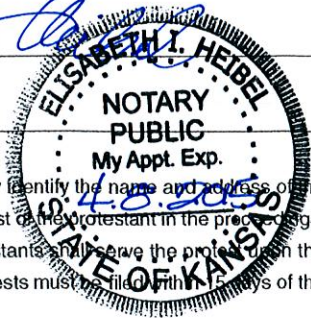

Protests may be filed by any party having a valid interest in the application. Petitions for protests shall be in writing and shall clearly identify the name and address of the protestant and the title of the application. The petition shall include a clear and concise statement of the direct and substantial interest of the protestant in the proceedings, including the manner in which the protestant may be affected, and the nature, extent, character and grounds of the protest. Protestants shall serve the protest on the applicant by mail or personal service at the same time or before the protestant files the protest with the Conservation Division. Protests must be filed with 15 days of the publication notice of the application.

Offset Operators, Unleased Mineral Owners and Landowners acreage

(Attach additional sheets if necessary)

Name:

Legal Description of Leasehold:

Murfin Drilling Co., Inc.

Sec. 29-10S-34W

250 N. Water, Suite 300

Wichita, KS 67202

Norstar Petroleum

E/2 Sec. 30, N/2 Sec. 32 in 10S-34W

88 Inverness Cir E Unit F-104

Englewood, CO. 80112

I hereby certify that the statements made herein are true and correct to the best of my knowledge and belief.

Kenneth Dean

Applicant or Duly Authorized Agent

Subscribed and sworn before me this 26th day of March, 2013

Elisabeth I. Heibel

Notary Public

My Commission Expires: 4.8.2015

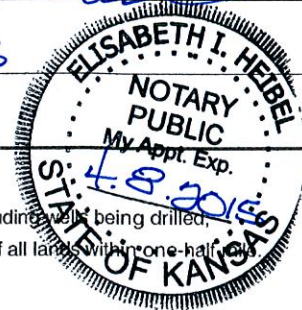

Instructions:

- Fully complete application, including page 4 (*plat map*) showing subject well and all known oil, gas and input wells, including wells being drilled, inactive wells, or dry holes, within one-half mile. Show lease names and operators or unleased mineral rights owners of all lands within one-half mile. Show well numbers and elevations of producing formation tops.
- Attach some type of log (*drillers log, electric log, etc.*).
- Attach some type of verification of cementing for surface casing, longstring, D.V. tool, perforations, etc. (*Cement ticket and job log, bond log, etc.*)
- Attach Affidavit of Notice.
- Fill in schematic drawing of subsurface facilities including: size, setting depth, amount of cement, measured or calculated tops of cement for each of surface, intermediate (*if any*) and production casing; size and setting depth of tubing and packer; geological zone of injection showing top and bottom of injection interval.
- The original and one copy of the application and all attachments shall be mailed to the State Corporation Commission, Conservation Division.
- Deliver or mail one (1) copy of the application to the landowner on whose land the injection well is located and to each operator or lessee of record and each unleased mineral rights owner within one-half mile of the applicant well.
- Approval of this application, if granted, is valid only as long as there are no substantial changes in operation set forth in the application. A substantial change requires the approval of a new application. **No injection well may be used without prior written authorization.**
- All application fees must accompany the application.

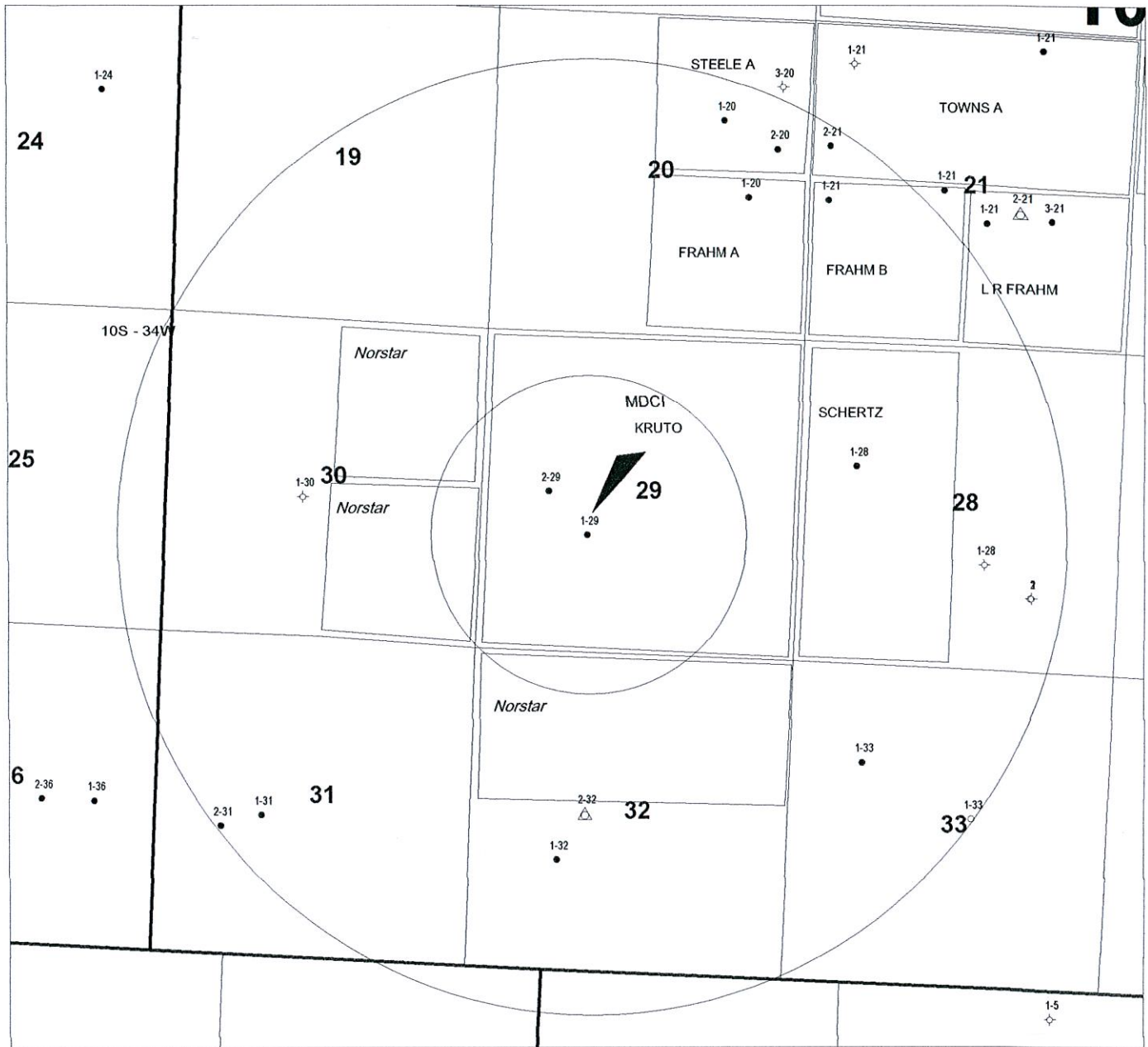



MURFIN
DRILLING COMPANY, INC.
WICHITA, KANSAS

**Commingling App., Kruto #1-29
Sec. 29-10S-34W, Thomas Co.**

Author:	Horizontal Scale:
Date: 27 February, 2013	Contour Interval:

AFFIDAVIT OF PUBLICATION
State of Kansas, Thomas County, ss:

..... Kylee Hunter, being first duly sworn, deposes and says:

that he/she is the ..Production Coordinator.. of

THE COLBY FREE PRESS

a daily newspaper printed in the state of Kansas, and published in and of general circulation in Thomas County, Kansas, with a general paid circulation on a yearly basis in Thomas County, Kansas, and that said newspaper is not a trade, religious or fraternal publication.

Said newspaper is published at least 50 times a year; has been so published continuously and uninterruptedly in said county and state for a period of more than five years prior to the first publication of said notice; and has been admitted at the post office of Colby, Kansas, in said county as second class matter.

That the attached notice is a true copy thereof and was published in the regular and entire issue of said newspaper for1.....consecutive week(s)/day(s), the first publication thereof being made as aforesaid on the7TH..... day ofMARCH....., 20 13, with subsequent publications being made on the following dates:

...../....., 20 /....., 20
...../....., 20 /....., 20
...../....., 20 /....., 20

..... Kylee Hunter

Subscribed and sworn to before me this14TH..... day ofMARCH....., 20 13

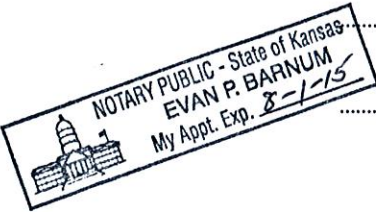

..... [Signature]

Notary Public

My commission expiresAUGUST....., 20 15
Publication Fee \$.....43.81.....
Additional copies \$.....

Public Notice

BEFORE THE STATE
CORPORATION COMMISSION
OF THE STATE OF KANSAS
NOTICE OF FILING APPLICATION

RE: Murfin Drilling Co., Inc.- Application for Commingling of Production on the Kruto #1-29, located in Thomas County, Kansas.

TO: All Oil and Gas Producers, Unleased Mineral Interest Owners, Landowners, and all persons whomever concerned.

You, and each of you, are hereby notified that Murfin Drilling Company, Inc. has filed an application for Commingling of Production from the Pawnee and the Johnson at the Kruto #1-29 well located in the NE SW NE SW of Sec. 29-10S-34W, Thomas Co., KS.

Any persons who object to or protest this application shall be required to file their objections or protest with the Conservation Division of the State Corporation Commission of the State of Kansas within fifteen (15) days from the date of this publication. These protests shall be pursuant to Commission regulations and must state specific reasons why the grant of the application may cause waste, violate correlative rights or pollute the natural resources of the State of Kansas.

All persons interested or concerned shall take notice of the foregoing and shall govern themselves accordingly.

Murfin Drilling Company, Inc.
250 N. Water, Suite 300
Wichita, KS 67202
316-267-3241

(Published in the Colby Free Press on Thursday, March 7, 2013)

AFFIDAVIT

STATE OF KANSAS \
- SS.
County of Sedgwick /

Mark Fletchall, of lawful age, being first duly sworn, deposeth and saith: That he is Record Clerk of The Wichita Eagle, a daily newspaper published in the City of Wichita, County of Sedgwick, State of Kansas, and having a general paid circulation on a daily basis in said County, which said newspaper has been continuously and uninterruptedly published in said County for more than one year prior to the first publication of the notice hereinafter mentioned, and which said newspaper has been entered as second class mail matter at the United States Post Office in Wichita, Kansas, and which said newspaper is not a trade, religious or fraternal publication and that a notice of a true copy is hereto attached was published in the regular and entire Morning issue of said The Wichita Eagle for 1 issues, that the first publication of said notice was

made as aforesaid on the 8th of

March A.D. 2013, with

subsequent publications being made on the following dates:

And affiant further says that he has personal knowledge of the statements above set forth and that they are true.

Mark Fletchall

Subscribed and sworn to before me this

8th day of March, 2013

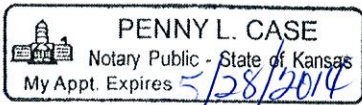

Penny L Case
Notary Public Sedgwick County, Kansas

Printer's Fee : \$98.80

LEGAL PUBLICATION
PUBLISHED IN THE WICHITA EAGLE
MARCH 8, 2013 (3234670)
BEFORE THE STATE
CORPORATION COMMISSION
OF THE STATE OF KANSAS
NOTICE OF FILING APPLICATION
RE: Murfin Drilling Co., Inc.- Application for Commingling of Production on the Kruto #1-29, located in Thomas County, Kansas.
TO: All Oil and Gas Producers, Unleased Mineral Interest Owners, Landowners, and all persons whomever concerned.
You, and each of you, are hereby notified that Murfin Drilling Company, Inc. has filed an application for Commingling of Production from the Pawnee and the Johnson at the Kruto #1-29 well located in the NE SW NE SW of Sec. 29-10S-34W, Thomas Co., KS.
Any persons who object to or protest this application shall be required to file their objections or protest with the Conservation Division of the State Corporation Commission of the State of Kansas within fifteen (15) days from the date of this publication. These protests shall be pursuant to Commission regulations and must state specific reasons why the grant of the application may cause waste, violate correlative rights or pollute the natural resources of the State of Kansas. All persons interested or concerned shall take notice of the foregoing and shall govern themselves accordingly.
Murfin Drilling Company, Inc.
250 N. Water, Suite 300
Wichita, KS 67202
316-267-3241

April 10, 2013

Kenneth Dean
Murfin Drilling Co., Inc.
250 N Water, Ste 300
Wichita, KS 67202-1216

RE: Approved Commingling CO0313120
Kruato 1-29, Sec.29-T10S-R34W, Thomas County
API No. 15-193-20840-00-00

Dear Mr. Dean:

Your Application for Commingling (ACO-4) for the above described well has been reviewed and approved by the Kansas Corporation Commission (KCC) per K.A.R. 82-3-123. Notice was examined and found to be proper per K.A.R. 82-3-135a. No protest had been filed within the 15-day protest period. This application, which was received by the KCC on March 27, 2013, concerns approval to simultaneously produce from the following sources of supply through the same tubing string in the same wellbore:

Source of Supply	Estimated Current Production			Perf Depth
	BOPD	MCFPD	BWPD	
Pawnee	103.0	0.0	42.0	4629-4634
Johnson Zn	18.0	0.0	0.0	4722-4727
Total Estimated Current Production	121.0	0.0	42.0	

Based upon the depth of the Johnson Zn formation perforations, total oil production shall not exceed 200 BOPD and total gas production shall not exceed 50% of the absolute open flow (AOF).

Commingling ID number CO031320 has been assigned to this approved application. Use this number for well completion reports (ACO-1) and other correspondence that may concern this approved commingling.

Sincerely,

Rick Hestermann
Production Department