



**APPLICATION FOR COMMINGLING OF PRODUCTION (K.A.R. 82-3-123) OR FLUIDS (K.A.R. 82-3-123a)** *Commingling ID # \_\_\_\_\_*

OPERATOR: License # \_\_\_\_\_ API No. 15 - \_\_\_\_\_  
Name: \_\_\_\_\_ Spot Description: \_\_\_\_\_  
Address 1: \_\_\_\_\_ - - - - - Sec. \_\_\_\_\_ Twp. \_\_\_\_\_ S. R. \_\_\_\_\_  East  West  
Address 2: \_\_\_\_\_ Feet from  North /  South Line of Section  
City: \_\_\_\_\_ State: \_\_\_\_\_ Zip: \_\_\_\_\_ + \_\_\_\_\_ Feet from  East /  West Line of Section  
Contact Person: \_\_\_\_\_ County: \_\_\_\_\_  
Phone: ( \_\_\_\_\_ ) \_\_\_\_\_ Lease Name: \_\_\_\_\_ Well #: \_\_\_\_\_

1. Name and upper and lower limit of each production interval to be commingled:  
Formation: \_\_\_\_\_ (Perfs): \_\_\_\_\_  
Formation: \_\_\_\_\_ (Perfs): \_\_\_\_\_  
Formation: \_\_\_\_\_ (Perfs): \_\_\_\_\_  
Formation: \_\_\_\_\_ (Perfs): \_\_\_\_\_  
Formation: \_\_\_\_\_ (Perfs): \_\_\_\_\_

2. Estimated amount of fluid production to be commingled from each interval:  
Formation: \_\_\_\_\_ BOPD: \_\_\_\_\_ MCFPD: \_\_\_\_\_ BWPD: \_\_\_\_\_  
Formation: \_\_\_\_\_ BOPD: \_\_\_\_\_ MCFPD: \_\_\_\_\_ BWPD: \_\_\_\_\_  
Formation: \_\_\_\_\_ BOPD: \_\_\_\_\_ MCFPD: \_\_\_\_\_ BWPD: \_\_\_\_\_  
Formation: \_\_\_\_\_ BOPD: \_\_\_\_\_ MCFPD: \_\_\_\_\_ BWPD: \_\_\_\_\_  
Formation: \_\_\_\_\_ BOPD: \_\_\_\_\_ MCFPD: \_\_\_\_\_ BWPD: \_\_\_\_\_

3. Plat map showing the location of the subject well, all other wells on the subject lease, and all wells on offsetting leases within a 1/2 mile radius of the subject well, and for each well the names and addresses of the lessee of record or operator.

4. Signed certificate showing service of the application and affidavit of publication as required in K.A.R. 82-3-135a.

**For Commingling of PRODUCTION ONLY, include the following:**

- 5. Wireline log of subject well. Previously Filed with ACO-1:  Yes  No
- 6. Complete Form ACO-1 (*Well Completion form*) for the subject well.

**For Commingling of FLUIDS ONLY, include the following:**

- 7. Well construction diagram of subject well.
- 8. Any available water chemistry data demonstrating the compatibility of the fluids to be commingled.

**AFFIDAVIT:** I am the affiant and hereby certify that to the best of my current information, knowledge and personal belief, this request for commingling is true and proper and I have no information or knowledge, which is inconsistent with the information supplied in this application.

**Submitted Electronically**

**KCC Office Use Only**  
 Denied  Approved  
15-Day Periods Ends: \_\_\_\_\_  
Approved By: \_\_\_\_\_ Date: \_\_\_\_\_

*Protests may be filed by any party having a valid interest in the application. Protests must be in writing and comply with K.A.R. 82-3-135b and must be filed within 15 days of publication of the notice of application.*

**AFFIDAVIT**

STATE OF KANSAS \
- SS.
County of Sedgwick /

Mark Fletchall, of lawful age, being first duly sworn, deposeth and saith: That he is Record Clerk of The Wichita Eagle, a daily newspaper published in the City of Wichita, County of Sedgwick, State of Kansas, and having a general paid circulation on a daily basis in said County, which said newspaper has been continuously and uninterruptedly published in said County for more than one year prior to the first publication of the notice hereinafter mentioned, and which said newspaper has been entered as second class mail matter at the United States Post Office in Wichita, Kansas, and which said newspaper is not a trade, religious or fraternal publication and that a notice of a true copy is hereto attached was published in the regular and entire Morning issue of said The Wichita Eagle for  1  issues, that the first publication of said notice was

made as aforesaid on the  22nd  of

April  A.D.  2013 , with

subsequent publications being made on the following dates:

**LEGAL PUBLICATION**  
PUBLISHED IN THE WICHITA EAGLE  
APRIL 22, 2013 (3241217)  
BEFORE THE STATE CORPORATION  
COMMISSION  
OF THE STATE OF KANSAS  
NOTICE OF FILING APPLICATION  
Re: Strat Land Exploration Company, License #34322 - Application for commingling of production for the McMillion 'B' #1, located in Clark County, KS  
TO: All Oil & Gas Producers, Unleased Mineral Interest Owners, Landowners and all persons concerned.  
You, and each of you, are hereby notified that Strat Land Exploration Company - has filed an application for commingling production or fluids from the Swope and St. Genevieve Formations. The subject well, the McMillion 'B' #1, is located 2338' from the north line and 2360 feet from the West line in the SE SE SE NW Section 33-Township 33 South, Range 23 West, Clark County, Kansas.  
Any persons who object to or protest this application shall be required to file their objections or protest with the Conservation Division of the State Corporation Commission of the State of Kansas within fifteen (15) days of the publication of the notice. These protests shall be filed pursuant to Commission regulations and must state specific reasons why granting the application may cause waste, violate correlative rights or pollute the natural resources of the State of Kansas.  
All persons interested or concerned shall take notice of the foregoing and shall govern themselves accordingly.  
Strat Land Exploration Company  
Rick Hall, Chief Operating Officer  
15 E 5th St, Ste 2020  
Tulsa, OK 74103  
(918) 584-3844 x21

And affiant further says that he has personal knowledge of the statements above set forth and that they are true.

*Mark Fletchall*

Subscribed and sworn to before me this

22nd  day of  April ,  2013

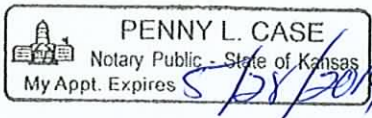

*Penny L Case*  
Notary Public Sedgwick County, Kansas

Printer's Fee : \$110.80

**Affidavit of Publication**

State of Kansas, County of Clark, ss: Thomas E. Kuhns, of lawful age, being first duly sworn on oath says that he is the principal clerk – bookkeeper of the Clark County Gazette, a weekly newspaper printed and published at Minneola, KS; that said newspaper has the following qualifications: (a) it has been published at least fifty (50) times a year and has so published at least one (1) years prior to the first publication of the attached notice; (b) it is entered at the post office as periodical mail matter; (c) it has a general paid circulation on a weekly basis in said county and it is not a trade, religious or fraternal publication; and (d) it is published in Clark County, Kansas; and that the attached legal notice being a copy of McMillion B Notice as per clipping attached, was published in the regular and entire weekly edition of said newspaper and not any supplement thereof for 1 consecutive week(s), the first publication being on the 10th of April, 2013, and the last publication being on the 10th day of April, 2013.

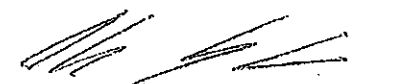

Subscribed and sworn to before me this 10<sup>th</sup> day of April, 2013.

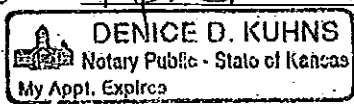

Denise D. Kuhns

My Appointment Expires: 5/09/15

Publication Fee: 81.00

Company - has filed an application for commingling production or fluids from the Swope and St. Genevieve Formations. The subject well, the McMillion 'B' #1, is located 2338' from the north line and 2360 feet from the West line in the SE SE SE NW of Section 33-Township 33 South, Range 23 West, Clark County, Kansas.

(First published in the Clark County Gazette on Wednesday, April 10, 2013.)

**BEFORE THE STATE CORPORATION COMMISSION OF THE STATE OF KANSAS NOTICE OF FILING APPLICATION**

Re: Strat Land Exploration Company, License #34322 - Application for a commingling of production for the McMillion 'B' #1, located in Clark County, KS

TO: All Oil & Gas Producers, Unleased Mineral Interest Owners, Landowners and all persons concerned.

You, and each of you, are hereby notified that Strat Land Exploration

Any persons who object to or protest this application shall be required to file their objections or protest with the Conservation Division of the State Corporation Commission of the State of Kansas within fifteen (15) days of the publication of this notice. These protests shall be filed pursuant to Commission regulations and must state specific reasons why granting the application may cause waste, violate correlative rights or pollute the natural resources of the State of Kansas.

All persons interested or concerned shall take notice of the foregoing and shall govern themselves accordingly.

Strat Land Exploration Company  
Rick Hall, Chief Operating Officer  
15 E 5<sup>th</sup> St, Ste 2020  
Tulsa, OK 74103  
(918) 584-3844 x21

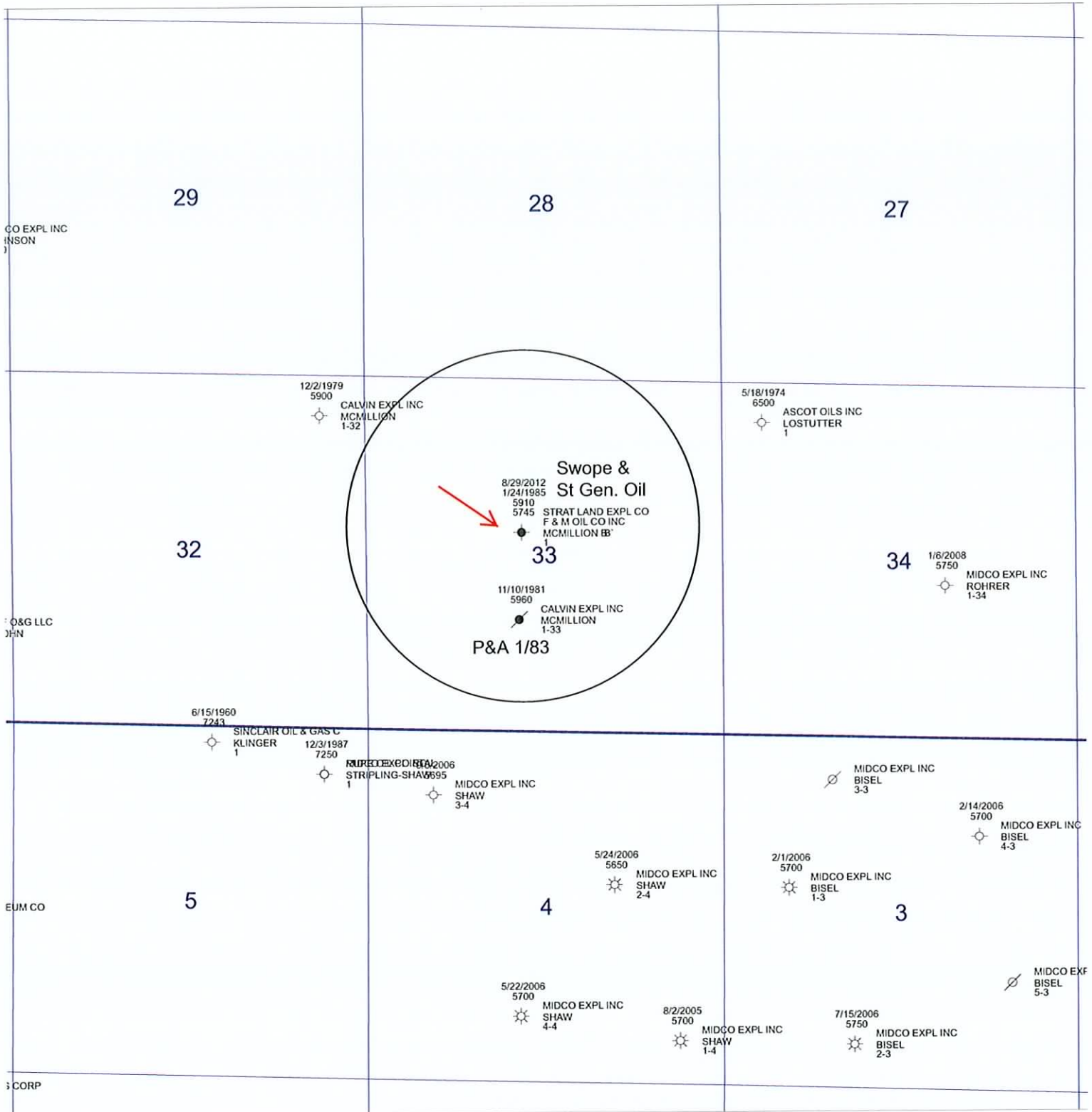

I, Dolores M Jansen, Sr. Prod/Reg Asst for Strat Land Exploration Co, do certify on behalf of Jim Bohanan, Company Geologist, that there are NO offset operators NOR unleased mineral owners within 1/2 mile of McMillion B well.

*Dolores M Jansen*  
4/29/13

<p><b>STRAT LAND EXPLORATION CO</b> Est. 1980</p>	<p><b>STRAT LAND EXPLORATION CO.</b></p>
<p>Sec 33-T33S-R23W Clark Co., KS</p>	
<p>Date: 8 April, 2013 Scale: 1" = 2000'</p>	<p>Geologist: Jim Bohanan File Name: McMillion Sec 33.gnp</p>

May 7, 2013

Dee Jansen  
Strat Land Exploration Co  
15 E. 5<sup>th</sup> St. Ste 2020  
Tulsa, OK 74103

RE: Approved Commingling CO041333  
McMillion 'B' 1, Sec. 33-T33S-R33W, Clark County  
API No. 15-025-20878-00-01

Dear Ms. Jansen:

Your Application for Commingling (ACO-4) for the above described well has been reviewed and approved by the Kansas Corporation Commission (KCC) per K.A.R. 82-3-123. Notice was examined and found to be proper per K.A.R. 82-3-135a. No protest had been filed within the 15-day protest period. This application, which was received by the KCC on April 29, 2013, concerns approval to simultaneously produce from the following sources of supply through the same tubing string in the same wellbore:

Source of Supply	Estimated Current Production			Perf Depth
	BOPD	MCFPD	BWPD	
Swope	6.0	0.0	16.0	4936-4944
St. Genevieve	2.0	0.0	9.0	5604-5622
Total Estimated Current Production	8.0	0.0	25.0	

Based upon the depth of the St. Genevieve formation perforations, total oil production shall not exceed 200 BOPD and total gas production shall not exceed 50% of the absolute open flow (AOF).

**File Form ACO-1 upon re-completion of the well to commingle.**

Commingling ID number CO041333 has been assigned to this approved application. Use this number for well completion reports (ACO-1) and other correspondence that may concern this approved commingling.

Sincerely,

Rick Hestermann  
Production Department