



KANSAS CORPORATION COMMISSION
OIL & GAS CONSERVATION DIVISION

1155000

Form ACO-4
Form must be typed
March 2009

APPLICATION FOR COMMINGLING OF PRODUCTION (K.A.R. 82-3-123) OR FLUIDS (K.A.R. 82-3-123a) *Commingling ID #* _____

OPERATOR: License # _____ API No. 15 - _____
Name: _____ Spot Description: _____
Address 1: _____ - - - - - Sec. _____ Twp. _____ S. R. _____ ☐ East ☐ West
Address 2: _____ Feet from ☐ North / ☐ South Line of Section
City: _____ State: _____ Zip: _____ + _____ Feet from ☐ East / ☐ West Line of Section
Contact Person: _____ County: _____
Phone: (_____) _____ Lease Name: _____ Well #: _____

☐ 1. Name and upper and lower limit of each production interval to be commingled:
Formation: _____ (Perfs): _____
Formation: _____ (Perfs): _____
Formation: _____ (Perfs): _____
Formation: _____ (Perfs): _____
Formation: _____ (Perfs): _____

☐ 2. Estimated amount of fluid production to be commingled from each interval:
Formation: _____ BOPD: _____ MCFPD: _____ BWPD: _____
Formation: _____ BOPD: _____ MCFPD: _____ BWPD: _____
Formation: _____ BOPD: _____ MCFPD: _____ BWPD: _____
Formation: _____ BOPD: _____ MCFPD: _____ BWPD: _____
Formation: _____ BOPD: _____ MCFPD: _____ BWPD: _____

☐ 3. Plat map showing the location of the subject well, all other wells on the subject lease, and all wells on offsetting leases within a 1/2 mile radius of the subject well, and for each well the names and addresses of the lessee of record or operator.

☐ 4. Signed certificate showing service of the application and affidavit of publication as required in K.A.R. 82-3-135a.

For Commingling of PRODUCTION ONLY, include the following:

- ☐ 5. Wireline log of subject well. Previously Filed with ACO-1: ☐ Yes ☐ No
☐ 6. Complete Form ACO-1 (*Well Completion form*) for the subject well.

For Commingling of FLUIDS ONLY, include the following:

- ☐ 7. Well construction diagram of subject well.
☐ 8. Any available water chemistry data demonstrating the compatibility of the fluids to be commingled.

AFFIDAVIT: I am the affiant and hereby certify that to the best of my current information, knowledge and personal belief, this request for commingling is true and proper and I have no information or knowledge, which is inconsistent with the information supplied in this application.

Submitted Electronically

KCC Office Use Only

☐ Denied ☐ Approved

15-Day Periods Ends: _____

Approved By: _____ Date: _____

Protests may be filed by any party having a valid interest in the application. Protests must be in writing and comply with K.A.R. 82-3-135b and must be filed within 15 days of publication of the notice of application.

CONFIDENTIAL

KANSAS CORPORATION COMMISSION 1120371
OIL & GAS CONSERVATION DIVISION

WELL COMPLETION FORM WELL HISTORY - DESCRIPTION OF WELL & LEASE

Form ACO-1

June 2009

Form Must Be Typed
Form must be Signed
All blanks must be Filled

OPERATOR: License # 30606
Name: Murfin Drilling Co., Inc.
Address 1: 250 N WATER STE 300
Address 2: _____
City: WICHITA State: KS Zip: 67202 + 1216
Contact Person: Leon Rodak
Phone: (316) 267-3241
CONTRACTOR: License # 30606
Name: Murfin Drilling Co., Inc.
Wellsite Geologist: Terry McLeod
Purchaser: MV Purchaser, LLC

Designate Type of Completion:

- ☒ New Well ☐ Re-Entry ☐ Workover
- ☒ Oil ☐ WSW ☐ SWD ☐ SOW
☐ Gas ☐ D&A ☐ ENHR ☐ SIGW
☐ OG ☐ GSW ☐ Temp. Abd.
☐ CM (Coal Bed Methane)
☐ Cathodic ☐ Other (Core, Expl., etc.): _____

If Workover/Re-entry: Old Well Info as follows:

Operator: _____
Well Name: _____
Original Comp. Date: _____ Original Total Depth: _____
☐ Deepening ☐ Re-perf. ☐ Conv. to ENHR ☐ Conv. to SWD
☐ Conv. to GSW
☐ Plug Back: _____ Plug Back Total Depth
☐ Commingled Permit #: _____
☐ Dual Completion Permit #: _____
☐ SWD Permit #: _____
☐ ENHR Permit #: _____
☐ GSW Permit #: _____

11/08/2012	11/16/2012	12/12/2012
Spud Date or	Date Reached TD	Completion Date or
Recompletion Date		Recompletion Date

API No. 15 - 15-153-20911-00-00
Spot Description: _____
NE NE NW Sec. 5 Twp. 3 S. R. 36 ☐ East ☒ West
330 Feet from ☒ North / ☐ South Line of Section
2310 Feet from ☐ East / ☒ West Line of Section
Footages Calculated from Nearest Outside Section Corner:
☐ NE ☒ NW ☐ SE ☐ SW
County: Rawlins
Lease Name: CWA 'B' Well #: 1-5
Field Name: NA
Producing Formation: LKC and Pawnee
Elevation: Ground: 3359 Kelly Bushing: 3369
Total Depth: 5100 Plug Back Total Depth: 5077
Amount of Surface Pipe Set and Cemented at: 392 Feet
Multiple Stage Cementing Collar Used? ☒ Yes ☐ No
If yes, show depth set: 3270 Feet
If Alternate II completion, cement circulated from: 3270
feet depth to: 0 w/ 225 sx cmt.

Drilling Fluid Management Plan

(Data must be collected from the Reserve Pit)

Chloride content: 1600 ppm Fluid volume: 1500 bbls
Dewatering method used: Evaporated
Location of fluid disposal if hauled offsite: _____
Operator Name: _____
Lease Name: _____ License #: _____
Quarter _____ Sec. _____ Twp. _____ S. R. _____ ☐ East ☐ West
County: _____ Permit #: _____

AFFIDAVIT

I am the affiant and I hereby certify that all requirements of the statutes, rules and regulations promulgated to regulate the oil and gas industry have been fully complied with and the statements herein are complete and correct to the best of my knowledge.

Submitted Electronically

KCC Office Use ONLY

☒ Letter of Confidentiality Received
Date: 02/28/2013
☐ Confidential Release Date: _____
☒ Wireline Log Received
☒ Geologist Report Received
☐ UIC Distribution
ALT ☒ I ☐ II ☐ III Approved by: NAOMI JAMES Date: 03/01/2013

1120371

Operator Name: Murfin Drilling Co., Inc. Lease Name: CWA 'B' Well #: 1-5
 Sec. 5 Twp. 3 S. R. 36 ☐ East ☒ West County: Rawlins

INSTRUCTIONS: Show important tops and base of formations penetrated. Detail all cores. Report all final copies of drill stems tests giving interval tested, time tool open and closed, flowing and shut-in pressures, whether shut-in pressure reached static level, hydrostatic pressures, bottom hole temperature, fluid recovery, and flow rates if gas to surface test, along with final chart(s). Attach extra sheet if more space is needed. Attach complete copy of all Electric Wire-line Logs surveyed. Attach final geological well site report.

Drill Stem Tests Taken ☒ Yes ☐ No
 (Attach Additional Sheets)

Samples Sent to Geological Survey ☒ Yes ☐ No

Cores Taken ☐ Yes ☒ No

Electric Log Run ☒ Yes ☐ No

Electric Log Submitted Electronically ☒ Yes ☐ No
 (If no, Submit Copy)

List All E. Logs Run:

Dual Induction
 Dual Compensated
 Microresistivity

☐ Log Formation (Top), Depth and Datum ☐ Sample

Name Top Datum
 See Attachment

CASING RECORD ☒ New ☐ Used

Report all strings set-conductor, surface, intermediate, production, etc.

Purpose of String	Size Hole Drilled	Size Casing Set (in O.D.)	Weight Lbs. / Ft.	Setting Depth	Type of Cement	# Sacks Used	Type and Percent Additives
Surface	12.2500	8.6250	23	392	Common	350	3%
Production	7.8750	5.5000	15.5	5092	OWC	175	

ADDITIONAL CEMENTING / SQUEEZE RECORD

Purpose:	Depth Top Bottom	Type of Cement	# Sacks Used	Type and Percent Additives
____ Perforate				
____ Protect Casing	-			
____ Plug Back TD				
____ Plug Off Zone	-			

Shots Per Foot	PERFORATION RECORD - Bridge Plugs Set/Type Specify Footage of Each Interval Perforated	Acid, Fracture, Shot, Cement Squeeze Record (Amount and Kind of Material Used)	Depth
4	4324 - 4333 LKC Lwr A	300 gal 15% MCA	
4	4360 - 4364 LKC D	260 gal 15% MCA	
4	4508 - 4513 LKC J	250 gal 15% MCA, 750 gal 15% NEFE	
4	4696 - 4700 Pawnee	250 gal 15% MCA	

TUBING RECORD: Size: <u>2 3/8</u> Set At: <u>4733</u> Packer At: <u>NA</u>		Liner Run: <input type="checkbox"/> Yes <input checked="" type="checkbox"/> No	
Date of First, Resumed Production, SWD or ENHR. <u>01/14/2013</u>		Producing Method: <input type="checkbox"/> Flowing <input checked="" type="checkbox"/> Pumping <input type="checkbox"/> Gas Lift <input type="checkbox"/> Other (Explain) _____	
Estimated Production Per 24 Hours	Oil Bbls. <u>75</u>	Gas Mcf <u>2</u>	Water Bbls. <u>36</u>

DISPOSITION OF GAS: <input type="checkbox"/> Vented <input type="checkbox"/> Sold <input type="checkbox"/> Used on Lease (If vented, Submit ACO-18.)		METHOD OF COMPLETION: <input type="checkbox"/> Open Hole <input checked="" type="checkbox"/> Perf. <input type="checkbox"/> Dually Comp. <input type="checkbox"/> Commingled (Submit ACO-5) (Submit ACO-4) <input type="checkbox"/> Other (Specify) _____		PRODUCTION INTERVAL: <u>4324 - 4700</u>
--	--	--	--	--

Affidavit of Notice Served

Re: Application for: ACO-4 Application for Commingling of Production Fluids
 Well Name: CWA B #1-5 Legal Location: NE NE NW Sec. 5-3S-36W, Rawlins Co.

The undersigned hereby certifies that he / she is a duly authorized agent for the applicant, and that on the day 22nd of August, 2013, a true and correct copy of the application referenced above was delivered or mailed to the following parties:

Note: A copy of this affidavit must be served as a part of the application.

Name

Address (Attach additional sheets if necessary)

I further attest that notice of the filing of this application was published in the The Rawlins County Square Deal, the official county publication of Rawlins county. A copy of the affidavit of this publication is attached.

Signed this 22nd day of August, 2013

Kenneth W. Dean

Applicant of Duly Authorized Agent

Subscribed and sworn to before me this 22nd day of August, 2013

Elisabeth J. Weibel
 Notary Public

My Commission Expires:

4.8.15

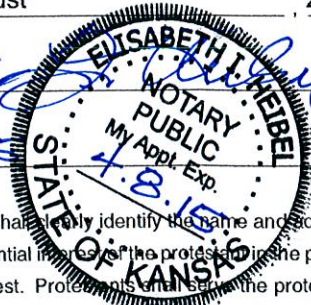

Protests may be filed by any party having a valid interest in the application. Petitions for protests shall be in writing and shall clearly identify the name and address of the protestant and the title of the application. The petition shall include a clear and concise statement of the direct and substantial interest of the protestant in the proceedings, including the manner in which the protestant may be affected, and the nature, extent, character and grounds of the protest. Protests must be filed upon the applicant by mail or personal service at the same time or before the protestant files the protest with the Conservation Division. Protests must be filed within 15 days of the publication notice of the application.

Offset Operators, Unleased Mineral Owners and Landowners acreage

(Attach additional sheets if necessary)

Name:

Murfin Drilling Co., Inc.

250 N. Water, Suite 300

Wichita, KS 67202

Antholz Family Trst

7388 Road J

McDonald, KS 67745

Legal Description of Leasehold:

S/2 Sec. 32-2S-36W, Sec. 5 and NE/4 of Sec 6

in T3S R36W Rawlins Co.

SE/4 Sec. 31-2S-36W, Rawlins Co.

I hereby certify that the statements made herein are true and correct to the best of my knowledge and belief.

 Applicant or Duly Authorized Agent
Subscribed and sworn before me this 22nd day of August, 2013

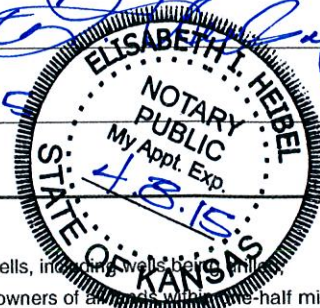
 Notary Public
My Commission Expires: 4.8.15**Instructions:**

1. Fully complete application, including page 4 (*plat map*) showing subject well and all known oil, gas and input wells, including wells being drilled, inactive wells, or dry holes, within one-half mile. Show lease names and operators or unleased mineral rights owners of all lands within one-half mile. Show well numbers and elevations of producing formation tops.
2. Attach some type of log (*drillers log, electric log, etc.*).
3. Attach some type of verification of cementing for surface casing, longstring, D.V. tool, perforations, etc. (*Cement ticket and job log, bond log, etc.*)
4. Attach Affidavit of Notice.
5. Fill in schematic drawing of subsurface facilities including: size, setting depth, amount of cement, measured or calculated tops of cement for each of surface, intermediate (*if any*) and production casing; size and setting depth of tubing and packer; geological zone of injection showing top and bottom of injection interval.
6. The original and one copy of the application and all attachments shall be mailed to the State Corporation Commission, Conservation Division.
7. Deliver or mail one (1) copy of the application to the landowner on whose land the injection well is located and to each operator or lessee of record and each unleased mineral rights owner within one-half mile of the applicant well.
8. Approval of this application, if granted, is valid only as long as there are no substantial changes in operation set forth in the application. A substantial change requires the approval of a new application. **No injection well may be used without prior written authorization.**

AFFIDAVIT

STATE OF KANSAS \
- SS.
County of Sedgwick /

Mark Fletchall, of lawful age, being first duly sworn, deposeth and saith: That he is Record Clerk of The Wichita Eagle, a daily newspaper published in the City of Wichita, County of Sedgwick, State of Kansas, and having a general paid circulation on a daily basis in said County, which said newspaper has been continuously and uninterruptedly published in said County for more than one year prior to the first publication of the notice hereinafter mentioned, and which said newspaper has been entered as second class mail matter at the United States Post Office in Wichita, Kansas, and which said newspaper is not a trade, religious or fraternal publication and that a notice of a true copy is hereto attached was published in the regular and entire Morning issue of said The Wichita Eagle for 1 issues, that the first publication of said notice was

made as aforesaid on the 20th

June A.D. 2013, with

subsequent publications being made on the following dates:

And affiant further says that he has personal knowledge of the statements above set forth and that they are true.

Mark Fletchall

Subscribed and sworn to before me this

20th day of June, 2013

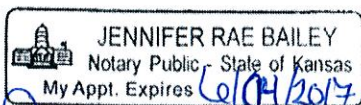

[Signature]
Notary Public Sedgwick County, Kansas

Printer's Fee : \$98.80

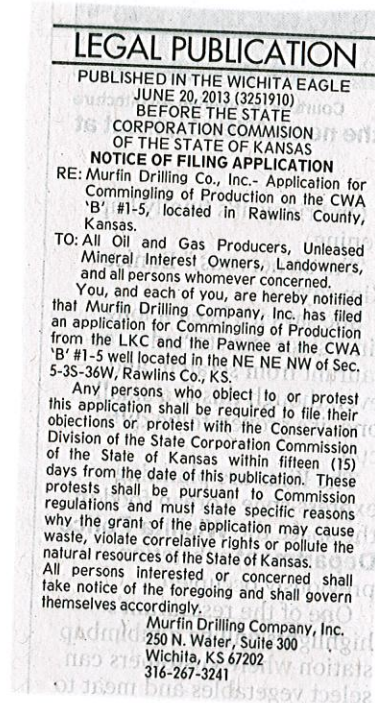

Affidavit of Publication
STATE OF KANSAS, RAWLINS COUNTY, ss:

Mary K. Holle

Being first duly sworn, Deposes and says: That
she is

EDITOR-OWNER

of the Rawlins County Square Deal, a weekly Newspaper printed in the State of Kansas, and published in and of general circulation in Rawlins County, Kansas, with a general paid circulation on a weekly basis in Rawlins County, Kansas, and that said newspaper is not a trade, religious nor fraternal publication.

Said newspaper is a Weekly published at least weekly 50 times a year; has been so published continuously and uninterruptedly in said county and state for a period of more than one year prior to the first publication of said notice and was designated by Resolution 93 R 8 of the Rawlins County Commissioners to be the official county newspaper and further designated by Resolution 93 R 9 of the Atwood City Council to be the official city newspaper. The Rawlins County Square Deal has been admitted at the post office of Atwood in said County as second class matter.

That the attached notice is a true copy thereof and was published in the regular and entire issue of said newspaper

for 1 consecutive weeks, the first publication thereof
being made as aforesaid on the 27th day of June

2013, with subsequent publications being made on the following dates:

_____ , 2013	_____ , 20
_____ , 2013	_____ , 20
_____ , 2013	_____ , 20

Mary K. Holle

Subscribed and sworn to before me this 28th day of
June , 2013.

Rosalie Russell Ross

Notary Public

My appointment expires: 4-17-2015

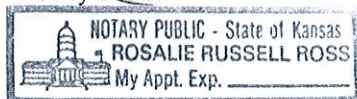

Printer's fee: \$ 44.20

Additional copies: \$ _____

(First published in The Rawlins County Square Deal, Thursday, June 27, 2013 - 1t.)

BEFORE THE STATE CORPORATION COMMISSION OF THE STATE OF KANSAS

NOTICE OF FILING APPLICATION

RE: Murfin Drilling Co., Inc. - Application for Commingling of Production on the CWA 'B' #1-5, located in Rawlins County, Kansas.

TO: All Oil and Gas Producers, Un-

leased Mineral Interest Owners, Landowners and all persons whomsoever concerned.

You, and each of you, are hereby notified that Murfin Drilling Company, Inc. has filed an application for Commingling of Production from the LKC and the Pawnee at the CWA 'B' #1-5 well located in the NE NE NW of Sec. 5-3S-36W, Rawlins Co., KS.

Any persons who object to or protest this application shall be required to file their objections or protest with the Conservation Division of the State Corporation Commission of the State of Kansas within fifteen (15) days from the date of this publication. These protests shall be pursuant to Commission regulations and must state specific reasons why the grant of the application may cause waste, violate correlative rights or pollute the natural resources of the State of Kansas.

All persons interested or concerned shall take notice of the foregoing and shall govern themselves accordingly.

Murfin Drilling Company, Inc.
250 N. Water, Suite 300
Wichita, KS 67202
316-267-3241

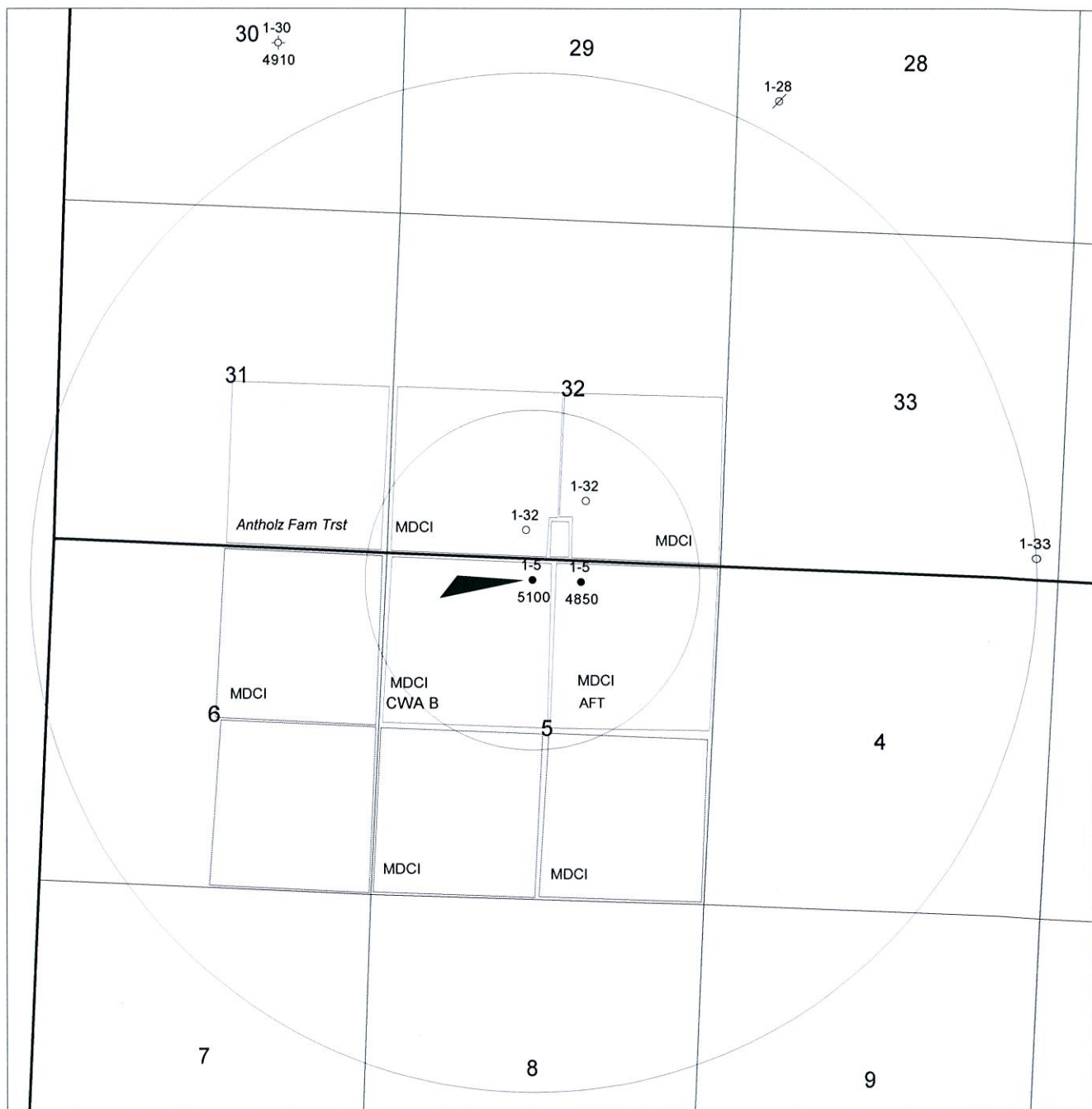

3 S / 36 W



Commingling Application
CWA 'B' #1-5
Sec. 5-3S-36W, Rawlins Co., KS

Author:
Date: 12 August, 2013

Horizontal Scale:
Contour Interval:

September 6 , 2013

Kenneth Dean
Murfin Drilling Co., Inc.
250 N Water, Ste 300
Wichita, KS 67202-1216

RE: Approved Commingling CO081306
CWA 'B' 1-5, Sec.5-T3S-R36W, Rawlins County
API No. 15-153-20911-00-00

Dear Mr. Dean:

Your Application for Commingling (ACO-4) for the above described well has been reviewed and approved by the Kansas Corporation Commission (KCC) per K.A.R. 82-3-123. Notice was examined and found to be proper per K.A.R. 82-3-135a. No protest had been filed within the 15-day protest period. This application, which was received by the KCC on August 22, 2013, concerns approval to simultaneously produce from the following sources of supply through the same tubing string in the same wellbore:

Source of Supply	Estimated Current Production			Perf Depth
	BOPD	MCFPD	BWPD	
LKC	72.00	0.00	0.50	4324-4513
Pawnee	3.00	0.00	1.50	4696-4711
Total Estimated Current Production	75.00	0.00	2.00	

Based upon the depth of the Pawnee formation perforations, total oil production shall not exceed 200 BOPD and total gas production shall not exceed 50% of the absolute open flow (AOF).

Commingling ID number CO081306 has been assigned to this approved application. Use this number for well completion reports (ACO-1) and other correspondence that may concern this approved commingling.

Sincerely,

Rick Hestermann
Production Department