

10S-34W

Murfin #1 James A

NE/4 Murfin

22 E/2 Owner=John James
804 Central Ave.
Nebraska City, NE 68410

SE/4 Open??

NE/4 Slawson
N/2 Owner=John James
804 Central Ave.
Nebraska City, NE 68410
NW/4 Murfin
SECI #3 James AY

23 SECI #1 James AY

SECI #1 James BE

SW/4 & SE/4 Slawson
S/2 Owner=John James
804 Central Ave.
Nebraska City, NE 68410

SECI #2 James BE

SECI #2 James AY

Murfin #1 Epard

SECI #3 Hills Trust

SECI #1 Hills Trust

SECI #2 Hills Trust

SECI #5 Hills Trust

E/2 Murfin
27 E/2 Owner=Epard Farms
1380 County Road 21
Colby, Ks 67701-9130

26

SE, NW & NE/4 SECI

NW, SW, & SE/4 Owner=Mike Moses
1601 County Rd T
Colby, Ks 67701

SW/4 - Open??

NW/4 Slawson
Owner=Robt. L. Soucie
Box 25
Upland, NE 68981

SECI #1 Soucie K

SECI #2 Soucie K 24

Norstar Epard #1

SW/4 Norstar
SW/4 Owner= Epard Farms
1380 County Road 21
Colby, Ks 67701-9130

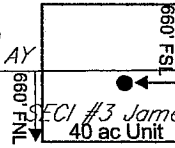

SECI #3 James



NE/4 Owner=John James
804 Central Ave.
Nebraska City, NE 68410

SECI #2 James

W/2 Russell Oil

W/2 Owner=Raymond Ward Dumler
14545 Inverness St.
Olathe, Ks 66061 25

34

35

36

Slawson Exploration Co., Inc.

Thomas County, Kansas
County Line & County Line West Prospect
James #3-26 Unit

Mary Powell

CL =

10/28/2013

Scale 1:21120.

3" = 1 mile