



APPLICATION FOR COMMINGLING OF PRODUCTION (K.A.R. 82-3-123) OR FLUIDS (K.A.R. 82-3-123a) *Commingling ID #* _____

OPERATOR: License # _____ API No. 15 - _____
Name: _____ Spot Description: _____
Address 1: _____ - - - - - Sec. _____ Twp. _____ S. R. _____ East West
Address 2: _____ Feet from North / South Line of Section
City: _____ State: _____ Zip: _____ + _____ Feet from East / West Line of Section
Contact Person: _____ County: _____
Phone: (_____) _____ Lease Name: _____ Well #: _____

1. Name and upper and lower limit of each production interval to be commingled:
Formation: _____ (Perfs): _____
Formation: _____ (Perfs): _____
Formation: _____ (Perfs): _____
Formation: _____ (Perfs): _____
Formation: _____ (Perfs): _____

2. Estimated amount of fluid production to be commingled from each interval:
Formation: _____ BOPD: _____ MCFPD: _____ BWPD: _____
Formation: _____ BOPD: _____ MCFPD: _____ BWPD: _____
Formation: _____ BOPD: _____ MCFPD: _____ BWPD: _____
Formation: _____ BOPD: _____ MCFPD: _____ BWPD: _____
Formation: _____ BOPD: _____ MCFPD: _____ BWPD: _____

3. Plat map showing the location of the subject well, all other wells on the subject lease, and all wells on offsetting leases within a 1/2 mile radius of the subject well, and for each well the names and addresses of the lessee of record or operator.

4. Signed certificate showing service of the application and affidavit of publication as required in K.A.R. 82-3-135a.

For Commingling of PRODUCTION ONLY, include the following:

- 5. Wireline log of subject well. Previously Filed with ACO-1: Yes No
- 6. Complete Form ACO-1 (*Well Completion form*) for the subject well.

For Commingling of FLUIDS ONLY, include the following:

- 7. Well construction diagram of subject well.
- 8. Any available water chemistry data demonstrating the compatibility of the fluids to be commingled.

AFFIDAVIT: I am the affiant and hereby certify that to the best of my current information, knowledge and personal belief, this request for commingling is true and proper and I have no information or knowledge, which is inconsistent with the information supplied in this application.

Submitted Electronically

KCC Office Use Only
 Denied Approved
15-Day Periods Ends: _____
Approved By: _____ Date: _____

Protests may be filed by any party having a valid interest in the application. Protests must be in writing and comply with K.A.R. 82-3-135b and must be filed within 15 days of publication of the notice of application.

10S-34W

Murfin #1 James A

NE/4 Murfin

22 E/2 Owner=John James
804 Central Ave.
Nebraska City, NE 68410

SE/4 Open??

N/2 Owner=John James
804 Central Ave.
Nebraska City, NE 68410

NW/4 Murfin

SECI #3 James AY

23 SECI #1 James AY

SECI #1 James BE

SW/4 & SE/4 Slawson
S/2 Owner=John James
804 Central Ave.
Nebraska City, NE 68410

SECI #2 James BE

SECI #2 James AY

Murfin #1 Epard

SECI #3 Hills Trust

SECI #1 Hills Trust

SECI #2 Hills Trust

SECI #5 Hills Trust

E/2 Murfin
27 E/2 Owner=Epard Farms
1380 County Road 21
Colby, Ks 67701-9130

26

SE, NW & NE/4 SECI

NW, SW, & SE/4 Owner=Mike Moses
1601 County Rd T
Colby, Ks 67701

SW/4 - Open??

NE/4 Slawson

NW/4 Slawson
Owner=Robt. L. Soucie
Box 25
Upland, NE 68981

SECI #1 Soucie K

SECI #2 Soucie K 24

Norstar Epard #1

SW/4 Norstar
SW/4 Owner= Epard Farms
1380 County Road 21
Colby, Ks 67701-9130

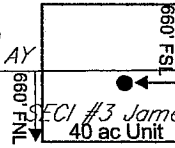

W/2 Russell Oil

W/2 Owner=Raymond Ward Dumler
14545 Inverness St.
Olathe, Ks 66061 25

34

35

36

Slawson Exploration Co., Inc.

Thomas County, Kansas
County Line & County Line West Prospect
James #3-26 Unit

Mary Powell

CL =

10/28/2013

Scale 1:21120.

3" = 1 mile

AFFIDAVIT OF MAILING

I, Steve Slawson , VP Operations, hereby swear that on the date below a copy of the Application for Commingling of Production (KCC ACO-4) James AY #3 was mailed to the following parties:

Landowner: James Family
804 Central Ave
Nebraska City, NE 68410

Offset Operators: Murfin Oil
250 N Water, #300
Wichita, KS 67202

Norstar Petroleum Inc
88 Iverness Cir E, Unit F104
Englewood CO, 80112

Russell Oil, Inc
PO Box 8050
Edmond, OK 73083

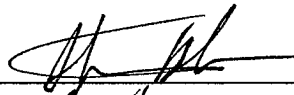
Signed 
Date 10/28/13

This instrument was acknowledged before me on 10/22/13
by Steve Slawson , Slawson Exploration Co., Inc.

Notary 

My Commission Expires



AFFIDAVIT OF PUBLICATION
State of Kansas, Thomas County, ss:

.....Kylee Hunter....., being first duly sworn, deposes and says:
that he/she is the Production Coordinator of

THE COLBY FREE PRESS

a daily newspaper printed in the state of Kansas, and published in and of general circulation in Thomas County, Kansas, with a general paid circulation on a yearly basis in Thomas County, Kansas, and that said newspaper is not a trade, religious or fraternal publication.

Said newspaper is published at least 50 times a year; has been so published continuously and uninterruptedly in said county and state for a period of more than five years prior to the first publication of said notice; and has been admitted at the post office of Colby, Kansas, in said county as second class matter.

That the attached notice is a true copy thereof and was published in the regular and entire issue of said newspaper for1.....consecutive week(s)/day(s), the first publication thereof being made as aforesaid on the31ST..... day ofOCTOBER....., 20 13, with subsequent publications being made on the following dates:

.....1....., 201....., 201....., 201....., 20

.....Kylee Hunter.....

Subscribed and sworn to before me this15TH..... day ofNOVEMBER....., 20 13

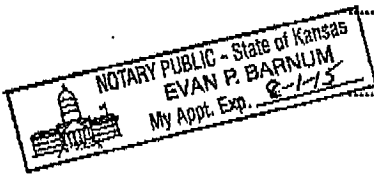

.....[Signature].....
Notary Public

My commission expiresAUGUST 1....., 20 15
Publication Fee \$.....43.81.....
Additional copies \$.....

Public Notice

**BEFORE THE
STATE CORPORATION COMMISSION
OF THE STATE OF KANSAS
NOTICE OF FILING APPLICATION**

RE: Slawson Exploration Co., Inc. - Application for Commingling of Production on the James AY #3, located in Thomas County, Kansas.

TO: All Oil and Gas Producers, Unleased Mineral Interest Owners, Landowners, and all persons whomsoever concerned.

You, and each of you, are hereby notified that Slawson Exploration Co., Inc. has filed an application for Commingling of Production from the Johnson and the Myrick Station Zones at the James AY #3 well located in the NW 6W NE of Sec. 23-10S-34W, Thomas Co, KS.

Any persons who object to or protest this application, shall be required to file their objections or protest with the Conservation Division of the State Corporation Commission of the State of Kansas within fifteen (15) days from the date of this publication. These protests shall be pursuant to Commission regulations and must state specific reasons why the grant of the application may cause waste, violate correlative rights or pollute the natural resources of the State of Kansas.

All persons interested or concerned shall take notice of the foregoing and shall govern themselves accordingly.

Slawson Exploration Company, Inc.
204 N. Robinson, Ste 2300,
OKC, OK 73102
405-232-0201

(Published in the Colby Free Press on
Thursday, October 31, 2013)

AFFIDAVIT

STATE OF KANSAS

SS.

County of Sedgwick

Mark Fletchall, of lawful age, being first duly sworn, deposeth and saith: That he is Record Clerk of The Wichita Eagle, a daily newspaper published in the City of Wichita, County of Sedgwick, State of Kansas, and having a general paid circulation on a daily basis in said County, which said newspaper has been continuously and uninterruptedly published in said County for more than one year prior to the first publication of the notice hereinafter mentioned, and which said newspaper has been entered as second class mail matter at the United States Post Office in Wichita, Kansas, and which said newspaper is not a trade, religious or fraternal publication and that a notice of a true copy is hereto attached was published in the regular and entire Morning issue of said The Wichita Eagle for 1 issues, that the first publication of said notice was

made as aforesaid on the 1st of

November A.D. 2013, with

subsequent publications being made on the following dates:

And affiant further says that he has personal knowledge of the statements above set forth and that they are true.

Mark Fletchall

Subscribed and sworn to before me this

1st day of November, 2013

JENNIFER RAE BAILEY
Notary Public - State of Kansas
My Appl. Expires 10/9/2017

Jennifer Rae Bailey
Notary Public Sedgwick County, Kansas

Printer's Fee : \$101.20

LEGAL PUBLICATION
PUBLISHED IN THE WICHITA EAGLE
NOVEMBER 1, 2013 (3273248)
BEFORE THE STATE CORPORATION
COMMISSION OF THE STATE OF
KANSAS
NOTICE OF FILING APPLICATION
RE: Slewsen Exploration Co., Inc.
Application for Commencing of Production
on the James AY #3, located in Thomas
County, Kansas
TO: All Oil and Gas Producers, Unleased
Mineral Interest Owners, Landowners, and
all persons whomsoever concerned.
You, and each of you, are hereby notified
that Slewsen Exploration Co., Inc. has
filed an application for commencing of
production from the Johnson and
Merrick Station Zones of the James AY
#3 well located in the NW SW NE of Sec
23-19S-34W, Thomas Co., KS.
Any persons who object to or protest this
application shall be required to file their
objections or protest with the Conservation
Division of the State Corporation
Commission of the State of Kansas
within fifteen (15) days from the date of
this publication. These protests shall be
pursuant to Commission regulations and
must state specific reasons why the grant
of the application may cause waste, violate
correlative rights, or pollute the natural
resources of the State of Kansas.
All persons interested or concerned shall
take notice of the foregoing and shall
govern themselves accordingly.
Slewsen Exploration Company, Inc. 204
N. Robinson, Ste 2300, OKC, OK 73102
405-222-0201.

November 20, 2013

Slawson Exploration Co., Inc.
204 N Robinson, Ste 2300
Oklahoma City, OK 73102

RE: Approved Commingling CO111305
James AY 3, Sec.23-T10S-R34W, Thomas County
API No. 15-193-20898-00-00

Dear Mr. Slawson:

Your Application for Commingling (ACO-4) for the above described well has been reviewed and approved by the Kansas Corporation Commission (KCC) per K.A.R. 82-3-123. Notice was examined and found to be proper per K.A.R. 82-3-135a. No protest had been filed within the 15-day protest period. This application, which was received by the KCC on November 20, 2013, concerns approval to simultaneously produce from the following sources of supply through the same tubing string in the same wellbore:

Source of Supply	Estimated Current Production			Perf Depth
	BOPD	MCFPD	BWPD	
Johnson	20	0	10	4675-4702
Myrick	5	0	15	4584-4586
Total Estimated Current Production	25	0	25	

Based upon the depth of the Johnson formation perforations, total oil production shall not exceed 200 BOPD and total gas production shall not exceed 50% of the absolute open flow (AOF).

Commingling ID number CO111305 has been assigned to this approved application. Use this number for well completion reports (ACO-1) and other correspondence that may concern this approved commingling.

Sincerely,

Rick Hestermann
Production Department