



APPLICATION FOR COMMINGLING OF PRODUCTION (K.A.R. 82-3-123) OR FLUIDS (K.A.R. 82-3-123a) *Commingling ID # _____*

OPERATOR: License # _____ API No. 15 - _____
Name: _____ Spot Description: _____
Address 1: _____ Sec. _____ Twp. _____ S. R. _____ East West
Address 2: _____ Feet from North / South Line of Section
City: _____ State: _____ Zip: _____ + _____ Feet from East / West Line of Section
Contact Person: _____ County: _____
Phone: (_____) _____ Lease Name: _____ Well #: _____

1. Name and upper and lower limit of each production interval to be commingled:
Formation: _____ (Perfs): _____
Formation: _____ (Perfs): _____
Formation: _____ (Perfs): _____
Formation: _____ (Perfs): _____
Formation: _____ (Perfs): _____

2. Estimated amount of fluid production to be commingled from each interval:
Formation: _____ BOPD: _____ MCFPD: _____ BWPD: _____
Formation: _____ BOPD: _____ MCFPD: _____ BWPD: _____
Formation: _____ BOPD: _____ MCFPD: _____ BWPD: _____
Formation: _____ BOPD: _____ MCFPD: _____ BWPD: _____
Formation: _____ BOPD: _____ MCFPD: _____ BWPD: _____

3. Plat map showing the location of the subject well, all other wells on the subject lease, and all wells on offsetting leases within a 1/2 mile radius of the subject well, and for each well the names and addresses of the lessee of record or operator.

4. Signed certificate showing service of the application and affidavit of publication as required in K.A.R. 82-3-135a.

For Commingling of PRODUCTION ONLY, include the following:

- 5. Wireline log of subject well. Previously Filed with ACO-1: Yes No
- 6. Complete Form ACO-1 (*Well Completion form*) for the subject well.

For Commingling of FLUIDS ONLY, include the following:

- 7. Well construction diagram of subject well.
- 8. Any available water chemistry data demonstrating the compatibility of the fluids to be commingled.

AFFIDAVIT: I am the affiant and hereby certify that to the best of my current information, knowledge and personal belief, this request for commingling is true and proper and I have no information or knowledge, which is inconsistent with the information supplied in this application.

Submitted Electronically

KCC Office Use Only
 Denied Approved
15-Day Periods Ends: _____
Approved By: _____ Date: _____

Protests may be filed by any party having a valid interest in the application. Protests must be in writing and comply with K.A.R. 82-3-135b and must be filed within 15 days of publication of the notice of application.

Proof of Publication

State of Kansas,
County of Haskell, ss:

Rolf Jungclas

of lawful age, being duly sworn upon oath states that he/she is the editor of **THE HASKELL COUNTY MONITOR CHIEF**.

THAT said newspaper has been published at least weekly 50 times a year and has been so published for at least five years prior to the first publication of the attached notice.

THAT said newspaper was entered as second class matter at the post office of its publication;

THAT said newspaper has a general paid circulation on a daily, weekly, monthly, or yearly basis in HASKELL County, Kansas and is NOT a trade, religious or fraternal publication and has been printed and published in HASKELL County, Kansas.

THE ATTACHED was published on the following dates in a regular issue of said newspaper:

1st Publication was made on the 11 day of Dec, 20 13

2nd Publication was made on the _____ day of _____, 20 _____

3rd Publication was made on the _____ day of _____, 20 _____

4th Publication was made on the _____ day of _____, 20 _____

5th Publication was made on the _____ day of _____, 20 _____

6th Publication was made on the _____ day of _____, 20 _____

Publication fee	\$ <u>5850</u>
Affidavit, Notary's Fees	\$ _____
Additional Copies _____ @ _____	\$ _____
Total Publication Fee	\$ <u>5850</u>

Rolf Jungclas

(Signed)

Witness my hand this 11 day of Dec, 20 13

SUBSCRIBED and SWORN to before me this 11

day of Dec, 20 13.

Kelly C Anderson
(Notary Public)

My commission expires 2-7-2014



Legal Notice

Cimarex Energy Co
348 Rd DD
Satanta, KS 67870
620-276-3693

(Published in the Haskell County Monitor-Chief on Wednesday, December 11, 2013.)

BEFORE THE STATE CORPORATION COMMISSION OF THE STATE OF KANSAS

NOTICE OF FILING APPLICATION

RE: CIMAREX ENERGY CO APPLICATION FOR A PERMIT TO AUTHORIZE THE COMMINGLING OF ZONES IN THE HAMMER 19-4, LOCATED IN HASKELL COUNTY, KANSAS

TO ALL OIL & GAS PRODUCERS, UNLEASED MINERAL INTEREST OWNERS, LANDOWNERS, AND ALL PERSONS WHOMEVER CONCERNED.

You, and each of you, are hereby notified that Cimarex Energy Co. has filed an application to commingle Drum, Atoka, Morrow and Chester zones in the Hammer 19-4, located in the NE, SE, Sec. 19, T30S, R31W, Haskell County, Kansas.

Any persons who object to or protest this application shall be required to file their objections or protest with the Conservation Division of the State Corporation Commission of the State of Kansas within thirty (15) days from the date of this publication. These protests shall be filed pursuant to Commission regulations and must state specific reasons why the grant of the application may cause waste violate correlative rights or pollute the natural resources of the State of Kansas. If no protests are received, this matter will be set hearing.

All persons interested or concerned shall take notice of the foregoing and shall govern themselves accordingly.

AFFIDAVIT

STATE OF KANSAS \
- SS.
County of Sedgwick /

Mark Fletchall, of lawful age, being first duly sworn, deposeth and saith: That he is Record Clerk of The Wichita Eagle, a daily newspaper published in the City of Wichita, County of Sedgwick, State of Kansas, and having a general paid circulation on a daily basis in said County, which said newspaper has been continuously and uninterruptedly published in said County for more than one year prior to the first publication of the notice hereinafter mentioned, and which said newspaper has been entered as second class mail matter at the United States Post Office in Wichita, Kansas, and which said newspaper is not a trade, religious or fraternal publication and that a notice of a true copy is hereto attached was published in the regular and entire Morning issue of said The Wichita Eagle for 1 issues, that the first publication of said notice was

made as aforesaid on the 2nd of

November A.D. 2013, with

subsequent publications being made on the following dates:

And affiant further says that he has personal knowledge of the statements above set forth and that they are true.

Mark Fletchall

Subscribed and sworn to before me this

4th day of November, 2013



Jennifer Rae Bailey
Notary Public Sedgwick County, Kansas

Printer's Fee : \$108.40

LEGAL PUBLICATION
PUBLISHED IN THE WICHITA EAGLE
NOVEMBER 2, 2013 (3273582)
BEFORE THE STATE CORPORATION
COMMISSION OF THE STATE OF KANSAS
NOTICE OF FILING APPLICATION
RE: CIMAREX ENERGY CO.
APPLICATION FOR A PERMIT TO
AUTHORIZE THE COMMINGLING OF
ZONES IN THE HAMMER 19-4, LOCATED
IN HASKELL COUNTY, KANSAS
TO: ALL OIL & GAS PRODUCERS,
UNLEASED MINERAL INTEREST
OWNERS, LANDOWNERS, AND ALL
PERSONS WHOMEVER CONCERNED.
You, and each of you, are hereby notified that
Cimarex Energy Co. has filed an application
to commingle Drum, Atoka, Morrow and
Chester zones in the Hammer 19-4, located
in the NE, SE, Sec. 19, T30S, R31W, Haskell
County, Kansas.
Any persons who object to or protest this
application shall be required to file their
objections or protest with the Conservation
Division of the State Corporation Commission
of the State of Kansas within thirty (15) days
from the date of this publication. These
protests shall be filed pursuant to Commission
regulations and must state specific reasons
why the grant of the application may cause
waste violate correlative rights or pollute the
natural resources of the State of Kansas. If
no protests are received, this matter will be
set hearing.
All persons interested or concerned shall
take notice of the foregoing and shall govern
themselves accordingly.
Cimarex Energy Co
348 Rd. DD
Saratoga, KS 67870
620-276-3693

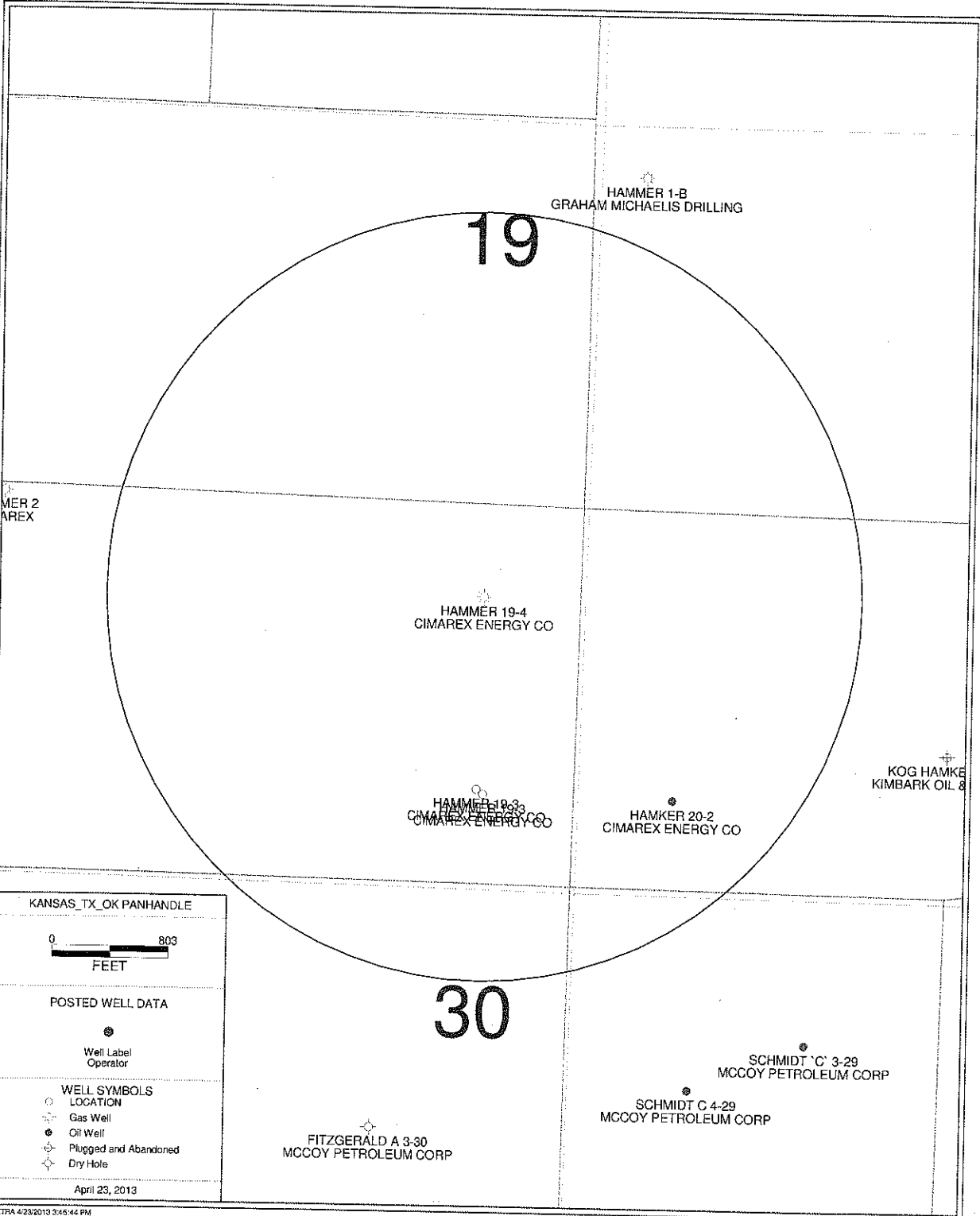



CERTIFICATE OF SERVICE

I hereby certify on this 11 day of December, 2013, true and correct copies of the above and foregoing Application for the Commingling of production were served by depositing copies of the same in the United States Mail, postage prepaid, on the 11th day of December, 2013 addressed to the following persons or entities:

McCoy Petroleum Corporation
8080 E. Central Ave Ste. 300
Wichita, KS 67206-2366

Who are all of the operators of leases, owners of record of the minerals in unleased acreage, and surface owner within a one-half mile radius of the Hammer 19-4.

Melissa Imler

Mark Sievers, Chairman
Thomas E. Wright, Commissioner
Shari Feist Albrecht, Commissioner

Sam Brownback, Governor

January 2, 2014

Melissa Imler
Cimarex Energy Co.
348 Rd. DD
Satanta, KS 67870

RE: Approved Commingling CO121303
Hammer 19-4, Sec.19-T30S-R31W, Haskell County
API No. 15-081-22007-00-00

Dear Ms. Imler:

Your Application for Commingling (ACO-4) for the above described well has been reviewed and approved by the Kansas Corporation Commission (KCC) per K.A.R. 82-3-123. Notice was examined and found to be proper per K.A.R. 82-3-135a. No protest had been filed within the 15-day protest period. This application, which was received by the KCC on December 18, 2013, concerns approval to simultaneously produce from the following sources of supply through the same tubing string in the same wellbore:

Source of Supply	Estimated Current Production			Perf Depth
	BOPD	MCFPD	BWPD	
Drum	30	6	15	4531-4534
Atoka	2	7	15	5147-5188
Morrow	12	65	0	5319-5352
Chester	2	450	10	5465-5479
Total Estimated Current Production	46	528	40	

Based upon the depth of the Chester formation perforations, total oil production shall not exceed 200 BOPD and total gas production shall not exceed 50% of the absolute open flow (AOF).

File form ACO-1 upon completion of the well to commingle.

Commingling ID number CO121303 has been assigned to this approved application. Use this number for well completion reports (ACO-1) and other correspondence that may concern this approved commingling.

Sincerely,

Rick Hestermann
Production Department