



APPLICATION FOR COMMINGLING OF PRODUCTION (K.A.R. 82-3-123) OR FLUIDS (K.A.R. 82-3-123a) *Commingling ID # _____*

OPERATOR: License # _____ API No. 15 - _____
Name: _____ Spot Description: _____
Address 1: _____ - - - - - Sec. _____ Twp. _____ S. R. _____ East West
Address 2: _____ Feet from North / South Line of Section
City: _____ State: _____ Zip: _____ + _____ Feet from East / West Line of Section
Contact Person: _____ County: _____
Phone: (_____) _____ Lease Name: _____ Well #: _____

1. Name and upper and lower limit of each production interval to be commingled:
Formation: _____ (Perfs): _____
Formation: _____ (Perfs): _____
Formation: _____ (Perfs): _____
Formation: _____ (Perfs): _____
Formation: _____ (Perfs): _____

2. Estimated amount of fluid production to be commingled from each interval:
Formation: _____ BOPD: _____ MCFPD: _____ BWPD: _____
Formation: _____ BOPD: _____ MCFPD: _____ BWPD: _____
Formation: _____ BOPD: _____ MCFPD: _____ BWPD: _____
Formation: _____ BOPD: _____ MCFPD: _____ BWPD: _____
Formation: _____ BOPD: _____ MCFPD: _____ BWPD: _____

3. Plat map showing the location of the subject well, all other wells on the subject lease, and all wells on offsetting leases within a 1/2 mile radius of the subject well, and for each well the names and addresses of the lessee of record or operator.

4. Signed certificate showing service of the application and affidavit of publication as required in K.A.R. 82-3-135a.

For Commingling of PRODUCTION ONLY, include the following:

- 5. Wireline log of subject well. Previously Filed with ACO-1: Yes No
- 6. Complete Form ACO-1 (*Well Completion form*) for the subject well.

For Commingling of FLUIDS ONLY, include the following:

- 7. Well construction diagram of subject well.
- 8. Any available water chemistry data demonstrating the compatibility of the fluids to be commingled.

AFFIDAVIT: I am the affiant and hereby certify that to the best of my current information, knowledge and personal belief, this request for commingling is true and proper and I have no information or knowledge, which is inconsistent with the information supplied in this application.

Submitted Electronically

KCC Office Use Only
 Denied Approved
15-Day Periods Ends: _____
Approved By: _____ Date: _____

Protests may be filed by any party having a valid interest in the application. Protests must be in writing and comply with K.A.R. 82-3-135b and must be filed within 15 days of publication of the notice of application.

R 30 W

T
17
S

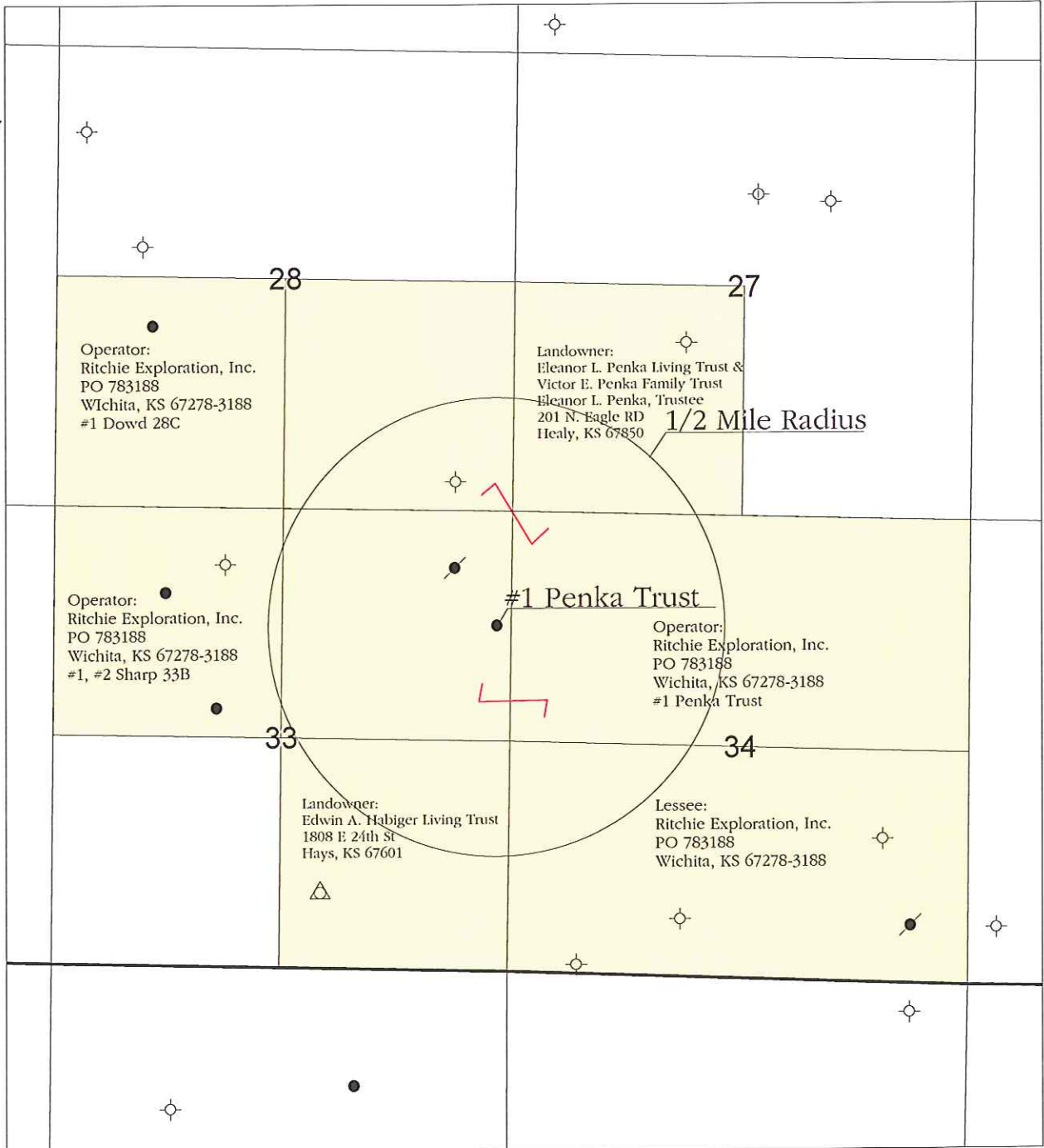

Legend

- Oil Well
- / Abandoned Oil Well
- △ Service Well
- ⊕ Dry and Abandoned Well



Application for
Commingling of
Production or Fluids

Applicant Well: #1 Penka Trust
All Wells on Offsetting Leases within 1/2 Mile Radius
Name and Address of Lessee of Record or Operator
On Offsetting Leases

Lane County, Kansas

Prepared By:
Justin Clegg

Scale:
1 : 22,000

Date:
December 27, 2013

APPLICATION FOR COMMINGLING OF PRODUCTION OR FLUIDS

**Operator, Lessee or Unleased Mineral Owner
within a ½ mile radius of Ritchie Exploration, Inc.'s**

**#1 Penka Trust
1320' FNL & 165' FEL
Section 33-17S-30W
Lane Co., KS**

Township 17 South, Range 30 West

Sec. 27:	SW/4	Eleanor L. Penka Living Trust & Victor E. Penka Family Trust Eleanor L. Penka, Trustee 201 N. Eagle RD Healy, KS 67850	Landowner
Sec. 28:	SW/4	Ritchie Exploration, Inc. P.O. Box 783188 Wichita, KS 67278-3188	Operator: #1 Dowd 28C
	SE/4	Ritchie Exploration, Inc.	Operator: #1 Penka Trust
Sec. 33:	NW/4	Ritchie Exploration, Inc.	Operator: #1 Sharp 33B, #2 Sharp 33B
	NE/4	Ritchie Exploration, Inc.	Operator: #1 Penka Trust
	SE/4	Edwin A. Habiger Living Trust 1808 E. 24 th St. Hays, KS 67601	Landowner
Sec. 34:	N/2	Ritchie Exploration, Inc.	Operator: #1 Penka Trust
	S/2, except a 1.79 acre tract	Ritchie Exploration, Inc.	Lessee

AFFIDAVIT

STATE OF KANSAS)
 - SS.
County of Sedgwick)

John Niernberger, of lawful age, being first duly sworn, deposeth and saith: That he is Production Manager of Ritchie Exploration, County of Sedgwick, State of Kansas, and that notice was given to all lessee of record or operator within ½ mile radius of the Penka Trust #1 well located in the County of Lane (see attached plat map). This notice included a letter and a copy of the Commingle Application (ACO-4). All notices were mailed on January 3, 2014.

made as aforesaid on the 3rd of

January A.D. 2014

And affiant further says that he has personal knowledge of the statements above set forth and that they are true.

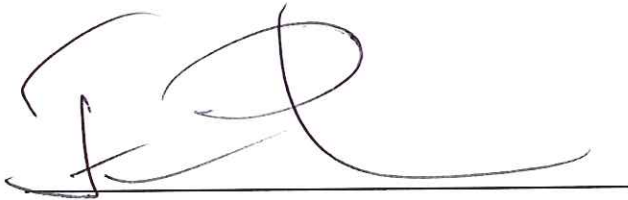

Subscribed and sworn to before me this

3rd day of January 2014



Notary Public Sedgwick County, Kansas

KAREN HOPPER
NOTARY PUBLIC-STATE OF KANSAS
MY APPT. EXPIRES 3-8-15

Proof of Publication

State of Kansas,
County of Lane, ss:

Mary Hartman
of lawful age, being duly sworn upon oath states that he/she is the editor of **THE DIGHTON HERALD**.

THAT said newspaper has been published at least weekly 50 times a year and has been so published for at least five years prior to the first publication of the attached notice.

THAT said newspaper was entered as second class matter at the post office of its publication;

THAT said newspaper has a general paid circulation on a daily, weekly, monthly, or yearly basis in LANE County, Kansas and is NOT a trade, religious or fraternal publication and has been printed and published in LANE County, Kansas.

THE ATTACHED was published on the following dates in a regular issue of said newspaper:

- 1st Publication was made on the 15 day of Jan, 20 14
- 2nd Publication was made on the ___ day of ___, 20 ___
- 3rd Publication was made on the ___ day of ___, 20 ___
- 4th Publication was made on the ___ day of ___, 20 ___
- 5th Publication was made on the ___ day of ___, 20 ___
- 6th Publication was made on the ___ day of ___, 20 ___

Publication fee \$ 4860
 Affidavit, Notary's Fees \$ _____
 Additional Copies @ _____ \$ _____
 Total Publication Fee \$ 4860

Mary Hartman
(Signed)

Witness my hand this 15 day of Jan, 20 14

SUBSCRIBED and SWORN to before me this 15 day of Jan, 20 14.

Kelly C. Anderson
(Notary Public)

My commission expires 2-7-2014

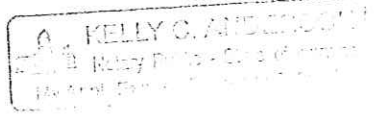

Legal

(First published in The Dighton Herald Wednesday, January 15, 2014)

LEGAL NOTICE

You, and each of you, are hereby notified that Ritchie Exploration, Inc. has filed an application to commence the commingling of production from the Altamont, Cherokee, and Johnson sources of supply for the #1 Penka Trust well located approx. E/2 E/2 NE of Section 33-17S-30W, Lane County, Kansas.

Any persons who object to or protest this application shall be required to file their objections or protests with the Conservation Division of the State Corporation Commission of the State of Kansas within fifteen (15) days from the date of the publication. These protests shall be filed pursuant to Commission regulations and must state specific reasons why the grant of the application may cause waste, violate correlativerights or pollute

the natural resources of the state of Kansas.

If no protests are received, this application may be granted through a summary proceeding. If valid protests are received, this matter will be set for hearing.

All persons interested or concerned shall take notice of the foregoing and shall govern themselves accordingly.

R I T C H I E EXPLORATION, INC.
P.O. Box 783188
Wichita, KS 67278-3188
(316) 691-9500

AFFIDAVIT

STATE OF KANSAS \
- SS.
County of Sedgwick /

Mark Fletchall, of lawful age, being first duly sworn, deposeth and saith: That he is Record Clerk of The Wichita Eagle, a daily newspaper published in the City of Wichita, County of Sedgwick, State of Kansas, and having a general paid circulation on a daily basis in said County, which said newspaper has been continuously and uninterruptedly published in said County for more than one year prior to the first publication of the notice hereinafter mentioned, and which said newspaper has been entered as second class mail matter at the United States Post Office in Wichita, Kansas, and which said newspaper is not a trade, religious or fraternal publication and that a notice of a true copy is hereto attached was published in the regular and entire Morning issue of said The Wichita Eagle for _1_ issues, that the first publication of said notice was

made as aforesaid on the 16th

January A.D. 2014, with

subsequent publications being made on the following dates:

And affiant further says that he has personal knowledge of the statements above set forth and that they are true.

Mark Fletchall

Subscribed and sworn to before me this

16th day of January, 2014

JENNIFER RAE BAILEY
Notary Public - State of Kansas
My Appt. Expires 6/4/2017

Jennifer Bailey
Notary Public Sedgwick County, Kansas

Printer's Fee : \$156.40

LEGAL NOTICE
You, and each of you, are hereby notified that Ritchie Exploration, Inc. has filed an application to commence the commingling of production from the Allamont, Cherokee and Johnson sources of supply for the #1 Penka Trust well located approx E/2 E/2 E/2 NE of Section 33-17S-30W, Lane County, Kansas.
Any persons who object to or protest this application shall be required to file their objections or protests with the Conservator Division of the State Corporation Commission of the State of Kansas within fifteen (15) days from the date of the publication. These protests shall be filed pursuant to Commission regulations and must state specific reasons why the grant of the application may cause waste, violate correlative rights or pollute the natural resources of the state of Kansas. If no protests are received, this application may be granted through a summary proceeding. If valid protests are received, this matter will be set for hearing.
All persons interested or concerned shall take notice of the foregoing and shall govern themselves accordingly.
RITCHIE EXPLORATION, INC.
P.O. Box 783188
Wichita, KS 67278-3188
(316) 691-9500



KANSAS CORPORATION COMMISSION 1074848
OIL & GAS CONSERVATION DIVISION

Form ACO-1
June 2009

Form Must Be Typed
Form must be Signed
All blanks must be Filled

WELL COMPLETION FORM
WELL HISTORY - DESCRIPTION OF WELL & LEASE

OPERATOR: License # 4767
Name: Ritchie Exploration, Inc.
Address 1: 8100 E 22ND ST N # 700
Address 2: BOX 783188
City: WICHITA State: KS Zip: 67278 + 3188
Contact Person: John Niernberger
Phone: (316) 691-9500
CONTRACTOR: License # 33793
Name: H2 Drilling LLC
Wellsite Geologist: Pete Fiorini
Purchaser: NCRA

Designate Type of Completion:

- New Well Re-Entry Workover
- Oil WSW SWD SLOW
 Gas D&A ENHR SIGW
 OG GSW Temp. Abd.
 CM (Coal Bed Methane)
 Cathodic Other (Core, Expl., etc.): _____

If Workover/Re-entry: Old Well Info as follows:

Operator: Ritchie Exploration, Inc.
Well Name: Penka Trust
Original Comp. Date: 1/28/2006 Original Total Depth: 4570
 Deepening Re-perf. Conv. to ENHR Conv. to SWD
 Conv. to GSW
 Plug Back: 4557 Plug Back Total Depth
 Commingled Permit #: _____
 Dual Completion Permit #: _____
 SWD Permit #: _____
 ENHR Permit #: _____
 GSW Permit #: _____
8/10/2011 8/10/2011 8/22/2011
Spud Date or Date Reached TD Completion Date or
Recompletion Date Recompletion Date

API No. 15 - 15-101-21900-00-01
Spot Description: 165' E OFF\ E2E2NE
E2 E2 E2 NE Sec. 33 Twp. 17 S. R. 30 East West
1320 Feet from North / South Line of Section
165 Feet from East / West Line of Section
Footages Calculated from Nearest Outside Section Corner:
 NE NW SE SW
County: Lane
Lease Name: PENKA TRUST Well #: 1
Field Name: Penka
Producing Formation: Altamont, Cherokee, Johnson
Elevation: Ground: 2841 Kelly Bushing: 2847
Total Depth: 4570 Plug Back Total Depth: 4538
Amount of Surface Pipe Set and Cemented at: 212 Feet
Multiple Stage Cementing Collar Used? Yes No
If yes, show depth set: 2177 Feet
If Alternate II completion, cement circulated from: 2177
feet depth to: 0 w/ 300 sx cmt.

Drilling Fluid Management Plan

(Data must be collected from the Reserve Pit)

Chloride content: _____ ppm Fluid volume: _____ bbls
Dewatering method used: _____
Location of fluid disposal if hauled offsite:
Operator Name: _____
Lease Name: _____ License #: _____
Quarter _____ Sec. _____ Twp. _____ S. R. _____ East West
County: _____ Permit #: _____

AFFIDAVIT

I am the affiant and I hereby certify that all requirements of the statutes, rules and regulations promulgated to regulate the oil and gas industry have been fully complied with and the statements herein are complete and correct to the best of my knowledge.

Submitted Electronically

KCC Office Use ONLY

- Letter of Confidentiality Received
Date: 02/24/2012
 Confidential Release Date: _____
 Wireline Log Received
 Geologist Report Received
 UIC Distribution
ALT I II III Approved by: Deanna Garrison Date: 02/24/2012



1074848

Operator Name: Ritchie Exploration, Inc. Lease Name: PENKA TRUST Well #: 1
 Sec. 33 Twp. 17 S. R. 30 East West County: Lane

INSTRUCTIONS: Show important tops and base of formations penetrated. Detail all cores. Report all final copies of drill stems tests giving interval tested, time tool open and closed, flowing and shut-in pressures, whether shut-in pressure reached static level, hydrostatic pressures, bottom hole temperature, fluid recovery, and flow rates if gas to surface test, along with final chart(s). Attach extra sheet if more space is needed. Attach complete copy of all Electric Wire-line Logs surveyed. Attach final geological well site report.

Drill Stem Tests Taken <input type="checkbox"/> Yes <input checked="" type="checkbox"/> No <i>(Attach Additional Sheets)</i> Samples Sent to Geological Survey <input type="checkbox"/> Yes <input checked="" type="checkbox"/> No Cores Taken <input type="checkbox"/> Yes <input checked="" type="checkbox"/> No Electric Log Run <input type="checkbox"/> Yes <input checked="" type="checkbox"/> No Electric Log Submitted Electronically <input type="checkbox"/> Yes <input type="checkbox"/> No <i>(If no, Submit Copy)</i> List All E. Logs Run:	<input type="checkbox"/> Log Formation (Top), Depth and Datum <input checked="" type="checkbox"/> Sample Name Top Datum Attached
---	--

CASING RECORD <input type="checkbox"/> New <input checked="" type="checkbox"/> Used							
Report all strings set-conductor, surface, intermediate, production, etc.							
Purpose of String	Size Hole Drilled	Size Casing Set (In O.D.)	Weight Lbs. / Ft.	Setting Depth	Type of Cement	# Sacks Used	Type and Percent Additives
Surface	12.25	8.625	28	212	common	150	3%cc,2%gel
Production	7.875	5.5	15.5	4577	60.49 pozmix	200	10%salt,2%gel,3/4%CDL

ADDITIONAL CEMENTING / SQUEEZE RECORD				
Purpose:	Depth Top Bottom	Type of Cement	# Sacks Used	Type and Percent Additives
___ Perforate				
___ Protect Casing	-			
___ Plug Back TD				
___ Plug Off Zone	-			

Shots Per Foot	PERFORATION RECORD - Bridge Plugs Set/Type Specify Footage of Each Interval Perforated	Acid, Fracture, Shot, Cement Squeeze Record <i>(Amount and Kind of Material Used)</i>	Depth
	4333'-4336'	500 gals 15% NE Acid	
4	4457.5'-4465.5'	1000 gals 15% NE Acid	
4	4488'-4499'	1000 gals 15% NE Acid	

TUBING RECORD: Size: <u>2.375</u> Set At: <u>4522</u> Packer At: <u> </u> Liner Run: <input type="checkbox"/> Yes <input checked="" type="checkbox"/> No	
Date of First, Resumed Production, SWD or ENHR. <u>8/22/2011</u>	Producing Method: <input type="checkbox"/> Flowing <input checked="" type="checkbox"/> Pumping <input type="checkbox"/> Gas Lift <input type="checkbox"/> Other (Explain) <u> </u>
Estimated Production Per 24 Hours	Oil Bbbs. <u>17</u> Gas Mcf <u> </u> Water Bbbs. <u>11</u> Gas-Oil Ratio <u> </u> Gravity <u>34</u>

DISPOSITION OF GAS: <input type="checkbox"/> Vented <input type="checkbox"/> Sold <input type="checkbox"/> Used on Lease <i>(If vented, Submit ACO-18.)</i>	METHOD OF COMPLETION: <input type="checkbox"/> Open Hole <input checked="" type="checkbox"/> Perf. <input type="checkbox"/> Dually Comp. <input type="checkbox"/> Commingled <i>(Submit ACO-5)</i> <i>(Submit ACO-4)</i> <input type="checkbox"/> Other (Specify) <u> </u>	PRODUCTION INTERVAL: <u> </u> <u> </u>
---	---	--



#1 Penka Trust
 1,320' FNL & 165' FEL
 Section 33-17S-30W
 Lane County, Kansas
 API# 15-101-21900-0000
 Elevation: 2839' GL: 2849' KB

Sample Tops	Ref. Well
Anhydrite	2206' flat
B/Anhydrite	2226' +623 flat
Heebner Shale	3869' -1020 flat
Lansing Limestone	3910' -1061 -1
Sark Shale	4175' -1326 -5
Marmaton	4293' -1444 -3
Altamont	4310' -1461 -3
Pawnee	4376' -1527 -1
Cherokee Shale	4445' -1596 -1
Johnson	4485' -1636 flat
Mississippian	4517' -1668 -2
RID	4570' -1721

8100 E. 22nd St. N., Bldg. 700
 Wichita, Kansas 67226-2328

(316) 691-9500
 Fax (316) 691-9530
rsf@ritchies.com

P.O. Box 783188
 Wichita, Kansas 67278-3188

January 31, 2014

John Niernberger
Ritchie Exploration, Inc.
P.O. Box 783188
Wichita, KS 67278-3188

RE: Approved Commingling CO011405
Penka Trust 1, Sec.33-T17S-R30W, Lane County
API No. 15-101-21900-00-01

Dear Mr. Niernberger:

Your Application for Commingling (ACO-4) for the above described well has been reviewed and approved by the Kansas Corporation Commission (KCC) per K.A.R. 82-3-123. Notice was examined and found to be proper per K.A.R. 82-3-135a. No protest had been filed within the 15-day protest period. This application, which was received by the KCC on January 17, 2014, concerns approval to simultaneously produce from the following sources of supply through the same tubing string in the same wellbore:

Source of Supply	Estimated Current Production			Perf Depth
	BOPD	MCFPD	BWPD	
Altamont	2.73	0.00	7.53	4333-4336
Cherokee	1.46	0.00	4.04	4457-4465
Johnson	2.49	0.00	6.80	4495-4499
Total Estimated Current Production	6.68	0.00	18.37	

Based upon the depth of the Johnson formation perforations, total oil production shall not exceed 200 BOPD and total gas production shall not exceed 50% of the absolute open flow (AOF).

Commingling ID number CO011405 has been assigned to this approved application. Use this number for well completion reports (ACO-1) and other correspondence that may concern this approved commingling.

Sincerely,

Rick Hestermann
Production Department