



APPLICATION FOR COMMINGLING OF PRODUCTION (K.A.R. 82-3-123) OR FLUIDS (K.A.R. 82-3-123a) *Commingling ID # _____*

OPERATOR: License # _____ API No. 15 - _____
Name: _____ Spot Description: _____
Address 1: _____ Sec. _____ Twp. _____ S. R. _____ East West
Address 2: _____ Feet from North / South Line of Section
City: _____ State: _____ Zip: _____ + _____ Feet from East / West Line of Section
Contact Person: _____ County: _____
Phone: (_____) _____ Lease Name: _____ Well #: _____

1. Name and upper and lower limit of each production interval to be commingled:
Formation: _____ (Perfs): _____
Formation: _____ (Perfs): _____
Formation: _____ (Perfs): _____
Formation: _____ (Perfs): _____
Formation: _____ (Perfs): _____

2. Estimated amount of fluid production to be commingled from each interval:
Formation: _____ BOPD: _____ MCFPD: _____ BWPD: _____
Formation: _____ BOPD: _____ MCFPD: _____ BWPD: _____
Formation: _____ BOPD: _____ MCFPD: _____ BWPD: _____
Formation: _____ BOPD: _____ MCFPD: _____ BWPD: _____
Formation: _____ BOPD: _____ MCFPD: _____ BWPD: _____

3. Plat map showing the location of the subject well, all other wells on the subject lease, and all wells on offsetting leases within a 1/2 mile radius of the subject well, and for each well the names and addresses of the lessee of record or operator.

4. Signed certificate showing service of the application and affidavit of publication as required in K.A.R. 82-3-135a.

For Commingling of PRODUCTION ONLY, include the following:

- 5. Wireline log of subject well. Previously Filed with ACO-1: Yes No
- 6. Complete Form ACO-1 (*Well Completion form*) for the subject well.

For Commingling of FLUIDS ONLY, include the following:

- 7. Well construction diagram of subject well.
- 8. Any available water chemistry data demonstrating the compatibility of the fluids to be commingled.

AFFIDAVIT: I am the affiant and hereby certify that to the best of my current information, knowledge and personal belief, this request for commingling is true and proper and I have no information or knowledge, which is inconsistent with the information supplied in this application.

Submitted Electronically

KCC Office Use Only
 Denied Approved
15-Day Periods Ends: _____
Approved By: _____ Date: _____

Protests may be filed by any party having a valid interest in the application. Protests must be in writing and comply with K.A.R. 82-3-135b and must be filed within 15 days of publication of the notice of application.

APPLICATION FOR COMMINGLING OF PRODUCTION OR FLUIDS

**Operator, Lessee or Unleased Mineral Owner
within a ½ mile radius of Ritchie Exploration, Inc.'s**

**#1 Rodie
1980' FSL & 1980' FEL
Section 15-11S-31W
Gove Co., KS**

Township 11 South, Range 31 West

Sec. 14:	NW/4	Pamela Kay Schehl & George M. Kearns 1402 Antiben Place Amelia, OH 45102	Landowners
	SW/4	Capital Land Services, Inc. 609 S. Kelly Ave. Edmond, OK 73003	Lessee
Sec. 15:	NE/4	Dorothy Swart 306 Maple Oakley, KS 67748	Landowner
	NW/4	Apache Corporation 2000 Post Oak Blvd., Ste. 100 Houston, TX 77056	Lessee
	S/2	Ritchie Exploration, Inc. P.O. Box 783188 Wichita, KS 67278-3188	Operator: #1 Rodie, #2 Rodie SWDW
Sec. 22:	NW/4	Transcontinent Oil Company 621 17 th St., #2501 Denver, CO 80293	Lessee
	E/2E/2NE/4	Francis M. & Pamela Rudell 2771 County Road 18 Oakley, KS 67748	Landowners
	W/2NE/4, W/2E/2NE/4	Alan & Yolanda Suter 1859 CR Bb Oakley, KS 67748	Landowners

R 31 W

T
11
S

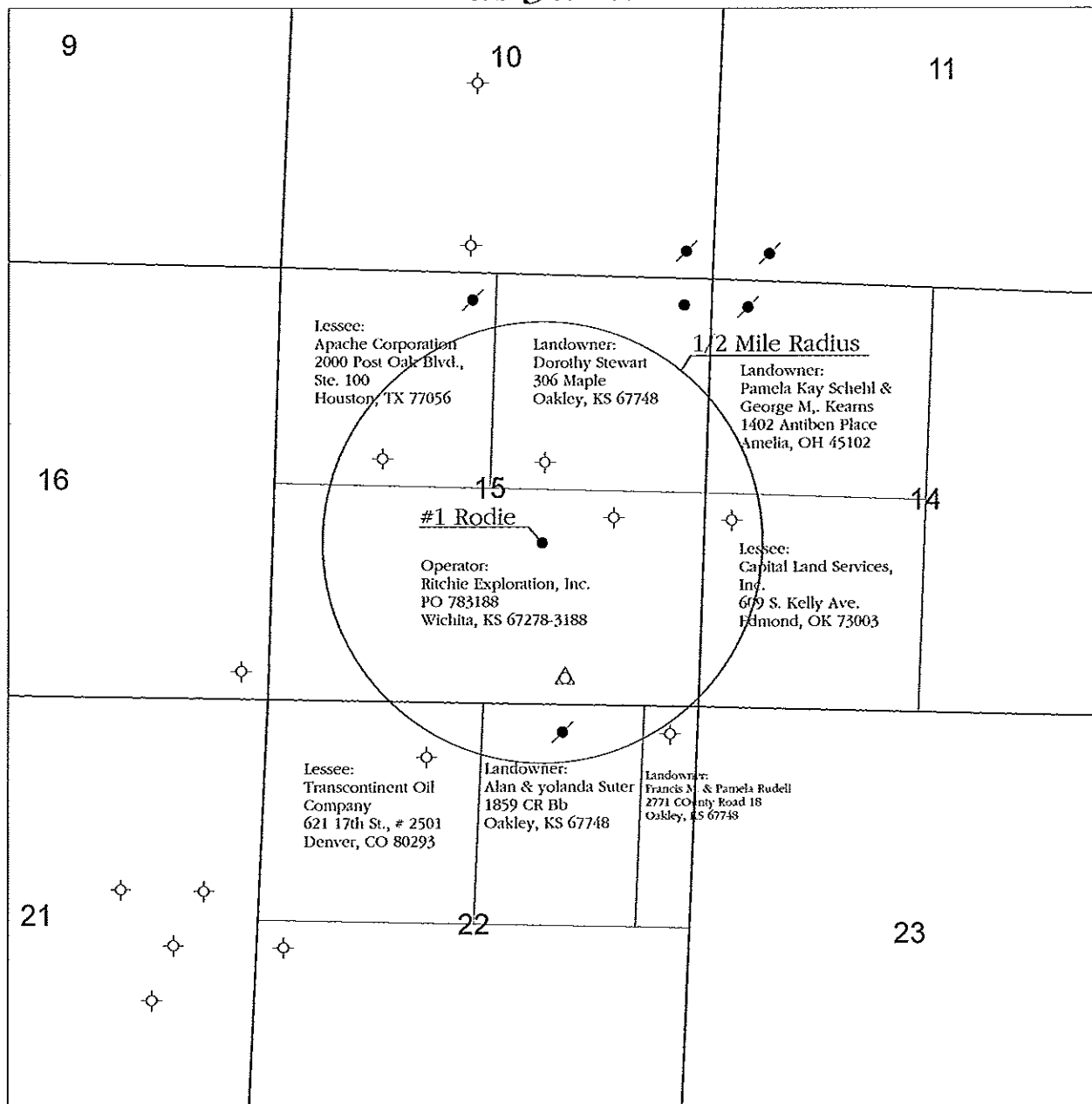

Legend

- Oil Well
- / Abandoned Oil Well
- △ Service Well
- / Dry and Abandoned Well



RITCHIE
EXPLORATION, INC.
Wichita, Kansas

**Application for
Commingle of
Production or Fluids**

Applicant Well: #1 Rodie
All Wells on Offsetting Leases within 1/2 Mile Radius
Name and Address of Lessee of Record or Operator
On Offsetting Leases

Gove County, Kansas		
Prepared By: Justin Clegg	Scale: 1 : 24,000	Date: 12/30/2013

AFFIDAVIT

STATE OF KANSAS)
 - SS.
County of Sedgwick)

John Niernberger, of lawful age, being first duly sworn, deposeth and saith: That he is Production Manager of Ritchie Exploration, County of Sedgwick, State of Kansas, and that notice was given to all lessee of record or operator within ½ mile radius of the Rodie #1 well located in the County of Gove (see attached plat map). This notice included a letter and a copy of the Commingle Application (ACO-4). All notices were mailed on January 9, 2014.

made as aforesaid on the 9th of
January A.D. 2014

And affiant further says that he has personal knowledge of the statements above set forth and that they are true.

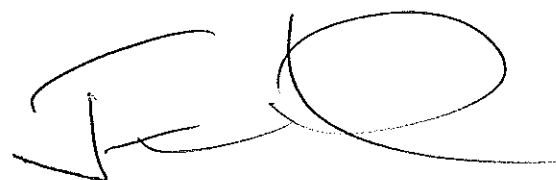

Subscribed and sworn to before me this
9th day of January 2014

Notary Public Sedgwick County, Kansas

AFFIDAVIT

STATE OF KANSAS \
- SS.
County of Sedgwick /

Mark Fletchall, of lawful age, being first duly sworn, deposeth and saith: That he is Record Clerk of The Wichita Eagle, a daily newspaper published in the City of Wichita, County of Sedgwick, State of Kansas, and having a general paid circulation on a daily basis in said County, which said newspaper has been continuously and uninterruptedly published in said County for more than one year prior to the first publication of the notice hereinafter mentioned, and which said newspaper has been entered as second class mail matter at the United States Post Office in Wichita, Kansas, and which said newspaper is not a trade, religious or fraternal publication and that a notice of a true copy is hereto attached was published in the regular and entire Morning issue of said The Wichita Eagle for _1_ issues, that the first publication of said notice was

made as aforesaid on the 16th

January A.D. 2014, with

subsequent publications being made on the following dates:

And affiant further says that he has personal knowledge of the statements above set forth and that they are true.

Mark Fletchall

Subscribed and sworn to before me this

16th day of January, 2014

JENNIFER RAE BAILEY
Notary Public - State of Kansas
My Appt. Expires 6/4/2017

Jennifer R. Bailey
Notary Public Sedgwick County, Kansas

Printer's Fee : \$156.40

LEGAL NOTICE
You, and each of you, are hereby notified that Ritchie Exploration, Inc. has filed an application to commence the commingling of production from the Lansing Kansas City, Myrick, and Forl Scott sources of supply for the #1 Rodie well located approx. NW SE of Section 15-11S-31W, Gove County, Kansas.
Any person who object to or protest this application shall be required to file their objections or protests with the Conservation Division of the State Corporation Commission of the State of Kansas with fifteen (15) days from the date of the publication. These protests shall be filed pursuant to Commission regulations and must state specific reasons why the grant of the application may cause waste, violate correlative rights or pollute the natural resources of the state of Kansas. If no protests are received, this application may be granted through a summary proceeding. If valid protests are received, this matter will be set for hearing.
All persons interested or concerned shall take notice of the foregoing and shall govern themselves accordingly.
RITCHIE EXPLORATION, INC.
P.O. Box 783188
Wichita, KS 67278-3188
(316) 691-9500

AFFIDAVIT OF PUBLICATION
State of Kansas,
Gove County, ss:

Roxanne Broeckelman,
being first duly sworn, deposes and
says: That she is
co-publisher of

Gove County Advocate, a weekly newspaper printed in the State of Kansas, and published in and of general circulation in Gove County, Kansas, with a general paid circulation on a weekly basis in Gove County, Kansas, and that said newspaper is not a trade, religious or fraternal publication.

Said newspaper is a weekly published at least 50 times a year; and has been so published continuously and uninterruptedly in said county and state for a period of more than five years prior to the first publication of said notice; and has been admitted at the post office in Quinter in said county as periodical class mail matter.

That the attached notice is a true copy thereof and was published in the regular and entire issue of said newspaper for one consecutive week(s), the first publication thereof being made as aforesaid on the 22nd day of January, 2014, with subsequent publications being made on the following dates:

_____, _____
_____, _____
_____, _____
_____, _____
_____, _____
_____, _____

Printer's Fee\$ 17.60
Additional Copies\$ _____
Affidavit Fees\$ 2.00
Total Publication Fees ..\$ 19.60

Roxanne Broeckelman

Subscribed and sworn to before me
this 22nd day of
January, 2014

Linda L. Zerr
Notary Public

My commission expires:
January 8, 2017

LEGAL ADVERTISING
(Published in the Gove County Advocate, Quinter, KS, Wed., January 22, 2014 - 11)
LEGAL NOTICE
You, and each of you, are hereby notified that Ritchie Exploration, Inc. has filed an application to commence the commingling of production from the Lansing Kansas City, Myrick, and Fort Scott sources of supply for the #1 Rodie well located approx. NW SE of Section 15-11S-31W, Gove County, Kansas.
Any persons who object to or protest this application shall be required to file their objections or protests with the Conservation Division of the State Corporation Commission of the State of Kansas within fifteen (15) days from the date of the publication. These protests shall be filed pursuant to Commission regulations and must state specific reasons why the grant of the application may cause waste, violate correlative rights or pollute the natural resources of the state of Kansas. If no protests are received, this application may be granted through a summary proceeding. If valid protests are received, this matter will be set for hearing.
All persons interested or concerned shall take notice of the foregoing and shall govern themselves accordingly.
RITCHIE EXPLORATION, INC.
P.O. Box 783188
Wichita, KS 67278-3188
(316) 691-9500

LINDA L. ZERR
NOTARY PUBLIC
STATE OF KANSAS
My Appt. Exp. 1/8/2017



CONFIDENTIAL

WELL COMPLETION FORM
WELL HISTORY - DESCRIPTION OF WELL & LEASE

OPERATOR: License # 4767
Name: Ritchie Exploration, Inc.
Address 1: 8100 E 22ND ST N # 700
Address 2: BOX 783188
City: WICHITA State: KS Zip: 67278 + 3188
Contact Person: Pete Fiorini
Phone: (316) 691-9500
CONTRACTOR: License # 99998
Name: COMPANY TOOLS
Wellsite Geologist: Pete Fiorini
Purchaser: NCRA

Designate Type of Completion:

- New Well Re-Entry Workover
- Oil WSW SWD SLOW
- Gas D&A ENHR SIGW
- OG GSW Temp. Abd.
- CM (Coal Bed Methane)
- Cathodic Other (Core, Expl., etc.): _____

If Workover/Re-entry: Old Well Info as follows:

Operator: A. Scott Ritchie
Well Name: Rodie
Original Comp. Date: 11/21/1984 Original Total Depth: 4610
 Deepening Re-perf. Conv. to ENHR Conv. to SWD
 Conv. to GSW

Plug Back: _____ Plug Back Total Depth _____

Commingled Permit #: _____

Dual Completion Permit #: _____

SWD Permit #: _____

ENHR Permit #: _____

GSW Permit #: _____

<u>11/03/2011</u>	<u>11/03/2011</u>	<u>11/10/2011</u>
Spud Date or Recompletion Date	Date Reached TD	Completion Date or Recompletion Date

API No. 15 - 15-063-20802-00-02
Spot Description: _____
_____ NW SE Sec. 15 Twp. 11 S. R. 31 East West
1980 Feet from North / South Line of Section
1980 Feet from East / West Line of Section
Footages Calculated from Nearest Outside Section Corner:
 NE NW SE SW
County: Gove
Lease Name: RODIE OWWO Well #: 1
Field Name: _____
Producing Formation: LKC, Myrick, Fort Scott
Elevation: Ground: 2992 Kelly Bushing: 2995
Total Depth: 4663 Plug Back Total Depth: 4575
Amount of Surface Pipe Set and Cemented at: 344 Feet
Multiple Stage Cementing Collar Used? Yes No
If yes, show depth set: 2530 Feet
If Alternate II completion, cement circulated from: 0
feet depth to: 344 w/ 225 sx cmt.

Drilling Fluid Management Plan

(Data must be collected from the Reserve Pit)

Chloride content: _____ ppm Fluid volume: _____ bbls
Dewatering method used: _____
Location of fluid disposal if hauled offsite: _____
Operator Name: _____
Lease Name: _____ License #: _____
Quarter _____ Sec. _____ Twp. _____ S. R. _____ East West
County: _____ Permit #: _____

AFFIDAVIT

I am the affiant and I hereby certify that all requirements of the statutes, rules and regulations promulgated to regulate the oil and gas industry have been fully complied with and the statements herein are complete and correct to the best of my knowledge.

Submitted Electronically

KCC Office Use ONLY

- Letter of Confidentiality Received
Date: 02/29/2012
- Confidential Release Date: _____
- Wireline Log Received
- Geologist Report Received
- UIC Distribution
- ALT I II III Approved by: NAOMI JAMES Date: 03/01/2012



1075450

Operator Name: Ritchie Exploration, Inc. Lease Name: RODIE OWWO Well #: 1
 Sec. 15 Twp. 11 S. R. 31 East West County: GOVE

INSTRUCTIONS: Show important tops and base of formations penetrated. Detail all cores. Report all final copies of drill stems tests giving interval tested, time tool open and closed, flowing and shut-in pressures, whether shut-in pressure reached static level, hydrostatic pressures, bottom hole temperature, fluid recovery, and flow rates if gas to surface test, along with final chart(s). Attach extra sheet if more space is needed. Attach complete copy of all Electric Wire-line Logs surveyed. Attach final geological well site report.

Drill Stem Tests Taken <input type="checkbox"/> Yes <input checked="" type="checkbox"/> No <i>(Attach Additional Sheets)</i> Samples Sent to Geological Survey <input type="checkbox"/> Yes <input checked="" type="checkbox"/> No Cores Taken <input type="checkbox"/> Yes <input checked="" type="checkbox"/> No Electric Log Run <input type="checkbox"/> Yes <input checked="" type="checkbox"/> No Electric Log Submitted Electronically <input type="checkbox"/> Yes <input type="checkbox"/> No <i>(If no, Submit Copy)</i> List All E. Logs Run:	<input checked="" type="checkbox"/> Log Formation (Top), Depth and Datum <input type="checkbox"/> Sample Name Top Datum Attached Attached Attached
---	--

CASING RECORD <input checked="" type="checkbox"/> New <input type="checkbox"/> Used							
Report all strings set-conductor, surface, intermediate, production, etc.							
Purpose of String	Size Hole Drilled	Size Casing Set (In O.D.)	Weight Lbs./ Ft.	Setting Depth	Type of Cement	# Sacks Used	Type and Percent Additives
Surface	12.25	8.675	20	344	60/40 poz	225	2%gel,3%cc
Production	7.875	5.5	14	4685	60/40 poz	185	10%salt,3%gilsonite

ADDITIONAL CEMENTING / SQUEEZE RECORD				
Purpose:	Depth Top Bottom	Type of Cement	# Sacks Used	Type and Percent Additives
___ Perforate				
___ Protect Casing	-			
___ Plug Back TD				
___ Plug Off Zone	-			

Shots Per Foot	PERFORATION RECORD - Bridge Plugs Set/Type Specify Footage of Each Interval Perforated	Acid, Fracture, Shot, Cement Squeeze Record (Amount and Kind of Material Used)	Depth
4	4521-4527, 4512-4518	500 gals 15% NE Acid w/Cla-Sta	
4	4274-4277.5	500 gals 15% NE Acid w/Cla-Sta	
	SET CIBP @ 4575 (over Mississippian)		

TUBING RECORD: Size: <u>2.875</u> Set At: <u>4568</u> Packer At: <u> </u>		Liner Run: <input type="checkbox"/> Yes <input checked="" type="checkbox"/> No	
Date of First, Resumed Production, SWD or ENHR. <u>11/10/2011</u>		Producing Method: <input type="checkbox"/> Flowing <input checked="" type="checkbox"/> Pumping <input type="checkbox"/> Gas Lift <input type="checkbox"/> Other (Explain) _____	
Estimated Production Per 24 Hours	Oil Bbls. <u>8.87</u>	Gas Mcf <u> </u>	Water Bbls. <u>71.4</u> Gas-Oil Ratio <u> </u> Gravity <u>35</u>

DISPOSITION OF GAS: <input type="checkbox"/> Vented <input type="checkbox"/> Sold <input type="checkbox"/> Used on Lease <i>(If vented, Submit ACO-18.)</i>	METHOD OF COMPLETION: <input type="checkbox"/> Open Hole <input checked="" type="checkbox"/> Perf. <input type="checkbox"/> Dually Comp. <input checked="" type="checkbox"/> Commingled <i>(Submit ACO-5) (Submit ACO-4)</i> <input type="checkbox"/> Other (Specify) _____	PRODUCTION INTERVAL: _____ _____
---	--	--

Form	ACO1 - Well Completion
Operator	Ritchie Exploration, Inc.
Well Name	RODIE OWWO 1
Doc ID	1075450

Tops

Name	Top	Depth
Anhydrite	2522	+473
B/Anhydrite	2549	+446
Topeka	3785	-789
Heebner	4004	-1009
Toronto	4030	-1035
Lansing	4046	-1051
Stark Shale	4262	-1267
B/KC	4322	-1327
Marmaton	4352	-1357
Pawnee	4446	-1451
Ft. Scott	4512	-1517
Cher. Shale	4538	-1543
Miss. Ls.	4605'	-1610
Miss. Dolo.	4631	-1636
LTD	4691	-1696

February 6, 2014

John Niernberger
Ritchie Exploration, Inc.
P.O. Box 783188
Wichita, KS 67278-3188

RE: Approved Commingling CO011408
Rodie OWWO 1, Sec.15-T11S-R31W, Gove County
API No. 15-063-20802-00-02

Dear Mr. Niernberger:

Your Application for Commingling (ACO-4) for the above described well has been reviewed and approved by the Kansas Corporation Commission (KCC) per K.A.R. 82-3-123. Notice was examined and found to be proper per K.A.R. 82-3-135a. No protest had been filed within the 15-day protest period. This application, which was received by the KCC on January 31, 2014, concerns approval to simultaneously produce from the following sources of supply through the same tubing string in the same wellbore:

Source of Supply	Estimated Current Production			
	BOPD	MCFPD	BWPD	
LKC	2.32	0.00	111.63	4274-4277
Myrick	1.29	0.00	15.23	4487-4493
Fort Scott	4.49	0.00	0.04	4512-4518, 4521-4527
Total Estimated Current Production	8.10	0.00	126.90	

Based upon the depth of the Fort Scott formation perforations, total oil production shall not exceed 200 BOPD and total gas production shall not exceed 50% of the absolute open flow (AOF).

Commingling ID number CO011408 has been assigned to this approved application. Use this number for well completion reports (ACO-1) and other correspondence that may concern this approved commingling.

Sincerely,

Rick Hestermann
Production Department