



**APPLICATION FOR COMMINGLING OF PRODUCTION (K.A.R. 82-3-123) OR FLUIDS (K.A.R. 82-3-123a)** *Commingling ID # \_\_\_\_\_*

OPERATOR: License # \_\_\_\_\_ API No. 15 - \_\_\_\_\_  
Name: \_\_\_\_\_ Spot Description: \_\_\_\_\_  
Address 1: \_\_\_\_\_ - - - - - Sec. \_\_\_\_\_ Twp. \_\_\_\_\_ S. R. \_\_\_\_\_  East  West  
Address 2: \_\_\_\_\_ Feet from  North /  South Line of Section  
City: \_\_\_\_\_ State: \_\_\_\_\_ Zip: \_\_\_\_\_ + \_\_\_\_\_ Feet from  East /  West Line of Section  
Contact Person: \_\_\_\_\_ County: \_\_\_\_\_  
Phone: ( \_\_\_\_\_ ) \_\_\_\_\_ Lease Name: \_\_\_\_\_ Well #: \_\_\_\_\_

1. Name and upper and lower limit of each production interval to be commingled:  
Formation: \_\_\_\_\_ (Perfs): \_\_\_\_\_  
Formation: \_\_\_\_\_ (Perfs): \_\_\_\_\_  
Formation: \_\_\_\_\_ (Perfs): \_\_\_\_\_  
Formation: \_\_\_\_\_ (Perfs): \_\_\_\_\_  
Formation: \_\_\_\_\_ (Perfs): \_\_\_\_\_

2. Estimated amount of fluid production to be commingled from each interval:  
Formation: \_\_\_\_\_ BOPD: \_\_\_\_\_ MCFPD: \_\_\_\_\_ BWPD: \_\_\_\_\_  
Formation: \_\_\_\_\_ BOPD: \_\_\_\_\_ MCFPD: \_\_\_\_\_ BWPD: \_\_\_\_\_  
Formation: \_\_\_\_\_ BOPD: \_\_\_\_\_ MCFPD: \_\_\_\_\_ BWPD: \_\_\_\_\_  
Formation: \_\_\_\_\_ BOPD: \_\_\_\_\_ MCFPD: \_\_\_\_\_ BWPD: \_\_\_\_\_  
Formation: \_\_\_\_\_ BOPD: \_\_\_\_\_ MCFPD: \_\_\_\_\_ BWPD: \_\_\_\_\_

3. Plat map showing the location of the subject well, all other wells on the subject lease, and all wells on offsetting leases within a 1/2 mile radius of the subject well, and for each well the names and addresses of the lessee of record or operator.

4. Signed certificate showing service of the application and affidavit of publication as required in K.A.R. 82-3-135a.

**For Commingling of PRODUCTION ONLY, include the following:**

- 5. Wireline log of subject well. Previously Filed with ACO-1:  Yes  No
- 6. Complete Form ACO-1 (*Well Completion form*) for the subject well.

**For Commingling of FLUIDS ONLY, include the following:**

- 7. Well construction diagram of subject well.
- 8. Any available water chemistry data demonstrating the compatibility of the fluids to be commingled.

**AFFIDAVIT:** I am the affiant and hereby certify that to the best of my current information, knowledge and personal belief, this request for commingling is true and proper and I have no information or knowledge, which is inconsistent with the information supplied in this application.

**Submitted Electronically**

**KCC Office Use Only**  
 Denied  Approved  
15-Day Periods Ends: \_\_\_\_\_  
Approved By: \_\_\_\_\_ Date: \_\_\_\_\_

*Protests may be filed by any party having a valid interest in the application. Protests must be in writing and comply with K.A.R. 82-3-135b and must be filed within 15 days of publication of the notice of application.*



**CONFIDENTIAL**

**WELL COMPLETION FORM**

**Form Must Be Typed**  
**Form must be Signed**  
**All blanks must be Filled**

**WELL HISTORY - DESCRIPTION OF WELL & LEASE**

OPERATOR: License # \_\_\_\_\_

Name: \_\_\_\_\_

Address 1: \_\_\_\_\_

Address 2: \_\_\_\_\_

City: \_\_\_\_\_ State: \_\_\_\_\_ Zip: \_\_\_\_\_ + \_\_\_\_\_

Contact Person: \_\_\_\_\_

Phone: ( \_\_\_\_\_ ) \_\_\_\_\_

CONTRACTOR: License # \_\_\_\_\_

Name: \_\_\_\_\_

Wellsite Geologist: \_\_\_\_\_

Purchaser: \_\_\_\_\_

Designate Type of Completion:

- New Well       Re-Entry       Workover
- Oil       WSW       SWD       SIOW
- Gas       D&A       ENHR       SIGW
- OG       GSW       Temp. Abd.
- CM (Coal Bed Methane)
- Cathodic       Other (Core, Expl., etc.): \_\_\_\_\_

If Workover/Re-entry: Old Well Info as follows:

Operator: \_\_\_\_\_

Well Name: \_\_\_\_\_

Original Comp. Date: \_\_\_\_\_ Original Total Depth: \_\_\_\_\_

- Deepening       Re-perf.       Conv. to ENHR       Conv. to SWD
- Conv. to GSW
- Plug Back: \_\_\_\_\_ Plug Back Total Depth \_\_\_\_\_
- Commingled      Permit #: \_\_\_\_\_
- Dual Completion      Permit #: \_\_\_\_\_
- SWD      Permit #: \_\_\_\_\_
- ENHR      Permit #: \_\_\_\_\_
- GSW      Permit #: \_\_\_\_\_

Spud Date or Recompletion Date	Date Reached TD	Completion Date or Recompletion Date
-----------------------------------	-----------------	---

API No. 15 - \_\_\_\_\_

Spot Description: \_\_\_\_\_

\_\_\_\_\_ - \_\_\_\_\_ - \_\_\_\_\_ Sec. \_\_\_\_\_ Twp. \_\_\_\_\_ S. R. \_\_\_\_\_  East  West

\_\_\_\_\_ Feet from  North /  South Line of Section

\_\_\_\_\_ Feet from  East /  West Line of Section

Footages Calculated from Nearest Outside Section Corner:

- NE       NW       SE       SW

County: \_\_\_\_\_

Lease Name: \_\_\_\_\_ Well #: \_\_\_\_\_

Field Name: \_\_\_\_\_

Producing Formation: \_\_\_\_\_

Elevation: Ground: \_\_\_\_\_ Kelly Bushing: \_\_\_\_\_

Total Depth: \_\_\_\_\_ Plug Back Total Depth: \_\_\_\_\_

Amount of Surface Pipe Set and Cemented at: \_\_\_\_\_ Feet

Multiple Stage Cementing Collar Used?  Yes  No

If yes, show depth set: \_\_\_\_\_ Feet

If Alternate II completion, cement circulated from: \_\_\_\_\_

feet depth to: \_\_\_\_\_ w/ \_\_\_\_\_ sx cmt.

**Drilling Fluid Management Plan**

(Data must be collected from the Reserve Pit)

Chloride content: \_\_\_\_\_ ppm Fluid volume: \_\_\_\_\_ bbls

Dewatering method used: \_\_\_\_\_

Location of fluid disposal if hauled offsite: \_\_\_\_\_

Operator Name: \_\_\_\_\_

Lease Name: \_\_\_\_\_ License #: \_\_\_\_\_

Quarter \_\_\_\_\_ Sec. \_\_\_\_\_ Twp. \_\_\_\_\_ S. R. \_\_\_\_\_  East  West

County: \_\_\_\_\_ Permit #: \_\_\_\_\_

**AFFIDAVIT**

I am the affiant and I hereby certify that all requirements of the statutes, rules and regulations promulgated to regulate the oil and gas industry have been fully complied with and the statements herein are complete and correct to the best of my knowledge.

Submitted Electronically

**KCC Office Use ONLY**

- Letter of Confidentiality Received  
Date: \_\_\_\_\_
- Confidential Release Date: \_\_\_\_\_
- Wireline Log Received
- Geologist Report Received
- UIC Distribution
- ALT  I  II  III Approved by: \_\_\_\_\_ Date: \_\_\_\_\_



1171266

Operator Name: \_\_\_\_\_ Lease Name: \_\_\_\_\_ Well #: \_\_\_\_\_

Sec. \_\_\_\_\_ Twp. \_\_\_\_\_ S. R. \_\_\_\_\_  East  West County: \_\_\_\_\_

**INSTRUCTIONS:** Show important tops and base of formations penetrated. Detail all cores. Report all final copies of drill stems tests giving interval tested, time tool open and closed, flowing and shut-in pressures, whether shut-in pressure reached static level, hydrostatic pressures, bottom hole temperature, fluid recovery, and flow rates if gas to surface test, along with final chart(s). Attach extra sheet if more space is needed. Attach complete copy of all Electric Wire-line Logs surveyed. Attach final geological well site report.

Drill Stem Tests Taken <input type="checkbox"/> Yes <input type="checkbox"/> No <i>(Attach Additional Sheets)</i>  Samples Sent to Geological Survey <input type="checkbox"/> Yes <input type="checkbox"/> No  Cores Taken <input type="checkbox"/> Yes <input type="checkbox"/> No Electric Log Run <input type="checkbox"/> Yes <input type="checkbox"/> No Electric Log Submitted Electronically <input type="checkbox"/> Yes <input type="checkbox"/> No <i>(If no, Submit Copy)</i>  List All E. Logs Run:	<input type="checkbox"/> Log Formation (Top), Depth and Datum <input type="checkbox"/> Sample  Name Top Datum
---	---

CASING RECORD <input type="checkbox"/> New <input type="checkbox"/> Used							
Report all strings set-conductor, surface, intermediate, production, etc.							
Purpose of String	Size Hole Drilled	Size Casing Set (In O.D.)	Weight Lbs. / Ft.	Setting Depth	Type of Cement	# Sacks Used	Type and Percent Additives

ADDITIONAL CEMENTING / SQUEEZE RECORD				
Purpose:	Depth Top Bottom	Type of Cement	# Sacks Used	Type and Percent Additives
<input type="checkbox"/> Perforate <input type="checkbox"/> Protect Casing <input type="checkbox"/> Plug Back TD <input type="checkbox"/> Plug Off Zone				

Shots Per Foot	PERFORATION RECORD - Bridge Plugs Set/Type Specify Footage of Each Interval Perforated	Acid, Fracture, Shot, Cement Squeeze Record <i>(Amount and Kind of Material Used)</i>	Depth

TUBING RECORD:      Size: \_\_\_\_\_ Set At: \_\_\_\_\_ Packer At: \_\_\_\_\_ Liner Run:  Yes  No

Date of First, Resumed Production, SWD or ENHR. \_\_\_\_\_ Producing Method:  Flowing  Pumping  Gas Lift  Other (Explain) \_\_\_\_\_

Estimated Production Per 24 Hours	Oil Bbls.	Gas Mcf	Water Bbls.	Gas-Oil Ratio	Gravity
-----------------------------------	-----------	---------	-------------	---------------	---------

<b>DISPOSITION OF GAS:</b> <input type="checkbox"/> Vented <input type="checkbox"/> Sold <input type="checkbox"/> Used on Lease <i>(If vented, Submit ACO-18.)</i>	<b>METHOD OF COMPLETION:</b> <input type="checkbox"/> Open Hole <input type="checkbox"/> Perf. <input type="checkbox"/> Dually Comp. <input type="checkbox"/> Commingled <i>(Submit ACO-5)</i> <i>(Submit ACO-4)</i> <input type="checkbox"/> Other (Specify) _____	<b>PRODUCTION INTERVAL:</b> _____ _____
--	--	---

Conservation Division  
Finney State Office Building  
130 S. Market, Rm. 2078  
Wichita, KS 67202-3802



Phone: 316-337-6200  
Fax: 316-337-6211  
<http://kcc.ks.gov/>

Mark Sievers, Chairman  
Thomas E. Wright, Commissioner  
Shari Feist Albrecht, Commissioner

Sam Brownback, Governor

December 03, 2013

LAURA BETH HICKERT  
OXY USA Inc.  
5 E GREENWAY PLZ  
PO BOX 27570  
HOUSTON, TX 77227-7570

Re: ACO1  
API 15-093-21883-00-00  
HYLBOM B 4  
SE/4 Sec.25-23S-35W  
Kearny County, Kansas

Dear Production Department:

We are herewith requesting that the Well Completion Form ACO-1 and attached information for the subject well be held confidential for a period of two years.

Should you have any questions or need additional information regarding subject well, please contact our office.

Respectfully,  
LAURA BETH HICKERT

**AFFIDAVIT OF NOTICE SERVED**

RE: Application for: OXY USA, INC.

Well Name: Hylbom B-4  
Legal Location: SW NW NE SE 25-23S-35W

The undersigned hereby certifies that he/she is a duly authorized agent for the applicant, and that on the 24th day of March, 2014, a true and correct copy of the application referenced above was delivered or mailed to the following parties:

NOTE: A copy of this affidavit must be served as a part of the application.

<b><u>Name:</u></b>	<b><u>Address:</u> (attach additional sheets if necessary).</b>
Big M Farms (Surface Owner)	2201 N. Center St. Garden City, Kansas 67846
Oxy USA, Inc.	P.O. Box 2528, Liberal, KS 67905

Signed this 24th day of March, 2014.

  
Idania B. Medina  
Applicant or Duly Authorized Agent

Subscribed and sworn to before me this 24 day of March, 2014

  
\_\_\_\_\_  
Notary Public

My Commission Expires: Oct. 1, 2017

Protests may be filed by any party having a valid interest in the application. Petitions for protests shall be in writing and shall clearly identify the name and address of the protestant and the title of the application. The petition shall include a clear and concise statement of the direct and substantial interest of the protestant in the proceedings, including the manner in which the protestant may be affected, and the nature, extent, character and grounds of the protest. Protestants shall serve the protest upon the applicant by mail or personal service at the same time or before the protestant files the protest with the Conservation Division.

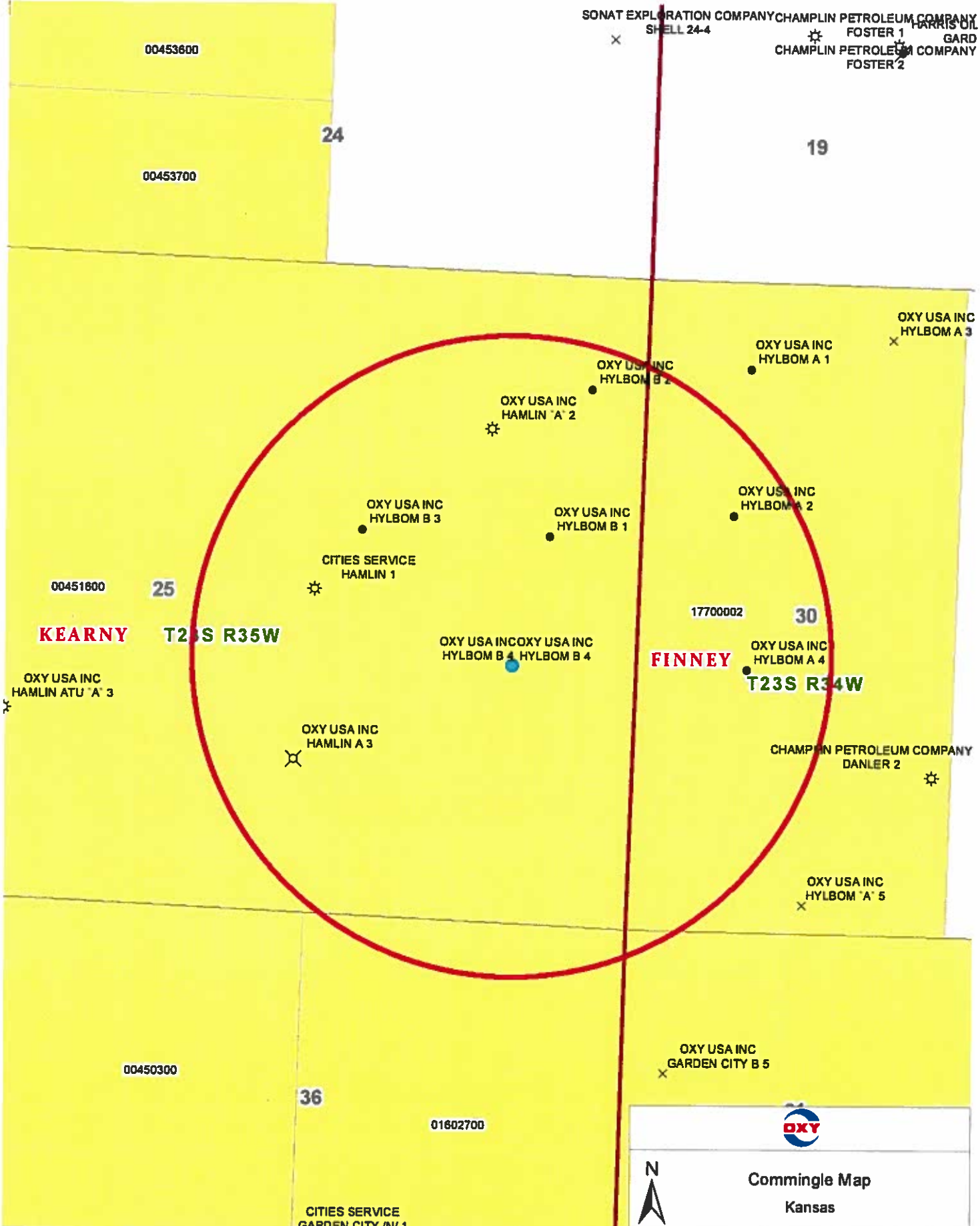

SONAT EXPLORATION COMPANY CHAMPLIN PETROLEUM COMPANY  
 SHELL 24-4 FOSTER 1 HARRIS OIL  
 CHAMPLIN PETROLEUM COMPANY GARD  
 FOSTER 2

00453600

24

19

00453700

00451800

25

KEARNY T25S R35W

OXY USA INC  
HAMLIN ATU 'A' 3

CITIES SERVICE  
HAMLIN 1

OXY USA INC  
HYLBOM B 3

OXY USA INC  
HAMLIN 'A' 2

OXY USA INC  
HYLBOM B 2

OXY USA INC  
HYLBOM A 1

OXY USA INC  
HYLBOM A 3

OXY USA INC  
HYLBOM B 1

OXY USA INC  
HYLBOM A 2

17700002

30

FINNEY

OXY USA INC  
HYLBOM A 4

T23S R34W

OXY USA INC OXY USA INC  
HYLBOM B 4 HYL BOM B 4

OXY USA INC  
HAMLIN A 3

CHAMPLIN PETROLEUM COMPANY  
DANLER 2

OXY USA INC  
HYLBOM 'A' 5

00450300

36

01602700

OXY USA INC  
GARDEN CITY B 5

CITIES SERVICE  
GARDEN CITY /N/ 1



Commingle Map  
Kansas

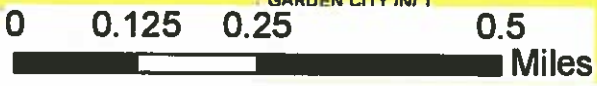

Scale: 1:12,000

Projection: NAD 27  
State Plane Kansas South

Date: 03/19/2014

Author: M. Jackson

AFFIDAVIT OF PUBLICATION

KEARNY COUNTY
STATE OF KANSAS ss:

KATHY McVEY, being first duly sworn, deposes and says: That she is editor of THE LAKIN INDEPENDENT, a weekly newspaper printed in the State of Kansas, and published in and of general circulation in Kearny County, Kansas, with a general paid circulation on a yearly basis in Kearny County, Kansas, and that said newspaper is not a trade, religious or fraternal publication.

Said newspaper is published at least weekly 50 times a year; has been so published continuously and uninterruptedly in said county and state for a period of more than five years prior to the first publication of said notice; and has been admitted at the post office of Lakin in said county as second class matter.

That the attached notice is a true copy thereof and was published in the regular and entire issue of said newspaper for 1 consecutive weeks, the first publication thereof being made as aforesaid on the

27th day of February, 2014, with subsequent publications being made on the following dates:

\_\_\_\_\_, 20\_\_\_\_, \_\_\_\_\_, 20\_\_\_\_

\_\_\_\_\_, 20\_\_\_\_, \_\_\_\_\_, 20\_\_\_\_

\_\_\_\_\_, 20\_\_\_\_, \_\_\_\_\_, 20\_\_\_\_

Kathy J McVey (handwritten signature)

Printer's fee: \$ 34.40

Subscribed and sworn to before me this 27th day of February, 2014.

Delores N. Edwards (handwritten signature)

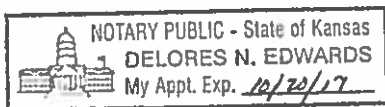

PUBLIC NOTICE

(Published in The Lakin Independent, Lakin, Kansas, Thursday, February 27, 2014.)

BEFORE THE STATE CORPORATION COMMISSION OF THE STATE OF KANSAS NOTICE OF FILING APPLICATION

RE: OXY USA Inc. Application for order to commingle Marmaton and Morrow sources of supply in Hylbom B-4 well, located in Sec 25 Twp 23S R 35W, Kearny County, Kansas.

TO: All Oil and Gas Producers, Unleased Minerals Interest Owners, Landowners, and all persons whosoever concerned.

You, and each of you, are hereby notified that OXY USA Inc. has filed an application to commingle the production from the Marmaton and Morrow sources of supply in the Hylbom B-4 well, located in the SW NW NE SE of Sec 25 Twp 23S R 35W in Kearny County, Kansas.

Any persons who object to or protest this application shall be required to file their objections or protests with the Conservation Division of the State Corporation Commission of the State of Kansas within fifteen (15) days from the date of this publication. These protests shall be filed pursuant to Commission regulations and must state specific reasons why the grant of the application may cause waste, violate correlative rights or pollute the natural resources of the State of Kansas. If no protests are received, this application may be granted through a summary proceeding. If valid protests are received, this matter will be set for hearing.

All persons interested or concerned shall take notice of the foregoing and shall govern themselves accordingly.

OXY USA Inc
P.O. Box 2528
Liberal, KS 67905
(620)-629-4200

**AFFIDAVIT**

STATE OF KANSAS

- SS.

County of Sedgwick

Mark Fletchall, of lawful age, being first duly sworn, deposes and saith: That he is Record Clerk of The Wichita Eagle, a daily newspaper published in the City of Wichita, County of Sedgwick, State of Kansas, and having a general paid circulation on a daily basis in said County, which said newspaper has been continuously and uninterruptedly published in said County for more than one year prior to the first publication of the notice hereinafter mentioned, and which said newspaper has been entered as second class mail matter at the United States Post Office in Wichita, Kansas, and which said newspaper is not a trade, religious or fraternal publication and that a notice of a true copy is hereto attached was published in the regular and entire Morning issue of said The Wichita Eagle for 1 issues, that the first publication of said notice was

made as aforesaid on the 26<sup>th</sup> of

February A.D. 2014, with

subsequent publications being made on the following dates:

And affiant further says that he has personal knowledge of the statements above set forth and that they are true.

*Mark Fletchall*

Subscribed and sworn to before me this

26th day of February, 2014

JENNIFER RAE BAILEY  
Notary Public, State of Kansas  
My Appt. Expires 6/1/2017

*JRB*  
Notary Public Sedgwick County, Kansas

Printer's Fee : \$113.20

**LEGAL PUBLICATION**

PUBLISHED IN THE WICHITA EAGLE  
FEBRUARY 26, 2014 (3289737)  
BEFORE THE STATE CORPORATION  
COMMISSION OF THE STATE OF KANSAS  
**NOTICE OF FILING APPLICATION**

RE: OXY USA Inc. Application for order to commingle Marmaton and Morrow sources of supply in Hyiborn B-4 well, located in Sec 25 Twp 23S R 35W, Kearny County, Kansas.

TO: All Oil and Gas Producers, Unleased Minerals Interest Owners, Landowners, and all persons whosever concerned.

You, and each of you, are hereby notified that OXY USA Inc. has filed an application to commingle the production from the Marmaton and Morrow sources of supply in the Hyiborn B-4 well, located in the SW NW NE SE of Sec 25 Twp 23S R 35W in Kearny County, Kansas. Any persons who object to or protest this application shall be required to file their objections or protests with the Conservation Division of the State Corporation Commission of the State of Kansas within fifteen (15) days from the date of this publication. These protests shall be filed pursuant to Commission regulations and must state specific reasons why the grant of the application may cause waste, violate correlative rights or pollute the natural resources of the State of Kansas. If no protests are received, this application may be granted through a summary proceeding. If valid protests are received, this matter will be set for hearing.

All persons interested or concerned shall take notice of the foregoing and shall govern themselves accordingly.

OXY USA Inc.  
P.O. Box 2528  
Liberal, KS 67905  
(620)-629-4200



Conservation Division  
Finney State Office Building  
130 S. Market, Rm. 2078  
Wichita, KS 67202-3802



Phone: 316-337-6200  
Fax: 316-337-6211  
<http://kcc.ks.gov/>

Shari Feist Albrecht, Chair  
Thomas E. Wright, Commissioner  
Jay Scott Emler, Commissioner

Sam Brownback, Governor

April 8, 2014

Idania Medina  
OXY USA, Inc.  
5 E Greenway Plz  
Houston, TX 77227-7570

RE: Approved Commingling CO031414  
HYLBOM B 4  
API Number: 15-093-21883-00-01

Dear Ms. Medina:

Your Application for Commingling (ACO-4) for the above described well has been reviewed and approved by the Kansas Corporation Commission (KCC) per K.A.R. 82-3-123. Notice was examined and found to be proper per K.A.R. 82-3-135a. No protest had been filed within the 15-day protest period.

Based upon the depth of the Morrow formation perforations, total oil production shall not exceed 200 BOPD and total gas production shall not exceed 50% of the absolute open flow (AOF).

Sincerely,

Rick Hestermann  
Production Department