



**APPLICATION FOR COMMINGLING OF PRODUCTION (K.A.R. 82-3-123) OR FLUIDS (K.A.R. 82-3-123a)** *Commingling ID # \_\_\_\_\_*

OPERATOR: License # \_\_\_\_\_ API No. 15 - \_\_\_\_\_  
Name: \_\_\_\_\_ Spot Description: \_\_\_\_\_  
Address 1: \_\_\_\_\_ - - - - - Sec. \_\_\_\_\_ Twp. \_\_\_\_\_ S. R. \_\_\_\_\_  East  West  
Address 2: \_\_\_\_\_ Feet from  North /  South Line of Section  
City: \_\_\_\_\_ State: \_\_\_\_\_ Zip: \_\_\_\_\_ + \_\_\_\_\_ Feet from  East /  West Line of Section  
Contact Person: \_\_\_\_\_ County: \_\_\_\_\_  
Phone: ( \_\_\_\_\_ ) \_\_\_\_\_ Lease Name: \_\_\_\_\_ Well #: \_\_\_\_\_

1. Name and upper and lower limit of each production interval to be commingled:  
Formation: \_\_\_\_\_ (Perfs): \_\_\_\_\_  
Formation: \_\_\_\_\_ (Perfs): \_\_\_\_\_  
Formation: \_\_\_\_\_ (Perfs): \_\_\_\_\_  
Formation: \_\_\_\_\_ (Perfs): \_\_\_\_\_  
Formation: \_\_\_\_\_ (Perfs): \_\_\_\_\_

2. Estimated amount of fluid production to be commingled from each interval:  
Formation: \_\_\_\_\_ BOPD: \_\_\_\_\_ MCFPD: \_\_\_\_\_ BWPD: \_\_\_\_\_  
Formation: \_\_\_\_\_ BOPD: \_\_\_\_\_ MCFPD: \_\_\_\_\_ BWPD: \_\_\_\_\_  
Formation: \_\_\_\_\_ BOPD: \_\_\_\_\_ MCFPD: \_\_\_\_\_ BWPD: \_\_\_\_\_  
Formation: \_\_\_\_\_ BOPD: \_\_\_\_\_ MCFPD: \_\_\_\_\_ BWPD: \_\_\_\_\_  
Formation: \_\_\_\_\_ BOPD: \_\_\_\_\_ MCFPD: \_\_\_\_\_ BWPD: \_\_\_\_\_

3. Plat map showing the location of the subject well, all other wells on the subject lease, and all wells on offsetting leases within a 1/2 mile radius of the subject well, and for each well the names and addresses of the lessee of record or operator.

4. Signed certificate showing service of the application and affidavit of publication as required in K.A.R. 82-3-135a.

**For Commingling of PRODUCTION ONLY, include the following:**

- 5. Wireline log of subject well. Previously Filed with ACO-1:  Yes  No
- 6. Complete Form ACO-1 (*Well Completion form*) for the subject well.

**For Commingling of FLUIDS ONLY, include the following:**

- 7. Well construction diagram of subject well.
- 8. Any available water chemistry data demonstrating the compatibility of the fluids to be commingled.

**AFFIDAVIT:** I am the affiant and hereby certify that to the best of my current information, knowledge and personal belief, this request for commingling is true and proper and I have no information or knowledge, which is inconsistent with the information supplied in this application.

**Submitted Electronically**

**KCC Office Use Only**  
 Denied  Approved  
15-Day Periods Ends: \_\_\_\_\_  
Approved By: \_\_\_\_\_ Date: \_\_\_\_\_

*Protests may be filed by any party having a valid interest in the application. Protests must be in writing and comply with K.A.R. 82-3-135b and must be filed within 15 days of publication of the notice of application.*



**CONFIDENTIAL**

**WELL COMPLETION FORM**

**WELL HISTORY - DESCRIPTION OF WELL & LEASE**

OPERATOR: License # \_\_\_\_\_

Name: \_\_\_\_\_

Address 1: \_\_\_\_\_

Address 2: \_\_\_\_\_

City: \_\_\_\_\_ State: \_\_\_\_\_ Zip: \_\_\_\_\_ + \_\_\_\_\_

Contact Person: \_\_\_\_\_

Phone: ( \_\_\_\_\_ ) \_\_\_\_\_

CONTRACTOR: License # \_\_\_\_\_

Name: \_\_\_\_\_

Wellsite Geologist: \_\_\_\_\_

Purchaser: \_\_\_\_\_

Designate Type of Completion:

- New Well       Re-Entry       Workover
- Oil       WSW       SWD       SIOW
- Gas       D&A       ENHR       SIGW
- OG       GSW       Temp. Abd.
- CM (Coal Bed Methane)
- Cathodic       Other (Core, Expl., etc.): \_\_\_\_\_

If Workover/Re-entry: Old Well Info as follows:

Operator: \_\_\_\_\_

Well Name: \_\_\_\_\_

Original Comp. Date: \_\_\_\_\_ Original Total Depth: \_\_\_\_\_

- Deepening       Re-perf.       Conv. to ENHR       Conv. to SWD
- Conv. to GSW
- Plug Back: \_\_\_\_\_ Plug Back Total Depth \_\_\_\_\_
- Commingled      Permit #: \_\_\_\_\_
- Dual Completion      Permit #: \_\_\_\_\_
- SWD      Permit #: \_\_\_\_\_
- ENHR      Permit #: \_\_\_\_\_
- GSW      Permit #: \_\_\_\_\_

|                                   |                 |   |
|-----------------------------------|-----------------|---|
| Spud Date or<br>Recompletion Date | Date Reached TD | Completion Date or<br>Recompletion Date |
|-----------------------------------|-----------------|---|

API No. 15 - \_\_\_\_\_

Spot Description: \_\_\_\_\_

\_\_\_\_\_ - \_\_\_\_\_ - \_\_\_\_\_ Sec. \_\_\_\_\_ Twp. \_\_\_\_\_ S. R. \_\_\_\_\_  East  West

\_\_\_\_\_ Feet from  North /  South Line of Section

\_\_\_\_\_ Feet from  East /  West Line of Section

Footages Calculated from Nearest Outside Section Corner:

- NE       NW       SE       SW

County: \_\_\_\_\_

Lease Name: \_\_\_\_\_ Well #: \_\_\_\_\_

Field Name: \_\_\_\_\_

Producing Formation: \_\_\_\_\_

Elevation: Ground: \_\_\_\_\_ Kelly Bushing: \_\_\_\_\_

Total Depth: \_\_\_\_\_ Plug Back Total Depth: \_\_\_\_\_

Amount of Surface Pipe Set and Cemented at: \_\_\_\_\_ Feet

Multiple Stage Cementing Collar Used?  Yes  No

If yes, show depth set: \_\_\_\_\_ Feet

If Alternate II completion, cement circulated from: \_\_\_\_\_

feet depth to: \_\_\_\_\_ w/ \_\_\_\_\_ sx cmt.

**Drilling Fluid Management Plan**

(Data must be collected from the Reserve Pit)

Chloride content: \_\_\_\_\_ ppm Fluid volume: \_\_\_\_\_ bbls

Dewatering method used: \_\_\_\_\_

Location of fluid disposal if hauled offsite: \_\_\_\_\_

Operator Name: \_\_\_\_\_

Lease Name: \_\_\_\_\_ License #: \_\_\_\_\_

Quarter \_\_\_\_\_ Sec. \_\_\_\_\_ Twp. \_\_\_\_\_ S. R. \_\_\_\_\_  East  West

County: \_\_\_\_\_ Permit #: \_\_\_\_\_

**AFFIDAVIT**

I am the affiant and I hereby certify that all requirements of the statutes, rules and regulations promulgated to regulate the oil and gas industry have been fully complied with and the statements herein are complete and correct to the best of my knowledge.

Submitted Electronically

**KCC Office Use ONLY**

- Letter of Confidentiality Received  
Date: \_\_\_\_\_
- Confidential Release Date: \_\_\_\_\_
- Wireline Log Received
- Geologist Report Received
- UIC Distribution
- ALT  I  II  III Approved by: \_\_\_\_\_ Date: \_\_\_\_\_



1166791

Operator Name: \_\_\_\_\_ Lease Name: \_\_\_\_\_ Well #: \_\_\_\_\_

Sec. \_\_\_\_\_ Twp. \_\_\_\_\_ S. R. \_\_\_\_\_  East  West County: \_\_\_\_\_

**INSTRUCTIONS:** Show important tops and base of formations penetrated. Detail all cores. Report all final copies of drill stems tests giving interval tested, time tool open and closed, flowing and shut-in pressures, whether shut-in pressure reached static level, hydrostatic pressures, bottom hole temperature, fluid recovery, and flow rates if gas to surface test, along with final chart(s). Attach extra sheet if more space is needed. Attach complete copy of all Electric Wire-line Logs surveyed. Attach final geological well site report.

|   |   |
|---|---|
| Drill Stem Tests Taken <input type="checkbox"/> Yes <input type="checkbox"/> No<br><i>(Attach Additional Sheets)</i><br><br>Samples Sent to Geological Survey <input type="checkbox"/> Yes <input type="checkbox"/> No<br><br>Cores Taken <input type="checkbox"/> Yes <input type="checkbox"/> No<br>Electric Log Run <input type="checkbox"/> Yes <input type="checkbox"/> No<br>Electric Log Submitted Electronically <input type="checkbox"/> Yes <input type="checkbox"/> No<br><i>(If no, Submit Copy)</i><br><br>List All E. Logs Run: | <input type="checkbox"/> Log Formation (Top), Depth and Datum <input type="checkbox"/> Sample<br><br>Name Top Datum |
|---|---|

| CASING RECORD <input type="checkbox"/> New <input type="checkbox"/> Used  |                   |                           |                   |               |                |              |                            |
|---|-------------------|---------------------------|-------------------|---------------|----------------|--------------|----------------------------|
| Report all strings set-conductor, surface, intermediate, production, etc. |                   |                           |                   |               |                |              |                            |
| Purpose of String   | Size Hole Drilled | Size Casing Set (In O.D.) | Weight Lbs. / Ft. | Setting Depth | Type of Cement | # Sacks Used | Type and Percent Additives |
|   |                   |                           |                   |               |                |              |                            |
|   |                   |                           |                   |               |                |              |                            |
|   |                   |                           |                   |               |                |              |                            |

| ADDITIONAL CEMENTING / SQUEEZE RECORD  |                  |                |              |                            |
|--|------------------|----------------|--------------|----------------------------|
| Purpose:   | Depth Top Bottom | Type of Cement | # Sacks Used | Type and Percent Additives |
| _____ Perforate<br>_____ Protect Casing<br>_____ Plug Back TD<br>_____ Plug Off Zone |                  |                |              |                            |
|  |                  |                |              |                            |

| Shots Per Foot | PERFORATION RECORD - Bridge Plugs Set/Type<br>Specify Footage of Each Interval Perforated | Acid, Fracture, Shot, Cement Squeeze Record<br><i>(Amount and Kind of Material Used)</i> | Depth |
|----------------|---|--|-------|
|                |   |  |       |
|                |   |  |       |
|                |   |  |       |
|                |   |  |       |
|                |   |  |       |

TUBING RECORD:      Size: \_\_\_\_\_ Set At: \_\_\_\_\_ Packer At: \_\_\_\_\_ Liner Run:  Yes  No

Date of First, Resumed Production, SWD or ENHR. \_\_\_\_\_ Producing Method:  Flowing  Pumping  Gas Lift  Other (Explain) \_\_\_\_\_

|                                   |           |         |             |               |         |
|-----------------------------------|-----------|---------|-------------|---------------|---------|
| Estimated Production Per 24 Hours | Oil Bbls. | Gas Mcf | Water Bbls. | Gas-Oil Ratio | Gravity |
|-----------------------------------|-----------|---------|-------------|---------------|---------|

|   |   |  |
|---|---|--|
| DISPOSITION OF GAS:<br><input type="checkbox"/> Vented <input type="checkbox"/> Sold <input type="checkbox"/> Used on Lease<br><i>(If vented, Submit ACO-18.)</i> | METHOD OF COMPLETION:<br><input type="checkbox"/> Open Hole <input type="checkbox"/> Perf. <input type="checkbox"/> Dually Comp. <input type="checkbox"/> Commingled<br><i>(Submit ACO-5)</i> <i>(Submit ACO-4)</i><br><input type="checkbox"/> Other (Specify) _____ | PRODUCTION INTERVAL:<br>_____<br>_____ |
|---|---|--|

|           |                        |
|-----------|------------------------|
| Form      | ACO1 - Well Completion |
| Operator  | OXY USA Inc.           |
| Well Name | DRUSSEL E 2            |
| Doc ID    | 1166791                |

All Electric Logs Run

|                                      |
|--------------------------------------|
|                                      |
| SPECTRAL DENSITY DUAL SPACED NEUTRON |
| MICROLOG                             |
| ARRAY COMPENSATED TRUE RESISTIVITY   |
| BOREHOLE COMPENSATED SONIC ARRAY     |

|           |                        |
|-----------|------------------------|
| Form      | ACO1 - Well Completion |
| Operator  | OXY USA Inc.           |
| Well Name | DRUSSEL E 2            |
| Doc ID    | 1166791                |

Tops

| Name          | Top  | Datum |
|---------------|------|-------|
| HEEBNER       | 3907 |       |
| TORONTO       | 3920 |       |
| LANSING       | 3954 |       |
| KANSAS CITY   | 4352 |       |
| MARMATON      | 4487 |       |
| PAWNEE        | 4573 |       |
| CHEROKEE      | 4623 |       |
| ATOKA         | 4794 |       |
| MORROW        | 4845 |       |
| ST. GENEVIEVE | 4948 |       |
| ST. LOUIS     | 5021 |       |

# ALLIED OIL & GAS SERVICES, LLC 052479

Federal Tax I.D.# 20-5975804

REMIT TO P.O. BOX 31  
RUSSELL, KANSAS 67665

SERVICE POINT:  
LIBERA KS

|  |                  |                             |                    |                 |             |                           |                            |
|--|------------------|-----------------------------|--------------------|-----------------|-------------|---------------------------|----------------------------|
| DATE <u>7/19/13</u>                                      | SEC. <u>38</u>   | TWP. <u>26</u>              | RANGE <u>33</u>    | CALLED OUT      | ON LOCATION | JOB START <u>11:30 AM</u> | JOB FINISH <u>12:45 PM</u> |
| LEASE <u>DRUSSEL</u>                                     | WELL # <u>E2</u> | LOCATION <u>PARALLEL Rd</u> | COUNTY <u>Fing</u> | STATE <u>KS</u> |             |                           |                            |
| OLD OR NEW <input checked="" type="radio"/> (Circle one) |                  | <u>W 1/2 N INTA Loc</u>     |                    |                 |             |                           |                            |

CONTRACTOR AZ TEC 567

TYPE OF JOB 8 3/4 SURFACE

HOLE SIZE 12 1/4 T.D. 1667'

CASING SIZE 8 3/8 DEPTH 1670'

TUBING SIZE DEPTH

DRILL PIPE DEPTH

TOOL DEPTH

PRES. MAX 2000 PSI MINIMUM D

MEAS. LINE SHOE JOINT 9/1.37'

CEMENT LEFT IN CSG. 41.37'

PERFS.

DISPLACEMENT 103.58 BBL

OWNER SAME

CEMENT

AMOUNT ORDERED 350 AM 9 CLASS C LEA

2 1/2 CYP 2 1/2 SWS 3.0CC 14 FLOSEA 12 1/4 SASI

2455 C 2 1/2 CC 14 FLOSEA TAIL

|                         |   |              |                             |
|-------------------------|---|--------------|-----------------------------|
| COMMON <u>C 245.5KS</u> | @ | <u>24.40</u> | <u>5978.00</u>              |
| POZMIX                  | @ |              |                             |
| GEL                     | @ |              |                             |
| CHLORIDE <u>CC 1PSK</u> | @ | <u>64.00</u> | <u>1152.00</u>              |
| ASC                     | @ |              |                             |
| <u>FLOSEA 149LB</u>     | @ | <u>2.97</u>  | <u>442.53</u>               |
| <u>SASI 66LB</u>        | @ | <u>17.55</u> | <u>1158.00</u>              |
| <u>AMD 350 SK</u>       | @ | <u>31</u>    | <u>10830.00</u>             |
|                         | @ |              |                             |
|                         | @ |              |                             |
| HANDLING <u>648</u>     | @ | <u>2.98</u>  | <u>1607.04</u>              |
| MILEAGE <u>1472.70</u>  | @ | <u>2.60</u>  | <u>3829.03</u>              |
|                         |   |              | <b>TOTAL <u>25016.9</u></b> |

EQUIPMENT

PUMP TRUCK CEMENTER R. RYAN

# 547550 HELPER K. BAEZA

BULK TRUCK

# 457251 DRIVER D. GALIA

BULK TRUCK

# 486554 DRIVER K. BAEZA

REMARKS:

THANK YOU

CIRC 150 BBL TO

CUT PIT

CHARGE TO: OXY USA Libcap

AP LOCATION/DEPT. 002  NON 002

LEASE/WELL/FAC Drussel E2

MAXIMO / WSM #

CITY/TASK 0102 STATE ELEMERIP 3023

PROJECT # 117199 CAPEX / OPEX - Circle one

SPO / BPA  UNSUPPORTED

PRINTED NAME Gene Bilby

SIGNATURE: Gene Bilby

To: Allied Oil & Gas Services, LLC.

You are hereby requested to rent cementing equipment and furnish cementer and helper(s) to assist owner or contractor to do work as is listed. The above work was done to satisfaction and supervision of owner agent or contractor. I have read and understand the "GENERAL TERMS AND CONDITIONS" listed on the reverse side.

PRINTED NAME Gene Bilby

SIGNATURE Gene Bilby

SERVICE

|                     |              |               |                             |
|---------------------|--------------|---------------|-----------------------------|
| DEPTH OF JOB        | <u>1670'</u> |               |                             |
| PUMP TRUCK CHARGE   |              |               | <u>2213.25</u>              |
| EXTRA FOOTAGE       | @            |               |                             |
| MILEAGE <u>50</u>   | @            | <u>7.70</u>   | <u>385.00</u>               |
| MANIFOLD + HEAD     | @            | <u>275.00</u> | <u>275.00</u>               |
| LT VEH IN <u>50</u> | @            | <u>4.40</u>   | <u>220.00</u>               |
|                     |              |               | <b>TOTAL <u>3093.25</u></b> |

PLUG & FLOAT EQUIPMENT

|                             |                 |                |
|-----------------------------|-----------------|----------------|
| <u>8 3/8 1" Guide Slot</u>  | <u>460.98</u>   | <u>460.98</u>  |
| <u>1" AFO</u>               | @ <u>446.91</u> | <u>446.91</u>  |
| <u>14 CEMENTAGREAS</u>      | @ <u>74.88</u>  | <u>1048.32</u> |
| <u>1 BASKET</u>             | @ <u>559.26</u> | <u>559.26</u>  |
| <u>STOP GATE</u>            | @ <u>56.16</u>  | <u>56.16</u>   |
| <u>T&amp;P Plug</u>         | @ <u>131.04</u> |                |
| <b>TOTAL <u>2702.26</u></b> |                 |                |

SALES TAX (If Any)

TOTAL CHARGES \$30,813.35

DISCOUNT

IF PAID IN 30 DAYS

Net \$18,796.14

# ALLIED OIL & GAS SERVICES, LLC 052480

Federal Tax I.D.# 20-5975804

REMIT TO P.O. BOX 31  
RUSSELL, KANSAS 67665

SERVICE POINT:  
FINNEY KS

|  |                  |  |                 |            |                      |                       |                        |
|--|------------------|--|-----------------|------------|----------------------|-----------------------|------------------------|
| DATE <u>7/13/13</u>                                      | SECS <u>38</u>   | TWP. <u>20</u>                         | RANGE <u>33</u> | CALLED OUT | ON LOCATION          | JOB START <u>8:00</u> | JOB FINISH <u>9:00</u> |
| LEASE <u>DRUSSEL</u>                                     | WELL # <u>E2</u> | LOCATION <u>PARCEL Rd W + N To Loc</u> |                 |            | COUNTY <u>FINNEY</u> | STATE <u>KS</u>       |                        |
| OLD OR <input checked="" type="radio"/> NEW (Circle one) |                  |  |                 |            |                      |                       |                        |

CONTRACTOR AD TEE 507

TYPE OF JOB 5 1/2 Long String

HOLE SIZE 7 1/8 T.D. 5155'

CASING SIZE 5 1/2 DEPTH 5155'

TUBING SIZE DEPTH

DRILL PIPE DEPTH

TOOL DEPTH

PRES. MAX 2200 PS MINIMUM 0

MEAS. LINE SHOE JOINT 40.62'

CEMENT LEFT IN CSG. 40.62'

PERFS.

DISPLACEMENT 11K.63 BBC

EQUIPMENT

|                  |          |                   |
|------------------|----------|-------------------|
| PUMP TRUCK       | CEMENTER | <u>R. Hagan</u>   |
| # <u>549-550</u> | HELPER   | <u>A Espinoza</u> |
| BULK TRUCK       |          |                   |
| # <u>470-524</u> | DRIVER   | <u>E Smith</u>    |
| BULK TRUCK       |          |                   |
| #                | DRIVER   |                   |

REMARKS:

THANK YOU!

RIG CREW WAS BIG HELP  
AS ALWAYS

CHARGE TO: OXY USA

STREET AP LOCATION/DEPT. Libcap D02  NON D02

LEASE/WELL/FAC Drussel E2

CITY MAXIMO / WSM # STATE        ZIP       

TASK 0102 ELEMENT 3023

PROJECT # 1171798 CAPEX / OPEX - Circle one

SPO / BPA         UNSUPPORTED

PRINTED NAME Gene Bilby

SIGNATURE: Gene Bilby

To: Allied Oil & Gas Services, LLC (All materials have been received)

You are hereby requested to rent cementing equipment and furnish cementer and helper(s) to assist owner or contractor to do work as is listed. The above work was done to satisfaction and supervision of owner agent or contractor. I have read and understand the "GENERAL TERMS AND CONDITIONS" listed on the reverse side.

PRINTED NAME \_\_\_\_\_

SIGNATURE \_\_\_\_\_

OWNER OXY

CEMENT

AMOUNT ORDERED 220 SK

50/50 162 CLASS H 2% BRK 5% GYP

SEAL 10% SALT 5/8" SC GILSONITE 1/4 FLO SEAL

5% FCB 160 2% C/D 31

|                    |   |              |                 |
|--------------------|---|--------------|-----------------|
| COMMON             | @ |              |                 |
| POZMIX             | @ |              |                 |
| GEL                | @ |              |                 |
| CHLORIDE SALT 13.4 | @ | <u>26.25</u> | <u>353.09</u>   |
| ASE APBH 220       | @ | <u>1685</u>  | <u>3707.00</u>  |
|                    | @ |              |                 |
| GYP SEAL 18.5      | @ | <u>37.40</u> | <u>695.40</u>   |
| GILSONITE 1100LB   | @ | <u>1.98</u>  | <u>1078.60</u>  |
| FLO SEAL 55LB      | @ | <u>7.99</u>  | <u>163.35</u>   |
| FLO 160 9290       | @ | <u>18.00</u> | <u>1796.76</u>  |
| C/D 31 32LB        | @ | <u>10.30</u> | <u>381.40</u>   |
| SUPER RUSH 12 PBL  | @ | <u>58.25</u> | <u>704.40</u>   |
|                    | @ |              |                 |
| HANDLING 295.40    | @ | <u>2.48</u>  | <u>732.59</u>   |
| MILEAGE 559.80     | @ | <u>2.00</u>  | <u>1455.44</u>  |
|                    | @ |              |                 |
|                    |   | TOTAL        | <u>11017.21</u> |

SERVICE

|                      |   |              |                |
|----------------------|---|--------------|----------------|
| DEPTH OF JOB         |   | <u>5155'</u> |                |
| PUMP TRUCK CHARGE    |   |              | <u>3099.25</u> |
| EXTRA FOOTAGE        | @ |              |                |
| MILEAGE <u>50 mi</u> | @ | <u>7.20</u>  | <u>385.00</u>  |
| MANIFOLD + HEAD      | @ | <u>2.75</u>  | <u>275.00</u>  |
| LT W/SH <u>mi</u>    | @ | <u>4.40</u>  | <u>220.00</u>  |
|                      | @ |              |                |
|                      |   | TOTAL        | <u>3979.25</u> |

PLUG & FLOAT EQUIPMENT

|                         |   |               |                |
|-------------------------|---|---------------|----------------|
| <u>5 1/2</u>            |   |               |                |
| <u>1 Guide Shoe</u>     | @ | <u>280.50</u> | <u>280.50</u>  |
| <u>20 CENTRAC 12145</u> | @ | <u>57.33</u>  | <u>1146.60</u> |
| <u>APG Float Valve</u>  | @ | <u>334.62</u> | <u>334.62</u>  |
| <u>- TOP Plug</u>       | @ |               | <u>85.41</u>   |
|                         | @ |               |                |
|                         |   | TOTAL         | <u>1847.43</u> |

SALES TAX (If Any) \_\_\_\_\_

TOTAL CHARGES 15,131.03

DISCOUNT \_\_\_\_\_ IF PAID IN 30 DAYS

10,591.23

Conservation Division  
Finney State Office Building  
130 S. Market, Rm. 2078  
Wichita, KS 67202-3802



Phone: 316-337-6200  
Fax: 316-337-6211  
<http://kcc.ks.gov/>

Mark Sievers, Chairman  
Thomas E. Wright, Commissioner  
Shari Feist Albrecht, Commissioner

Sam Brownback, Governor

November 04, 2013

LAURA BETH HICKERT  
OXY USA Inc.  
5 E GREENWAY PLZ  
PO BOX 27570  
HOUSTON, TX 77227-7570

Re: ACO1  
API 15-055-22227-00-00  
DRUSSEL E 2  
SW/4 Sec.36-25S-33W  
Finney County, Kansas

Dear Production Department:

We are herewith requesting that the Well Completion Form ACO-1 and attached information for the subject well be held confidential for a period of two years.

Should you have any questions or need additional information regarding subject well, please contact our office.

Respectfully,  
LAURA BETH HICKERT



**AFFIDAVIT OF NOTICE SERVED**

RE: Application for: OXY USA, INC.

Well Name: Drussel E-2  
Legal Location: NE SE SE SW 36-25S-33W

The undersigned hereby certifies that he/she is a duly authorized agent for the applicant, and that on the 24th day of March, 2014, a true and correct copy of the application referenced above was delivered or mailed to the following parties:

NOTE: A copy of this affidavit must be served as a part of the application.

|                               |   |
|-------------------------------|---|
| <b><u>Name:</u></b>           | <b><u>Address:</u></b> (attach additional sheets if necessary). |
| Drussel Inc., (Surface Owner) | 9585 S. Hands Rd, Garden City, KS 67846                         |
| Oxy USA, Inc.                 | P.O. Box 2528, Liberal, KS 67905                                |
| Linn Operating Inc            | 14000 Quail Springs Pkwy, Oklahoma City, OK 73134               |

Signed this 24th day of March, 2014.

  
Idania B. Medina  
Applicant or Duly Authorized Agent

Subscribed and sworn to before me this 24 day of March, 2014



  
\_\_\_\_\_  
Notary Public

My Commission Expires: Oct. 1, 2017

Protests may be filed by any party having a valid interest in the application. Petitions for protests shall be in writing and shall clearly identify the name and address of the protestant and the title of the application. The petition shall include a clear and concise statement of the direct and substantial interest of the protestant in the proceedings, including the manner in which the protestant may be affected, and the nature, extent, character and grounds of the protest. Protestants shall serve the protest upon the applicant by mail or personal service at the same time or before the protestant files the protest with the Conservation Division.

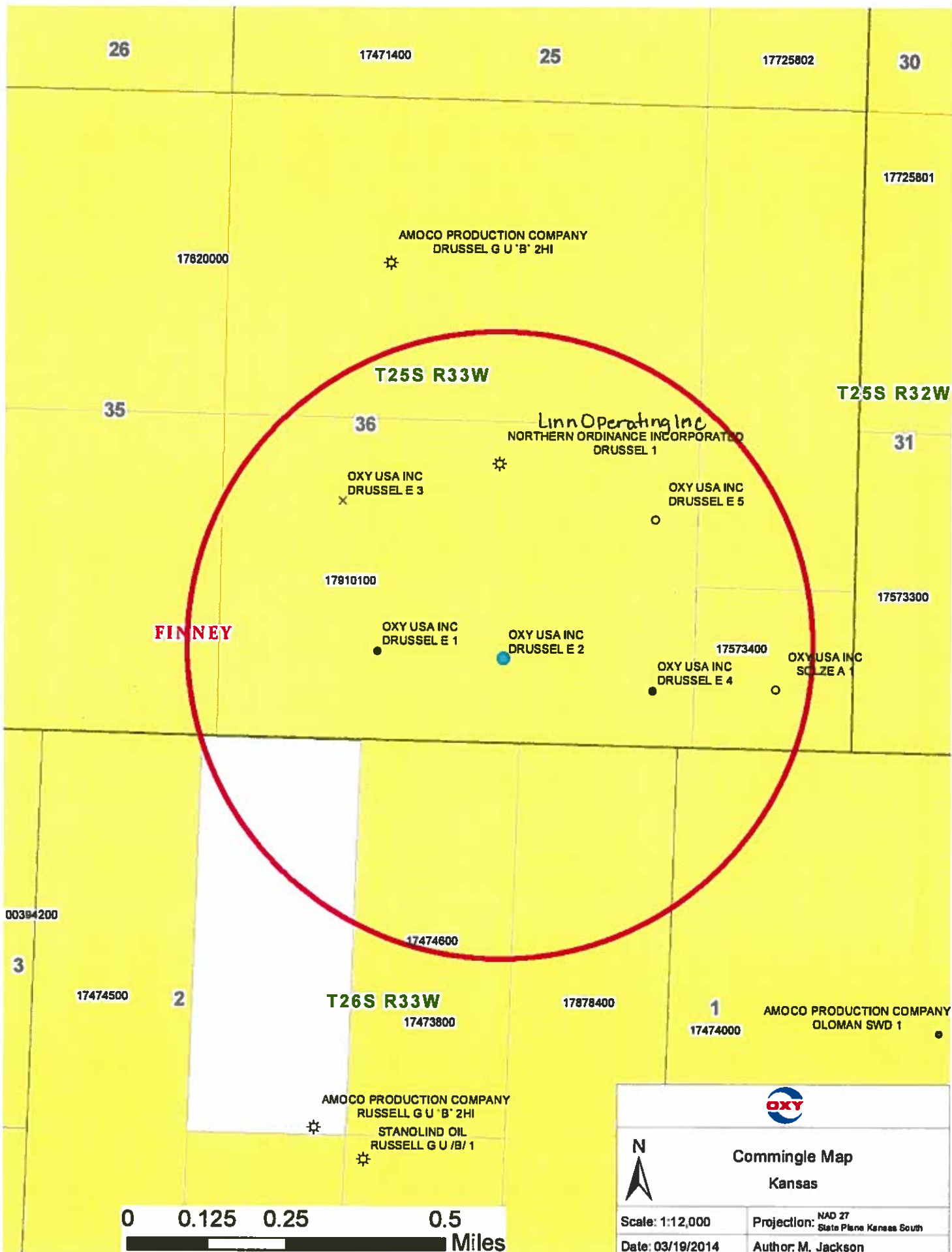

26

17471400

25

17725802

30

17620000

AMOCO PRODUCTION COMPANY  
DRUSSEL G U 'B' 2HI

17725801

T25S R33W

T25S R32W

35

36

Linn Operating Inc  
NORTHERN ORDINANCE INCORPORATED  
DRUSSEL 1

31

OXY USA INC  
DRUSSEL E 3

OXY USA INC  
DRUSSEL E 5

17910100

17573300

FINNEY

OXY USA INC  
DRUSSEL E 1

OXY USA INC  
DRUSSEL E 2

17573400

OXY USA INC  
DRUSSEL E 4

OXY USA INC  
SOLZEA 1

00394200

17474800

3

17474500

2

T26S R33W

17978400

1

AMOCO PRODUCTION COMPANY  
OLOMAN SWD 1

17473800

17474000

AMOCO PRODUCTION COMPANY  
RUSSELL G U 'B' 2HI  
STANOLIND OIL  
RUSSELL G U /B/ 1



Commingle Map  
Kansas

0 0.125 0.25 0.5  
Miles

Scale: 1:12,000

Projection: NAD 27  
State Plane Kansas South

Date: 03/19/2014

Author: M. Jackson

# Proof Of Publication

## State Of Kansas - Finney County

Dena A. Sattler, being first duly sworn, deposes and says that she is publisher of **THE GARDEN CITY TELEGRAM**, a weekly newspaper printed in the State of Kansas and published in and of general circulation in Finney County, Kansas, on a weekly basis in Finney County, Kansas, and that said newspaper is not a trade, religious, or fraternal publication.

THAT said newspaper is daily published at least weekly fifty (50) times a year; has been so published continuously and uninterruptedly in said county and state for a period of more than five (5) years prior to the first publication of said notice.

THAT the attached notice is a true copy thereof and was published in the regular and entire issue of said newspaper for 1 consecutive days/weeks. The first (1st) publication thereof being made as aforesaid on the 25 day of February, 2014.

With subsequent publications being made on the following dates:

- 2<sup>nd</sup> Publication made on the Y day of X, 20Y.
- 3<sup>rd</sup> Publication made on the Y day of X, 20X.
- 4<sup>th</sup> Publication made on the X day of X, 20X.

Publication Fee: \$ 51.52

Affidavits (Additional Copies): @ \$5 each \$

Total Publication Fee: \$ 51.52

Sign [Signature]

Witness my hand this 26 day of Feb, 2014.

SUBSCRIBED AND SWORN before me this 26<sup>th</sup> day of February, 2014.

[Signature]

(Notary Public)  
My commission expires 11-25-17

(Published in the Garden City Telegram, Tuesday, February 25, 2014)

**BEFORE THE STATE CORPORATION COMMISSION OF THE STATE OF KANSAS**  
NOTICE OF FILING APPLICATION

RE: OXY USA Inc. Application for order to commingle St. Louis, Pawnee, and Marmaton sources of supply in DRUSSEL E-2 well, located in Sec. 36 Twp 25S R 33W, Finney County, Kansas.

TO: All Oil and Gas Producers, Unleased Minerals Interest Owners, Landowners, and all persons whose ever concerned.

You, and each of you, are hereby notified that OXY USA Inc. has filed an application to commingle the production from the St. Louis, Pawnee, and Marmaton sources of supply in the DRUSSEL E-2 well, located in the NE SE SE SW of Sec 36 Twp 25S R 33W in Finney County, Kansas.

Any persons who object to or protest this application shall be required to file their objections or protests with the Conservation Division of the State Corporation Commission of the State of Kansas within fifteen (15) days from the date of this publication. These protests shall be filed pursuant to Commission regulations and must state specific reasons why the grant of the application may cause waste, violate correlative rights or pollute the natural resources of the State of Kansas. If no protests are received, this application may be granted through a summary proceeding. If valid protests are received, this matter will be set for hearing.

All persons interested or concerned shall take notice of the foregoing and shall govern themselves accordingly.

OXY USA Inc.  
P.O. Box 2528  
Liberal, KS 67905  
(820)-629-4200

230723

NOTARY PUBLIC-State of Kansas

**NANCY MILLER**  
My Appt. Exp 11-25-17

Legal Invoice #

**AFFIDAVIT**

STATE OF KANSAS \  
- SS.  
County of Sedgwick /

Mark Fletchall, of lawful age, being first duly sworn, deposeth and saith: That he is Record Clerk of The Wichita Eagle, a daily newspaper published in the City of Wichita, County of Sedgwick, State of Kansas, and having a general paid circulation on a daily basis in said County, which said newspaper has been continuously and uninterruptedly published in said County for more than one year prior to the first publication of the notice hereinafter mentioned, and which said newspaper has been entered as second class mail matter at the United States Post Office in Wichita, Kansas, and which said newspaper is not a trade, religious or fraternal publication and that a notice of a true copy is hereto attached was published in the regular and entire Morning issue of said The Wichita Eagle for  1  issues, that the first publication of said notice was

made as aforesaid on the  26<sup>th</sup>  of

**February** A.D. **2014**, with

subsequent publications being made on the following dates:

And affiant further says that he has personal knowledge of the statements above set forth and that they are true.

*Mark Fletchall*

Subscribed and sworn to before me this

**26th day of February, 2014**

JENNIFER RAE BAILEY  
Notary Public - State of Kansas  
My Appt. Expires 6/14/2017

*JRB*

Notary Public Sedgwick County, Kansas

Printer's Fee : **\$113.20**

**LEGAL PUBLICATION**

PUBLISHED IN THE WICHITA EAGLE  
FEBRUARY 26, 2014 (3289734)  
BEFORE THE STATE CORPORATION  
COMMISSION OF THE STATE OF KANSAS  
**NOTICE OF FILING APPLICATION**  
RE: OXY USA Inc. Application for order  
to commingle St. Louis, Pawnee, and  
Marmaton sources of supply in DRUSSEL  
E-2 well, located in Sec. 36 Twp 25S R 33W,  
Finney County, Kansas.

TO: All Oil and Gas Producers, Unleased  
Minerals Interest Owners, Landowners,  
and all persons whosoever concerned.

You, and each of you, are hereby notified  
that OXY USA Inc. has filed an application to  
commingle the production from the St. Louis,  
Pawnee, and Marmaton sources of supply  
in the DRUSSEL E-2 well, located in the  
NE SE SE SW of Sec 36 Twp 25S R 33W in  
Finney County, Kansas.

Any persons who object to or protest this  
application shall be required to file their  
objections or protests with the Conservation  
Division of the State Corporation Commission  
of the State of Kansas within fifteen (15)  
days from the date of this publication. These  
protests shall be filed pursuant to Commission  
regulations and must state specific reasons  
why the grant of the application may cause  
waste, violate correlative rights or pollute the  
natural resources of the State of Kansas. If no  
protests are received, this application may be  
granted through a summary proceeding. If  
valid protests are received, this matter will be  
set for hearing.

All persons interested or concerned shall  
take notice of the foregoing and shall govern  
themselves accordingly.

OXY USA Inc.  
P.O. Box 2528  
Liberal, KS 67905  
(620)-629-4200

Conservation Division  
Finney State Office Building  
130 S. Market, Rm. 2078  
Wichita, KS 67202-3802



Phone: 316-337-6200  
Fax: 316-337-6211  
<http://kcc.ks.gov/>

Shari Feist Albrecht, Chair  
Thomas E. Wright, Commissioner  
Jay Scott Emler, Commissioner

Sam Brownback, Governor

April 8, 2014

Idania Medina  
OXY USA, Inc.  
5 E Greenway Plz  
Houston, TX 77227-7570

RE: Approved Commingling CO031413  
DRUSSEL E 2  
API Number: 15-055-22227-00-00

Dear Ms. Medina:

Your Application for Commingling (ACO-4) for the above described well has been reviewed and approved by the Kansas Corporation Commission (KCC) per K.A.R. 82-3-123. Notice was examined and found to be proper per K.A.R. 82-3-135a. No protest had been filed within the 15-day protest period.

Based upon the depth of the St. Louis formation perforations, total oil production shall not exceed 200 BOPD and total gas production shall not exceed 50% of the absolute open flow (AOF).

Sincerely,

Rick Hestermann  
Production Department