



APPLICATION FOR COMMINGLING OF PRODUCTION (K.A.R. 82-3-123) OR FLUIDS (K.A.R. 82-3-123a) *Commingling ID # _____*

OPERATOR: License # _____ API No. 15 - _____
Name: _____ Spot Description: _____
Address 1: _____ - - - - - Sec. _____ Twp. _____ S. R. _____ East West
Address 2: _____ Feet from North / South Line of Section
City: _____ State: _____ Zip: _____ + _____ Feet from East / West Line of Section
Contact Person: _____ County: _____
Phone: (_____) _____ Lease Name: _____ Well #: _____

1. Name and upper and lower limit of each production interval to be commingled:
Formation: _____ (Perfs): _____
Formation: _____ (Perfs): _____
Formation: _____ (Perfs): _____
Formation: _____ (Perfs): _____
Formation: _____ (Perfs): _____

2. Estimated amount of fluid production to be commingled from each interval:
Formation: _____ BOPD: _____ MCFPD: _____ BWPD: _____
Formation: _____ BOPD: _____ MCFPD: _____ BWPD: _____
Formation: _____ BOPD: _____ MCFPD: _____ BWPD: _____
Formation: _____ BOPD: _____ MCFPD: _____ BWPD: _____
Formation: _____ BOPD: _____ MCFPD: _____ BWPD: _____

3. Plat map showing the location of the subject well, all other wells on the subject lease, and all wells on offsetting leases within a 1/2 mile radius of the subject well, and for each well the names and addresses of the lessee of record or operator.

4. Signed certificate showing service of the application and affidavit of publication as required in K.A.R. 82-3-135a.

For Commingling of PRODUCTION ONLY, include the following:

- 5. Wireline log of subject well. Previously Filed with ACO-1: Yes No
- 6. Complete Form ACO-1 (*Well Completion form*) for the subject well.

For Commingling of FLUIDS ONLY, include the following:

- 7. Well construction diagram of subject well.
- 8. Any available water chemistry data demonstrating the compatibility of the fluids to be commingled.

AFFIDAVIT: I am the affiant and hereby certify that to the best of my current information, knowledge and personal belief, this request for commingling is true and proper and I have no information or knowledge, which is inconsistent with the information supplied in this application.

Submitted Electronically

KCC Office Use Only
 Denied Approved
15-Day Periods Ends: _____
Approved By: _____ Date: _____

Protests may be filed by any party having a valid interest in the application. Protests must be in writing and comply with K.A.R. 82-3-135b and must be filed within 15 days of publication of the notice of application.

R 22 W

T
26
S

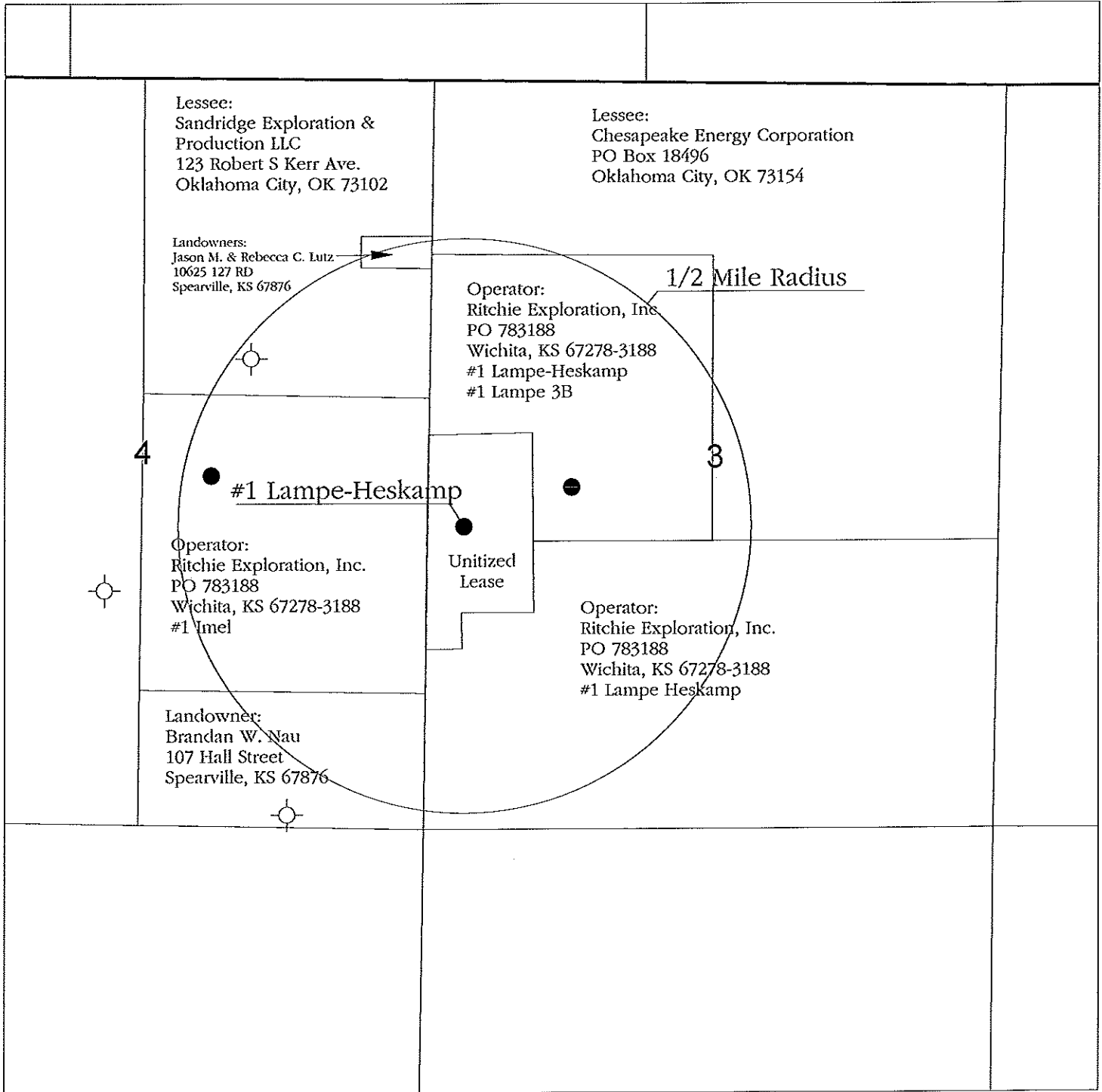

Legend

- Oil Well
- ⊕ Dry and Abandoned Well

 <p>RITCHIE EXPLORATION, INC. Wichita, Kansas</p>		<p>Application for Commingling of Production or Fluids</p>
<p>Applicant Well: #1 Lampe-Heskamp All Wells on Offsetting Leases within 1/2 Mile Radius Name and Address of Operator or Lessee of Record on Offsetting Leases</p>		
<p>Ford County, Kansas</p>		
<p>Prepared By: Justin Clegg</p>	<p>Scale: 1 : 16,000</p>	<p>Date: April 3, 2014</p>

APPLICATION FOR COMMINGLING OF PRODUCTION OR FLUIDS

**Operator, Lessee or Unleased Mineral Owner
within a ½ mile radius of Ritchie Exploration, Inc.'s**

**#1 Lampe-Heskamp
2780' FSL & 335' FWL
Section 3-26S-22W
Ford Co., KS**

Township 26 South, Range 22 West

Sec. 3: E/2N/2; Lots 3 & 4, ex. the S. 80 acres	Chesapeake Energy Corporation P.O. Box 18496 Oklahoma City, OK 73154	Lessee
S. 80 acres of Lots 3 & 4; S/2NW/4	Ritchie Exploration, Inc. P.O. Box 783188 Wichita, KS 67278-3188	Operator: #1 Lampe-Heskamp, #1 Lampe 3B
S/2	Ritchie Exploration, Inc.	Operator: #1 Lampe-Heskamp
Sec. 4: Lots 1 & 2, ex. 4.4 acre tract	Sandridge Exploration & Production LLC 123 Robert S Kerr Ave. Oklahoma City, OK 73102	Lessee
4.4 acre tract in Lot 1	Jason M. & Rebecca C. Lutz 10625 127 RD Spearville, KS 67876	Landowners
S/2NE/4; N/2SE/4	Ritchie Exploration, Inc.	Operator: #1 Imel
S/2SE/4	Brandan W. Nau 107 Hall Street Spearville, KS 67876	Landowner

AFFIDAVIT

STATE OF KANSAS)
 - SS.
County of Sedgwick)

John Niernberger, of lawful age, being first duly sworn, deposes and saith: That he is Production Manager of Ritchie Exploration, County of Sedgwick, State of Kansas, and that notice was given to all lessee of record or operator within ½ mile radius of the Lampe-Heskamp #1 well located in the County of Ford (see attached plat map). This notice included a letter and a copy of the Commingle Application (ACO-4). All notices were mailed on April 24, 2014.

made as aforesaid on the 24th of

April A.D. 2014

And affiant further says that he has personal knowledge of the statements above set forth and that they are true.

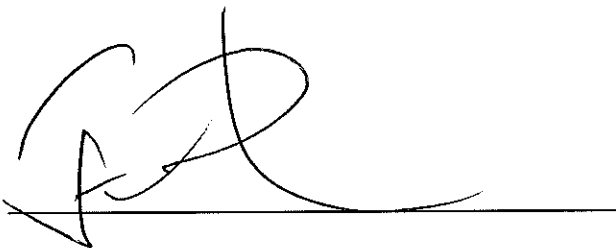

Subscribed and sworn to before me this

24th day of April 2014

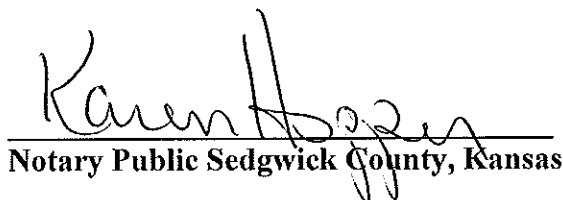
Notary Public Sedgwick County, Kansas

KAREN HOPPER
NOTARY PUBLIC-STATE OF KANSAS
MY APPT. EXPIRES 3-8-15



CONFIDENTIAL

WELL COMPLETION FORM
WELL HISTORY - DESCRIPTION OF WELL & LEASE

OPERATOR: License # 4767
Name: Ritchie Exploration, Inc.
Address 1: 8100 E 22ND ST N # 700
Address 2: BOX 783188
City: WICHITA State: KS Zip: 67278 + 3188
Contact Person: John Niernberger
Phone: (316) 691-9500
CONTRACTOR: License # 30606
Name: Murfin Drilling Co., Inc.
Wellsite Geologist: Dave Williams
Purchaser: NCRA

Designate Type of Completion:

- New Well Re-Entry Workover
- Oil WSW SWD SIOW
 Gas D&A ENHR SIGW
 OG GSW Temp. Abd.
 CM (Coal Bed Methane)
 Cathodic Other (Core, Expl., etc.): _____

If Workover/Re-entry: Old Well Info as follows:

Operator: _____

Well Name: _____

Original Comp. Date: _____ Original Total Depth: _____

- Deepening Re-perf. Conv. to ENHR Conv. to SWD
 Conv. to GSW
- Plug Back: _____ Plug Back Total Depth _____
 Commingled Permit #: _____
 Dual Completion Permit #: _____
 SWD Permit #: _____
 ENHR Permit #: _____
 GSW Permit #: _____

<u>04/14/2012</u>	<u>04/24/2012</u>	<u>04/24/2012</u>
Spud Date or Recompletion Date	Date Reached TD	Completion Date or Recompletion Date

API No. 15 - 15-057-20794-00-00

Spot Description: Irregular Section

SE SW SW NW Sec. 3 Twp. 26 S. R. 22 East West

2780 Feet from North / South Line of Section

335 Feet from East / West Line of Section

Footages Calculated from Nearest Outside Section Corner:

- NE NW SE SW

County: Ford

Lease Name: Lampe-Heskamp Well #: 1

Field Name: _____

Producing Formation: Altamont/Huck

Elevation: Ground: 2406 Kelly Bushing: 2417

Total Depth: 4956 Plug Back Total Depth: 4917

Amount of Surface Pipe Set and Cemented at: 312 Feet

Multiple Stage Cementing Collar Used? Yes No

If yes, show depth set: 1456 Feet

If Alternate II completion, cement circulated from: 0

feet depth to: 1456 w/ 300 sx cmt.

Drilling Fluid Management Plan

(Data must be collected from the Reserve Pit)

Chloride content: 6600 ppm Fluid volume: 675 bbls

Dewatering method used: Evaporated

Location of fluid disposal if hauled offsite: _____

Operator Name: _____

Lease Name: _____ License #: _____

Quarter _____ Sec. _____ Twp. _____ S. R. _____ East West

County: _____ Permit #: _____

AFFIDAVIT

I am the affiant and I hereby certify that all requirements of the statutes, rules and regulations promulgated to regulate the oil and gas industry have been fully complied with and the statements herein are complete and correct to the best of my knowledge.

Submitted Electronically

KCC Office Use ONLY

Letter of Confidentiality Received
Date: 07/24/2012

Confidential Release Date: _____

Wireline Log Received

Geologist Report Received

UIC Distribution

ALT I II III Approved by: Deanna Garrison Date: 07/30/2012



1088577

Operator Name: Ritchie Exploration, Inc. Lease Name: Lampe-Heskamp Well #: 1
 Sec. 3 Twp. 26 S. R. 22 East West County: Ford

INSTRUCTIONS: Show important tops and base of formations penetrated. Detail all cores. Report all final copies of drill stems tests giving interval tested, time tool open and closed, flowing and shut-in pressures, whether shut-in pressure reached static level, hydrostatic pressures, bottom hole temperature, fluid recovery, and flow rates if gas to surface test, along with final chart(s). Attach extra sheet if more space is needed. Attach complete copy of all Electric Wire-line Logs surveyed. Attach final geological well site report.

Drill Stem Tests Taken <input checked="" type="checkbox"/> Yes <input type="checkbox"/> No <i>(Attach Additional Sheets)</i> Samples Sent to Geological Survey <input checked="" type="checkbox"/> Yes <input type="checkbox"/> No Cores Taken <input type="checkbox"/> Yes <input checked="" type="checkbox"/> No Electric Log Run <input checked="" type="checkbox"/> Yes <input type="checkbox"/> No Electric Log Submitted Electronically <input checked="" type="checkbox"/> Yes <input type="checkbox"/> No <i>(If no, Submit Copy)</i> List All E. Logs Run: Dual Induction Log Compensated Density/Neutron Log	<input type="checkbox"/> Log Formation (Top), Depth and Datum <input checked="" type="checkbox"/> Sample Name Top Datum SEE ATTACHED
---	--

CASING RECORD <input checked="" type="checkbox"/> New <input type="checkbox"/> Used							
Report all strings set-conductor, surface, intermediate, production, etc.							
Purpose of String	Size Hole Drilled	Size Casing Set (In O.D.)	Weight Lbs./ Ft.	Selling Depth	Type of Cement	# Sacks Used	Type and Percent Additives
surface	12.25	8.63	23	312	class A	230	3% cc, 2% gel
production	7.875	4.5	10.5	4940	AA2	200	5% W-60, 10% sat, 6% D-15, 1.4# defc

ADDITIONAL CEMENTING / SQUEEZE RECORD				
Purpose:	Depth Top Bottom	Type of Cement	# Sacks Used	Type and Percent Additives
___ Perforate				
___ Protect Casing	-			
___ Plug Back TD				
___ Plug Off Zone	-			

Shots Per Foot	PERFORATION RECORD - Bridge Plugs Set/Type Specify Footage of Each Interval Perforated	Acid, Fracture, Shot, Cement Squeeze Record (Amount and Kind of Material Used)	Depth
4	4842.5'-4845.5', 4850.5'-4853.5' (5/31/12)	1000 gals 15% NE	
4	4677.5' - 4685.5' (5/31/12)	750 gals 15% NE	

TUBING RECORD:	Size: <u>2.67</u>	Set At: <u>4914'</u>	Packer At:	Liner Run: <input type="checkbox"/> Yes <input checked="" type="checkbox"/> No
----------------	-------------------	----------------------	------------	--

Date of First, Resumed Production, SWD or ENHR. <u>06/06/2012</u>	Producing Method: <input type="checkbox"/> Flowing <input checked="" type="checkbox"/> Pumping <input type="checkbox"/> Gas Lift <input type="checkbox"/> Other (Explain) _____				
Estimated Production Per 24 Hours	Oil Bbls. <u>123.98</u>	Gas Mcf	Water Bbls. <u>0</u>	Gas-Oil Ratio	Gravity <u>22</u>

DISPOSITION OF GAS: <input type="checkbox"/> Vented <input type="checkbox"/> Sold <input type="checkbox"/> Used on Lease <i>(If vented, Submit ACO-18.)</i>	METHOD OF COMPLETION: <input type="checkbox"/> Open Hole <input checked="" type="checkbox"/> Perf. <input type="checkbox"/> Dually Comp. <input type="checkbox"/> Commingled <i>(Submit ACO-5) (Submit ACO-4)</i> <input type="checkbox"/> Other (Specify) _____	PRODUCTION INTERVAL: _____ _____
---	---	--



#1 Lampe-Heskamp
2780' FSL & 335' FWL
Irregular Section 3-26S-22W
Ford County, Kansas
API# 15-057-20794-0000
Elevation: 2406' GL, 2417' KB

Sample Tops			Ref. Well
Anhydrite	1480'	+937	+19
B/Anhydrite	1513'	+904	+6
Stotler	3494'	-1077	-2
Heebner	4112'	-1695	+1
Lansing	4225'	-1808	-4
Muncie Shale	4396'	-1979	flat
Stark Shale	4499'	-2082	+6
BKC	4602'	-2185	+1
Marmaton	4606'	-2189	flat
Altamont	4652'	-2235	+3
Pawnee	4722'	-2305	+5
Fort Scott	4754'	-2337	+5
Cherokee Shale	4775'	-2358	+4
Huck	4841'	-2424	+2
Atoka Shale	4853'	-2436	+3
Mississippian	4874'	-2457	+5
RTD	4956'	-2539	

AFFIDAVIT

STATE OF KANSAS \
- SS.
County of Sedgwick /

Mark Fletchall, of lawful age, being first duly sworn, deposeth and saith: That he is Record Clerk of The Wichita Eagle, a daily newspaper published in the City of Wichita, County of Sedgwick, State of Kansas, and having a general paid circulation on a daily basis in said County, which said newspaper has been continuously and uninterruptedly published in said County for more than one year prior to the first publication of the notice hereinafter mentioned, and which said newspaper has been entered as second class mail matter at the United States Post Office in Wichita, Kansas, and which said newspaper is not a trade, religious or fraternal publication and that a notice of a true copy is hereto attached was published in the regular and entire Morning issue of said The Wichita Eagle for _1_ issues, that the first publication of said notice was

made as aforesaid on the 25th

April A.D. 2014, with

subsequent publications being made on the following dates:

And affiant further says that he has personal knowledge of the statements above set forth and that they are true.

Mark Fletchall

Subscribed and sworn to before me this

25th day of April, 2014

JENNIFER RAE BAILEY
Notary Public - State of Kansas
My Appt. Expires 04/14/2017

[Signature]
Notary Public Sedgwick County, Kansas

Printer's Fee : \$158.80

230 Legal Notices
LEGAL NOTICE
You, and each of you, are hereby notified that Ritchie Exploration, Inc. has filed an application to commence the commingling of production from the Huck and Altamont-B sources of supply for the #1 Lampe-Heskamp well located approx. SE SW NW of Section 3-26S-22W, Ford County, Kansas.
Any persons who object to or protest this application shall be required to file their objections or protests with the Conservation Division of the State Corporation Commission of the State of Kansas within fifteen (15) days from the date of the publication. These protests shall be filed pursuant to Commission regulations and must state specific reasons why the grant of the application may cause waste, violate correlative rights or pollute the natural resources of the state of Kansas.
If no protests are received, this application may be granted through a summary proceeding. If valid protests are received, this matter will be set for hearing.
All persons interested or concerned shall take notice of the foregoing and shall govern themselves accordingly.
RITCHIE EXPLORATION, INC.
P.O. Box 783188
Wichita, KS 67278-3188
(316) 691-9500

Proof of Publication
State of Kansas, Ford County, SS.

Dodge City Daily Globe

Ritchie Exploration, Inc.
PO Box 783188
Wichita, KS 67278

Reference: 75277 Account: 114170
Case No. Lampe-Heskamp #1

Ed O'Neal of lawful age, being duly sworn upon oath, states that he is the Circulation Manager of the DODGE CITY DAILY GLOBE.

THAT said newspaper has been published at least weekly fifty (50) times a year and has been so published for at least five years prior to the first publication of the attached notice;

THAT said paper was entered as second-class mail matter at the post office of its publication;

THAT said paper has a general paid circulation on a daily, or weekly, or yearly basis in FORD COUNTY KANSAS, and is NOT a trade, religious or fraternal publication and has been PRINTED and published in FORD COUNTY, KANSAS.

THE ATTACHED was published on the following dates in a regular issue of said paper:

(Sign) *Ed O'Neal*

PUBLISHED ON: 04/26/2014
TOTAL COST: \$ 32.50
FILED ON: 04/26/2014
AD SPACE: 6.25 inches

Witness my hand this 26 day of April, 2014.

SUBSCRIBED and Sworn to Before Me This 26 day of April, 2014.

Kathy Runquist
Notary Public, Ford County, Kansas



(Published in the Dodge City Daily Globe on Saturday, April 26, 2014)
LEGAL NOTICE

You, and each of you, are hereby notified that Ritchie Exploration, Inc. has filed an application to commence the commingling of production from the Huck and Altamont-B sources of supply for the #1 Lampe-Heskamp well located approx. SE SW SW NW of Section 3-26S-22W, Ford County, Kansas.

Any persons who object to or protest this application shall be required to file their objections or protests with the Conservation Division of the State Corporation Commission of the State of Kansas within fifteen (15) days from the date of the publication. These protests shall be filed pursuant to Commission regulations and must state specific reasons why the grant of the application may cause waste, violate correlative rights or pollute the natural resources of the state of Kansas. If no protests are received, this application may be granted through a summary proceeding. If valid protests are received, this matter will be set for hearing.

All persons interested or concerned shall take notice of the foregoing and shall govern themselves accordingly.

RITCHIE EXPLORATION, INC
P.O. Box 783188
Wichita, KS 67278-3188
(316) 691-9500
1xSat

Conservation Division
Finney State Office Building
130 S. Market, Rm. 2078
Wichita, KS 67202-3802



Phone: 316-337-6200
Fax: 316-337-6211
<http://kcc.ks.gov/>

Shari Feist Albrecht, Chair
Jay Scott Emler, Commissioner
Pat Apple, Commissioner

Sam Brownback, Governor

May 27, 2014

John Niernberger
Ritchie Exploration, Inc.
P.O. Box 783188
Wichita, KS 67278-3188

RE: Approved Commingling CO051407
Lampe-Heskamp 1
API No. 15-057-20794-00-00

Dear Mr. Niernberger:

Your Application for Commingling (ACO-4) for the above described well has been reviewed and approved by the Kansas Corporation Commission (KCC) per K.A.R. 82-3-123. Notice was examined and found to be proper per K.A.R. 82-3-135a. No protest had been filed within the 15-day protest period.

Based upon the depth of the Huck formation perforations, total oil production shall not exceed 200 BOPD and total gas production shall not exceed 50% of the absolute open flow (AOF).

Sincerely,

Rick Hestermann
Production Department