



APPLICATION FOR COMMINGLING OF PRODUCTION (K.A.R. 82-3-123) OR FLUIDS (K.A.R. 82-3-123a) *Commingling ID # _____*

OPERATOR: License # _____ API No. 15 - _____
Name: _____ Spot Description: _____
Address 1: _____ - - - - - Sec. _____ Twp. _____ S. R. _____ East West
Address 2: _____ Feet from North / South Line of Section
City: _____ State: _____ Zip: _____ + _____ Feet from East / West Line of Section
Contact Person: _____ County: _____
Phone: (_____) _____ Lease Name: _____ Well #: _____

1. Name and upper and lower limit of each production interval to be commingled:
Formation: _____ (Perfs): _____
Formation: _____ (Perfs): _____
Formation: _____ (Perfs): _____
Formation: _____ (Perfs): _____
Formation: _____ (Perfs): _____

2. Estimated amount of fluid production to be commingled from each interval:
Formation: _____ BOPD: _____ MCFPD: _____ BWPD: _____
Formation: _____ BOPD: _____ MCFPD: _____ BWPD: _____
Formation: _____ BOPD: _____ MCFPD: _____ BWPD: _____
Formation: _____ BOPD: _____ MCFPD: _____ BWPD: _____
Formation: _____ BOPD: _____ MCFPD: _____ BWPD: _____

3. Plat map showing the location of the subject well, all other wells on the subject lease, and all wells on offsetting leases within a 1/2 mile radius of the subject well, and for each well the names and addresses of the lessee of record or operator.

4. Signed certificate showing service of the application and affidavit of publication as required in K.A.R. 82-3-135a.

For Commingling of PRODUCTION ONLY, include the following:

- 5. Wireline log of subject well. Previously Filed with ACO-1: Yes No
- 6. Complete Form ACO-1 (*Well Completion form*) for the subject well.

For Commingling of FLUIDS ONLY, include the following:

- 7. Well construction diagram of subject well.
- 8. Any available water chemistry data demonstrating the compatibility of the fluids to be commingled.

AFFIDAVIT: I am the affiant and hereby certify that to the best of my current information, knowledge and personal belief, this request for commingling is true and proper and I have no information or knowledge, which is inconsistent with the information supplied in this application.

Submitted Electronically

KCC Office Use Only
 Denied Approved
15-Day Periods Ends: _____
Approved By: _____ Date: _____

Protests may be filed by any party having a valid interest in the application. Protests must be in writing and comply with K.A.R. 82-3-135b and must be filed within 15 days of publication of the notice of application.

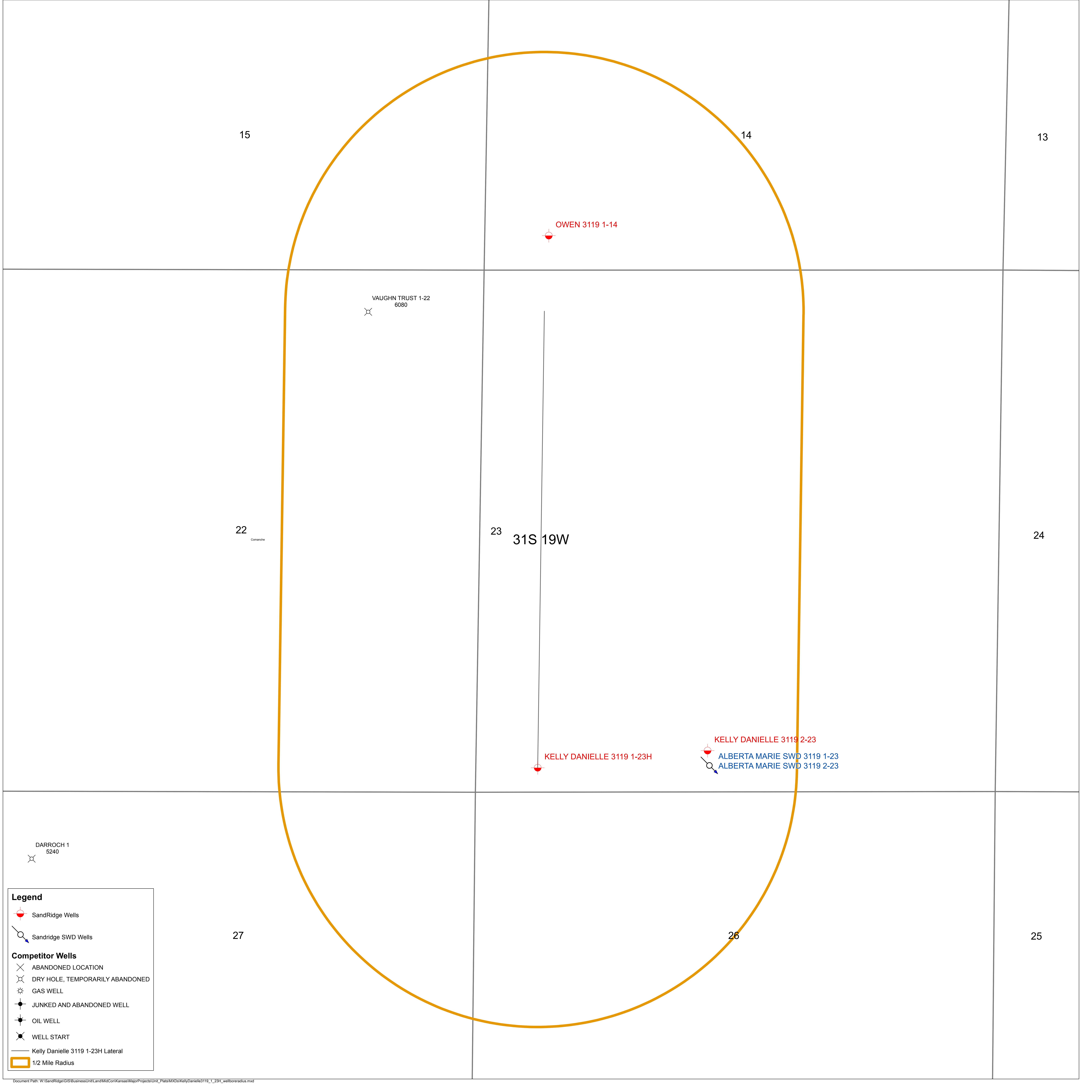

15

14

13

OWEN 3119 1-14

VAUGHN TRUST 1-22
6080

22

23

31S 19W

24

KELLY DANIELLE 3119 1-23H

KELLY DANIELLE 3119 2-23

ALBERTA MARIE SWD 3119 1-23
ALBERTA MARIE SWD 3119 2-23











DARROCH 1
5240

27

26

25

Legend

-  SandRidge Wells
-  Sandridge SWD Wells
- Competitor Wells**
-  ABANDONED LOCATION
-  DRY HOLE, TEMPORARILY ABANDONED
-  GAS WELL
-  JUNKED AND ABANDONED WELL
-  OIL WELL
-  WELL START
-  Kelly Danielle 3119 1-23H Lateral
-  1/2 Mile Radius

Kelly Danielle 3119 1-23H

Unit Description

Sections 15 and 23-31S-19W			

Unleased Mineral Owners

<u>Name:</u>	<u>Address:</u>		
N.A.			

Operators

<u>Name:</u>	<u>Address:</u>		
SandRidge: all of 14, 15, 23-31S-19W			

Lessees Of Non-Producing Leasehold

<u>Name:</u>	<u>Address:</u>		
Chesapeake: NE/4 of 22-31S-19W	Chesapeake Exploration, LLC	P.O. Box 18496	Oklahoma City, OK 73154
Cheyenne: NW/4 of 22-31S-19W and N/2, SE/4 of 26-31S-19W	Cheyenne Exploration, LLC	14860 Montfort Drive, Suite 209	Dallas, TX 75254
SandRidge: SW/4 of 26-31S-19W and S/2 of 22-31S-19W and E/2 of 27-31S-19W			

**THE STATE CORPORATION COMMISSION
OF THE STATE OF KANSAS**

IN THE MATTER OF THE APPLICATION)
OF SANDRIDGE EXPLORATION AND)
PRODUCTION, LLC FOR PERMISSION)
TO COMMINGLE PRODUCTION FROM)
THE KELLY DANIELLE 3119 #1-23H WELL) KCC License No. 34192
IN COMANCHE COUNTY, KANSAS,)
PURSUANT TO K.A.R. § 82-3-124) CONSERVATION DIVISION
_____)

**NOTICE OF PENDING APPLICATION
FOR PERMISSION TO COMMINGLE PRODUCTION**

TO: ALL OIL AND GAS PRODUCERS, UNLEASED MINERAL INTEREST OWNERS,
LANDOWNERS, AND ALL PERSONS WHOSOEVER CONCERNED.

You, and each of you, are hereby notified that SANDRIDGE EXPLORATION AND PRODUCTION, LLC has filed an Application with the State Corporation Commission of the State of Kansas (the "Commission") seeking permission to commingle production, pursuant to K.A.R. §§ 82-3-124, from the Mississippi and Oswego formations in the following well located in Comanche County, Kansas:

Kelly Danielle 3119 #1-23H well
API No. 15-033-21637-01-00
Surface Location: 245' FSL and 4,636' FEL of Section 23-31S-19W

The Commission may approve SANDRIDGE EXPLORATION AND PRODUCTION, LLC's request to commingle production from the subject well without a hearing or further notice if no timely protest is filed. Any persons who object to or protest the request to commingle production from that well should file their objections or protests with the Commission within fifteen (15) days from the date of this publication. Any protest must be filed pursuant to the Commission's regulations and must state specific reasons why the grant of the Application may case waste, violate correlative rights, or pollute the natural resources of the state of Kansas. If any valid protests are timely filed, the request will be set forth hearing by the Commission. All parties in any way interested or concerned shall take notice of the foregoing and govern themselves accordingly.

David E. Bengtson (#12184)
STINSON LEONARD STREET LLP
1625 N. Waterfront Pkwy., Suite 300
Wichita, Kansas 67206-6620
(316) 265-8800
Fax: (316) 265-1349

Attorneys for SandRidge Exploration and
Production, LLC

Certificate of Service

The undersigned hereby certifies that on July 9th, 2014, a copy of the KCC Form ACO-4, Application for Commingling of Production, and the Notice of Pending Application were mailed to the following persons and entities who constitute all of those persons entitled to notice of this Application pursuant to K.A.R. §82-3-15a:

[See Attachment A]

A handwritten signature in cursive script, reading "Wanda Ledbetter", is written over a solid horizontal line.

Wanda Ledbetter

Regulatory Analyst

Attachment A:

1. Chesapeake Exploration, LLC
PO Box 18496
Oklahoma City, OK 73154
2. Cheyenne Exploration, LLC
14860 Montfort Drive, Suite 209
Dallas, TX 75254

AFFIDAVIT

STATE OF KANSAS \
- SS.
County of Sedgwick /

Mark Fletchall, of lawful age, being first duly sworn, deposeth and saith: That he is Record Clerk of The Wichita Eagle, a daily newspaper published in the City of Wichita, County of Sedgwick, State of Kansas, and having a general paid circulation on a daily basis in said County, which said newspaper has been continuously and uninterruptedly published in said County for more than one year prior to the first publication of the notice hereinafter mentioned, and which said newspaper has been entered as second class mail matter at the United States Post Office in Wichita, Kansas, and which said newspaper is not a trade, religious or fraternal publication and that a notice of a true copy is hereto attached was published in the regular and entire Morning issue of said The Wichita Eagle for _1_ issues, that the first publication of said notice was

made as aforesaid on the 28th of

June A.D. 2014, with

subsequent publications being made on the following dates:

And affiant further says that he has personal knowledge of the statements above set forth and that they are true.

Mark Fletchall

Subscribed and sworn to before me this

30th day of June, 2014

JENNIFER RAE BAILEY
Notary Public - State of Kansas
My Appt. Expires 6/4/2017

JRB

Notary Public Sedgwick County, Kansas

Printer's Fee : \$220.80

LEGAL PUBLICATION
PUBLISHED IN THE WICHITA EAGLE
JUNE 28, 2014 (3307470)
THE STATE CORPORATION COMMISSION
OF THE STATE OF KANSAS
IN THE MATTER OF THE APPLICATION
OF SANDRIDGE EXPLORATION AND
PRODUCTION, LLC FOR PERMISSION TO
COMMINGLE PRODUCTION FROM THE
KELLY DANIELLE 3119 #1-23H WELL IN
COMANCHE COUNTY, KANSAS,
PURSUANT TO K.A.R. § 82-3-124
KCC License No. 34192
CONSERVATION DIVISION
NOTICE OF PENDING APPLICATION
FOR PERMISSION TO COMMINGLE
PRODUCTION
TO: ALL OIL AND GAS PRODUCERS,
UNLEASED MINERAL INTEREST
OWNERS, LANDOWNERS, AND ALL
PERSONS WHOSEVER CONCERNED.
You, and each of you, are hereby notified
that SANDRIDGE EXPLORATION AND
PRODUCTION, LLC has filed an Application
with the State Corporation Commission of
the State of Kansas (the "Commission") seeking
permission to commingle production, pursuant
to K.A.R. § 82-3-124, from the Mississippi and
Oswego formations in the following well located
in Comanche County, Kansas:
Kelly Danielle 3119 #1-23H well
API No. 15-033-21637-01-00
Surface Location: 245' FSL and 4,636'
FEL of Section 23-31S-19W
The Commission may approve
SANDRIDGE EXPLORATION AND
PRODUCTION, LLC's request to commingle
production from the subject well without a
hearing or further notice if no timely protest
is filed. Any persons who object to or protest
the request to commingle production from
that well should file their objections or protests
with the Commission within fifteen (15) days
from the date of this publication. Any protest
must be filed pursuant to the Commission's
regulations and must state specific reasons
why the grant of the Application may cause
waste, violate correlative rights, or pollute
the natural resources of the state of Kansas. If
any valid protests are timely filed, the request
will be set forth hearing by the Commission.
All parties in any way interested or concerned
shall take notice of the foregoing and govern
themselves accordingly.
David E. Bengtson (#12184)
STINSON LEONARD STREET LLP
1625 N. Waterfront Pkwy., Suite 300
Wichita, Kansas 67206-6620
(316) 265-8800
Fax: (316) 265-1349
Attorneys for SandRidge
Exploration and
Production, LLC

Notice

Published in The Western Star
Thursday, June 26, 2014. 48c

THE STATE CORPORATION
COMMISSION
OF THE STATE OF KANSAS

IN THE MATTER OF THE APPLI-
CATION OF SANDRIDGE EX-
PLORATION AND PRODUC-
TION, LLC FOR PERMISSION
TO COMMINGLE PRODUCTION
FROM THE KELLY DANIELLE
3119 #1-23H WELL IN COMAN-
CHE COUNTY, KANSAS, PUR-
SUANT TO K.A.R. § 82-3-124

KCC License No. 34192

CONSERVATION DIVISION

NOTICE OF PENDING APPLI-
CATION FOR PERMISSION TO
COMMINGLE PRODUCTION

TO: ALL OIL AND GAS PRO-
DUCERS, UNLEASED MIN-
ERAL INTEREST OWNERS,
LANDOWNERS, AND ALL
PERSONS WHOSEVER
CONCERNED.

You, and each of you, are hereby
notified that SANDRIDGE EX-
PLORATION AND PRODUC-
TION, LLC has filed an applica-
tion with the State Corporation
Commission of the State of Kan-
sas (the "Commission") seeking
permission to commingle produc-
tion, pursuant to K.A.R. §82-3-
124, from the Mississippi and Os-
wego formations in the following
well located in Comanche
County, Kansas:

Kelly Danielle 3119 #1-23H
well API No. 15-033-21637-
01-00 Surface Location: 245'
FSL and 4,636' FEL of Section
23-31S-19W

The Commission may approve
SANDRIDGE EXPLORATION
AND PRODUCTION, LLC's re-
quest to commingle production
from the subject well without a
hearing or further notice if no
timely protest is filed. Any per-
sons who object to or protest the
request to commingle production
from that well should file their
objections or protests with the
Commission within fifteen (15)
days from the date of this publi-
cation. Any protest must be filed
pursuant to the Commission's
regulations and must state spe-
cific reasons why the grant of the
Application may cause waste, vio-
late correlative rights, or pollute
the natural resources of the state
of Kansas. If any valid protests
are timely filed, the request will
be set forth hearing by the Com-
mission. All parties in any way
interested or concerned shall
take notice of the foregoing and
govern themselves accordingly.

David E. Bengtson (#12184)
STINSON LEONARD STREET LLP
1625 N. Waterfront Pkwy.,
Suite 300
Wichita, Kansas 67206-6620
(316) 265-8800
Fax: (316) 265-1349

Attorneys for SandRidge

Affidavit of Publication

State of Kansas, Comanche County, ss.

Dennies D. Andersen, of lawful age, being duly
sworn says he is the editor of *THE WESTERN STAR*, a
newspaper printed in the State of Kansas and pub-
lished in the City of Coldwater, County of Coman-
che, State of Kansas, which newspaper has been
admitted to the mails as periodical class matter in
said county, and is of general circulation in said
county, and the printed notice hereunto attached
was published in the regular and entire issue of
every number of said newspaper for

1 consecutive weeks, as follows:

1st publication June 26, 20 14

2nd publication _____, 20 _____

3rd publication _____, 20 _____

4th publication _____, 20 _____

5th publication _____, 20 _____

And further, that said newspaper is a weekly pub-
lished at least weekly 50 times a year; has been so
published continuously and uninterruptedly in said
county and state for a period of more than five
years prior to the first publication of said notice,
and that said newspaper is not a trade, religious or
fraternal publication.

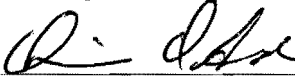

Subscribed and sworn to before me this 7

day of July, 20 14



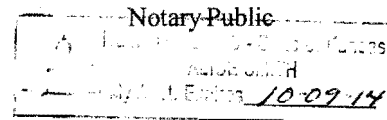

Publication Fee \$ 32.55

Total Publication Fee \$ 32.55

From: Jessica Tripp
Sent: Wednesday, June 25, 2014 2:29 PM
To: Wanda Ledbetter
Subject: RE: Kelly Danielle 3119 1-23H

Wanda,

From the deviation survey the location of the Oswego perfs are as follows:

FNL 4768'

FSL 518'

FWL 661'

FEL 4650'

Also, Jeff and I did the math and the perfs are going to be 3.9° from the surface location.

Hope this helps!

Thank you,

Jessica



Spud: 6/22/2012

Current

Wellbore Schematic

Field: Spur
 County: Comanche
 State: KS
 Well: Kelly Danielle 3119 1-23H
 Location: SEC 23 TWP 31S, RGE 19W
 Elevations: 2156 KB; 2136 CL

Original Completion (6-7-2012)	
Current	X
Proposed	

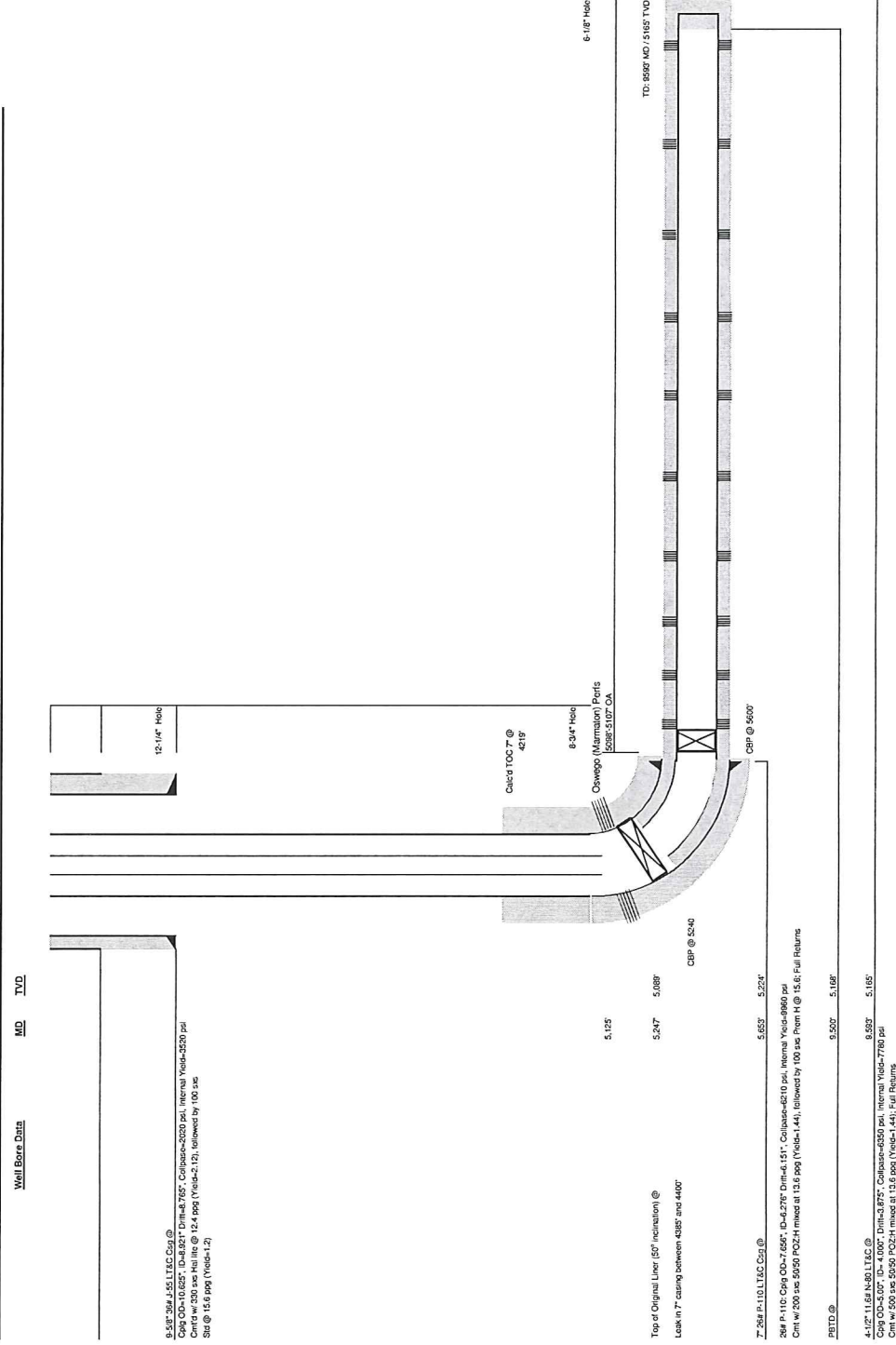

Conservation Division
Finney State Office Building
130 S. Market, Rm. 2078
Wichita, KS 67202-3802



Phone: 316-337-6200
Fax: 316-337-6211
<http://kcc.ks.gov/>

Shari Feist Albrecht, Chair
Jay Scott Emler, Commissioner
Pat Apple, Commissioner

Sam Brownback, Governor

July 24, 2014

Wand Ledbetter
SandRidge Exploration & Production LLC
123 Robert S. Kerr Ave
Oklahoma City, OK 73102-6406

RE: Approved Commingling CO071406
Kelly Danielle 3119 1-23H
API No. 15-033-21637-01-01

Dear Ms. Ledbetter:

Your Application for Commingling (ACO-4) for the above described well has been reviewed and approved by the Kansas Corporation Commission (KCC) per K.A.R. 82-3-123. Notice was examined and found to be proper per K.A.R. 82-3-135a. No protest had been filed within the 15-day protest period.

Based upon the depth of the Mississippi formation perforations, total oil production shall not exceed 200 BOPD and total gas production shall not exceed 50% of the absolute open flow (AOF).

Sincerely,

Rick Hestermann
Production Department