



**APPLICATION FOR COMMINGLING OF PRODUCTION (K.A.R. 82-3-123) OR FLUIDS (K.A.R. 82-3-123a)** *Commingling ID # \_\_\_\_\_*

OPERATOR: License # \_\_\_\_\_ API No. 15 - \_\_\_\_\_  
Name: \_\_\_\_\_ Spot Description: \_\_\_\_\_  
Address 1: \_\_\_\_\_ Sec. \_\_\_\_\_ Twp. \_\_\_\_\_ S. R. \_\_\_\_\_  East  West  
Address 2: \_\_\_\_\_ Feet from  North /  South Line of Section  
City: \_\_\_\_\_ State: \_\_\_\_\_ Zip: \_\_\_\_\_ + \_\_\_\_\_ Feet from  East /  West Line of Section  
Contact Person: \_\_\_\_\_ County: \_\_\_\_\_  
Phone: ( \_\_\_\_\_ ) \_\_\_\_\_ Lease Name: \_\_\_\_\_ Well #: \_\_\_\_\_

1. Name and upper and lower limit of each production interval to be commingled:  
Formation: \_\_\_\_\_ (Perfs): \_\_\_\_\_  
Formation: \_\_\_\_\_ (Perfs): \_\_\_\_\_  
Formation: \_\_\_\_\_ (Perfs): \_\_\_\_\_  
Formation: \_\_\_\_\_ (Perfs): \_\_\_\_\_  
Formation: \_\_\_\_\_ (Perfs): \_\_\_\_\_

2. Estimated amount of fluid production to be commingled from each interval:  
Formation: \_\_\_\_\_ BOPD: \_\_\_\_\_ MCFPD: \_\_\_\_\_ BWPD: \_\_\_\_\_  
Formation: \_\_\_\_\_ BOPD: \_\_\_\_\_ MCFPD: \_\_\_\_\_ BWPD: \_\_\_\_\_  
Formation: \_\_\_\_\_ BOPD: \_\_\_\_\_ MCFPD: \_\_\_\_\_ BWPD: \_\_\_\_\_  
Formation: \_\_\_\_\_ BOPD: \_\_\_\_\_ MCFPD: \_\_\_\_\_ BWPD: \_\_\_\_\_  
Formation: \_\_\_\_\_ BOPD: \_\_\_\_\_ MCFPD: \_\_\_\_\_ BWPD: \_\_\_\_\_

3. Plat map showing the location of the subject well, all other wells on the subject lease, and all wells on offsetting leases within a 1/2 mile radius of the subject well, and for each well the names and addresses of the lessee of record or operator.

4. Signed certificate showing service of the application and affidavit of publication as required in K.A.R. 82-3-135a.

**For Commingling of PRODUCTION ONLY, include the following:**

- 5. Wireline log of subject well. Previously Filed with ACO-1:  Yes  No
- 6. Complete Form ACO-1 (*Well Completion form*) for the subject well.

**For Commingling of FLUIDS ONLY, include the following:**

- 7. Well construction diagram of subject well.
- 8. Any available water chemistry data demonstrating the compatibility of the fluids to be commingled.

**AFFIDAVIT:** I am the affiant and hereby certify that to the best of my current information, knowledge and personal belief, this request for commingling is true and proper and I have no information or knowledge, which is inconsistent with the information supplied in this application.

**Submitted Electronically**

**KCC Office Use Only**  
 Denied  Approved  
15-Day Periods Ends: \_\_\_\_\_  
Approved By: \_\_\_\_\_ Date: \_\_\_\_\_

*Protests may be filed by any party having a valid interest in the application. Protests must be in writing and comply with K.A.R. 82-3-135b and must be filed within 15 days of publication of the notice of application.*

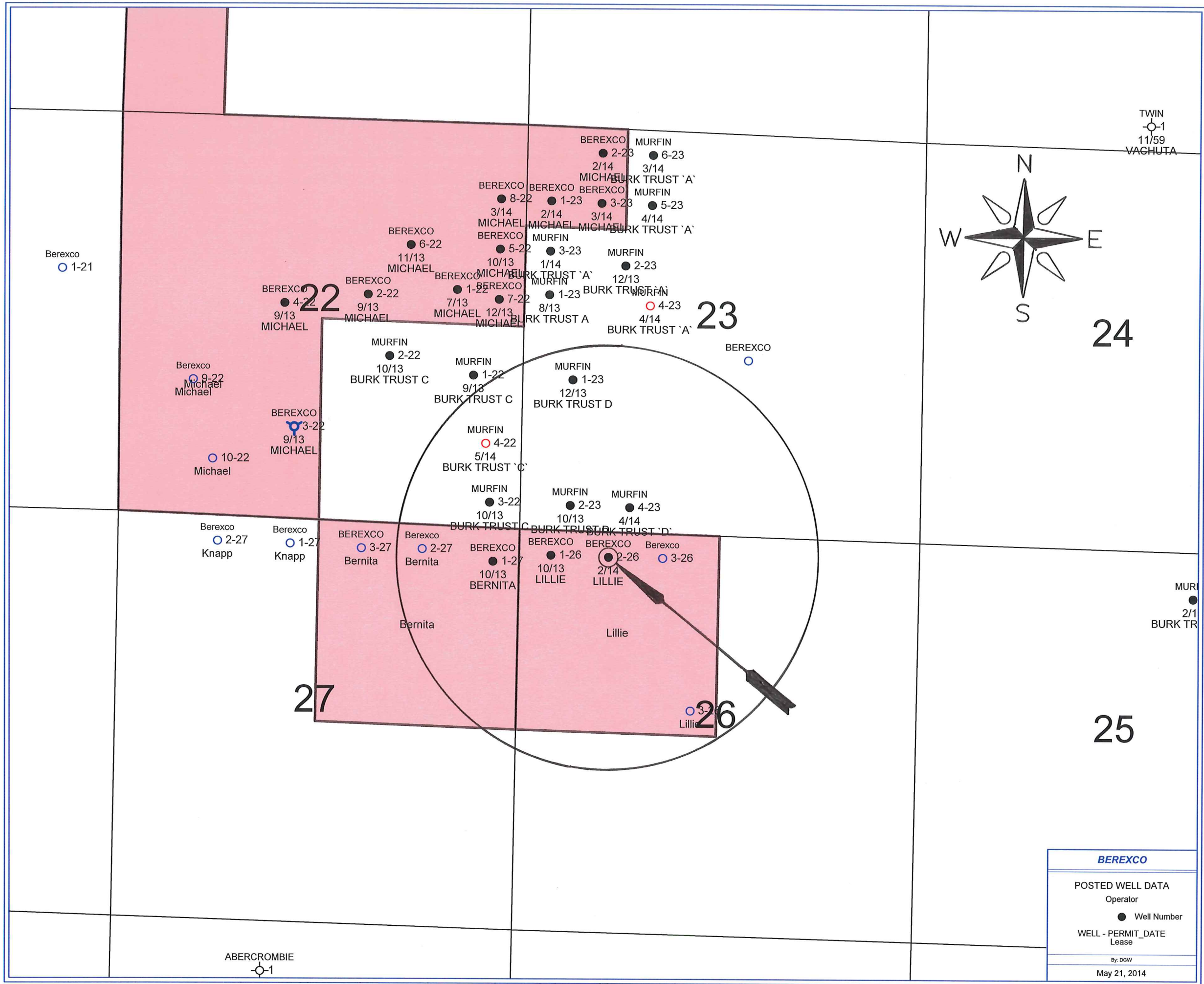

BEFORE THE STATE  
CORPORATION COMMISSION  
OF THE STATE OF KANSAS  
NOTICE OF FILING APPLICATION

Re: Berexco LLC Application for a permit to commingle production in the Lansing/KS City and Oread formations in the Lillie #2-26 well, located in Rawlins County, Kansas.

To: All Oil & Gas Producers, Unleased Mineral Interest Owners, Landowners, and all persons whosoever concerned.

You, and each of you are hereby notified that Berexco LLC has filed an application to commingle production from the Lansing/KS City and Oread formations in the Lillie #2-26 well located in the E/2 NE NW NW (330' FNL, 1175' FWL) of Sec 26-1S-36W, Rawlins County, KS.

Any persons who object to, or protest this application shall be required to file their objections or protests with the Oil & Gas Conservation Division of the Kansas Corporation Commission within fifteen (15) days from the date of this publication. These protests shall be filed pursuant to Commission regulations and must state specific reasons why the grant of the application may cause waste, violate correlative rights, or pollute the natural resources of the state of Kansas. All persons interested or concerned shall take notice of the foregoing and shall govern themselves accordingly.

Berexco LLC  
2020 N. Bramblewood  
Wichita, KS 67206-1094  
Phone: 316-265-3311

---

BEFORE THE STATE CORPORATION COMMISSION  
OF THE STATE OF KANSAS

IN THE MATTER OF THE APPLICATION OF )  
BEREXCO LLC FOR COMMINGLING OF )  
PRODUCTION OR FLUIDS IN THE LILLIE #2-26 )  
WELL LOCATED IN THE E/2 NE NW NW SECTION 26, )  
TOWNSHIP 1 SOUTH, RANGE 36 WEST, )  
RAWLINS COUNTY, KANSAS. )

AFFIDAVIT OF MAILING

STATE OF KANSAS )  
 ) ss.  
SEDGWICK COUNTY )

Richard R. Smith, of lawful age, being first duly sworn on oath states:

That he is an Engineering Technician for Applicant; that he served a copy of the attached Application by depositing same in the United States Mail, postage prepaid, on the 21 day of May, addressed to Murfin Drilling, the only other operator within a half-mile radius of the subject well, in accordance with K.A.R. 82-3-135a.

Richard R. Smith  
Richard R. Smith  
Engineering Technician  
Berexco LLC

SUBSCRIBED AND SWORN to before me this 22 day of May 2014.

Jennifer Warren  
Notary Public

My appointment expires: 10-03-2016

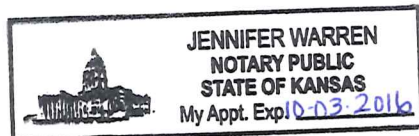

**AFFIDAVIT**

STATE OF KANSAS \
- SS.
County of Sedgwick /

Mark Fletchall, of lawful age, being first duly sworn, deposeth and saith: That he is Record Clerk of The Wichita Eagle, a daily newspaper published in the City of Wichita, County of Sedgwick, State of Kansas, and having a general paid circulation on a daily basis in said County, which said newspaper has been continuously and uninterruptedly published in said County for more than one year prior to the first publication of the notice hereinafter mentioned, and which said newspaper has been entered as second class mail matter at the United States Post Office in Wichita, Kansas, and which said newspaper is not a trade, religious or fraternal publication and that a notice of a true copy is hereto attached was published in the regular and entire Morning issue of said The Wichita Eagle for \_1\_ issues, that the first publication of said notice was

made as aforesaid on the 26<sup>th</sup> of

July A.D. 2014, with

subsequent publications being made on the following dates:

And affiant further says that he has personal knowledge of the statements above set forth and that they are true.

*Mark Fletchall*

Subscribed and sworn to before me this

28th day of July, 2014

JENNIFER RAE BAILEY
Notary Public, State of Kansas
My Appt. Expires 6/19/2017

*JRB*

Notary Public Sedgwick County, Kansas

Printer's Fee : \$139.20

LEGAL PUBLICATION
PUBLISHED IN THE WICHITA EAGLE
JULY 26, 2014 (3311045)
BEFORE THE STATE CORPORATION
COMMISSION OF THE STATE OF KANSAS
NOTICE OF FILING APPLICATION
Re: Berexco LLC Application for a permit
to commingle production in the Lansing/KS
City and Oread formations in the Lillie #2-26
well, located in Rawlins County, Kansas.
To: All Oil & Gas Producers, Unleased
Mineral Interest Owners, Landowners, and
all persons whosever concerned.
You, and each of you are hereby notified
that Berexco LLC has filed an application
to commingle production from the Lansing/
KS City and Oread formations in the Lillie
#2-26 well located in the E/2 NE NW NW
(330' FNL, 1175' FWL) of Sec 26-1S-36W,
Rawlins County, KS.
Any persons who object to, or protest
this application shall be required to file
their objections or protests with the Oil &
Gas Conservation Division of the Kansas
Corporation Commission within fifteen
(15) days from the date of this publication.
These protests shall be filed pursuant to
Commission regulations and must state
specific reasons why the grant of the
application may cause waste, violate
correlative rights, or pollute the natural
resources of the state of Kansas. All persons
interested or concerned shall take notice of
the foregoing and shall govern themselves
accordingly.
Berexco LLC
2020 N. Bramblewood
Wichita, KS 67206-1094
Phone: 316-265-3311



Affidavit of Publication  
STATE OF KANSAS, RAWLINS COUNTY, ss:

**Lloyd A. Huff,**

being first duly sworn, deposes and says:

He is

**PUBLISHER-OWNER**

of the Rawlins County Square Deal, a weekly Newspaper printed in the State of Kansas, and published in and of general circulation in Rawlins County, Kansas, and that said newspaper is not a trade, religious nor fraternal publication.

The newspaper is a weekly newspaper published at least weekly 50 times a year, has been so published continuously and uninterruptedly in the county and state for a period of more than one year prior to the first publication of the notice; and has been admitted at the post office of Atwood in Rawlins County as second-class matter.

The attached notice is a true copy thereof and was published in the regular and entire issue of said newspaper

for 1 consecutive weeks, the first publication

being made on the 29<sup>th</sup> day of May, 2014, with subsequent publications being made on the following dates:

\_\_\_\_\_, 2014

\_\_\_\_\_, 2014

\_\_\_\_\_, 2014

Lloyd A. Huff

Subscribed and sworn to before me this 30<sup>th</sup> day of

May, 2014.

Rosalie Russell Ross  
Notary Public

My appointment expires: 4-17-2015

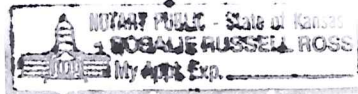

Printer's fee: \$. 43.35

(First published in The Rawlins County Square Deal, Thursday, May 29, 2014 - 1t.)

**BEFORE THE STATE CORPORATION COMMISSION OF THE STATE OF KANSAS NOTICE OF FILING APPLICATION**

Re: Berexco LLC Application for a permit to commingle production in the Lansing/KS City and Oread formations in the Lillie #2-26 well, located in Rawlins County, Kansas. To: All Oil & Gas Producers, Unleased Mineral Interest Owners, Landowners, and all persons whosesoever concerned.

You, and each of you are hereby notified that Berexco LLC has filed an application to commingle production from the Lansing/KS City and Oread formations in the Lillie #2-26 well located in the E/2 NE NW NW

(330' FNL, 1175' FWL) of Sec 26-1S-36W, Rawlins County, KS.

Any persons who object to, or protest this application shall be required to file their objections or protests with the Oil & Gas Conservation Division of the Kansas Corporation Commission within fifteen (15) days from the date of this publication. These protests shall be filed pursuant to Commission regulations and must state specific reasons why the grant of the application may cause waste, violate correlative rights, or pollute the natural resources of the state of Kansas. All persons interested or concerned shall take notice of the foregoing and shall govern themselves accordingly.

Berexco LLC  
2020 N. Bramblewood  
Wichita, KS 67206-1094  
Phone: 316-265-3311

# BEREXCO LLC

July 30, 2014

Kansas Corporation Commission  
Oil & Gas Conservation Division  
266 North Main, Ste 220  
Wichita, KS 67202-1513

RE: Lillie #2-26 Application for Commingling of Production  
E/2 NE NW NW Sec 26-1S-36W (330' FNL, 1175' FWL)  
Rawlins County, Kansas  
API # 15-153-20987-00-00

Gentlemen:

Enclosed please find our Application for Commingling of Production for the Lillie #2-26 well. Notice of this application has been provided to Murfin Drilling, the only other operator within the half-mile radius of the subject well in accordance with Kansas Corporation Commission Rules & Regulations - K.A.R. 82-3-135a (b), by first class mail, postpaid. If anything is lacking in our application, please advise me at your earliest convenience.  
Thank you for your attention to this matter.

Sincerely,



Richard R. Smith  
Engineering Technician  
(316) 337-8334  
(316) 265-2994 (fax)  
rsmith@berexco.com

Encls.:

- Application for Commingling of Production (form ACO-4)
- 1) ACO-1 Completion report (partial – filed w/KCC previously).
- 2) Plat Map of all wells within ½ mile radius of subject well with required information
- 3) Certificate of Service (mailed to Murfin Drilling with copy of ACO-4)
- 4) Affidavit of Mailing
- 5a) Affidavit of Publication – Wichita Eagle
- 5b) Affidavit of Publication –Rawlins County Square Deal

Conservation Division  
266 N. Main St., Ste. 220  
Wichita, KS 67202-1513



Phone: 316-337-6200  
Fax: 316-337-6211  
<http://kcc.ks.gov/>

Shari Feist Albrecht, Chair  
Jay Scott Emler, Commissioner  
Pat Apple, Commissioner

Sam Brownback, Governor

August 11, 2014

Rodney Reynolds  
BEREXCO LLC  
2020 N. Bramblewood  
Wichita, KS 67206-1094

RE: Approved Commingling CO071408  
Lillie 2-26, Sec. 26-T1S-R36W, Rawlins County  
API No. 15-153-20987-00-00

Dear Mr.Reynolds:

Your Application for Commingling (ACO-4) for the above described well has been reviewed and approved by the Kansas Corporation Commission (KCC) per K.A.R. 82-3-123. Notice was examined and found to be proper per K.A.R. 82-3-135a. No protest had been filed within the 15-day protest period.

Based upon the depth of the Lansing/KS City formation perforations, total oil production shall not exceed **200 BOPD** and total gas production shall not exceed 50% of the absolute open flow (AOF).

Sincerely,

Rick Hestermann  
Production Department