

Section 33
17S 25W

Section 34
17S 25W

Section 4
18S 25W

Section 3
18S 25W

Section 9
18S 25W

Section 10
18S 25W

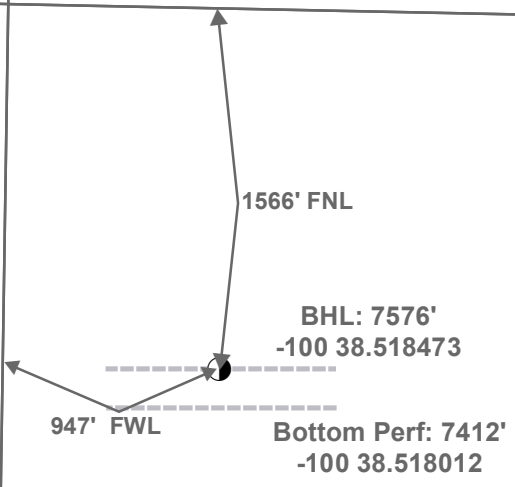

Top Perf: 5295'
-100 38.512202

Miss Entry: 4624'
-100 38.510423

SUTTON 1825 2-3H

SUTTON 1825 1-3H



Actual Bottom-Hole Location of Sutton 1825 1-3H
 Ness County, Kansas
 T&R: 18S 25W
 Section: 3, 947' FWL & 1566' FNL
 Long/Lat: -100 38.518473
 1 in = 833 ft



● Actual BH Location

* SandRidge Wells

--- Perf
□ Sections

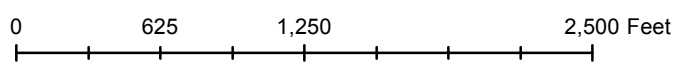

Draftsman: Aaron Birk	Draft Date: 10/26/2012
Drawing Name/Number: Addendum_Sutton_1-3H .mxd	
Coordinate System: NAD 1927 State Plane Kansas South FIPS: 1502	