



**APPLICATION FOR COMMINGLING OF PRODUCTION (K.A.R. 82-3-123) OR FLUIDS (K.A.R. 82-3-123a)** *Commingling ID # \_\_\_\_\_*

OPERATOR: License # \_\_\_\_\_ API No. 15 - \_\_\_\_\_  
Name: \_\_\_\_\_ Spot Description: \_\_\_\_\_  
Address 1: \_\_\_\_\_ - - - - - Sec. \_\_\_\_\_ Twp. \_\_\_\_\_ S. R. \_\_\_\_\_  East  West  
Address 2: \_\_\_\_\_ Feet from  North /  South Line of Section  
City: \_\_\_\_\_ State: \_\_\_\_\_ Zip: \_\_\_\_\_ + \_\_\_\_\_ Feet from  East /  West Line of Section  
Contact Person: \_\_\_\_\_ County: \_\_\_\_\_  
Phone: ( \_\_\_\_\_ ) \_\_\_\_\_ Lease Name: \_\_\_\_\_ Well #: \_\_\_\_\_

1. Name and upper and lower limit of each production interval to be commingled:  
Formation: \_\_\_\_\_ (Perfs): \_\_\_\_\_  
Formation: \_\_\_\_\_ (Perfs): \_\_\_\_\_  
Formation: \_\_\_\_\_ (Perfs): \_\_\_\_\_  
Formation: \_\_\_\_\_ (Perfs): \_\_\_\_\_  
Formation: \_\_\_\_\_ (Perfs): \_\_\_\_\_

2. Estimated amount of fluid production to be commingled from each interval:  
Formation: \_\_\_\_\_ BOPD: \_\_\_\_\_ MCFPD: \_\_\_\_\_ BWPD: \_\_\_\_\_  
Formation: \_\_\_\_\_ BOPD: \_\_\_\_\_ MCFPD: \_\_\_\_\_ BWPD: \_\_\_\_\_  
Formation: \_\_\_\_\_ BOPD: \_\_\_\_\_ MCFPD: \_\_\_\_\_ BWPD: \_\_\_\_\_  
Formation: \_\_\_\_\_ BOPD: \_\_\_\_\_ MCFPD: \_\_\_\_\_ BWPD: \_\_\_\_\_  
Formation: \_\_\_\_\_ BOPD: \_\_\_\_\_ MCFPD: \_\_\_\_\_ BWPD: \_\_\_\_\_

3. Plat map showing the location of the subject well, all other wells on the subject lease, and all wells on offsetting leases within a 1/2 mile radius of the subject well, and for each well the names and addresses of the lessee of record or operator.

4. Signed certificate showing service of the application and affidavit of publication as required in K.A.R. 82-3-135a.

**For Commingling of PRODUCTION ONLY, include the following:**

- 5. Wireline log of subject well. Previously Filed with ACO-1:  Yes  No
- 6. Complete Form ACO-1 (*Well Completion form*) for the subject well.

**For Commingling of FLUIDS ONLY, include the following:**

- 7. Well construction diagram of subject well.
- 8. Any available water chemistry data demonstrating the compatibility of the fluids to be commingled.

**AFFIDAVIT:** I am the affiant and hereby certify that to the best of my current information, knowledge and personal belief, this request for commingling is true and proper and I have no information or knowledge, which is inconsistent with the information supplied in this application.

**Submitted Electronically**

**KCC Office Use Only**  
 Denied  Approved  
15-Day Periods Ends: \_\_\_\_\_  
Approved By: \_\_\_\_\_ Date: \_\_\_\_\_

*Protests may be filed by any party having a valid interest in the application. Protests must be in writing and comply with K.A.R. 82-3-135b and must be filed within 15 days of publication of the notice of application.*

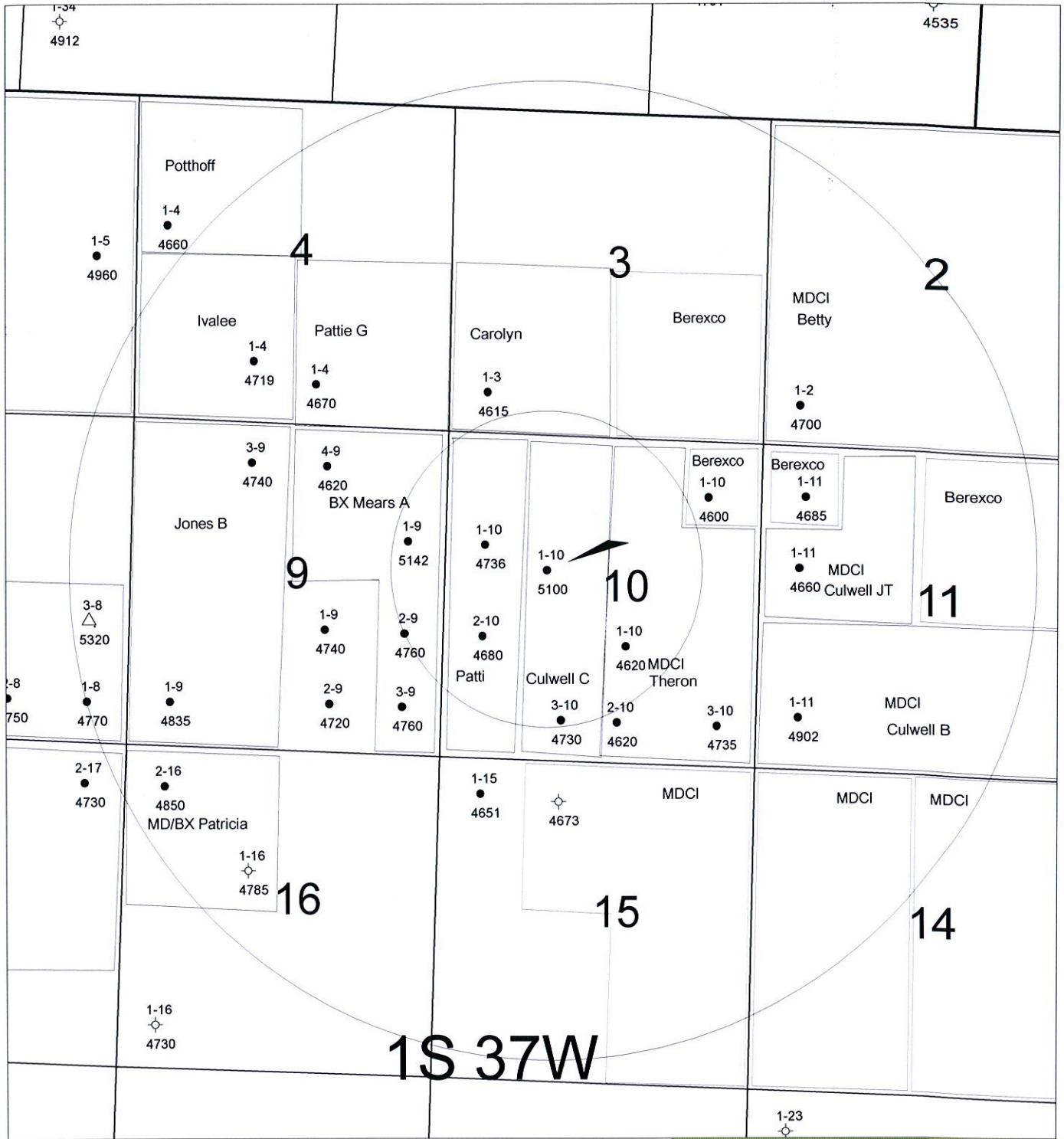



**Commingling Application**  
**Culwell C #1-10**  
**Sec. 10-1S-37W, Cheyenne Co., KS**

Author: \_\_\_\_\_ Horizontal Scale: \_\_\_\_\_  
 Date: 20 February, 2015 Contour Interval: \_\_\_\_\_

**Affidavit of Notice Served**

Re: Application for: Commingling of Production  
Well Name: Culwell C #1-10 Legal Location: NE SW SE NW Sec. 10-1S-37W

The undersigned hereby certifies that he / she is a duly authorized agent for the applicant, and that on the day 23rd of February, 2015, a true and correct copy of the application referenced above was delivered or mailed to the following parties:

Note: A copy of this affidavit must be served as a part of the application.

Name

Address (Attach additional sheets if necessary)

I further attest that notice of the filing of this application was published in the The Saint Francis Herald, the official county publication of Cheyenne county. A copy of the affidavit of this publication is attached.

Signed this 23rd day of February, 2015

Applicant of Duty Authorized Agent

Subscribed and sworn to before me this 23rd day of February, 2015

Notary Public

My Commission Expires: 4.8.15

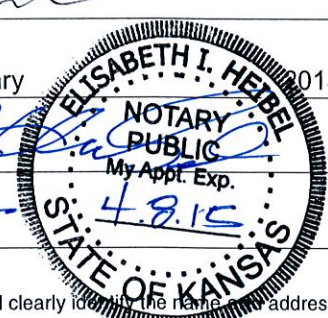

Protests may be filed by any party having a valid interest in the application. Petitions for protests shall be in writing and shall clearly identify the name and address of the protestant and the title of the application. The petition shall include a clear and concise statement of the direct and substantial interest of the protestant in the proceedings, including the manner in which the protestant may be affected, and the nature, extent, character and grounds of the protest. Protestants shall serve the protest upon the applicant by mail or personal service at the same time or before the protestant files the protest with the Conservation Division. Protests must be filed within 15 days of the publication notice of the application.

**Offset Operators, Unleased Mineral Owners and Landowners acreage**

(Attach additional sheets if necessary)

Name:

Legal Description of Leasehold:

Murfin Drilling Co., Inc.

SW/4 Sec. 3; Sec 10 Except NE/4 NE/4 in T1S- R37W

250 N. Water, Suite 300

Wichita, KS 67202

Berexco LLC

SE/4 Sec. 3, E/2 Sec. 9, NE/4 NE/4 Sec. 10-1S-37W

2020 N Bramblewood

Wichita, KS 67206

James & Carolyn Culwell

Landowner

1790 Rd B

St Francis, KS 67756

I hereby certify that the statements made herein are true and correct to the best of my knowledge and belief.

Applicant or Duly Authorized Agent

Subscribed and sworn before me this 23rd day of February 2015

Notary Public

My Commission Expires: 4.8.15

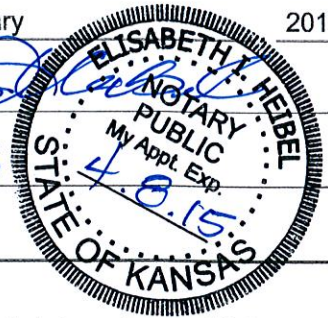

**Instructions:**

1. Fully complete application, including page 4 (*plat map*) showing subject well and all known oil, gas and input wells, including wells being drilled, inactive wells, or dry holes, within one-half mile. Show lease names and operators or unleased mineral rights owners of all lands within one-half mile. Show well numbers and elevations of producing formation tops.
2. Attach some type of log (*drillers log, electric log, etc.*).
3. Attach some type of verification of cementing for surface casing, longstring, D.V. tool, perforations, etc. (*Cement ticket and job log, bond log, etc.*)
4. Attach Affidavit of Notice.
5. Fill in schematic drawing of subsurface facilities including: size, setting depth, amount of cement, measured or calculated tops of cement for each of surface, intermediate (*if any*) and production casing; size and setting depth of tubing and packer; geological zone of injection showing top and bottom of injection interval.
6. The original and one copy of the application and all attachments shall be mailed to the State Corporation Commission, Conservation Division.
7. Deliver or mail one (*1*) copy of the application to the landowner on whose land the injection well is located and to each operator or lessee of record and each unleased mineral rights owner within one-half mile of the applicant well.
8. Approval of this application, if granted, is valid only as long as there are no substantial changes in operation set forth in the application. A substantial change requires the approval of a new application. **No injection well may be used without prior written authorization.**

AFFIDAVIT OF PUBLICATION  
STATE OF KANSAS, CHEYENNE COUNTY, ss:

Cynthia Haynes

Being first duly sworn, Deposes and says: That

She

is the

Chief Financial Officer

of The Saint Francis Herald, a Weekly Newspaper printed in the State of Kansas, and published in and of general circulation in Cheyenne County, Kansas, with a general paid circulation on a weekly basis in Cheyenne County, Kansas, and that said newspaper is not a trade, religious or fraternal publication.

Said newspaper is a Weekly published at least weekly 50 times a year; has been so published continuously and uninterruptedly in said county and state for a period of more than five years prior to the first publication of said notice; and has been admitted at the post office of St. Francis in said County as second class matter.

That the attached notice is a true copy thereof and was published in the regular and entire issue of said newspaper

for .....consecutive weeks, the first publication thereof

being made as aforesaid on the 16<sup>th</sup> day of Oct,

2014, with subsequent publications being made on the

following dates:

\_\_\_\_\_, 20\_\_\_\_, \_\_\_\_\_, 20\_\_\_\_

\_\_\_\_\_, 20\_\_\_\_, \_\_\_\_\_, 20\_\_\_\_

\_\_\_\_\_, 20\_\_\_\_, \_\_\_\_\_, 20\_\_\_\_

*Cynthia Haynes*

Subscribed and sworn to before me this 16<sup>th</sup> day of

October, 2014.

*Karen Krien*  
Notary Public

My commission expires: 11/23/14

Printer's fee \$ 97.92

Additional copies \$ \_\_\_\_\_



Published in The Saint Francis Herald, St. Francis, Kansas, Thursday, October 16, 2014. (42)

BEFORE THE STATE  
CORPORATION COMMISSION  
OF THE STATE OF KANSAS

NOTICE OF FILING APPLICATION

RE: Murfin Drilling Co., Inc.- Application for Commingling of Production on the Culwell C #1-10, located in Cheyenne County, Kansas.

TO: All Oil and Gas Producers, Unleased Mineral Interest Owners, Landowners, and all persons whomever concerned.

You, and each of you, are hereby notified that Murfin Drilling Company, Inc. has filed an application for Commingling of Production from the LKC and the Pawnee at the Culwell C #1-10 well located in the NE SW SE NW of Sec. 10-1S-37W, Cheyenne Co., KS

Any persons who object to or protest this application shall be required to file their objections or protest with the Conservation Division of the State Corporation Commission of the State of Kansas within fifteen (15) days from the date of this publication. These protests shall be pursuant to Commission regulations and must state specific reasons why the grant of the application may cause waste, violate correlative rights or pollute the natural resources of the State of Kansas.

All persons interested or concerned shall take notice of the foregoing and shall govern themselves accordingly.

Murfin Drilling Company, Inc.  
250 N. Water, Suite 300  
Wichita, KS 67202  
316-267-3241

**AFFIDAVIT**

STATE OF KANSAS \
- SS.
County of Sedgwick /

Mark Fletchall, of lawful age, being first duly sworn, deposeth and saith: That he is Record Clerk of The Wichita Eagle, a daily newspaper published in the City of Wichita, County of Sedgwick, State of Kansas, and having a general paid circulation on a daily basis in said County, which said newspaper has been continuously and uninterruptedly published in said County for more than one year prior to the first publication of the notice hereinafter mentioned, and which said newspaper has been entered as second class mail matter at the United States Post Office in Wichita, Kansas, and which said newspaper is not a trade, religious or fraternal publication and that a notice of a true copy is hereto attached was published in the regular and entire Morning issue of said The Wichita Eagle for  1  issues, that the first publication of said notice was

made as aforesaid on the 13th of

October A.D. 2014, with

subsequent publications being made on the following dates:

And affiant further says that he has personal knowledge of the statements above set forth and that they are true.

*Mark Fletchall*

Subscribed and sworn to before me this

13th October, 2014



*JRB*

Notary Public Sedgwick County, Kansas

Printer's Fee : \$135.80

**LEGAL PUBLICATION**

Published in The Wichita Eagle
October 13, 2014 (3322240)

BEFORE THE STATE CORPORATION
COMMISSION OF THE STATE OF KANSAS
NOTICE OF FILING APPLICATION

RE: Murfin Drilling Co., Inc. - Application for
Commingleing of Production on the Culwell C
#1-10, located in Cheyenne County, Kansas.
TO: All Oil and Gas Producers, Unleased Mineral
Interest Owners, Landowners, and all persons
whomever concerned.

You, and each of you, are hereby notified that
Murfin Drilling Company, Inc. has filed an application
for Commingleing of Production from the LKC and the
Pawnee at the Culwell C #1-10 well located in the NE
SW SE NW of Sec. 10-1S-37W, Cheyenne Co., KS.

Any persons who object to or protest this
application shall be required to file their objections
or protest with the Conservation Division of the State
Corporation Commission of the State of Kansas within
fifteen (15) days from the date of this publication.
These protests shall be pursuant to Commission
regulations and must state specific reasons why the
grant of the application may cause waste, violate
correlative rights or pollute the natural resources of
the State of Kansas.

All persons interested or concerned shall take
notice of the foregoing and shall govern themselves
accordingly.

Murfin Drilling Company, Inc.
250 N. Water, Suite 300
Wichita, KS 67202
316-267-3241



Confidentiality Requested:

Yes  No

KANSAS CORPORATION COMMISSION 1158986  
OIL & GAS CONSERVATION DIVISION

Form ACO-1

August 2013

Form must be Typed

Form must be Signed

All blanks must be Filled

# CONFIDENTIAL WELL COMPLETION FORM

## WELL HISTORY - DESCRIPTION OF WELL & LEASE

OPERATOR: License # 30606

Name: Murfin Drilling Co., Inc.

Address 1: 250 N WATER STE 300

Address 2: \_\_\_\_\_

City: WICHITA State: KS Zip: 67202 + 1216

Contact Person: Leon Rodak

Phone: ( 316 ) 267-3241

CONTRACTOR: License # 30606

Name: Murfin Drilling Co., Inc.

Wellsite Geologist: Jeff Christian

Purchaser: MV Purchasing, LLC

Designate Type of Completion:

- New Well     Re-Entry     Workover
- Oil     WSW     SWD     SLOW
- Gas     D&A     ENHR     SIGW
- OG     GSW     Temp. Abd.
- CM (Coal Bed Methane)
- Cathodic     Other (Core, Expl., etc.): \_\_\_\_\_

If Workover/Re-entry: Old Well Info as follows:

Operator: \_\_\_\_\_

Well Name: \_\_\_\_\_

Original Comp. Date: \_\_\_\_\_ Original Total Depth: \_\_\_\_\_

- Deepening     Re-perf.     Conv. to ENHR     Conv. to SWD
- Plug Back     Conv. to GSW     Conv. to Producer
- Commingled    Permit #: \_\_\_\_\_
- Dual Completion    Permit #: \_\_\_\_\_
- SWD    Permit #: \_\_\_\_\_
- ENHR    Permit #: \_\_\_\_\_
- GSW    Permit #: \_\_\_\_\_

<u>05/24/2013</u>	<u>06/03/2013</u>	<u>07/17/2013</u>
Spud Date or Recompletion Date	Date Reached TD	Completion Date or Recompletion Date

API No. 15 - 15-023-21367-00-00

Spot Description: \_\_\_\_\_

NE SW SE NW Sec. 10 Twp. 1 S. R. 37  East  West

2190 Feet from  North /  South Line of Section

1680 Feet from  East /  West Line of Section

Footages Calculated from Nearest Outside Section Corner:

NE  NW  SE  SW

GPS Location: Lat: \_\_\_\_\_, Long: \_\_\_\_\_  
(e.g. xx.xxxxx) (e.g. -xxx.xxxxx)

Datum:  NAD27  NAD83  WGS84

County: Cheyenne

Lease Name: Culwell 'C' Well #: 1-10

Field Name: Jones Canyon SE

Producing Formation: LKC and Pawnee

Elevation: Ground: 3140 Kelly Bushing: 3150

Total Vertical Depth: 4650 Plug Back Total Depth: 4611

Amount of Surface Pipe Set and Cemented at: 208 Feet

Multiple Stage Cementing Collar Used?  Yes  No

If yes, show depth set: \_\_\_\_\_ Feet

If Alternate II completion, cement circulated from: \_\_\_\_\_

feet depth to: \_\_\_\_\_ w/ \_\_\_\_\_ sx cmt.

### Drilling Fluid Management Plan

*(Data must be collected from the Reserve Pit)*

Chloride content: 800 ppm Fluid volume: 1200 bbls

Dewatering method used: Evaporated

Location of fluid disposal if hauled offsite: \_\_\_\_\_

Operator Name: \_\_\_\_\_

Lease Name: \_\_\_\_\_ License #: \_\_\_\_\_

Quarter \_\_\_\_\_ Sec. \_\_\_\_\_ Twp. \_\_\_\_\_ S. R. \_\_\_\_\_  East  West

County: \_\_\_\_\_ Permit #: \_\_\_\_\_

### AFFIDAVIT

I am the affiant and I hereby certify that all requirements of the statutes, rules and regulations promulgated to regulate the oil and gas industry have been fully complied with and the statements herein are complete and correct to the best of my knowledge.

Submitted Electronically

### KCC Office Use ONLY

Confidentiality Requested

Date: 09/20/2013

Confidential Release Date: \_\_\_\_\_

Wireline Log Received

Geologist Report Received

UIC Distribution

ALT  I  II  III Approved by: NAOMI JAMES Date: 09/25/2013



1158986

Operator Name: Murfin Drilling Co., Inc. Lease Name: Culwell 'C' Well #: 1-10  
 Sec. 10 Twp. 1 S. R. 37  East  West County: Cheyenne

**INSTRUCTIONS:** Show important tops of formations penetrated. Detail all cores. Report all final copies of drill stems tests giving interval tested, time tool open and closed, flowing and shut-in pressures, whether shut-in pressure reached static level, hydrostatic pressures, bottom hole temperature, fluid recovery, and flow rates if gas to surface test, along with final chart(s). Attach extra sheet if more space is needed.

Final Radioactivity Log, Final Logs run to obtain Geophysical Data and Final Electric Logs must be emailed to kcc-well-logs@kcc.ks.gov. Digital electronic log files must be submitted in LAS version 2.0 or newer AND an image file (TIFF or PDF).

Drill Stem Tests Taken <input checked="" type="checkbox"/> Yes <input type="checkbox"/> No <i>(Attach Additional Sheets)</i>  Samples Sent to Geological Survey <input checked="" type="checkbox"/> Yes <input type="checkbox"/> No  Cores Taken <input type="checkbox"/> Yes <input checked="" type="checkbox"/> No Electric Log Run <input checked="" type="checkbox"/> Yes <input type="checkbox"/> No  List All E. Logs Run:  Dual Induction Dual Compensated Microresistivity	<input type="checkbox"/> Log Formation (Top), Depth and Datum <input type="checkbox"/> Sample  Name See Attachment Top Datum
--	--

CASING RECORD <input checked="" type="checkbox"/> New <input type="checkbox"/> Used							
Report all strings set-conductor, surface, intermediate, production, etc.							
Purpose of String	Size Hole Drilled	Size Casing Set (In O.D.)	Weight Lbs. / Ft.	Setting Depth	Type of Cement	# Sacks Used	Type and Percent Additives
Surface	12.2500	8.6250	23	220	Common	190	3% cc
Production	7.8750	5.5000	15.5	4641	EA2	450	

ADDITIONAL CEMENTING / SQUEEZE RECORD				
Purpose:	Depth Top Bottom	Type of Cement	# Sacks Used	Type and Percent Additives
<input type="checkbox"/> Perforate				
<input type="checkbox"/> Protect Casing	-			
<input type="checkbox"/> Plug Back TD				
<input type="checkbox"/> Plug Off Zone	-			

Did you perform a hydraulic fracturing treatment on this well?  Yes  No *(If No, skip questions 2 and 3)*  
 Does the volume of the total base fluid of the hydraulic fracturing treatment exceed 350,000 gallons?  Yes  No *(If No, skip question 3)*  
 Was the hydraulic fracturing treatment information submitted to the chemical disclosure registry?  Yes  No *(If No, fill out Page Three of the ACO-1)*

Shots Per Foot	PERFORATION RECORD - Bridge Plugs Set/Type Specify Footage of Each Interval Perforated	Acid, Fracture, Shot, Cement Squeeze Record <i>(Amount and Kind of Material Used)</i>	Depth
4	4153 - 4158 LKC D	250 gal 15% MCA	
4	4202 - 4208 LKC G	250 gal 15% MCA	
4	4480 - 4487 Pawnee	300 gal 20% MCA, 1000 gal 15% NEFE	

TUBING RECORD: Size: <u>2 3/8</u> Set At: <u>4171</u> Packer At: <u>NA</u>		Liner Run: <input type="checkbox"/> Yes <input checked="" type="checkbox"/> No
Date of First, Resumed Production, SWD or ENHR. <u>07/22/2013</u>		Producing Method: <input type="checkbox"/> Flowing <input checked="" type="checkbox"/> Pumping <input type="checkbox"/> Gas Lift <input type="checkbox"/> Other <i>(Explain)</i> _____
Estimated Production Per 24 Hours	Oil Bbls. <u>9</u>	Gas Mcf <u>114</u> Water Bbls. <u>114</u> Gas-Oil Ratio <u>36</u> Gravity <u>36</u>

DISPOSITION OF GAS: <input type="checkbox"/> Vented <input type="checkbox"/> Sold <input type="checkbox"/> Used on Lease <i>(If vented, Submit ACO-18.)</i>	METHOD OF COMPLETION: <input type="checkbox"/> Open Hole <input checked="" type="checkbox"/> Perf. <input type="checkbox"/> Dually Comp. <input type="checkbox"/> Commingled <i>(Submit ACO-5)</i> <input type="checkbox"/> Other <i>(Specify)</i> _____	PRODUCTION INTERVAL: <u>4153 - 4487</u>
---	--	--



Conservation Division  
266 N. Main St., Ste. 220  
Wichita, KS 67202-1513



Phone: 316-337-6200  
Fax: 316-337-6211  
<http://kcc.ks.gov/>

Shari Feist Albrecht, Chair  
Jay Scott Emler, Commissioner  
Pat Apple, Commissioner

Sam Brownback, Governor

March 10, 2015

Kenneth Dean  
Murfin Drilling Co., Inc.  
250 N Water, Ste 300  
Wichita, KS 67202-1216

RE: Approved Commingling CO021507  
Culwell 'C' 1-10  
API No. 15-023-21367-00-00

Dear Mr. Dean:

Your Application for Commingling (ACO-4) for the above described well has been reviewed and approved by the Kansas Corporation Commission (KCC) per K.A.R. 82-3-123. Notice was examined and found to be proper per K.A.R. 82-3-135a. No protest had been filed within the 15-day protest period.

Based upon the depth of the Pawnee formation perforations, total oil production shall not exceed 200 BOPD and total gas production shall not exceed 50% of the absolute open flow (AOF).

Sincerely,

Rick Hestermann  
Production Department