



APPLICATION FOR COMMINGLING OF PRODUCTION (K.A.R. 82-3-123) OR FLUIDS (K.A.R. 82-3-123a) *Commingling ID # _____*

OPERATOR: License # _____ API No. 15 - _____
Name: _____ Spot Description: _____
Address 1: _____ - - - - - Sec. _____ Twp. _____ S. R. _____ East West
Address 2: _____ Feet from North / South Line of Section
City: _____ State: _____ Zip: _____ + _____ Feet from East / West Line of Section
Contact Person: _____ County: _____
Phone: (_____) _____ Lease Name: _____ Well #: _____

1. Name and upper and lower limit of each production interval to be commingled:
Formation: _____ (Perfs): _____
Formation: _____ (Perfs): _____
Formation: _____ (Perfs): _____
Formation: _____ (Perfs): _____
Formation: _____ (Perfs): _____

2. Estimated amount of fluid production to be commingled from each interval:
Formation: _____ BOPD: _____ MCFPD: _____ BWPD: _____
Formation: _____ BOPD: _____ MCFPD: _____ BWPD: _____
Formation: _____ BOPD: _____ MCFPD: _____ BWPD: _____
Formation: _____ BOPD: _____ MCFPD: _____ BWPD: _____
Formation: _____ BOPD: _____ MCFPD: _____ BWPD: _____

3. Plat map showing the location of the subject well, all other wells on the subject lease, and all wells on offsetting leases within a 1/2 mile radius of the subject well, and for each well the names and addresses of the lessee of record or operator.

4. Signed certificate showing service of the application and affidavit of publication as required in K.A.R. 82-3-135a.

For Commingling of PRODUCTION ONLY, include the following:

- 5. Wireline log of subject well. Previously Filed with ACO-1: Yes No
- 6. Complete Form ACO-1 (*Well Completion form*) for the subject well.

For Commingling of FLUIDS ONLY, include the following:

- 7. Well construction diagram of subject well.
- 8. Any available water chemistry data demonstrating the compatibility of the fluids to be commingled.

AFFIDAVIT: I am the affiant and hereby certify that to the best of my current information, knowledge and personal belief, this request for commingling is true and proper and I have no information or knowledge, which is inconsistent with the information supplied in this application.

Submitted Electronically

KCC Office Use Only
 Denied Approved
15-Day Periods Ends: _____
Approved By: _____ Date: _____

Protests may be filed by any party having a valid interest in the application. Protests must be in writing and comply with K.A.R. 82-3-135b and must be filed within 15 days of publication of the notice of application.

R 22 W

T
26
S

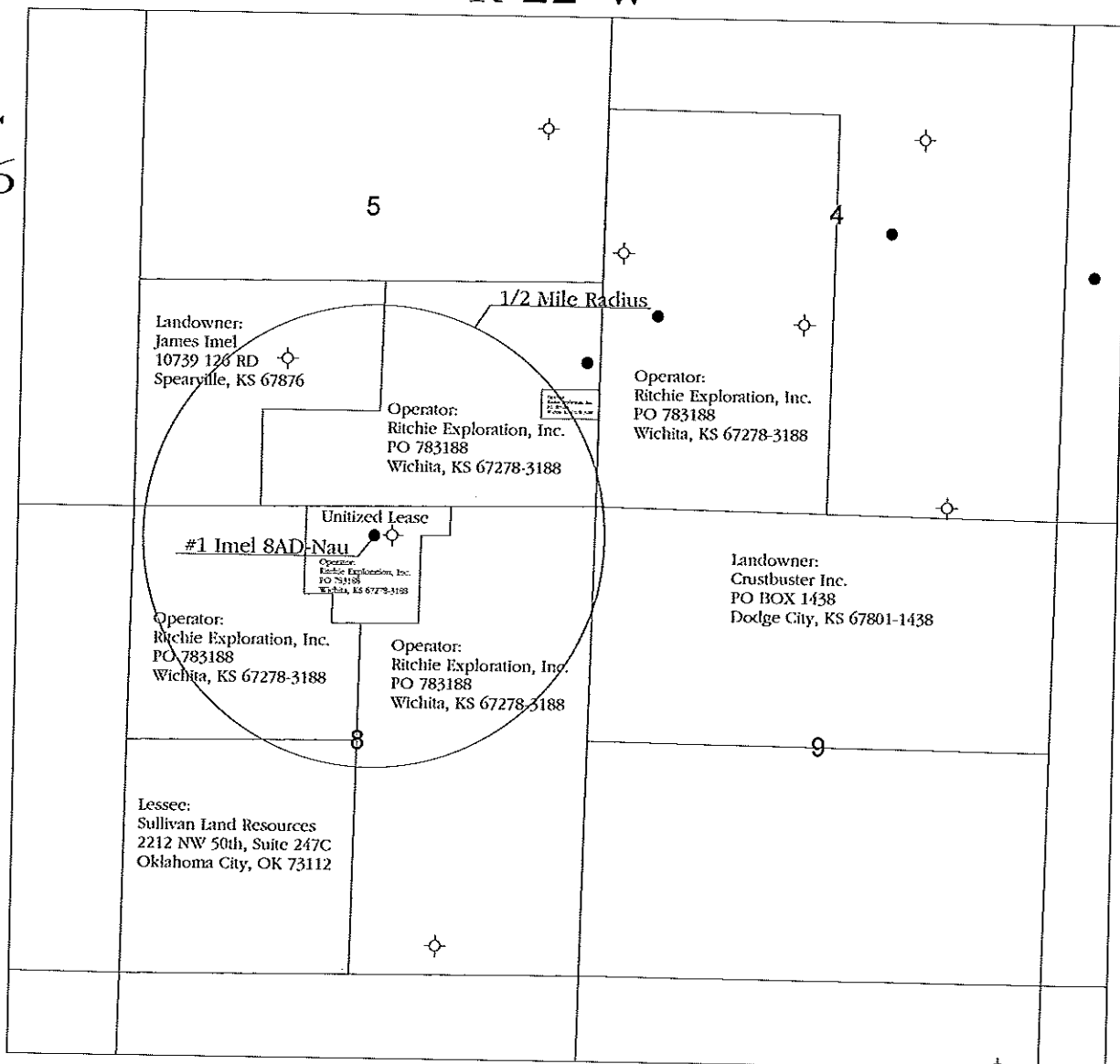

Legend

- Oil Well
- ⊕ Dry and Abandoned Well



RITCHIE
EXPLORATION, INC.
Wichita, Kansas

**Application for
Commingling of
Production or Fluids**

Applicant Well: #1 Imel 8AD-Nau
All Wells on Offsetting Leases within 1/2 Mile Radius
Name and Address of Lessee of Record or Operator on
Offsetting Leases

Ford County, Kansas		
Prepared By: Justin Clegg	Scale: 1 : 24,000	Date: 1/29/2015

APPLICATION FOR COMMINGLING OF PRODUCTION OR FLUIDS

**Operator, Lessee or Unleased Mineral Owner
within a ½ mile radius of Ritchie Exploration, Inc.'s**

**#1 Imel 8AD-Nau
335' FNL & 2510' FEL
Section 8-26S-22W
Ford Co., KS**

Township 26 South, Range 22 West

Sec. 4:	S. 280 ac. of W/2	Ritchie Exploration, Inc. PO Box 783188 Wichita, KS 67278-3188	Operator: #1 Nau 4BC, #1 Imel-Nau
Sec. 5:	SESW; SE, Ex. N/2NESESE	Ritchie Exploration, Inc.	Operator: #1 Imel-Nau
	N/2NESESE	Ritchie Exploration, Inc.	Operator: #1 Imel-Nau, #1 Imel 8AD-Nau
	N/2SW, SWSW	James Imel 10739 126 RD Spearville, KS 67876	Landowner
Sec. 8:	NW/4	Ritchie Exploration, Inc.	Operator: #1 Imel-Nau, #1 Imel 8AD-Nau
	SW/4	Sullivan Land Resources, Inc. 2212 NW 50 th St., Suite 247C Oklahoma City, OK 73112	Lessee
	E/2	Ritchie Exploration, Inc.	Operator: #1 Imel 8AD-Nau
Sec. 9:	N/2	Crustbuster Inc. PO Box 1438 Dodge City, KS 67801-1438	Landowner

AFFIDAVIT

STATE OF KANSAS)
 - SS.
County of Sedgwick)

John Niernberger, of lawful age, being first duly sworn, deposeth and saith: That he is Production Manager of Ritchie Exploration, County of Sedgwick, State of Kansas, and that notice was given to all lessee of record or operator within ½ mile radius of the Imel 8AD-Nau #1 well located in the County of Ford (see attached plat map). This notice included a letter and a copy of the Commingle Application (ACO-4). All notices were mailed on February 11, 2015.

made as aforesaid on the 11th of
February A.D. 2015

And affiant further says that he has personal knowledge of the statements above set forth and that they are true.

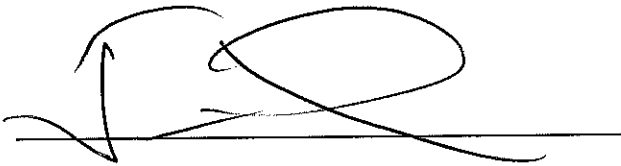

Subscribed and sworn to before me this

11th day of February 2015

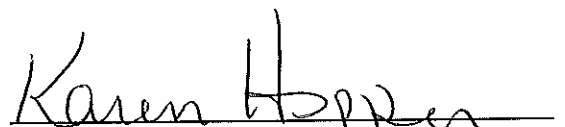

Notary Public Sedgwick County, Kansas

AFFIDAVIT

STATE OF KANSAS \
 - SS.
County of Sedgwick /

Mark Fletchall, of lawful age, being first duly sworn, deposeth and saith: That he is Record Clerk of The Wichita Eagle, a daily newspaper published in the City of Wichita, County of Sedgwick, State of Kansas, and having a general paid circulation on a daily basis in said County, which said newspaper has been continuously and uninterruptedly published in said County for more than one year prior to the first publication of the notice hereinafter mentioned, and which said newspaper has been entered as second class mail matter at the United States Post Office in Wichita, Kansas, and which said newspaper is not a trade, religious or fraternal publication and that a notice of a true copy is hereto attached was published in the regular and entire Morning issue of said The Wichita Eagle for 1 issues, that the first publication of said notice was

made as aforesaid on the 19th of

February A.D. 2015, with

subsequent publications being made on the following dates:

And affiant further says that he has personal knowledge of the statements above set forth and that they are true.

Mark Fletchall

Subscribed and sworn to before me this

19th day of February, 2015



Rachel M. Wilson

Notary Public Sedgwick County, Kansas

Printers Fee: \$122.20

LEGAL PUBLICATION

PUBLISHED IN THE WICHITA EAGLE
FEBRUARY 19, 2015 (3338097)

LEGAL NOTICE

You, and each of you, are hereby notified that Ritchie Exploration, Inc. has filed an application to commence the commingling of production from the Cherokee, Atoka, and Huck sources of supply for the #1 Inel 8AD-Hau well located approx. SW NW NW NE of Section 8-26S-22W, Ford County, Kansas. Any persons who object to or protest this application shall be required to file their objections or protests with the Conservation Division of the State Corporation Commission of the State of Kansas within fifteen (15) days from the date of the publication. These protests shall be filed pursuant to Commission regulations and must state specific reasons why the grant of the application may cause waste, violate correlative rights or pollute the natural resources of the state of Kansas. If no protests are received, this application may be granted through a summary proceeding. If valid protests are received, this matter will be set for hearing. All persons interested or concerned shall take notice of the foregoing and shall govern themselves accordingly.

RITCHIE EXPLORATION, INC.
P.O. Box 783188
Wichita, KS 67278-3188
(316) 691-9500

Proof of Publication
State of Kansas, Ford County, SS.

Dodge City Daily Globe

Ritchie Exploration, Inc.
PO Box 783188
Wichita, KS 67278

Reference: 83655 Account: 114170
Case No. # Imel 8AD- Nau Well

Ed O'Neal of lawful age, being duly sworn upon oath, states that he is the Circulation Manager of the DODGE CITY DAILY GLOBE.

THAT said newspaper has been published at least weekly fifty (50) times a year and has been so published for at least five years prior to the first publication of the attached notice;

THAT said paper was entered as second-class mail matter at the post office of its publication;

THAT said paper has a general paid circulation on a daily, or weekly, or yearly basis in FORD COUNTY KANSAS, and is NOT a trade, religious or fraternal publication and has been PRINTED and published in FORD COUNTY, KANSAS.

THE ATTACHED was published on the following dates in a regular issue of said paper:

(Sign) *Ed O'Neal*

PUBLISHED ON: 02/19/15
TOTAL COST: \$ 39.00
FILED ON: 02/19/15
AD SPACE: 6.5 inches

Witness my hand this 19 day of Feb, 2015.

SUBSCRIBED and Sworn to Before Me This 19 day of Feb, 2015.

Kathy Runquist
Notary Public, Ford County, Kansas

 KATHY RUNQUIST
Notary Public - State of Kansas
My Appt. Expires 11/23/16

(First Published in the Dodge City Daily Globe on Thursday, February 19, 2015)
LEGAL NOTICE

You, and each of you, are hereby notified that Ritchie Exploration, Inc. has filed an application to commence the commingling of production from the Cherokee, Atoka, and Huck sources of supply for the #1 Imel 8AD-Nau well located approx. SW NW NW NE of Section 8-26S-22W, Ford County, Kansas.

Any persons who object to or protest this application shall be required to file their objections or protests with the Conservation Division of the State Corporation Commission of the State of Kansas within fifteen (15) days from the date of the publication. These protests shall be filed pursuant to Commission regulations and must state specific reasons why the grant of the application may cause waste, violate correlative rights or pollute the natural resources of the state of Kansas.

If no protests are received, this application may be granted through a summary proceeding. If valid protests are received, this matter will be set for hearing.

All persons interested or concerned shall take notice of the foregoing and shall govern themselves accordingly.

RITCHIE EXPLORATION, INC.
P.O. Box 783188
Wichita, KS 67278-3188
(316) 691-9500



CONFIDENTIAL

WELL COMPLETION FORM

WELL HISTORY - DESCRIPTION OF WELL & LEASE

OPERATOR: License # 4767
 Name: Ritchie Exploration, Inc.
 Address 1: 8100 E 22ND ST N # 700
 Address 2: BOX 783188
 City: WICHITA State: KS Zip: 67278 + 3188
 Contact Person: John Niernberger
 Phone: (316) 691-9500
 CONTRACTOR: License # 33350
 Name: Southwind Drilling, Inc.
 Wellsite Geologist: Adam Eldani
 Purchaser: NCRA

Designate Type of Completion:

- New Well Re-Entry Workover
- Oil WSW SWD SIOW
 Gas D&A ENHR SIGW
 OG GSW Temp. Abd.
 CM (Coal Bed Methane)
 Cathodic Other (Core, Expl., etc.): _____

If Workover/Re-entry: Old Well Info as follows:

Operator: _____
 Well Name: _____
 Original Comp. Date: _____ Original Total Depth: _____
 Deepening Re-perf. Conv. to ENHR Conv. to SWD
 Conv. to GSW
 Plug Back: _____ Plug Back Total Depth _____
 Commingled Permit #: _____
 Dual Completion Permit #: _____
 SWD Permit #: _____
 ENHR Permit #: _____
 GSW Permit #: _____

<u>04/30/2013</u>	<u>05/11/2013</u>	<u>05/11/2013</u>
Spud Date or Recompletion Date	Date Reached TD	Completion Date or Recompletion Date

API No. 15 - 15-057-20887-00-00
 Spot Description: 5'S & 130'E of N2N2N2
SW_NW_NW_NE Sec. 8 Twp. 26 S. R. 22 East West
335 Feet from North / South Line of Section
2510 Feet from East / West Line of Section
 Footages Calculated from Nearest Outside Section Corner:
 NE NW SE SW
 County: Ford
 Lease Name: Imel 8AD-Nau Well #: 1
 Field Name: _____
 Producing Formation: Cherokee, Huck & Atoka
 Elevation: Ground: 2727 Kelly Bushing: 2439
 Total Depth: 5020 Plug Back Total Depth: 4954
 Amount of Surface Pipe Set and Cemented at: 371 Feet
 Multiple Stage Cementing Collar Used? Yes No
 If yes, show depth set: 1465 Feet
 If Alternate II completion, cement circulated from: 0
 feet depth to: 1465 w/ 285 sx cmt.

Drilling Fluid Management Plan

(Data must be collected from the Reserve Pit)

Chloride content: 14100 ppm Fluid volume: 1000 bbls
 Dewatering method used: Evaporated
 Location of fluid disposal if hauled offsite: _____
 Operator Name: _____
 Lease Name: _____ License #: _____
 Quarter _____ Sec. _____ Twp. _____ S. R. _____ East West
 County: _____ Permit #: _____

AFFIDAVIT

I am the affiant and I hereby certify that all requirements of the statutes, rules and regulations promulgated to regulate the oil and gas industry have been fully complied with and the statements herein are complete and correct to the best of my knowledge.

Submitted Electronically

KCC Office Use ONLY

- Letter of Confidentiality Received
 Date: 08/20/2013
 Confidential Release Date: _____
 Wireline Log Received
 Geologist Report Received
 UIC Distribution
 ALT I II III Approved by: NAOMI JAMES Date: 08/21/2013



155887

Operator Name: Ritchie Exploration, Inc. Lease Name: Imel 8AD-Nau Well #: 1
 Sec. 8 Twp. 26 S. R. 22 East West County: Ford

INSTRUCTIONS: Show important tops and base of formations penetrated. Detail all cores. Report all final copies of drill stems tests giving interval tested, time tool open and closed, flowing and shut-in pressures, whether shut-in pressure reached static level, hydrostatic pressures, bottom hole temperature, fluid recovery, and flow rates if gas to surface test, along with final chart(s). Attach extra sheet if more space is needed. Attach complete copy of all Electric Wire-line Logs surveyed. Attach final geological well site report.

Drill Stem Tests Taken <input checked="" type="checkbox"/> Yes <input type="checkbox"/> No <i>(Attach Additional Sheets)</i> Samples Sent to Geological Survey <input checked="" type="checkbox"/> Yes <input type="checkbox"/> No Cores Taken <input type="checkbox"/> Yes <input checked="" type="checkbox"/> No Electric Log Run <input checked="" type="checkbox"/> Yes <input type="checkbox"/> No Electric Log Submitted Electronically <input checked="" type="checkbox"/> Yes <input type="checkbox"/> No <i>(If no, Submit Copy)</i> List All E. Logs Run: Dual Induction Log Compensated Density/Neutron Log	<input type="checkbox"/> Log Formation (Top), Depth and Datum <input checked="" type="checkbox"/> Sample Name Top Datum See Attached
---	--

CASING RECORD <input checked="" type="checkbox"/> New <input type="checkbox"/> Used							
Report all strings set-conductor, surface, intermediate, production, etc.							
Purpose of String	Size Hole Drilled	Size Casing Set (In O.D.)	Weight Lbs. / Ft.	Setting Depth	Type of Cement	# Sacks Used	Type and Percent Additives
Surface	12.25	8.625	24	371	Common	220	3% cc, 2% gel
Production	7.88	4.5	10.5	5001	OWC	200	10% sa't, 2% gel, 5#/sx Kofseal

ADDITIONAL CEMENTING / SQUEEZE RECORD				
Purpose:	Depth Top Bottom	Type of Cement	# Sacks Used	Type and Percent Additives
____ Perforate				
____ Protect Casing				
____ Plug Back TD				
____ Plug Off Zone				

Shots Per Foot	PERFORATION RECORD - Bridge Plugs Set/Type Specify Footage of Each Interval Perforated	Acid, Fracture, Shot, Cement Squeeze Record (Amount and Kind of Material Used)	Depth
4	4864'-4866' (6/11/13)	250 gals 15% NE & 500 gals 28% NE	
4	4850'-4852', 4860'-4862' (6/11/13)	250 gals 15% NE & 500 gals 28% NE	
4	4821'-4823', 4835'-4837' (6/11/13)	250 gals 15% NE & 500 gals 28% NE	
4	4813'-4815' (6/11/13)	250 gals 15% NE & 500 gals 28% NE	

TUBING RECORD: Size: <u>2.375</u> Set At: <u>4930</u> Packer At:		Liner Run: <input type="checkbox"/> Yes <input checked="" type="checkbox"/> No
Date of First, Resumed Production, SWD or ENHR. <u>07/23/2013</u>		Producing Method: <input type="checkbox"/> Flowing <input checked="" type="checkbox"/> Pumping <input type="checkbox"/> Gas Lift <input type="checkbox"/> Other (Explain) _____
Estimated Production Per 24 Hours	Oil Bbls. <u>6.26</u>	Gas Mcf <u>3.34</u> Water Bbls. _____ Gas-Oil Ratio _____ Gravity _____

DISPOSITION OF GAS: <input type="checkbox"/> Vented <input type="checkbox"/> Sold <input type="checkbox"/> Used on Lease <i>(If vented, Submit ACO-18.)</i>	METHOD OF COMPLETION: <input type="checkbox"/> Open Hole <input checked="" type="checkbox"/> Perf. <input type="checkbox"/> Dually Comp. <input type="checkbox"/> Commingled <i>(Submit ACO-5)</i> <i>(Submit ACO-4)</i> <input type="checkbox"/> Other (Specify) _____	PRODUCTION INTERVAL: _____ _____
---	--	--



#1 Imel 8AD - Nau
335' FNL & 2510' FEL
5' S & 130' E of N/2 N/2 N/2 Section 8-26S-22W
Ford County, Kansas
API# 15-057-20887-0000
Elevation: 2427' GL, 2439' KB

Sample Tops			Ref. Well
Anhydrite	1492'	+947	Flat
B/Anhydrite	1524'	+915	-9
Stotler	3493'	-1054	-2
Heebner	4118'	-1679	-3
Lansing	4229'	-1790	-4
Muncie Shale	4407'	-1968	-2
Stark Shale	4512'	-2073	-6
Hush	4570'	-2131	-7
BKC	4607'	-2166	-5
Marmaton	4631'	-2194	-7
Altamont	4666'	-2227	-7
Pawnee	4737'	-2298	-4
Fort Scott	4766'	-2327	-1
Cherokee Shale	4786'	-2347	-4
Lower Cherokee Shale	4818'	-2379	-0
Huck	4849'	-2410	+1
Atoka	4862'	-2423	+1
Mississippian	4894'	-2455	+3
RTD	5020'	-2581	

Conservation Division
266 N. Main St., Ste. 220
Wichita, KS 67202-1513



Phone: 316-337-6200
Fax: 316-337-6211
<http://kcc.ks.gov/>

Shari Feist Albrecht, Chair
Jay Scott Emler, Commissioner
Pat Apple, Commissioner

Sam Brownback, Governor

March 19, 2015

John Niernberger
Ritchie Exploration, Inc.
P.O. Box 783188
Wichita, KS 67278-3188

RE: Approved Commingling CO031513
Imel 8AD-Nau 1
API No. 15-057-20887-00-00

Dear Mr. Niernberger:

Your Application for Commingling (ACO-4) for the above described well has been reviewed and approved by the Kansas Corporation Commission (KCC) per K.A.R. 82-3-123. Notice was examined and found to be proper per K.A.R. 82-3-135a. No protest had been filed within the 15-day protest period.

Based upon the depth of the Atoka formation perforations, total oil production shall not exceed 200 BOPD and total gas production shall not exceed 50% of the absolute open flow (AOF).

Sincerely,

Rick Hestermann
Production Department