



**APPLICATION FOR COMMINGLING OF PRODUCTION (K.A.R. 82-3-123) OR FLUIDS (K.A.R. 82-3-123a)** *Commingling ID # \_\_\_\_\_*

OPERATOR: License # \_\_\_\_\_ API No. 15 - \_\_\_\_\_  
Name: \_\_\_\_\_ Spot Description: \_\_\_\_\_  
Address 1: \_\_\_\_\_ - - - - - Sec. \_\_\_\_\_ Twp. \_\_\_\_\_ S. R. \_\_\_\_\_  East  West  
Address 2: \_\_\_\_\_ Feet from  North /  South Line of Section  
City: \_\_\_\_\_ State: \_\_\_\_\_ Zip: \_\_\_\_\_ + \_\_\_\_\_ Feet from  East /  West Line of Section  
Contact Person: \_\_\_\_\_ County: \_\_\_\_\_  
Phone: ( \_\_\_\_\_ ) \_\_\_\_\_ Lease Name: \_\_\_\_\_ Well #: \_\_\_\_\_

1. Name and upper and lower limit of each production interval to be commingled:  
Formation: \_\_\_\_\_ (Perfs): \_\_\_\_\_  
Formation: \_\_\_\_\_ (Perfs): \_\_\_\_\_  
Formation: \_\_\_\_\_ (Perfs): \_\_\_\_\_  
Formation: \_\_\_\_\_ (Perfs): \_\_\_\_\_  
Formation: \_\_\_\_\_ (Perfs): \_\_\_\_\_

2. Estimated amount of fluid production to be commingled from each interval:  
Formation: \_\_\_\_\_ BOPD: \_\_\_\_\_ MCFPD: \_\_\_\_\_ BWPD: \_\_\_\_\_  
Formation: \_\_\_\_\_ BOPD: \_\_\_\_\_ MCFPD: \_\_\_\_\_ BWPD: \_\_\_\_\_  
Formation: \_\_\_\_\_ BOPD: \_\_\_\_\_ MCFPD: \_\_\_\_\_ BWPD: \_\_\_\_\_  
Formation: \_\_\_\_\_ BOPD: \_\_\_\_\_ MCFPD: \_\_\_\_\_ BWPD: \_\_\_\_\_  
Formation: \_\_\_\_\_ BOPD: \_\_\_\_\_ MCFPD: \_\_\_\_\_ BWPD: \_\_\_\_\_

3. Plat map showing the location of the subject well, all other wells on the subject lease, and all wells on offsetting leases within a 1/2 mile radius of the subject well, and for each well the names and addresses of the lessee of record or operator.

4. Signed certificate showing service of the application and affidavit of publication as required in K.A.R. 82-3-135a.

**For Commingling of PRODUCTION ONLY, include the following:**

- 5. Wireline log of subject well. Previously Filed with ACO-1:  Yes  No
- 6. Complete Form ACO-1 (*Well Completion form*) for the subject well.

**For Commingling of FLUIDS ONLY, include the following:**

- 7. Well construction diagram of subject well.
- 8. Any available water chemistry data demonstrating the compatibility of the fluids to be commingled.

**AFFIDAVIT:** I am the affiant and hereby certify that to the best of my current information, knowledge and personal belief, this request for commingling is true and proper and I have no information or knowledge, which is inconsistent with the information supplied in this application.

**Submitted Electronically**

**KCC Office Use Only**  
 Denied  Approved  
15-Day Periods Ends: \_\_\_\_\_  
Approved By: \_\_\_\_\_ Date: \_\_\_\_\_

*Protests may be filed by any party having a valid interest in the application. Protests must be in writing and comply with K.A.R. 82-3-135b and must be filed within 15 days of publication of the notice of application.*

# Proof Of Publication

## State Of Kansas - Finney County

Dena A. Sattler, being first duly sworn, deposes and says that she is publisher of THE GARDEN CITY TELEGRAM, a weekly newspaper printed in the State of Kansas and published in and of general circulation in Finney County, Kansas, on a weekly basis in Finney County, Kansas, and that said newspaper is not a trade, religious, or fraternal publication.

THAT said newspaper is daily published at least weekly fifty (50) times a year; has been so published continuously and uninterruptedly in said county and state for a period of more than five (5) years prior to the first publication of said notice.

THAT the attached notice is a true copy thereof and was published in the regular and entire issue of said newspaper for 1 consecutive days/weeks. The first (1st) publication thereof being made as aforesaid on the 17 day of October, 2014.

With subsequent publications being made on the following dates:

2<sup>nd</sup> Publication made on the      day of     , 20    
3<sup>rd</sup> Publication made on the      day of     , 20    
4<sup>th</sup> Publication made on the      day of     , 20  

Publication Fee: \$ 49.86  
Affidavits (Additional Copies): @ \$5 each \$       
Total Publication Fee: \$ 49.86

Sign Dena A. Sattler

Witness my hand this 17 day of Oct, 2014

SUBSCRIBED AND SWORN before me this 17 day of October, 2014.

(Notary Public)  
My commission expires 11-22-17

(Published in The Garden City Telegram Friday, October 17, 2014.)

BEFORE THE STATE CORPORATION COMMISSION OF THE STATE OF KANSAS  
NOTICE OF FILING APPLICATION

Re: Berexco LLC Application for a permit to commingle production in the Fort Scott, Morrow and Saint Louis formations in the Walker #11-20 well, located in Finney County, Kansas.

To: All Oil & Gas Producers, Unleased Mineral Interest Owners, Landowners, and all persons whosoever concerned.

You, and each of you are hereby notified that Berexco LLC has filed an application to commingle production from the Fort Scott, Morrow and Saint Louis formations in the Walker #11-20 well located in the N/2 S/2 SE SE (560' FSL, 660' FEL) of Sec 20-23S-32W, Finney County, KS.

Any persons who object to, or protest this application shall be required to file their objections or protests with the Oil & Gas Conservation Division of the Kansas Corporation Commission within fifteen (15) days from the date of this publication. These protests shall be filed pursuant to Commission regulations and must state specific reasons why the grant of the application may cause waste, violate correlative rights, or pollute the natural resources of the state of Kansas. All persons interested or concerned shall take notice of the foregoing and shall govern themselves accordingly.

Berexco LLC  
2020 N. Bramblewood  
Wichita, KS 67206-1094  
Phone: 316-265-3311

235772

NOTARY PUBLIC - State of Kansas  
**NANCY MILLER**  
My Appt. Exp 11-22-17

Legal Invoice #  
235772

**AFFIDAVIT**

STATE OF KANSAS \
- SS.
County of Sedgwick /

Mark Fletchall, of lawful age, being first duly sworn, deposeth and saith: That he is Record Clerk of The Wichita Eagle, a daily newspaper published in the City of Wichita, County of Sedgwick, State of Kansas, and having a general paid circulation on a daily basis in said County, which said newspaper has been continuously and uninterruptedly published in said County for more than one year prior to the first publication of the notice hereinafter mentioned, and which said newspaper has been entered as second class mail matter at the United States Post Office in Wichita, Kansas, and which said newspaper is not a trade, religious or fraternal publication and that a notice of a true copy is hereto attached was published in the regular and entire Morning issue of said The Wichita Eagle for \_1\_ issues, that the first publication of said notice was

made as aforesaid on the 18th of

October A.D. 2014, with

subsequent publications being made on the following dates:

And affiant further says that he has personal knowledge of the statements above set forth and that they are true.

*Mark Fletchall*

Subscribed and sworn to before me this

27th day of October, 2014

JENNIFER RAE BAILEY
Notary Public, State of Kansas
My Appt. Expires 10/1/2017

*JRB*

Notary Public Sedgwick County, Kansas

Printer's Fee : \$142.60

**LEGAL PUBLICATION**

Published In The Wichita Eagle
October 18, 2014 (3323064)

BEFORE THE STATE CORPORATION
COMMISSION OF THE STATE OF KANSAS
NOTICE OF FILING APPLICATION

Re: Berexco LLC Application for a permit
to commingle production in the Fort Scott,
Morrow and Saint Louis formations in the
Walker #11-20 well, located in Finney County,
Kansas.

To: All Oil & Gas Producers, Unleased
Mineral Interest Owners, Landowners, and
all persons whosoever concerned.

You, and each of you are hereby notified
that Berexco LLC has filed an application to
commingle production from the Fort Scott,
Morrow and Saint Louis formations in the
Walker #11-20 well located in the N/2 S/2 SE
SE (560' FSL, 660' FEL) of Sec 20-23S-32W,
Finney County, KS.

Any persons who object to, or protest
this application shall be required to file
their objections or protests with the Oil &
Gas Conservation Division of the Kansas
Corporation Commission within fifteen (15)
days from the date of this publication. These
protests shall be filed pursuant to Commission
regulations and must state specific reasons
why the grant of the application may cause
waste, violate correlative rights, or pollute
the natural resources of the state of Kansas.
All persons interested or concerned shall
take notice of the foregoing and shall govern
themselves accordingly.

Berexco LLC
2020 N. Bramblewood
Wichita, KS 67206-1094
Phone: 316-265-3311

**Berexco LLC**

Walker #11-20

Application for Commingling (ACO-4)  
N/2 S/2 SE SE 20-23S-32W  
Finney County, KS

**POSTED WELL DATA**  
Operator  
Well Name  
● Well Number

**REMARKS**  
Brown Circle = 1/2 Mile Radius  
Green Arrow = Subject Well  
September 24, 2014 10:23 AM

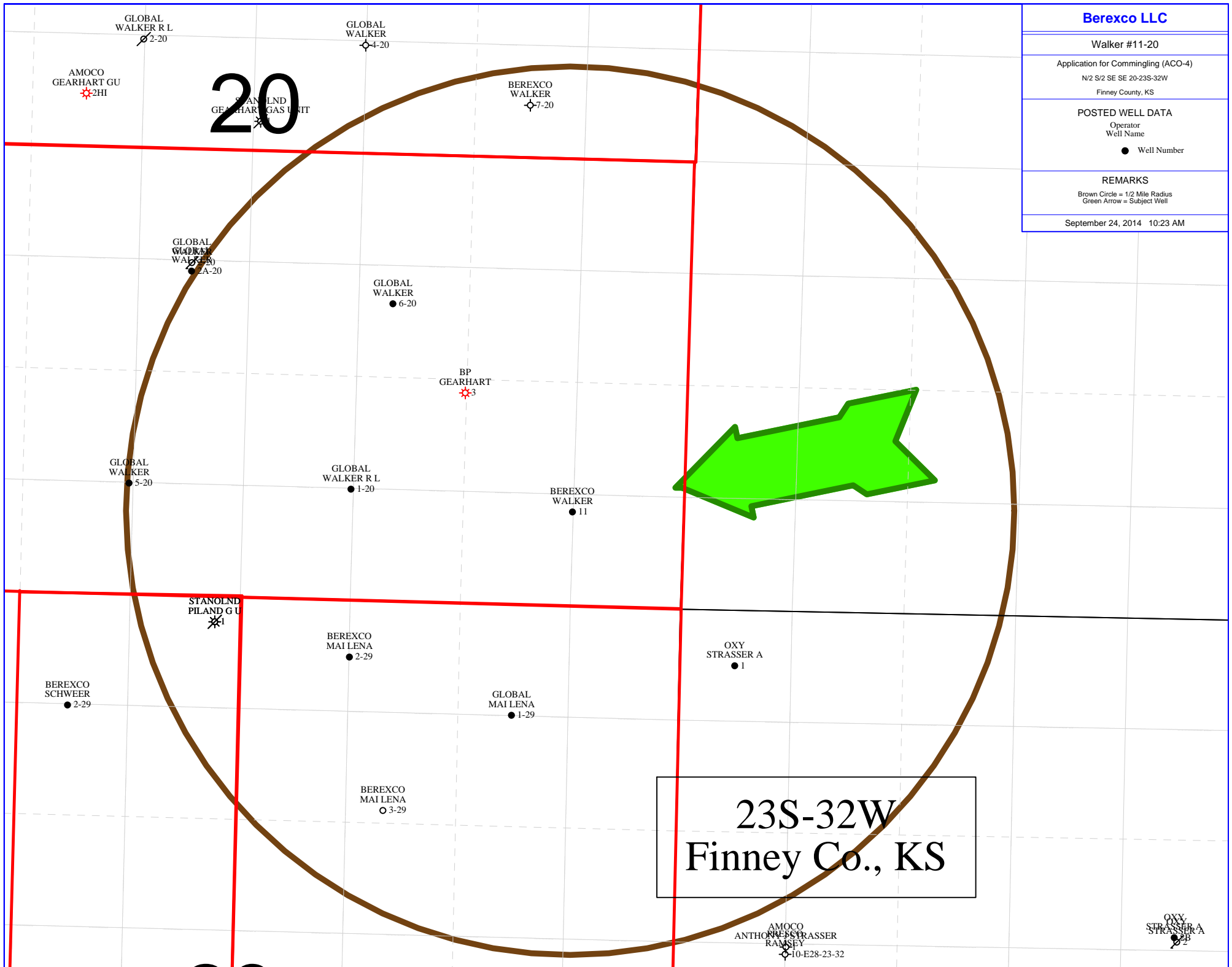

23S-32W  
Finney Co., KS

WF

**PRODUCTION TEST & GOR REPORT**

**IMPORTANT:** This form is intended to convey information pertinent to a single well, not an entire lease.  
In so far as possible, while testing the well, production of both oil and natural gas shall be held within assigned daily allowable limits.

TYPE TEST:  Initial  Annual  Workover  Reclassification TEST DATE: 11-13-14

Company: Berexco LLC Lease: Walker Well No.: 11-20

County: Finney Location: N/2 S/2 SE SE Sec. 20 Twp. 23s R. 32  East  West Acres: \_\_\_\_\_

API Well No.: 15-055-22318-00-00 Reservoir(s): St. Louis, Morrow, Ft. Scott Gas Pipeline Connection: \_\_\_\_\_

Completion Date: 08/23/2014 Liquid to Surface Thru (Describe): Tubing (Pumped) Plug Back T.D.: 4885 Packer Set At: no pkr.

Lifting Method:  None  Pumping  Gas Lift  ESP Type Liquid: oil & salt brine API Gravity of Liquid / Oil: 33

Casing Diameter: 5.50 Weight: 15.5 I.D.: 4.95 Set At: 4928 Perforations: 4487 To: 4791

Tubing Diameter: 2.875 Weight: 6.4 I.D.: 2.441 Set At: 4623 Perforations: \_\_\_\_\_ To: \_\_\_\_\_

**Pretest**  
Starting Date: \_\_\_\_\_ Time: \_\_\_\_\_  AM /  PM Ending Date: \_\_\_\_\_ Time: \_\_\_\_\_  AM /  PM

**Test**  
Starting Date: 11/12/14 Time: 9:30  AM /  PM Ending Date: 11/13/14 Time: 9:30  AM /  PM

**OIL PRODUCTION OBSERVED DATA**

Bbbls./In.	Producing Wellhead Pressure		Separator Pressure			Choke Size			Net API Bbbls.	
	Casing: Psig	Tubing: Psig	Feet	Inches	Barrels	Feet	Inches	Barrels	Water	Oil
	Stock Tank	Starting Gauge	Ending Gauge			Net API Bbbls.				
	Size	Number	Feet	Inches	Barrels	Feet	Inches	Barrels	Water	Oil
Pretest:										
Test 1:	<u>12x20</u>	<u>2963</u>	<u>2</u>	<u>6</u>	<u>50.1</u>	<u>5</u>	<u>0</u>	<u>100.2</u>	<u>17.8</u>	<u>50.1</u>
Test 2:										

**GAS PRODUCTION OBSERVED DATA**

Orifice Meter Connections:  Pipe Taps  Flange Taps

Orifice Meter Location:  Downstream of Separator  At Wellhead

Check one:  Ranges > Differential: \_\_\_\_\_ Inches Static Pressure: \_\_\_\_\_ inches / psi

Type Measuring Device	Sales Line Entry Size (inches)	Orifice Size	Meter - Prover <sup>2</sup> Tester Pressure				Diff. Pressure (H <sub>w</sub> ) or (h <sub>d</sub> )	Gas Gravity (G <sub>g</sub> )	Flow Temp. (t)
			In. Water	In. Merc.	Psig or (P <sub>a</sub> )	%CO <sub>2</sub>			
Orifice Meter									
Critical Flow Prover									
MERLA Well Tester									

**GAS FLOW RATE CALCULATIONS (R)**

Plate Coeff. MCFD (F <sub>b</sub> ) (F <sub>p</sub> )	Meter - Prover Press. (Psia) (P <sub>p</sub> )	Press Extension $\sqrt{h_w \times P_m}$	Gravity Factor (F <sub>g</sub> )	Choke Setting	Flowing Temp. Factor (F <sub>t</sub> )	Deviation Factor (F <sub>pv</sub> )	Sqr. Rt. Chart Factor (F <sub>r</sub> )
Trial 1:							
Trial 2:							

Gas Prod. MCF Flow Rate (R): \_\_\_\_\_ Oil Prod. Bbbls / Day: \_\_\_\_\_ Gas / Oil Ratio (GOR): \_\_\_\_\_ Cubic Feet per Bbl.

The undersigned authority, on behalf of the Company, states that he is duly authorized to make the above report and that he has knowledge of the facts stated therein, and that every aspect of said report is true and correct. Executed this the 13 day of Nov, 2014.

Phil Hoemp  
For Offset Operator

[Signature]  
For Commission

For Company

BEFORE THE STATE  
CORPORATION COMMISSION  
OF THE STATE OF KANSAS  
NOTICE OF FILING APPLICATION

Re: Berexco LLC Application for a permit to commingle production in the Fort Scott, Morrow and St. Louis formations in the Walker #11-20 well, located in Finney County, Kansas.

To: All Oil & Gas Producers, Unleased Mineral Interest Owners, Landowners, and all persons whosoever concerned.

You, and each of you are hereby notified that Berexco LLC has filed an application to commingle production from the Fort Scott, Morrow and St. Louis formations in the Walker #11-20 well located in the N/2 S/2 SE SE (560' FSL, 660' FEL) of Sec 20-23S-32W, Finney County, KS.

Any persons who object to, or protest this application shall be required to file their objections or protests with the Oil & Gas Conservation Division of the Kansas Corporation Commission within fifteen (15) days from the date of this publication. These protests shall be filed pursuant to Commission regulations and must state specific reasons why the grant of the application may cause waste, violate correlative rights, or pollute the natural resources of the state of Kansas. All persons interested or concerned shall take notice of the foregoing and shall govern themselves accordingly.

Berexco LLC  
2020 N. Bramblewood  
Wichita, KS 67206-1094  
Phone: 316-265-3311

---

# BEREXCO LLC

March 5, 2015

Kansas Corporation Commission  
Oil & Gas Conservation Division  
266 North Main, Suite 220  
Wichita, KS 67202-1513

RE: Walker #11-20 Application for Commingling of Production  
N/2 S/2 SE SE Sec 20-23S-32W (560' FSL, 660' FEL)  
Finney County, Kansas  
API # 15-055-22318-00-00

Gentlemen:

Enclosed please find our Application for Commingling of Production for the Walker #11-20 well. Notice of this application has been provided to the persons listed on Exhibit A (attached) in accordance with Kansas Corporation Commission Rules & Regulations - K.A.R. 82-3-135a (b), by first class mail, postpaid. If anything is lacking in our application, please advise me at your earliest convenience.

Thank you for your attention to this matter.

Sincerely,



Richard R. Smith  
Engineering Technician  
(316) 337-8334  
(316) 265-2994 (fax)  
rsmith@berexco.com

Encls.:

- Application for Commingling of Production (form ACO-4)
  - 1) ACO-1 Completion report (filed w/KCC previously)
  - 2) Plat Map of all wells within ½ mile radius of subject well with required information
  - 3) Notice of Filing Application (mailed to Exhibit A Walker #11-25 notice area)
  - 4) C-5 Production Test & GOR Report
  - 5) Affidavit of Mailing
  - 6a) Affidavit of Publication – Wichita Eagle
  - 6b) Affidavit of Publication – Garden City Telegram

**Walker #11-20 notice area**

**Surface owner – SE/4 Sec. 20-23S-32W (wellsite)**

Wheatland Electric Cooperative  
P. O. Box 1078  
Garden City, KS 67846-1078

**Operator (below base/Permian) – S/2 Sec. 20, E/2 NW/4, NE/4 Sec. 29-23S-32W**

Berexco LLC  
2020 N. Bramblewood  
Wichita, KS 67206

**Operator (above base/Permian) – All Sec. 20-23S-32W**

**Operator (Chase formation) – All Sec. 29-23S-32W**

Linn Operating, Inc.  
600 Travis, Suite 5100  
Houston, TX 77002

**Operator (above base/Permian) – All Secs. 21, 28-23S-32W**

Kansas Natural Gas Operating, Inc.  
P. O. Box 818  
Hays, KS 67001

**Leasehold owner (below base/Permian) – SW/4 Sec. 21-23S-32W**

Anadarko E&P Onshore, LLC  
P. O. Box 1330  
Houston, TX 77251

**Leasehold owner/Operator – N/2 Sec. 20, NW/4 Sec. 21, NW/4 Sec. 28-23S-32W**

Merit Energy Company, LLC  
13727 Noel Road, Suite 1200  
Dallas, TX 75240

**Operator (Council Grove formation) – All Sec. 29-23S-32W**

Pioneer Oil Company, Inc.  
RR #4, Box 142B  
Lawrenceville, IL 62439





Conservation Division  
266 N. Main St., Ste. 220  
Wichita, KS 67202-1513



Phone: 316-337-6200  
Fax: 316-337-6211  
<http://kcc.ks.gov/>

Shari Feist Albrecht, Chair  
Jay Scott Emler, Commissioner  
Pat Apple, Commissioner

Sam Brownback, Governor

March 23, 2015

Evan Mahyew  
BEREXCO LLC  
2020 N. Bramblewood  
Wichita, KS 67206-1094

RE: Approved Commingling CO031503  
Walker 11-20, Sec. 20-T23S-R32W, Finney County  
API No. 15-055-22318-00-00

Dear Mr Mayhew:

Your Application for Commingling (ACO-4) for the above described well has been reviewed and approved by the Kansas Corporation Commission (KCC) per K.A.R. 82-3-123. Notice was examined and found to be proper per K.A.R. 82-3-135a. No protest had been filed within the 15-day protest period.

Based upon the depth of the St. Louis formation perforations, total oil production shall not exceed **200 BOPD** and total gas production shall not exceed 50% of the absolute open flow (AOF).

Sincerely,

Rick Hestermann  
Production Department