



APPLICATION FOR COMMINGLING OF PRODUCTION (K.A.R. 82-3-123) OR FLUIDS (K.A.R. 82-3-123a) *Commingling ID # _____*

OPERATOR: License # _____ API No. 15 - _____
Name: _____ Spot Description: _____
Address 1: _____ - - - - - Sec. _____ Twp. _____ S. R. _____ East West
Address 2: _____ Feet from North / South Line of Section
City: _____ State: _____ Zip: _____ + _____ Feet from East / West Line of Section
Contact Person: _____ County: _____
Phone: (_____) _____ Lease Name: _____ Well #: _____

1. Name and upper and lower limit of each production interval to be commingled:
Formation: _____ (Perfs): _____
Formation: _____ (Perfs): _____
Formation: _____ (Perfs): _____
Formation: _____ (Perfs): _____
Formation: _____ (Perfs): _____

2. Estimated amount of fluid production to be commingled from each interval:
Formation: _____ BOPD: _____ MCFPD: _____ BWPD: _____
Formation: _____ BOPD: _____ MCFPD: _____ BWPD: _____
Formation: _____ BOPD: _____ MCFPD: _____ BWPD: _____
Formation: _____ BOPD: _____ MCFPD: _____ BWPD: _____
Formation: _____ BOPD: _____ MCFPD: _____ BWPD: _____

3. Plat map showing the location of the subject well, all other wells on the subject lease, and all wells on offsetting leases within a 1/2 mile radius of the subject well, and for each well the names and addresses of the lessee of record or operator.

4. Signed certificate showing service of the application and affidavit of publication as required in K.A.R. 82-3-135a.

For Commingling of PRODUCTION ONLY, include the following:

- 5. Wireline log of subject well. Previously Filed with ACO-1: Yes No
- 6. Complete Form ACO-1 (*Well Completion form*) for the subject well.

For Commingling of FLUIDS ONLY, include the following:

- 7. Well construction diagram of subject well.
- 8. Any available water chemistry data demonstrating the compatibility of the fluids to be commingled.

AFFIDAVIT: I am the affiant and hereby certify that to the best of my current information, knowledge and personal belief, this request for commingling is true and proper and I have no information or knowledge, which is inconsistent with the information supplied in this application.

Submitted Electronically

KCC Office Use Only
 Denied Approved
15-Day Periods Ends: _____
Approved By: _____ Date: _____

Protests may be filed by any party having a valid interest in the application. Protests must be in writing and comply with K.A.R. 82-3-135b and must be filed within 15 days of publication of the notice of application.

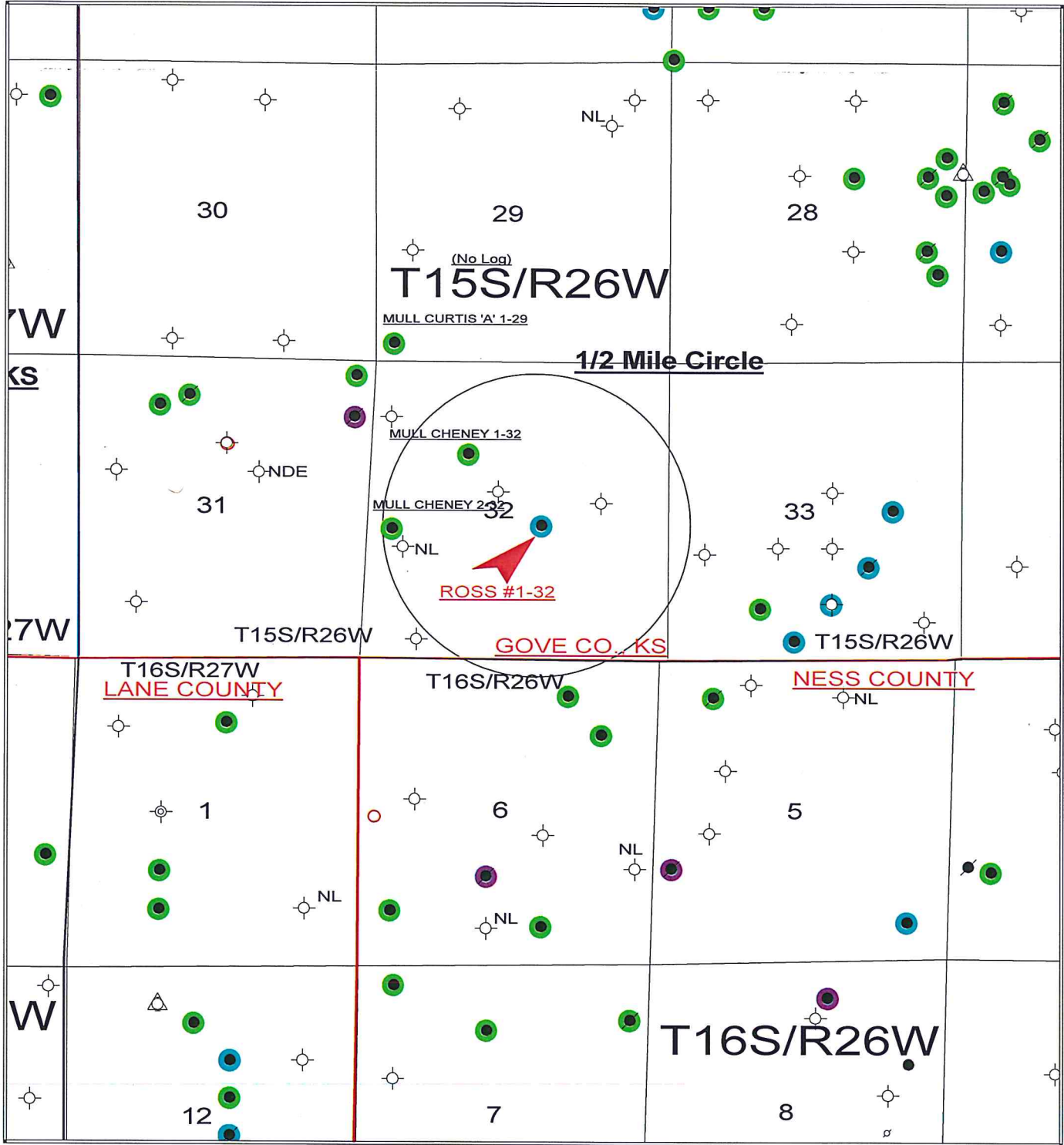

LEGEND

- LKC Production
- Marmaton Production
- Cherokee Production
- Mississippi Production



DRILLING COMPANY, INC.
WICHITA, KANSAS

Mull Ross #1-32
Comingle Application

erm		March 27, 2015
2 inches :: 1 mile		



DRILLING COMPANY, INC.
WICHITA, KANSAS

ATTACHMENT TO ACO-4
APPLICATION FOR COMMINGLING OF PRODUCTION

Signed Certificate of Notice to Offset Operators and Unleased Mineral Holders

Mull Drilling Company, Inc.
Ross #1-32
NW/4 SE/4 Section 32-15S-26W
Gove County, Kansas
API No. 15-063-22201-00-00

Names and addresses of each operator or lessee of record and each unleased mineral owner within one half mile of the subject well:

All 32-15S-26W

Mull Drilling Company, Inc.

N/2 SW/4 33-15S-26W

Gove County, KS

S/2 SW/4 33-15S-26W

Gove County, KS

Daystar Petroleum
P.O. Box 560
Eureka KS 67045-0560

W/2 NW/4 33-15S-26W
Gove County, KS

Dodrill Family Trust
29000 A Road
Utica KS 67584

NE/4 6-16S-26W
Ness County, KS

Pintail Petroleum
225 N. Market, Suite 300
Wichita KS 67202

NW/4 6-16S-26W
Ness County, KS

SEP Holdings H, LLC.
1111 Bagby, Suite 1800
Houston TX 77002

Copy of the ACO-4 was mailed to the above listed companies/individuals on March 5, 2015.

Signed this 5th day of March, 2015.

MULL DRILLING COMPANY, INC.

Risa Carter
Risa Carter
Production Technician

STATE OF KANSAS

ACKNOWLEDGEMENT FOR INDIVIDUAL

COUNTY OF SEDGWICK

Before me, the undersigned, a Notary Public, within and for said county and state, on this 5th day of March, 2015, personally appeared Risa Carter, Production Technician of Mull Drilling Company, Inc., to me personally known to be the identical person who executed the within and foregoing Certificate of Service Form and acknowledged to me that he executed the same as his free and voluntary act and deed for the uses and purposes therein set forth.

IN WITNESS WHEREOF, I have hereunto set my hand and official seal the day and year last above written.

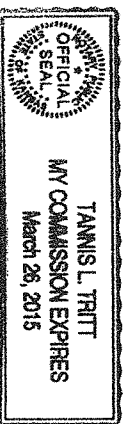

Tannis L. Tritt
Tannis L. Tritt, Notary Public

My commission expires: 3.26.2015

AFFIDAVIT OF PUBLICATION
State of Kansas,
Gove County, ss:

Roxanne Broeckelman,
being first duly sworn, deposes and
says: That she is
co-publisher of

Gove County Advocate, a weekly
newspaper printed in the State of
Kansas, and published in and of
general circulation in Gove County,
Kansas, with a general paid
circulation on a weekly basis in
Gove County, Kansas, and that said
newspaper is not a trade, religious
or fraternal publication.

Said newspaper is a weekly
published at least 50 times a year;
and has been so published
continuously and uninterruptedly in
said county and state for a period of
more than five years prior to the first
publication of said notice; and has
been admitted at the post office in
Quinter in said county as periodical
class mail matter.

That the attached notice is a true
copy thereof and was published in
the regular and entire issue of said

newspaper for one
consecutive week(s), the first
publication thereof being made as
aforesaid on the 11th day
of March, 2015,
with subsequent publications being
made on the following dates:

- _____
- _____
- _____
- _____
- _____
- _____

Printer's Fee\$ 22.00
Additional Copies \$ _____
Affidavit Fees\$ 2.00
Total Publication Fees . \$ 24.00

Roxanne Broeckelman

Subscribed and sworn to before me
this 11th day of
March, 2015

Linda L. Zerr
Notary Public

My commission expires:
January 8, 2017

LEGAL ADVERTISING
(First published in the Gove County Advocate,
Quinter, KS, Wed., March 11, 2015 - 1f)
**BEFORE THE STATE CORPORATION
COMMISSION OF THE STATE OF KANSAS
NOTICE OF FILING APPLICATION**
Re: Mull Drilling Company, Inc. - Application
for order to permit commingling of production of
the Ross #1-32, located in Gove County, Kansas.
To: All Oil & Gas Producers, Unleased Min-
eral Interest Owners, Landowners, and all per-
sons whosoever concerned.
You, and each of you, are hereby notified that
Mull Drilling Company, Inc. has filed an applica-
tion to commingle production of the Mississippian
and Lansing Kansas City formation on the Ross
#1-32, located NE NW NW SE Section 32-15S-
26W, Gove County, Kansas.
Any persons who object to or protest this ap-
plication shall be required to file their objections
or protests with the Conservation Division of the
State Corporation Commission of the State of
Kansas within fifteen (15) days from the date of
the publication. These protests shall be filed pur-
suant to Commission regulations and must state
specific reasons why the grant of the application
may cause waste, violate correlative rights or pol-
lute the natural resources of the state of Kansas.
If no protests are received, this application may
be granted through a summary proceeding. If
valid protests are received, this matter will be set
for hearing.
All persons interested or concerned shall take
notice of the foregoing and shall govern them-
selves accordingly.
Mull Drilling Company, Inc.
1700 N. Waterfront Parkway, Building 1200
Wichita, KS 67206
316-264-6366

LINDA L. ZERR
NOTARY PUBLIC
STATE OF KANSAS
My Appt. Exp. 1-8-2017

AFFIDAVIT

STATE OF KANSAS \
- SS.
County of Sedgwick /

Mark Fletchall, of lawful age, being first duly sworn, deposeth and saith: That he is Record Clerk of The Wichita Eagle, a daily newspaper published in the City of Wichita, County of Sedgwick, State of Kansas, and having a general paid circulation on a daily basis in said County, which said newspaper has been continuously and uninterruptedly published in said County for more than one year prior to the first publication of the notice hereinafter mentioned, and which said newspaper has been entered as second class mail matter at the United States Post Office in Wichita, Kansas, and which said newspaper is not a trade, religious or fraternal publication and that a notice of a true copy is hereto attached was published in the regular and entire Morning issue of said The Wichita Eagle for 1 issues, that the first publication of said notice was

made as aforesaid on the 9th of

March A.D. 2015, with

subsequent publications being made on the following dates:

And affiant further says that he has personal knowledge of the statements above set forth and that they are true.

Mark Fletchall

Subscribed and sworn to before me this

9th day of March, 2015



Rachel M. Wilson

Notary Public Sedgwick County, Kansas

Printers Fee: \$156.20

LEGAL PUBLICATION
Published in The Wichita Eagle
March 9, 2015 (3340663)
**BEFORE THE STATE CORPORATION
COMMISSION OF THE STATE OF KANSAS
NOTICE OF FILING APPLICATION**
Re: Mull Drilling Company, Inc. - Application
for order to permit commingling of
production of the
Ross #1-32, located in Gove County, Kansas.
To: All Oil & Gas Producers, Unleased Mineral
Interest Owners, Landowners, and all
persons whosever concerned.
You, and each of you, are hereby notified
that Mull Drilling Company, Inc. has filed
an application to commingle production of
the Mississippian and Lansing Kansas City
formation on the
Ross #1-32, located NE NW NW SE Section
32-15S-26W, Gove County, Kansas.
Any persons who object to or protest this
application shall be required to file their
objections or protests with the Conservation
Division of the State Corporation
Commission of the State of Kansas within
fifteen (15) days from the date of the
publication. These protests shall be files
pursuant to Commission regulations and
must state specific reasons why the grant
of the application may cause waste, violate
correlative rights or pollute the natural
resources of the state of Kansas. If no
protests are received, this application may
be granted through a summary proceeding.
If valid protests are received, this matter
will be set for hearing.
All persons interested or concerned shall
take notice of the foregoing and shall govern
themselves accordingly.
Mull Drilling Company, Inc.
1700 N. Waterfront Parkway, Building 1200
Wichita, KS 67206
316-264-6366



DRILLING COMPANY, INC.
WICHITA, KANSAS

Proposed Wellbore Configuration

Date:	3/27/2015
Well Name:	Ross #1-32
Location:	NE NW SW SE
	Section 32-T15S-R26W
County:	Gove
State:	Kansas
API:	15-063-22201
KB:	2617'
GL:	2612'
Spud Date:	4/24/2014

8-5/8" set at 216'
Cmt to surface with 165 sks.

Port Collar at 2075'
Cmt to surface with 175 sks.

Top of Cement at 3620'

LKC perfs at 4133'-39' & 4192'-95'

Mississippi perfs at 4494'-4500'

5-1/2", 17# csg set at 4592'
Cmt with 150 sks. 50/50 Pozmix



DownHole SAT Rx
FORMATION WATER CHEMISTRY INPUT

Mull Drilling
Ross1-32

Pro-Stim Chemicals
Troy Pelton

Report Date: 03-25-2015
Sample #: 24

Sampled: 03-25-2015
at 0000

CATIONS

Calcium (as Ca)	3912
Magnesium (as Mg)	807.00
Barium (as Ba)	4.00
Strontium (as Sr)	0.00
Sodium (as Na)	50172
Potassium (as K)	0.00
Lithium (as Li)	0.00
Ammonia (as NH ₃)	0.00
Aluminum (as Al)	0.00
Iron (as Fe)	1.50
Manganese (as Mn)	0.550
Zinc (as Zn)	0.00
Lead (as Pb)	0.00

ANIONS

Chloride (as Cl)	86000
Sulfate (as SO ₄)	1200
Bromine (as Br)	0.00
Dissolved CO ₂ (as CO ₂)	32.04
Bicarbonate (as HCO ₃)	260.00
Carbonate (as CO ₃)	0.00
Oxalic acid (as C ₂ O ₄)	0.00
Silica (as SiO ₂)	0.00
Phosphate(as PO ₄)	0.00
H ₂ S (as H ₂ S)	0.00
Fluoride (as F)	0.00
Nitrate (as NO ₃)	0.00
Boron (as B)	0.00

PARAMETERS

Calculated T.D.S.	138527
Molar Conductivity	212901
Resistivity	4.70
Sp.Gr.(g/mL)	1.08
Pressure(atm)	1.00
pCO ₂ (atm)	0.0172
pH ₂ S(atm)	0.00
Temperature (°F)	67.00
pH	6.98

COMMENTS

Prepared by SGB Solutions

FRENCH CREEK SOFTWARE, INC.
1220 VALLEY FORGE ROAD, BUILDING 21, VALLEY FORGE, PA 19460

Conservation Division
266 N. Main St., Ste. 220
Wichita, KS 67202-1513



Phone: 316-337-6200
Fax: 316-337-6211
<http://kcc.ks.gov/>

Shari Feist Albrecht, Chair
Jay Scott Emler, Commissioner
Pat Apple, Commissioner

Sam Brownback, Governor

April 22, 2015

Mark Shreve
Mull Drilling Co., Inc.
1700 N Waterfront Pkwy, Bldg 1200
Wichita, KS 67206

RE: Approved Commingling CO041510
Ross 1-32
API No. 15-063-22201-00-00

Dear Mr. Shreve:

Your Application for Commingling (ACO-4) for the above described well has been reviewed and approved by the Kansas Corporation Commission (KCC) per K.A.R. 82-3-123. Notice was examined and found to be proper per K.A.R. 82-3-135a. No protest had been filed within the 15-day protest period.

Based upon the depth of the Mississippi formation perforations, total oil production shall not exceed **200 BOPD** and total gas production shall not exceed 50% of the absolute open flow (AOF).

File form ACO-1 upon re-completion of the well to commingle.

Sincerely,

Rick Hestermann
Production Department