



**APPLICATION FOR COMMINGLING OF PRODUCTION (K.A.R. 82-3-123) OR FLUIDS (K.A.R. 82-3-123a)** *Commingling ID # \_\_\_\_\_*

OPERATOR: License # \_\_\_\_\_ API No. 15 - \_\_\_\_\_  
Name: \_\_\_\_\_ Spot Description: \_\_\_\_\_  
Address 1: \_\_\_\_\_ - - - - - Sec. \_\_\_\_\_ Twp. \_\_\_\_\_ S. R. \_\_\_\_\_  East  West  
Address 2: \_\_\_\_\_ Feet from  North /  South Line of Section  
City: \_\_\_\_\_ State: \_\_\_\_\_ Zip: \_\_\_\_\_ + \_\_\_\_\_ Feet from  East /  West Line of Section  
Contact Person: \_\_\_\_\_ County: \_\_\_\_\_  
Phone: ( \_\_\_\_\_ ) \_\_\_\_\_ Lease Name: \_\_\_\_\_ Well #: \_\_\_\_\_

1. Name and upper and lower limit of each production interval to be commingled:  
Formation: \_\_\_\_\_ (Perfs): \_\_\_\_\_  
Formation: \_\_\_\_\_ (Perfs): \_\_\_\_\_  
Formation: \_\_\_\_\_ (Perfs): \_\_\_\_\_  
Formation: \_\_\_\_\_ (Perfs): \_\_\_\_\_  
Formation: \_\_\_\_\_ (Perfs): \_\_\_\_\_

2. Estimated amount of fluid production to be commingled from each interval:  
Formation: \_\_\_\_\_ BOPD: \_\_\_\_\_ MCFPD: \_\_\_\_\_ BWPD: \_\_\_\_\_  
Formation: \_\_\_\_\_ BOPD: \_\_\_\_\_ MCFPD: \_\_\_\_\_ BWPD: \_\_\_\_\_  
Formation: \_\_\_\_\_ BOPD: \_\_\_\_\_ MCFPD: \_\_\_\_\_ BWPD: \_\_\_\_\_  
Formation: \_\_\_\_\_ BOPD: \_\_\_\_\_ MCFPD: \_\_\_\_\_ BWPD: \_\_\_\_\_  
Formation: \_\_\_\_\_ BOPD: \_\_\_\_\_ MCFPD: \_\_\_\_\_ BWPD: \_\_\_\_\_

3. Plat map showing the location of the subject well, all other wells on the subject lease, and all wells on offsetting leases within a 1/2 mile radius of the subject well, and for each well the names and addresses of the lessee of record or operator.

4. Signed certificate showing service of the application and affidavit of publication as required in K.A.R. 82-3-135a.

**For Commingling of PRODUCTION ONLY, include the following:**

- 5. Wireline log of subject well. Previously Filed with ACO-1:  Yes  No
- 6. Complete Form ACO-1 (*Well Completion form*) for the subject well.

**For Commingling of FLUIDS ONLY, include the following:**

- 7. Well construction diagram of subject well.
- 8. Any available water chemistry data demonstrating the compatibility of the fluids to be commingled.

**AFFIDAVIT:** I am the affiant and hereby certify that to the best of my current information, knowledge and personal belief, this request for commingling is true and proper and I have no information or knowledge, which is inconsistent with the information supplied in this application.

**Submitted Electronically**

**KCC Office Use Only**  
 Denied  Approved  
15-Day Periods Ends: \_\_\_\_\_  
Approved By: \_\_\_\_\_ Date: \_\_\_\_\_

*Protests may be filed by any party having a valid interest in the application. Protests must be in writing and comply with K.A.R. 82-3-135b and must be filed within 15 days of publication of the notice of application.*

R 31 W

T  
13  
S

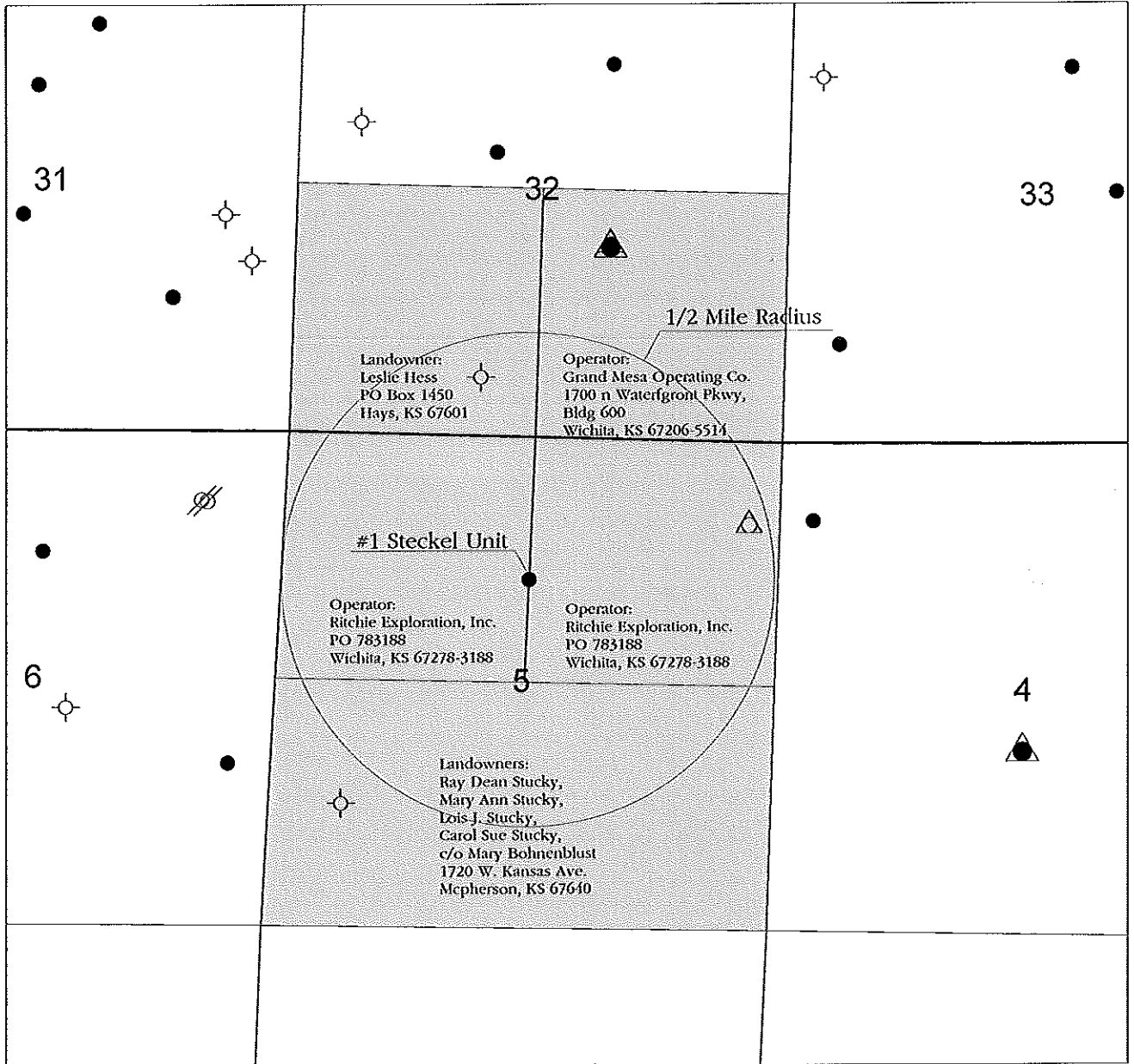

T  
14  
S

- Legend**
- Oil Well
  - ▲ Service Well / Was Oil Well
  - △ Service Well
  - ⊕ Dry and Abandoned Well



**RITCHIE**  
EXPLORATION, INC.  
Wichita, Kansas

Application for  
Commingling of  
Production or Fluids

**Applicant Well: #1 Steckel Unit**  
All Wells on Offsetting Leases within 1/2 Mile Radius  
Name and Address of Lessee of Record or Operator  
On Offsetting Leases

Gove County, Kansas

Prepared By: Justin Clegg	Scale: 1 : 21,120	Date: October 20, 2015
------------------------------	----------------------	---------------------------

# APPLICATION FOR COMMINGLING OF PRODUCTION OR FLUIDS

**Operator, Lessee or Unleased Mineral Owner  
within a ½ mile radius of Ritchie Exploration, Inc.'s**

**#1 Steckel Unit  
1525' FNL & 2660' FWL  
Section 5-14S-31W  
Gove Co., KS**

## Township 13 South, Range 31 West

Sec. 32:	SW/4	Leslie Hess P.O. Box 1450 Hays, KS 67601	Landowner
	SE/4	Grand Mesa Operating Company 1700 N. Waterfront Pkwy, Bldg 600 Wichita, KS 67206-5514	Operator: Hess #1-32

## Township 14 South, Range 31 West

Sec. 5:	NE/4	Ritchie Exploration, Inc. P.O. Box 783188 Wichita, KS 67278-3188	Operator: #1 Steckel Unit, #1 Steckel 5A SWD
	NW/4	Ritchie Exploration, Inc. P.O. Box 783188 Wichita, KS 67278-3188	Operator: #1 Steckel Unit
	S/2	Ray Dean Stucky, Mary Ann Stucky, Lois J. Stucky, Carol Sue Stucky, Mary Bohnenblust c/o Mary Bohnenblust 1720 W. Kansas Ave. McPherson, KS 67640	Landowners

**AFFIDAVIT**

STATE OF KANSAS            )  
  - SS.  
County of Sedgwick         )

Peter Fiorini, of lawful age, being first duly sworn, deposes and saith: That he is Production/Development Geologist of Ritchie Exploration, County of Sedgwick, State of Kansas, and that notice was given to all lessee of record or operator within ½ mile radius of the Steckel Unit #1 well located in the County of Gove (see attached plat map). This notice included a letter and a copy of the Commingle Application (ACO-4). All notices were mailed on October 28, 2015.

made as aforesaid on the 28<sup>th</sup> of

October A.D. **2015**

And affiant further says that he has personal knowledge of the statements above set forth and that they are true.

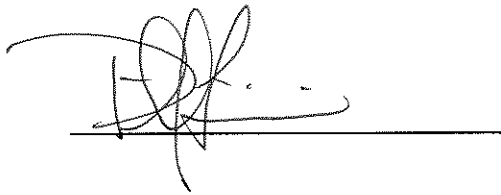

Subscribed and sworn to before me this

28<sup>th</sup> day of October 2015

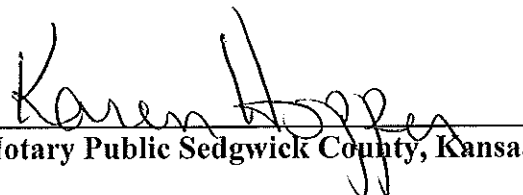

  
Notary Public Sedgwick County, Kansas

**AFFIDAVIT OF PUBLICATION**  
State of Kansas,  
Gove County, ss:

Roxanne Broeckelman,  
being first duly sworn, deposes and  
says: That she is  
co-publisher of

**Gove County Advocate**, a weekly  
newspaper printed in the State of  
Kansas, and published in and of  
general circulation in Gove County,  
Kansas, with a general paid  
circulation on a weekly basis in  
Gove County, Kansas, and that said  
newspaper is not a trade, religious  
or fraternal publication.

Said newspaper is a weekly  
published at least 50 times a year;  
and has been so published  
continuously and uninterruptedly in  
said county and state for a period of  
more than five years prior to the first  
publication of said notice; and has  
been admitted at the post office in  
Quinter in said county as periodical  
class mail matter.

That the attached notice is a true  
copy thereof and was published in  
the regular and entire issue of said  
newspaper for one  
consecutive week(s), the first  
publication thereof being made as  
aforesaid on the 20th day  
of January, 2016,  
with subsequent publications being  
made on the following dates:

\_\_\_\_\_, \_\_\_\_\_  
\_\_\_\_\_, \_\_\_\_\_  
\_\_\_\_\_, \_\_\_\_\_  
\_\_\_\_\_, \_\_\_\_\_  
\_\_\_\_\_, \_\_\_\_\_  
\_\_\_\_\_, \_\_\_\_\_

Printer's Fee .....\$ 19.20  
Additional Copies .....\$ \_\_\_\_\_  
Affidavit Fees .....\$ 2.00  
Total Publication Fees \$21.20

*Roxanne Broeckelman*

Subscribed and sworn to before me  
this 20th day of  
January, 2016

*Linda L. Zerr*  
Notary Public

My commission expires:  
January 8, 2017

**LEGAL ADVERTISING**  
(Published in the Gove County Advocate, Quinter,  
KS, Wed., January 20, 2016 - 11)  
**LEGAL NOTICE**  
You, and each of you, are hereby notified that  
Ritchie Exploration, Inc. has filed an application  
to commence the commingling of production from  
the Johnson and Morrow Sand sources of supply  
for the #1 Steckel Unit well located approx. N/2  
S/2 N/2 of Section 5-14S-31W, Gove County,  
Kansas.  
Any persons who object to or protest this ap-  
plication shall be required to file their objections  
or protests with the Conservation Division of the  
State Corporation Commission of the State of  
Kansas within fifteen (15) days from the date of  
the publication. These protests shall be filed pur-  
suant to Commission regulations and must state  
specific reasons why the grant of the application  
may cause waste, violate correlative rights or pol-  
lute the natural resources of the state of Kansas.  
If no protests are received, this application may  
be granted through a summary proceeding. If  
valid protests are received, this matter will be set  
for hearing.  
All persons interested or concerned shall take  
notice of the foregoing and shall govern them-  
selves accordingly.  
**RITCHIE EXPLORATION, INC.**  
P.O. Box 783188  
Wichita, KS 67278-3188  
(316) 691-9500

LINDA L. ZERR  
NOTARY PUBLIC  
STATE OF KANSAS  
My Appl. Exp. 1-8-2017



# LEGAL PROOF OF PUBLICATION

Account #	Ad Number	Identification	PO	Amount	Cols	Lines
453699	0002215133	Published in the Wichita Eagle January 18,		\$129.00	1	35

**Attention:** karen hopper  
 RITCHIE EXPLORATION INC  
 P O BOX 783188  
 WICHITA, KS 672783188

In The STATE OF KANSAS  
 In and for the County of Sedgwick  
 AFFIDAVIT OF PUBLICATION

1 Insertions

Beginning issue of: 01/18/2016

Ending issue of: 01/18/2016

STATE OF KANSAS)  
 .SS  
 County of Sedgwick)

**LEGAL PUBLICATION**

Published in the Wichita Eagle January 18, 2016 (215133)

**LEGAL NOTICE**

You, and each of you, are hereby notified that Ritchie Exploration, Inc. has filed an application to commence the commencing of production from the Johnson and Morrow Sand sources of supply for the #1 Stecker Unit well located approx. N/2 S/2 N/2 of Section 5-165-31W, Gore County, Kansas.

Any persons who object to or protest this application shall be required to file their objections or protests with the Conservation Division of the State Corporation Commission of the State of Kansas within fifteen (15) days from the date of the publication. These protests shall be filed pursuant to Commission regulations and must state specific reasons why the grant of the application may cause waste, violate correlative rights or pollute the natural resources of the state of Kansas.

If no protests are received, this application may be granted through a summary proceeding. If valid protests are received, this matter will be set for hearing.

All persons interested or concerned shall take notice of the foregoing and shall govern themselves accordingly.

RITCHIE EXPLORATION, INC.  
 P.O. Box 783188  
 Wichita, KS 67278-3188  
 (316) 691-9500

Mark Fletchall, of lawful age, being first duly sworn, deposeth and saith: That he is Record Clerk of The Wichita Eagle, a daily newspaper published in the City of Wichita, County of Sedgwick, State of Kansas, and having a general paid circulation on a daily basis in said County, which said newspaper has been continuously and uninterruptedly published in said County for more than one year prior to the first publication of the notice hereinafter mentioned, and which said newspaper has been entered as second class mail matter at the United States Post Office in Wichita, Kansas, and which said newspaper is not a trade, religious or fraternal publication and that a notice of a true copy is hereto attached was published in the regular and entire Morning issue of said The Wichita Eagle from 1/18/2016 to 01/18/2016.

I certify (or declare) under the penalty of perjury that the foregoing is true and correct.

*Mark Fletchall*

(Signature of Principal Clerk)  
 DATED: 1/18/2016

*JBA*

Notary Public Sedgwick County, Kansas

JENNIFER RAE BAILEY  
 Notary Public - State of Kansas  
 My Appt. Expires 6/19/2017

Confidentiality Requested:

Yes  No

KANSAS CORPORATION COMMISSION 1172793  
OIL & GAS CONSERVATION DIVISION

Form ACO-1  
August 2013  
Form must be Typed  
Form must be Signed  
All blanks must be Filled

# CONFIDENTIAL WELL COMPLETION FORM

## WELL HISTORY - DESCRIPTION OF WELL & LEASE

OPERATOR: License # 4767

Name: Ritchie Exploration, Inc.

Address 1: 8100 E 22ND ST N # 700

Address 2: BOX 783188

City: WICHITA State: KS Zip: 67278 + 3188

Contact Person: Peter Fiorini

Phone: ( 316 ) 691-9500

CONTRACTOR: License # 6426

Name: Express Well Service & Supply Inc

Wellsite Geologist: Peter Fiorini

Purchaser: NCRA

Designate Type of Completion:

- New Well
- Re-Entry
- Workover
- Oil
- WSW
- SWD
- SIOW
- Gas
- D&A
- ENHR
- SIGW
- OG
- GSW
- Temp. Abd.
- CM (Coal Bed Methane)
- Cathodic
- Other (Core, Expl., etc.): \_\_\_\_\_

If Workover/Re-entry: Old Well Info as follows:

Operator: Ritchie Exploration, Inc.

Well Name: Steckel Unit

Original Comp. Date: 3/26/2010 Original Total Depth: 4680

- Deepening
- Re-perf.
- Conv. to ENHR
- Conv. to SWD
- Plug Back
- Conv. to GSW
- Conv. to Producer
- Commingled
- Permit #: \_\_\_\_\_
- Dual Completion
- Permit #: \_\_\_\_\_
- SWD
- Permit #: \_\_\_\_\_
- ENHR
- Permit #: \_\_\_\_\_
- GSW
- Permit #: \_\_\_\_\_

<u>10/14/2013</u>	<u>10/14/2013</u>	<u>10/17/2013</u>
Spud Date or Recompletion Date	Date Reached TD	Completion Date or Recompletion Date

API No. 15 - 15-063-21829-00-01

Spot Description: 125N & 20'E of N2S2N2

NW NW SW NE Sec. 5 Twp. 14 S. R. 31  East  West

1525 Feet from  North /  South Line of Section

2660 Feet from  East /  West Line of Section

Footages Calculated from Nearest Outside Section Corner:

- NE
- NW
- SE
- SW

GPS Location: Lat: \_\_\_\_\_, Long: \_\_\_\_\_  
(e.g. xx.xxxxx) (e.g. -xxx.xxxxx)

Datum:  NAD27  NAD83  WGS84

County: Gove

Lease Name: Steckel Unit Well #: 1

Field Name: Gaeland Township

Producing Formation: Morrow Sand, Johnson

Elevation: Ground: 2957 Kelly Bushing: 2967

Total Vertical Depth: 4680 Plug Back Total Depth: 4647

Amount of Surface Pipe Set and Cemented at: 214 Feet

Multiple Stage Cementing Collar Used?  Yes  No

If yes, show depth set: 2418 Feet

If Alternate II completion, cement circulated from: 2418

feet depth to: 0 w/ 325 sx cmt.

### Drilling Fluid Management Plan

(Data must be collected from the Reserve Pit)

Chloride content: \_\_\_\_\_ ppm Fluid volume: \_\_\_\_\_ bbls

Dewatering method used: \_\_\_\_\_

Location of fluid disposal if hauled offsite: \_\_\_\_\_

Operator Name: \_\_\_\_\_

Lease Name: \_\_\_\_\_ License #: \_\_\_\_\_

Quarter \_\_\_\_\_ Sec. \_\_\_\_\_ Twp. \_\_\_\_\_ S. R. \_\_\_\_\_  East  West

County: \_\_\_\_\_ Permit #: \_\_\_\_\_

### AFFIDAVIT

I am the affiant and I hereby certify that all requirements of the statutes, rules and regulations promulgated to regulate the oil and gas industry have been fully complied with and the statements herein are complete and correct to the best of my knowledge.

Submitted Electronically

### KCC Office Use ONLY

- Confidentiality Requested
- Date: 12/16/2013
- Confidential Release Date: \_\_\_\_\_
- Wireline Log Received
- Geologist Report Received
- UIC Distribution
- ALT  I  II  III Approved by: NAOMI JAMES Date: 12/17/2013

1172793

Operator Name: Ritchie Exploration, Inc. Lease Name: Steckel Unit Well #: 1  
 Sec. 5 Twp. 14 S. R. 31  East  West County: Gove

**INSTRUCTIONS:** Show important tops of formations penetrated. Detail all cores. Report all final copies of drill stems tests giving interval tested, time tool open and closed, flowing and shut-in pressures, whether shut-in pressure reached static level, hydrostatic pressures, bottom hole temperature, fluid recovery, and flow rates if gas to surface test, along with final chart(s). Attach extra sheet if more space is needed.

Final Radioactivity Log, Final Logs run to obtain Geophysical Data and Final Electric Logs must be emailed to kcc-well-logs@kcc.ks.gov. Digital electronic log files must be submitted in LAS version 2.0 or newer AND an image file (TIFF or PDF).

Drill Stem Tests Taken <i>(Attach Additional Sheets)</i>	<input type="checkbox"/> Yes <input checked="" type="checkbox"/> No	<input checked="" type="checkbox"/> Log	Formation (Top), Depth and Datum	<input type="checkbox"/> Sample
Samples Sent to Geological Survey	<input type="checkbox"/> Yes <input checked="" type="checkbox"/> No	Name Attached	Top Attached	Datum Attached
Cores Taken	<input type="checkbox"/> Yes <input checked="" type="checkbox"/> No			
Electric Log Run	<input type="checkbox"/> Yes <input checked="" type="checkbox"/> No			
List All E. Logs Run:				

CASING RECORD <input type="checkbox"/> New <input type="checkbox"/> Used							
Report all strings set-conductor, surface, intermediate, production, etc.							
Purpose of String	Size Hole Drilled	Size Casing Set (In O.D.)	Weight Lbs. / Ft.	Setting Depth	Type of Cement	# Sacks Used	Type and Percent Additives
Surface	12.25	8.625	23	214	common	175	3%cc,2%gel
Production	7.875	5.5	15.5	4674	ASC	175	10% sa,2% gel & 5# per sack fo-ssal

ADDITIONAL CEMENTING / SQUEEZE RECORD				
Purpose:	Depth Top Bottom	Type of Cement	# Sacks Used	Type and Percent Additives
<input type="checkbox"/> Perforate				
<input type="checkbox"/> Protect Casing	-			
<input type="checkbox"/> Plug Back TD				
<input type="checkbox"/> Plug Off Zone	-			

Did you perform a hydraulic fracturing treatment on this well?  Yes  No *(If No, skip questions 2 and 3)*  
 Does the volume of the total base fluid of the hydraulic fracturing treatment exceed 350,000 gallons?  Yes  No *(If No, skip question 3)*  
 Was the hydraulic fracturing treatment information submitted to the chemical disclosure registry?  Yes  No *(If No, fill out Page Three of the ACO-1)*

Shots Per Foot	PERFORATION RECORD - Bridge Plugs Set/Type Specify Footage of Each Interval Perforated	Acid, Fracture, Shot, Cement Squeeze Record <i>(Amount and Kind of Material Used)</i>	Depth
4	4593-4609	1500 Gals 7.5% NE/FE 40 Sol Perf Balls	

TUBING RECORD: Size: 2.875 Set At: 4519 Packer At: \_\_\_\_\_ Liner Run:  Yes  No

Date of First, Resumed Production, SWD or ENHR. 10/17/2013  
 Producing Method:  Flowing  Pumping  Gas Lift  Other *(Explain)* \_\_\_\_\_  
 Estimated Production Per 24 Hours: Oil 8.35 Bbls. Gas 1.5 Mcf Water 1.5 Bbls. Gas-Oil Ratio \_\_\_\_\_ Gravity 29

DISPOSITION OF GAS: <input type="checkbox"/> Vented <input type="checkbox"/> Sold <input type="checkbox"/> Used on Lease <i>(If vented, Submit ACO-18.)</i>	METHOD OF COMPLETION: <input type="checkbox"/> Open Hole <input checked="" type="checkbox"/> Perf. <input type="checkbox"/> Dually Comp. <input checked="" type="checkbox"/> Commingled <i>(Submit ACO-5)</i> <input type="checkbox"/> Other <i>(Specify)</i> _____	PRODUCTION INTERVAL: _____ _____
---	--	--



Form	ACO1 - Well Completion
Operator	Ritchie Exploration, Inc.
Well Name	Steckel Unit 1
Doc ID	1172793

Tops

Name	Top	Datum
Anhydrite	2447	+520
B/Anhydrite	2471	+496
Heebner	3960	-993
Toronto	3986	-1016
Lansing	4003	-1036
BKC	4315	-1348
Marmaton	4351	-1384
Altamont	4364	-1397
Pawnee	4442	-1475
Cherokee Shale	4526	-1559
Johnson	4567	-1600
Morrow Sand	4603	-1636
Mississippian	4614	-1647

Conservation Division  
266 N. Main St., Ste. 220  
Wichita, KS 67202-1513



Phone: 316-337-6200  
Fax: 316-337-6211  
<http://kcc.ks.gov/>

Jay Scott Emler, Chairman  
Shari Feist Albrecht, Commissioner  
Pat Apple, Commissioner

Sam Brownback, Governor

February 10, 2016

Peter Fiorini  
Ritchie Exploration, Inc.  
P.O. Box 783188  
Wichita, KS 67278-3188

RE: Approved Commingling CO021601  
Steckel Unit 1  
API No. 15-101-21829-00-01

Dear Mr. Fiorini:

Your Application for Commingling (ACO-4) for the above described well has been reviewed and approved by the Kansas Corporation Commission (KCC) per K.A.R. 82-3-123. Notice was examined and found to be proper per K.A.R. 82-3-135a. No protest had been filed within the 15-day protest period.

Based upon the depth of the Morrow Sand formation perforations, total oil production shall not exceed 200 BOPD and total gas production shall not exceed 50% of the absolute open flow (AOF).

Sincerely,

Rick Hestermann  
Production Department