



KANSAS CORPORATION COMMISSION 1294809  
OIL & GAS CONSERVATION DIVISION

Form ACO-4  
Form must be typed  
March 2009

APPLICATION FOR COMMINGLING OF *Commingling ID #* \_\_\_\_\_  
PRODUCTION (K.A.R. 82-3-123) OR FLUIDS (K.A.R. 82-3-123a)

OPERATOR: License # \_\_\_\_\_ API No. 15 - \_\_\_\_\_  
Name: \_\_\_\_\_ Spot Description: \_\_\_\_\_  
Address 1: \_\_\_\_\_ - - - - - Sec. \_\_\_\_\_ Twp. \_\_\_\_\_ S. R. \_\_\_\_\_  East  West  
Address 2: \_\_\_\_\_ Feet from  North /  South Line of Section  
City: \_\_\_\_\_ State: \_\_\_\_\_ Zip: \_\_\_\_\_ + \_\_\_\_\_ Feet from  East /  West Line of Section  
Contact Person: \_\_\_\_\_ County: \_\_\_\_\_  
Phone: ( \_\_\_\_\_ ) \_\_\_\_\_ Lease Name: \_\_\_\_\_ Well #: \_\_\_\_\_

1. Name and upper and lower limit of each production interval to be commingled:  
Formation: \_\_\_\_\_ (Perfs): \_\_\_\_\_  
Formation: \_\_\_\_\_ (Perfs): \_\_\_\_\_  
Formation: \_\_\_\_\_ (Perfs): \_\_\_\_\_  
Formation: \_\_\_\_\_ (Perfs): \_\_\_\_\_  
Formation: \_\_\_\_\_ (Perfs): \_\_\_\_\_

2. Estimated amount of fluid production to be commingled from each interval:  
Formation: \_\_\_\_\_ BOPD: \_\_\_\_\_ MCFPD: \_\_\_\_\_ BWPD: \_\_\_\_\_  
Formation: \_\_\_\_\_ BOPD: \_\_\_\_\_ MCFPD: \_\_\_\_\_ BWPD: \_\_\_\_\_  
Formation: \_\_\_\_\_ BOPD: \_\_\_\_\_ MCFPD: \_\_\_\_\_ BWPD: \_\_\_\_\_  
Formation: \_\_\_\_\_ BOPD: \_\_\_\_\_ MCFPD: \_\_\_\_\_ BWPD: \_\_\_\_\_  
Formation: \_\_\_\_\_ BOPD: \_\_\_\_\_ MCFPD: \_\_\_\_\_ BWPD: \_\_\_\_\_

3. Plat map showing the location of the subject well, all other wells on the subject lease, and all wells on offsetting leases within a 1/2 mile radius of the subject well, and for each well the names and addresses of the lessee of record or operator.

4. Signed certificate showing service of the application and affidavit of publication as required in K.A.R. 82-3-135a.

**For Commingling of PRODUCTION ONLY, include the following:**

- 5. Wireline log of subject well. Previously Filed with ACO-1:  Yes  No
- 6. Complete Form ACO-1 (*Well Completion form*) for the subject well.

**For Commingling of FLUIDS ONLY, include the following:**

- 7. Well construction diagram of subject well.
- 8. Any available water chemistry data demonstrating the compatibility of the fluids to be commingled.

**AFFIDAVIT:** I am the affiant and hereby certify that to the best of my current information, knowledge and personal belief, this request for commingling is true and proper and I have no information or knowledge, which is inconsistent with the information supplied in this application.

Submitted Electronically

**KCC Office Use Only**  
 Denied  Approved  
15-Day Periods Ends: \_\_\_\_\_  
Approved By: \_\_\_\_\_ Date: \_\_\_\_\_

*Protests may be filed by any party having a valid interest in the application. Protests must be in writing and comply with K.A.R. 82-3-135b and must be filed within 15 days of publication of the notice of application.*

R 22 W

T  
25  
S

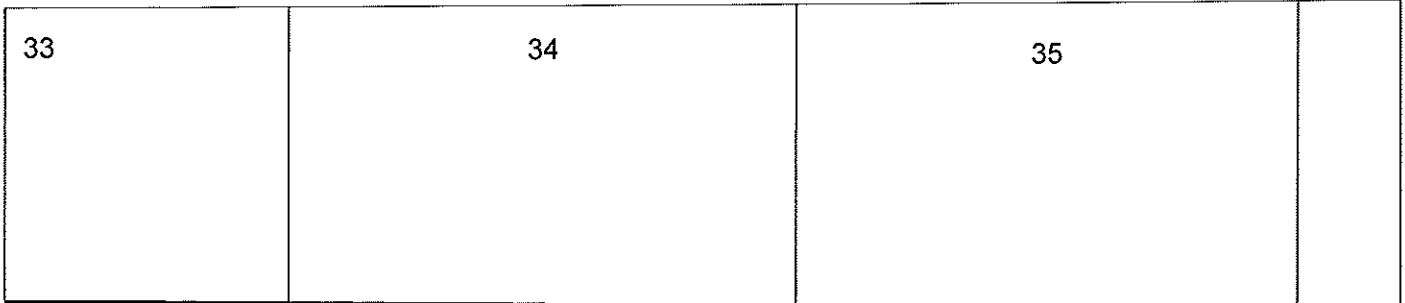

T  
26  
S

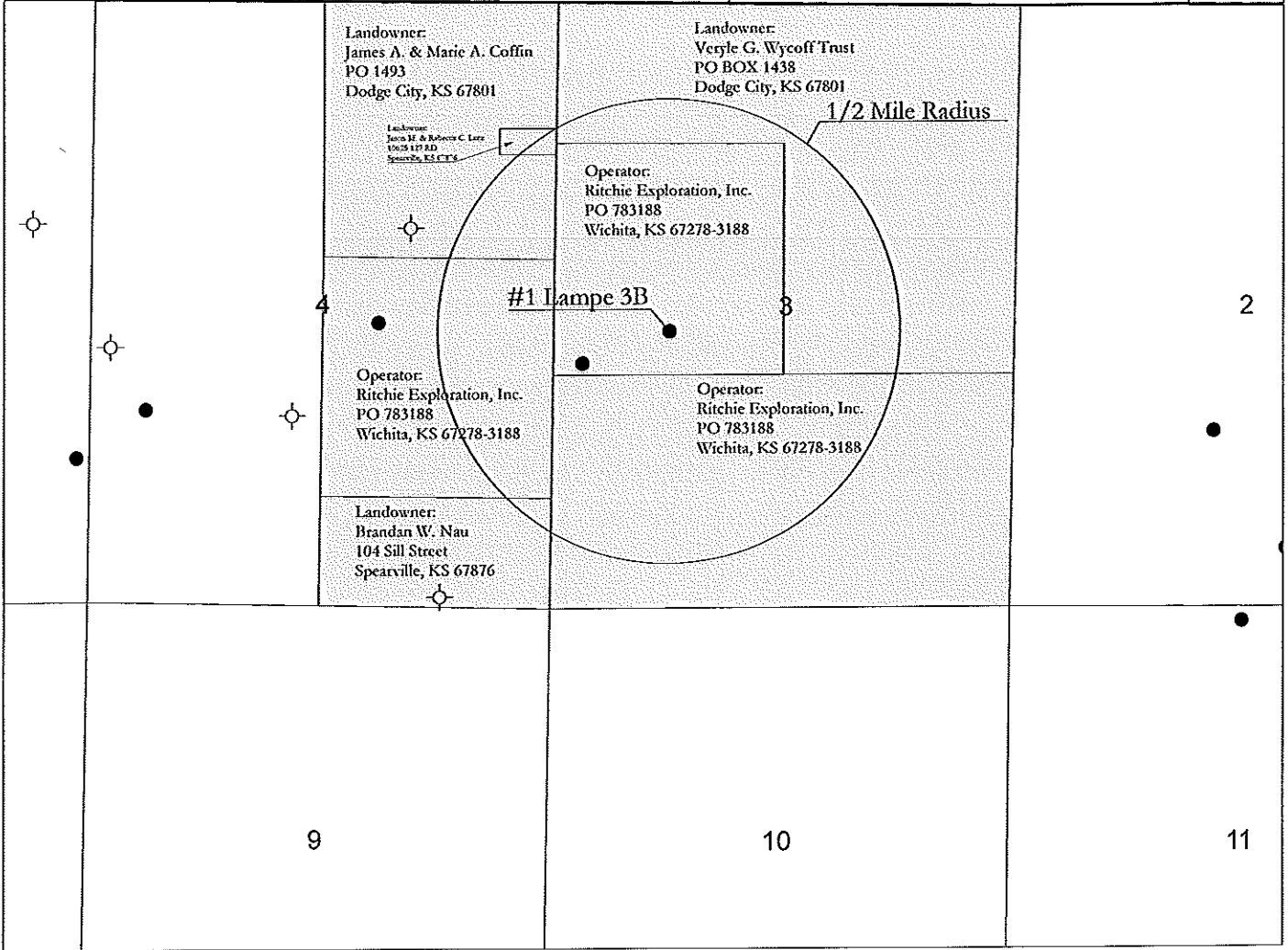

Legend

- Oil Well
- ⊕ Dry and Abandoned Well



**RITCHIE**  
EXPLORATION, INC.  
Wichita, Kansas

Application for  
Commingling of  
Production or Fluids

Applicant Well: #1 Lampe 3B  
All Wells on Offsetting Leases within 1/2 Mile Radius  
Name and Address of Lessee of Record or Operator  
On Offsetting Leases

Ford County, Kansas		
Prepared By: Justin Clegg	Scale: 1 : 24,000	Date: October 26, 2015

# APPLICATION FOR COMMINGLING OF PRODUCTION OR FLUIDS

**Operator, Lessee or Unleased Mineral Owner  
within a ½ mile radius of Ritchie Exploration, Inc.'s**

**#1 Lampe 3B  
3410' FSL & 1320' FWL of Irregular Section  
Section 3-26S-22W  
Ford Co., KS**

## Township 26 South, Range 22 West

Sec. 3: E/2N/2; Lots 3 & 4, ex. the S. 80 acres	Veryle G. Wycoff Trust PO Box 1438 Dodge City, KS 67801	Landowner
S. 80 acres of Lots 3 & 4; S/2NW/4	Ritchie Exploration, Inc. P.O. Box 783188 Wichita, KS 67278-3188	Operator: #1 Lampe-Heskamp; #1 Lampe 3B
S/2	Ritchie Exploration, Inc.	Operator: #1 Lampe-Heskamp
Sec. 4: Lots 1 & 2, ex. 4.4 acre tract	James A. & Marie A. Coffin PO Box 1493 Dodge City, KS 67801	Landowners
4.4 acre tract in Lot 1	Jason M. & Rebecca C. Lutz 10625 127 RD Spearville, KS 67876	Landowner
S/2NE/4; N/2SE/4	Ritchie Exploration, Inc.	Operator: #1 Imel
S/2SE/4	Brandan W. Nau 104 Sill Street Spearville, KS 67876	Landowner

**AFFIDAVIT**

STATE OF KANSAS        )  
                                  - SS.  
County of Sedgwick     )

Peter Fiorini, of lawful age, being first duly sworn, deposeth and saith: That he is Production/Development Geologist of Ritchie Exploration, County of Sedgwick, State of Kansas, and that notice was given to all lessee of record or operator within ½ mile radius of the Lampe 3B #1 well located in the County of Ford (see attached plat map). This notice included a letter and a copy of the Commingle Application (ACO-4). All notices were mailed on October 28, 2015.

made as aforesaid on the 28<sup>th</sup> of

October A.D. 2015

And affiant further says that he has personal knowledge of the statements above set forth and that they are true.

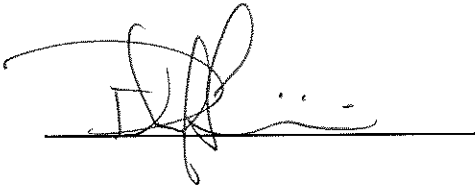

Subscribed and sworn to before me this

28<sup>th</sup> day of October 2015



  
\_\_\_\_\_  
Notary Public Sedgwick County, Kansas



Confidentiality Requested:

Yes  No

KANSAS CORPORATION COMMISSION 1175728  
OIL & GAS CONSERVATION DIVISION

Form ACO-1  
August 2013  
Form must be Typed  
Form must be Signed  
All blanks must be Filled

# CONFIDENTIAL WELL COMPLETION FORM

## WELL HISTORY - DESCRIPTION OF WELL & LEASE

OPERATOR: License # 4767  
Name: Ritchie Exploration, Inc.  
Address 1: 8100 E 22ND ST N # 700  
Address 2: BOX 783188  
City: WICHITA State: KS Zip: 67278 + 3188  
Contact Person: Peter Fiorini  
Phone: ( 316 ) 691-9500  
CONTRACTOR: License # 5822  
Name: Val Energy, Inc.  
Wellsite Geologist: Adam Eldani  
Purchaser: NCRA

Designate Type of Completion:

- New Well  Re-Entry  Workover
- Oil  WSW  SWD  SIOW  
 Gas  D&A  ENHR  SIGW  
 OG  GSW  Temp. Abd.  
 CM (Coal Bed Methane)  
 Cathodic  Other (Core, Expl., etc.): \_\_\_\_\_

If Workover/Re-entry: Old Well Info as follows:

Operator: \_\_\_\_\_

Well Name: \_\_\_\_\_

Original Comp. Date: \_\_\_\_\_ Original Total Depth: \_\_\_\_\_

- Deepening  Re-perf.  Conv. to ENHR  Conv. to SWD  
 Plug Back  Conv. to GSW  Conv. to Producer
- Commingled Permit #: \_\_\_\_\_  
 Dual Completion Permit #: \_\_\_\_\_  
 SWD Permit #: \_\_\_\_\_  
 ENHR Permit #: \_\_\_\_\_  
 GSW Permit #: \_\_\_\_\_

<u>09/27/2013</u>	<u>10/08/2013</u>	<u>10/08/2013</u>
Spud Date or Recompletion Date	Date Reached TD	Completion Date or Recompletion Date

API No. 15 - 15-057-20912-00-00

Spot Description: \_\_\_\_\_

N2 S2 S2 NW Sec. 3 Twp. 26 S. R. 22  East  West

3140 Feet from  North /  South Line of Section

1320 Feet from  East /  West Line of Section

Footages Calculated from Nearest Outside Section Corner:

NE  NW  SE  SW

GPS Location: Lat: \_\_\_\_\_, Long: \_\_\_\_\_  
(e.g. xx.xxxxx) (e.g. -xxx.xxxxx)

Datum:  NAD27  NAD83  WGS84

County: Ford

Lease Name: Lampe 3B Well #: 1

Field Name: \_\_\_\_\_

Producing Formation: Altamont B & Huck

Elevation: Ground: 2401 Kelly Bushing: 2411

Total Vertical Depth: 5000 Plug Back Total Depth: 4972

Amount of Surface Pipe Set and Cemented at: 358 Feet

Multiple Stage Cementing Collar Used?  Yes  No

If yes, show depth set: 1429 Feet

If Alternate II completion, cement circulated from: 0

feet depth to: 1429 w/ 250 sx cmt.

### Drilling Fluid Management Plan

*(Data must be collected from the Reserve Pit)*

Chloride content: 13700 ppm Fluid volume: 1100 bbls

Dewatering method used: Evaporated

Location of fluid disposal if hauled offsite: \_\_\_\_\_

Operator Name: \_\_\_\_\_

Lease Name: \_\_\_\_\_ License #: \_\_\_\_\_

Quarter \_\_\_\_\_ Sec. \_\_\_\_\_ Twp. \_\_\_\_\_ S. R. \_\_\_\_\_  East  West

County: \_\_\_\_\_ Permit #: \_\_\_\_\_

### AFFIDAVIT

I am the affiant and I hereby certify that all requirements of the statutes, rules and regulations promulgated to regulate the oil and gas industry have been fully complied with and the statements herein are complete and correct to the best of my knowledge.

Submitted Electronically

### KCC Office Use ONLY

- Confidentiality Requested  
Date: 01/06/2014
- Confidential Release Date: \_\_\_\_\_
- Wireline Log Received
- Geologist Report Received
- UIC Distribution
- ALT  I  II  III Approved by: NAOMI JAMES Date: 01/07/2014

1183973

Operator Name: Ritchie Exploration, Inc. Lease Name: Lampe 3B Well #: 1  
 Sec. 3 Twp. 26 S. R. 22  East  West County: Ford

**INSTRUCTIONS:** Show important tops of formations penetrated. Detail all cores. Report all final copies of drill stems tests giving interval tested, time tool open and closed, flowing and shut-in pressures, whether shut-in pressure reached static level, hydrostatic pressures, bottom hole temperature, fluid recovery, and flow rates if gas to surface test, along with final chart(s). Attach extra sheet if more space is needed.

Final Radioactivity Log, Final Logs run to obtain Geophysical Data and Final Electric Logs must be emailed to kcc-well-logs@kcc.ks.gov. Digital electronic log files must be submitted in LAS version 2.0 or newer AND an image file (TIFF or PDF).

Drill Stem Tests Taken (Attach Additional Sheets)	<input checked="" type="checkbox"/> Yes <input type="checkbox"/> No	<input type="checkbox"/> Log Formation (Top), Depth and Datum	<input checked="" type="checkbox"/> Sample
Samples Sent to Geological Survey	<input checked="" type="checkbox"/> Yes <input type="checkbox"/> No	Name	Top Datum
Cores Taken	<input type="checkbox"/> Yes <input checked="" type="checkbox"/> No	See Attached	
Electric Log Run	<input checked="" type="checkbox"/> Yes <input type="checkbox"/> No		
List All E. Logs Run:			
Compensated Density/Neutron Log Dual Induction Log			

CASING RECORD <input checked="" type="checkbox"/> New <input type="checkbox"/> Used							
Report all strings set-conductor, surface, intermediate, production, etc.							
Purpose of String	Size Hole Drilled	Size Casing Set (In O.D.)	Weight Lbs. / Ft.	Setting Depth	Type of Cement	# Sacks Used	Type and Percent Additives
Surface	12.25	8.625	23	358	Class A	225	3% cc, 2% gel
Production	7.875	4.5	10.5	4990	OWC	200	10% sa1, 2% gel, .25% CDI-26

ADDITIONAL CEMENTING / SQUEEZE RECORD				
Purpose:	Depth Top Bottom	Type of Cement	# Sacks Used	Type and Percent Additives
___ Perforate				
___ Protect Casing	-			
___ Plug Back TD				
___ Plug Off Zone	-			

Did you perform a hydraulic fracturing treatment on this well?  Yes  No (If No, skip questions 2 and 3)  
 Does the volume of the total base fluid of the hydraulic fracturing treatment exceed 350,000 gallons?  Yes  No (If No, skip question 3)  
 Was the hydraulic fracturing treatment information submitted to the chemical disclosure registry?  Yes  No (If No, fill out Page Three of the ACO-1)

Shots Per Foot	PERFORATION RECORD - Bridge Plugs Set/Type Specify Footage of Each Interval Perforated	Acid, Fracture, Shot, Cement Squeeze Record (Amount and Kind of Material Used)	Depth
4	4839'-4843', 4845'-4849' (10/28/13)	1250 gals 15% NE	
4	4673'-4681' (10/28/13)	750 gals 15% NE	

TUBING RECORD:	Size: <u>2.38</u>	Set At: <u>4941</u>	Packer At:	Liner Run: <input type="checkbox"/> Yes <input checked="" type="checkbox"/> No
Date of First, Resumed Production, SWD or ENHR. <u>11/20/2013</u>	Producing Method: <input type="checkbox"/> Flowing <input checked="" type="checkbox"/> Pumping <input type="checkbox"/> Gas Lift <input type="checkbox"/> Other (Explain) _____			
Estimated Production Per 24 Hours	Oil Bbls. <u>47.23</u>	Gas Mcf	Water Bbls. <u>0</u>	Gas-Oil Ratio <u>22</u>

DISPOSITION OF GAS: <input type="checkbox"/> Vented <input type="checkbox"/> Sold <input type="checkbox"/> Used on Lease (If vented, Submit ACO-18.)	METHOD OF COMPLETION: <input type="checkbox"/> Open Hole <input checked="" type="checkbox"/> Perf. <input type="checkbox"/> Dually Comp. <input type="checkbox"/> Commingled (Submit ACO-5)	PRODUCTION INTERVAL: _____ _____
	<input type="checkbox"/> Other (Specify) _____	



**#1 Lampe 3B**  
3140' FSL & 1320' FWL  
Irregular Section - Section 3-26S-22W  
Ford County, Kansas  
API# 15-057-20912-00-00  
Elevation: 2401' GL, 2411' KB

Sample Tops			Ref. Well
Anhydrite	1487'	+924	-6
B/Anhydrite	1519'	+892	-6
Stotler	3484'	-1073	+1
Heebner	4105'	-1694	Flat
Lansing	4217'	-1806	-1
Muncie Shale	4395'	-1984	-6
Stark Shale	4513'	-2102	-7
Hush	4562'	-2151	-3
BKC	4596'	-2185	Flat
Marmaton	4600'	-2189	Flat
Altamont	4650'	-2239	-4
Pawnee	4715'	-2304	+3
Fort Scott	4745'	-2334	+3
Cherokee Shale	4769'	-2358	Flat
Huck	4836'	-2425	-1
Atoka	4854'	-2443	-4
Mississippian	4906'	-2495	-9
RTD	5000'	-2589	

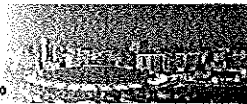

# LEGAL PROOF OF PUBLICATION

Account #	Ad Number	Identification	PO	Amount	Cols	Lines
453699	0002215145	Published in the Wichita Eagle January 18,		\$129.00	1	35

**Attention:** karen hopper

RITCHIE EXPLORATION INC  
P O BOX 783188  
WICHITA, KS 672783188

In The STATE OF KANSAS  
In and for the County of Sedgwick  
AFFIDAVIT OF PUBLICATION

1 Insertions

Beginning issue of: 01/18/2016

Ending Issue of: 01/18/2016

STATE OF KANSAS)

.SS

County of Sedgwick)

**LEGAL PUBLICATION**

Published in the Wichita Eagle  
January 18, 2016 (2215145)

**LEGAL NOTICE**

You, and each of you, are hereby notified that Ritchie Exploration, Inc. has filed an application to commence the commingling of production from the Huck and Allamont B sources of supply for the #1 Lange SB well located approx. N/2S/2S/2 NW of Section 3-265-22W, Ford County, Kansas. Any persons who object to or protest this application shall be required to file their objections or protests with the Conservation Division of the State Corporation Commission of the State of Kansas within fifteen (15) days from the date of the publication. These protests shall be filed pursuant to Commission regulations and must state specific reasons why the grant of the application may cause waste, violate correlative rights or pollute the natural resources of the state of Kansas. If no protests are received, this application may be granted through a summary proceeding. If valid protests are received, this matter will be set for hearing.

All persons interested or concerned shall take notice of the foregoing and shall govern themselves accordingly.

RITCHIE EXPLORATION, INC.  
P.O. Box 783188  
Wichita, KS 67278-3188  
(316) 691-9500

Mark Fletchall, of lawful age, being first duly sworn, deposeth and saith: That he is Record Clerk of The Wichita Eagle, a daily newspaper published in the City of Wichita, County of Sedgwick, State of Kansas, and having a general paid circulation on a daily basis in said County, which said newspaper has been continuously and uninterruptedly published in said County for more than one year prior to the first publication of the notice hereinafter mentioned, and which said newspaper has been entered as second class mail matter at the United States Post Office in Wichita, Kansas, and which said newspaper is not a trade, religious or fraternal publication and that a notice of a true copy is hereto attached was published in the regular and entire Morning issue of said The Wichita Eagle from 1/18/2016 to 01/18/2016.

I certify (or declare) under the penalty of perjury that the foregoing is true and correct.

*Mark Fletchall*

(Signature of Principal Clerk)

DATED: 1/18/2016

*Jennifer Rae Bailey*  
Notary Public Sedgwick County, Kansas

JENNIFER RAE BAILEY  
Notary Public State of Kansas  
My Appt. Expires: 6/14/2017



Proof of Publication  
State of Kansas, Ford County, SS.

Dodge City Daily Globe

Ritchie Exploration, Inc.  
P.O. Box 783188  
Wichita, Ks 67278

Reference: 93565 Account: 114170  
Case No. #1Lamp3B

Ed O'Neal of lawful age, being duly sworn upon oath, states that he is the Circulation Manager of the DODGE CITY DAILY GLOBE.

THAT said newspaper has been published at least weekly fifty (50) times a year and has been so published for at least five years prior to the first publication of the attached notice;

THAT said paper was entered as second-class mail matter at the post office of its publication;

THAT said paper has a general paid circulation on a daily, or weekly, or yearly basis in FORD COUNTY KANSAS, and is NOT a trade, religious or fraternal publication and has been PRINTED and published in FORD COUNTY, KANSAS.

THE ATTACHED was published on the following dates in a regular issue of said paper:

(Sign) *Ed O'Neal*

PUBLISHED ON: 01/16/16  
TOTAL COST: \$ 40.50  
FILED ON: 01/16/16  
AD SPACE: 6.75 inches

Witness my hand this 16 day of Jan, 2016.

SUBSCRIBED and Sworn to Before Me This 16 day of Jan, 2016.

*Kathy Runquist*  
\_\_\_\_\_  
Notary Public, Ford County, Kansas

(First Published in the Dodge City Daily Globe on Saturday, January 16, 2016)  
**LEGAL NOTICE**

You, and each of you, are hereby notified that Ritchie Exploration, Inc. has filed an application to commence the commingling of production from the Huck and Altamont B sources of supply for the #1 Lampe 3B well located approx. N/2 S/2 S/2 NW of Section 3-26S-22W, Ford County, Kansas.

Any persons who object to or protest this application shall be required to file their objections or protests with the Conservation Division of the State Corporation Commission of the State of Kansas within fifteen (15) days from the date of the publication. These protests shall be filed pursuant to Commission regulations and must state specific reasons why the grant of the application may cause waste, violate correlative rights or pollute the natural resources of the state of Kansas.

If no protests are received, this application may be granted through a summary proceeding. If valid protests are received, this matter will be set for hearing.

All persons interested or concerned shall take notice of the foregoing and shall govern themselves accordingly.

RITCHIE EXPLORATION, INC.  
P.O. Box 783188  
Wichita, KS 67278-3188  
(316) 691-9500  
1xSat

KATHY RUNQUIST  
Notary Public - State of Kansas  
My Appt. Expires 11/23/16

Conservation Division  
266 N. Main St., Ste. 220  
Wichita, KS 67202-1513



Phone: 316-337-6200  
Fax: 316-337-6211  
<http://kcc.ks.gov/>

Jay Scott Emler, Chairman  
Shari Feist Albrecht, Commissioner  
Pat Apple, Commissioner

Sam Brownback, Governor

March 4, 2016

Peter Fiorini  
Ritchie Exploration, Inc.  
P.O. Box 783188  
Wichita, KS 67278-3188

RE: Approved Commingling CO031601  
Lampe 3B 1  
API No. 15-057-20912-00-00

Dear Mr. Fiorini:

Your Application for Commingling (ACO-4) for the above described well has been reviewed and approved by the Kansas Corporation Commission (KCC) per K.A.R. 82-3-123. Notice was examined and found to be proper per K.A.R. 82-3-135a. No protest had been filed within the 15-day protest period.

Based upon the depth of the Huck formation perforations, total oil production shall not exceed 200 BOPD and total gas production shall not exceed 50% of the absolute open flow (AOF).

Sincerely,

Rick Hestermann  
Production Department