

WHITEHALL EXPLORATION

87 De France Way • Golden, Colorado • (303) 279-6894

GEOLOGIST'S REPORT DRILLING TIME AND SAMPLE LOG

OPERATOR CORAL PROD. CORP.
LEASE GRIEBEL WELL NO. 16-1
FIELD SE-NE-SW-NW
LOCATION 1800' FNL-1120' FWL
SEC. 16 TWP. 7S RGE. 19W
COUNTY ROOKS STATE KS

ELEVATION
KB 1,980'
DF
GL 1,972'
Measurements Are All
From KB

CASING RECORD
SURFACE 85% @ 263'
PRODUCTION NONE

CONTRACTOR DISCOVERY DRILLING - RIG NO. 1
COMM: 5/17/2014 COMP: 5/23/2014
RTD 3476' LOG TD 3472'
SAMPLES SAVED FROM 2900' TO 3476' RTD
DRILLING TIME KEPT FROM 2,850' TO 3476' RTD
SAMPLES EXAMINED FROM 2900' TO 3476' RTD
GEOLOGICAL SUPERVISION FROM 2900' TO 3476' RTD
MUD UP 2,688' TYPE MUD CHEMICAL
WELL SITE GEOLOGIST RICHARD J. HALL - CR#45820

ELECTRICAL SURVEYS
PIONEER
- SONIC
- NEUTRON/DENSITY
POROSITY

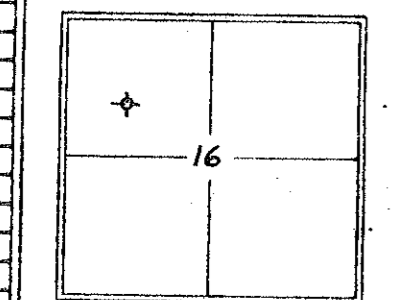

FORMATION	LOG TOP	DATUM	SAMPLE TOP	DATUM	STRUCT. COMP.
ANHYDRITE	1471	+509	1474		-16
TOPEKA	2928	-948	2931		+3
HEBNER SH.	3127	-1147	3131		+5
LANSING	3172	-1192	3178		+2
'H' ZONE	3298	-1318	3301		+4
BKC	3384	-1404	3386		+5
ARBUCKLE	3446	-1466	3442		-16

REFERENCE WELL FOR STRUCTURAL COMPARISON BAIRD OIL CO., GRIEBEL B No. 2,
W12-SE-NW-SEC. 16-T7S-R19W, ROOKS CO., KS KB=1972'

