



KANSAS CORPORATION COMMISSION 1311571
OIL & GAS CONSERVATION DIVISION

Form ACO-4
Form must be typed
March 2009

APPLICATION FOR COMMINGLING OF *Commingling ID #* _____
PRODUCTION (K.A.R. 82-3-123) OR FLUIDS (K.A.R. 82-3-123a)

OPERATOR: License # _____ API No. 15 - _____
Name: _____ Spot Description: _____
Address 1: _____ - - - - - Sec. _____ Twp. _____ S. R. _____ East West
Address 2: _____ Feet from North / South Line of Section
City: _____ State: _____ Zip: _____ + _____ Feet from East / West Line of Section
Contact Person: _____ County: _____
Phone: (_____) _____ Lease Name: _____ Well #: _____

1. Name and upper and lower limit of each production interval to be commingled:
Formation: _____ (Perfs): _____
Formation: _____ (Perfs): _____
Formation: _____ (Perfs): _____
Formation: _____ (Perfs): _____
Formation: _____ (Perfs): _____

2. Estimated amount of fluid production to be commingled from each interval:
Formation: _____ BOPD: _____ MCFPD: _____ BWPD: _____
Formation: _____ BOPD: _____ MCFPD: _____ BWPD: _____
Formation: _____ BOPD: _____ MCFPD: _____ BWPD: _____
Formation: _____ BOPD: _____ MCFPD: _____ BWPD: _____
Formation: _____ BOPD: _____ MCFPD: _____ BWPD: _____

3. Plat map showing the location of the subject well, all other wells on the subject lease, and all wells on offsetting leases within a 1/2 mile radius of the subject well, and for each well the names and addresses of the lessee of record or operator.

4. Signed certificate showing service of the application and affidavit of publication as required in K.A.R. 82-3-135a.

For Commingling of PRODUCTION ONLY, include the following:

- 5. Wireline log of subject well. Previously Filed with ACO-1: Yes No
- 6. Complete Form ACO-1 (*Well Completion form*) for the subject well.

For Commingling of FLUIDS ONLY, include the following:

- 7. Well construction diagram of subject well.
- 8. Any available water chemistry data demonstrating the compatibility of the fluids to be commingled.

AFFIDAVIT: I am the affiant and hereby certify that to the best of my current information, knowledge and personal belief, this request for commingling is true and proper and I have no information or knowledge, which is inconsistent with the information supplied in this application.

Submitted Electronically

KCC Office Use Only
 Denied Approved
15-Day Periods Ends: _____
Approved By: _____ Date: _____

Protests may be filed by any party having a valid interest in the application. Protests must be in writing and comply with K.A.R. 82-3-135b and must be filed within 15 days of publication of the notice of application.

APPLICATION FOR COMMINGLING OF PRODUCTION OR FLUIDS

**Operator, Lessee or Unleased Mineral Owner
within a ½ mile radius of Ritchie Exploration, Inc.'s**

**#1 Bartlett 2D
1950' FSL & 2305' FEL
Section 2-13S-34W
Logan Co., KS**

Township 13 South, Range 34 West

Sec. 1:	W/2	Kathryn Robinson & Harvey V. Robinson, her husband 28801 220 th Street NW Geary, OK 73040	Mineral Owners
Sec. 2:	NE/4, less a tract	William F. Kuhlman & Alberta M. Kuhlman, his wife 316 S. Hudson Ave. Oakley, KS 67748	Mineral Owners
	Tract in NE/4	James L. Bartlett Revocable Trust U/T/A dated March 14, 1996 1692 County Road 26 Colby, KS 67701	Mineral Owner
	NW/4	James L. Barlett Revocable Trust U/T/A dated March 14, 1996	Mineral Owner
	SW/4	Kevin Ayers & Jill Ayers, his wife 316 W. Pine Sharon Springs, KS 67758	Mineral Owners
	SE/4	Ritchie Exploration, Inc. P.O. Box 783188 Wichita, KS 67278-3188	Operator: #1 Bartlett 2D
Sec. 11:	NE/4	Virginia G. Sharpe & Harry E. Sharpe, her husband 308 E. 3 rd Scott City, KS 67871	Mineral Owners
	NW/4	Georgia B.H. Bosse & Rex Bosse, Daniel Mason Heckendorn, Eloise Ruth Ariza-Rodriguez Alida Sue Booth c/o Rex Bosse 5726 SW 42 nd Ave. Portland, OR 97221	Mineral Owners

R 34 W

T
13
S

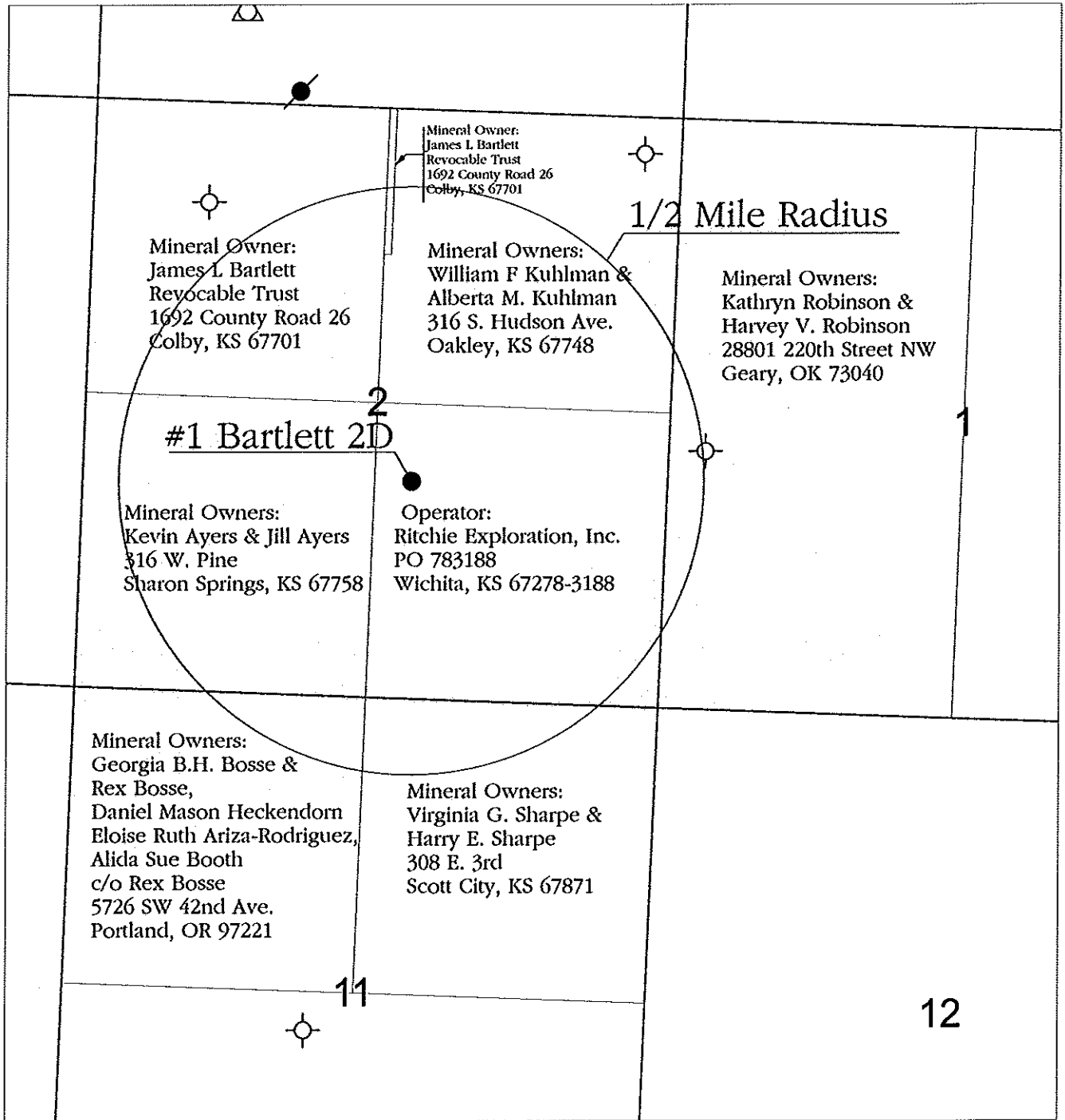

Legend

- Oil Well
- / Abandoned Oil Well
- △ Service Well
- / Dry and Abandoned Well



RITCHIE
EXPLORATION, INC.
Wichita, Kansas

**Application for
Commingling of
Production or Fluids**

Applicant Well: #1 Bartlett 2D
All Wells on Offsetting Leases within 1/2 Mile Radius
Name and Address of Lessee of Record or Operator
On Offsetting Leases

Logan County, Kansas

Prepared By: Justin Clegg	Scale: 1 : 16,500	Date: June 8, 2016
------------------------------	----------------------	-----------------------

AFFIDAVIT

STATE OF KANSAS)
 - SS.
County of Sedgwick)

Peter Fiorini, of lawful age, being first duly sworn, deposeth and saith: That he is Production Manager of Ritchie Exploration, County of Sedgwick, State of Kansas, and that notice was given to all lessee of record or operator within ½ mile radius of the Bartlett 2D #1 well located in the County of Logan (see attached plat map). This notice included a letter and a copy of the Commingle Application (ACO-4). All notices were mailed on June 20, 2016.

made as aforesaid on the 20th of

June A.D. 2016

And affiant further says that he has personal knowledge of the statements above set forth and that they are true.

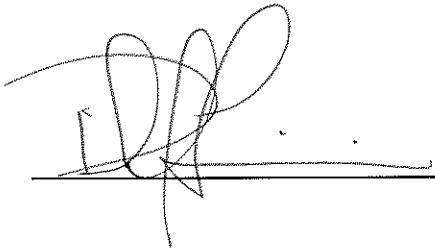

Subscribed and sworn to before me this

20th day of June 2016

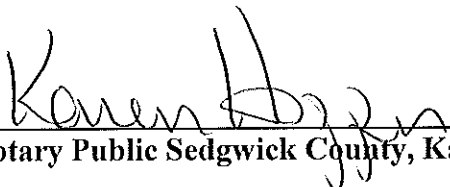

Notary Public Sedgwick County, Kansas



LEGAL PROOF OF PUBLICATION

Account #	Ad Number	Identification	PO	Amount	Cols	Lines
453699	0002527712	Published in the Wichita Eagle June 25, 2016		\$129.00	1	35

Attention: karen hopper
 RITCHIE EXPLORATION INC
 P O BOX 783188
 WICHITA, KS 672783188

In The STATE OF KANSAS
 In and for the County of Sedgwick
 AFFIDAVIT OF PUBLICATION

1 Insertions

Beginning issue of: 06/25/2016

Ending issue of: 06/25/2016

STATE OF KANSAS)

.SS

County of Sedgwick)

Mark Fletchall, of lawful age, being first duly sworn, deposeth and saith: That he is Record Clerk of The Wichita Eagle, a daily newspaper published in the City of Wichita, County of Sedgwick, State of Kansas, and having a general paid circulation on a daily basis in said County, which said newspaper has been continuously and uninterruptedly published in said County for more than one year prior to the first publication of the notice hereinafter mentioned, and which said newspaper has been entered as second class mail matter at the United States Post Office in Wichita, Kansas, and which said newspaper is not a trade, religious or fraternal publication and that a notice of a true copy is hereto attached was published in the regular and entire Morning issue of said The Wichita Eagle from 6/25/2016 to 06/25/2016.

I certify (or declare) under the penalty of perjury that the foregoing is true and correct.

Mark Fletchall

(Signature of Principal Clerk)

DATED: 6/27/2016

Jennifer Rae Bailey
 Notary Public Sedgwick County, Kansas

LEGAL PUBLICATION
 Published in the Wichita Eagle
 June 25, 2016 (250712)
LEGAL NOTICE
 You, and each of you, are hereby notified that Ritchie Exploration, Inc. has filed an application to commence the commencing of production from the Atamos, Johnson, and Marmaton sources of supply for the #1 Bartlett 2D well located approx. W1/2 NW SE of Section 12-13S-34W, Logan County, Kansas.
 Any persons who object to or protest this application shall be required to file their objections or protests with the Conservation Division of the State Corporation Commission of the State of Kansas within fifteen (15) days from the date of the publication. These protests shall be filed pursuant to Commission regulations and must state specific reasons why the grant of the application may cause waste, violate correlative rights or pollute the natural resources of the state of Kansas. If no protests are received, this application may be granted through a summary proceeding. If valid protests are received, this matter will be set for hearing.
 All persons interested or concerned shall take notice of the foregoing and shall govern themselves accordingly.
 RITCHIE EXPLORATION, INC.
 P.O. Box 783188
 Wichita, KS 67278-3188
 (316) 691-9300

JENNIFER RAE BAILEY
 Notary Public - State of Kansas
 My Appt. Expires 6/17/2017

Proof of Publication

State of Kansas,
County of Logan, ss:

_____ of lawful age, being duly sworn upon oath states that he/she is the editor of **THE OAKLEY GRAPHIC**.

THAT said newspaper has been published at least weekly 50 times a year and has been so published for at least five years prior to the first publication of the attached notice.

THAT said newspaper was entered as second class matter at the post office of its publication;

THAT said newspaper has a general paid circulation on a daily, weekly, monthly, or yearly basis in LOGAN County, Kansas and is NOT a trade, religious or fraternal publication and has been printed and published in LOGAN County, Kansas.

THE ATTACHED was published on the following dates in a regular issue of said newspaper:

- 1st Publication was made on the 29 day of June, 20 16
- 2nd Publication was made on the _____ day of _____, 20 _____
- 3rd Publication was made on the _____ day of _____, 20 _____
- 4th Publication was made on the _____ day of _____, 20 _____
- 5th Publication was made on the _____ day of _____, 20 _____
- 6th Publication was made on the _____ day of _____, 20 _____

Publication fee \$ 5200
 Affidavit, Notary's Fees \$ _____
 Additional Copies _____ @ _____ \$ _____
 Total Publication Fee \$ 5200

Dawn Wierand
(Signed)

Witness my hand this 29 day of June, 20 16

SUBSCRIBED and SWORN to before me this 29

day of June, 2016.

Kelly C Anderson
(Notary Public)

My commission expires 2-7-2018

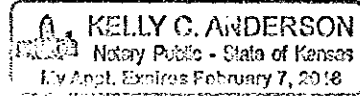

Legal Notice

Published in the Oakley Graphic June 29, 2016
LEGAL NOTICE

You, and each of you, are hereby notified that Ritchie Exploration, Inc. has filed an application to commence the commingling of production from the Altamont, Johnson, and Marmaton sources of supply for the #1 Bartlett 2D well located approx. W/2 NW SE of Section 2-13S-34W, Logan County, Kansas.

Any persons who object to or protest this application shall be required to file their objections or protests with the Conservation Division of the State Corporation Commission of the State of Kansas within fifteen (15) days from the date of the publication. These protests shall be filed pursuant to Commission regulations and must state specific reasons why the grant of the application may cause waste, violate correlative rights or pollute the natural resources of the state of Kansas.

If no protests are received, this application may be granted through a summary proceeding. If valid protests are received, this matter will be set for hearing.

All persons interested or concerned shall take notice of the foregoing and shall govern themselves accordingly.

RITCHIE EXPLORATION, INC.

P.O. Box 783188
Wichita, KS 67278-3188
(316) 691-9500

Confidentiality Requested:

Yes No

KANSAS CORPORATION COMMISSION 1230074
OIL & GAS CONSERVATION DIVISION

Form ACO-1
August 2013
Form must be Typed
Form must be Signed
All blanks must be Filled

CONFIDENTIAL WELL COMPLETION FORM
WELL HISTORY - DESCRIPTION OF WELL & LEASE

OPERATOR: License # 4767

Name: Ritchie Exploration, Inc.

Address 1: 8100 E 22ND ST N # 700

Address 2: BOX 783188

City: WICHITA State: KS Zip: 67278 + 3188

Contact Person: Peter Fiorini

Phone: (316) 691-9500

CONTRACTOR: License # 34082

Name: Alliance Well Service Inc.

Wellsite Geologist: Max Lovely

Purchaser: NCRA

Designate Type of Completion:

- New Well
- Re-Entry
- Workover
- Oil
- Gas
- OG
- CM (Coal Bed Methane)
- Cathodic
- WSW
- D&A
- Other (Core, Expl., etc.): _____
- SWD
- ENHR
- GSW
- SIOW
- SIGW
- Temp. Abd.

If Workover/Re-entry: Old Well Info as follows:

Operator: Ritchie Exploration, Inc.

Well Name: Bartlett 2D

Original Comp. Date: 04/30/2014 Original Total Depth: 4715

- Deepening
- Re-perf.
- Plug Back
- Commingled
- Dual Completion
- SWD
- ENHR
- GSW
- Conv. to ENHR
- Conv. to SWD
- Conv. to GSW
- Conv. to Producer
- Permit #: _____
- Permit #: _____
- Permit #: _____
- Permit #: _____
- Permit #: _____

<u>10/2/2014</u>	<u>10/2/2014</u>	<u>10/7/2014</u>
Spud Date or Recompletion Date	Date Reached TD	Completion Date or Recompletion Date

API No. 15 - 15-109-21278-00-01

Spot Description: 30'S & 5'E of

W2_NW_SE Sec. 2 Twp. 13 S. R. 34 East West

1950 Feet from North / South Line of Section

2305 Feet from East / West Line of Section

Footages Calculated from Nearest Outside Section Corner:

- NE
- NW
- SE
- SW

GPS Location: Lat: _____, Long: _____
(e.g. xx.xxxxx) (e.g. -xxx.xxxxx)

Datum: NAD27 NAD83 WGS84

County: Logan

Lease Name: Bartlett 2D Well #: 1

Field Name: _____

Producing Formation: Marmaton, Altamont, Johnson

Elevation: Ground: 2992 Kelly Bushing: 2997

Total Vertical Depth: 4715 Plug Back Total Depth: 4678

Amount of Surface Pipe Set and Cemented at: 219 Feet

Multiple Stage Cementing Collar Used? Yes No

If yes, show depth set: 2401 Feet

If Alternate II completion, cement circulated from: 2401

feet depth to: 0 w/ 385 sx cmt.

Drilling Fluid Management Plan

(Data must be collected from the Reserve Pit)

Chloride content: _____ ppm Fluid volume: _____ bbis

Dewatering method used: _____

Location of fluid disposal if hauled offsite: _____

Operator Name: _____

Lease Name: _____ License #: _____

Quarter _____ Sec. _____ Twp. _____ S. R. _____ East West

County: _____ Permit #: _____

AFFIDAVIT

I am the affiant and I hereby certify that all requirements of the statutes, rules and regulations promulgated to regulate the oil and gas industry have been fully complied with and the statements herein are complete and correct to the best of my knowledge.

Submitted Electronically

KCC Office Use ONLY

- Confidentiality Requested
Date: 10/30/2014
- Confidential Release Date: _____
- Wireline Log Received
- Geologist Report Received
- UIC Distribution
- ALT I II III Approved by: NAOMI JAMES Date: 10/30/2014



1230074

Operator Name: Ritchie Exploration, Inc. Lease Name: Bartlett 2D Well #: 1

Sec. 2 Twp. 13 S. R. 34 East West County: Logan

INSTRUCTIONS: Show important tops of formations penetrated. Detail all cores. Report all final copies of drill stems tests giving interval tested, time tool open and closed, flowing and shut-in pressures, whether shut-in pressure reached static level, hydrostatic pressures, bottom hole temperature, fluid recovery, and flow rates if gas to surface test, along with final chart(s). Attach extra sheet if more space is needed.

Final Radioactivity Log, Final Logs run to obtain Geophysical Data and Final Electric Logs must be emailed to kcc-well-logs@kcc.ks.gov. Digital electronic log files must be submitted in LAS version 2.0 or newer AND an image file (TIFF or PDF).

Drill Stem Tests Taken <input type="checkbox"/> Yes <input checked="" type="checkbox"/> No <i>(Attach Additional Sheets)</i> Samples Sent to Geological Survey <input type="checkbox"/> Yes <input checked="" type="checkbox"/> No Cores Taken <input type="checkbox"/> Yes <input checked="" type="checkbox"/> No Electric Log Run <input type="checkbox"/> Yes <input checked="" type="checkbox"/> No List All E. Logs Run:	<input type="checkbox"/> Log Formation (Top), Depth and Datum <input checked="" type="checkbox"/> Sample Name Attached Top Attached Datum Attached
--	---

CASING RECORD <input checked="" type="checkbox"/> New <input type="checkbox"/> Used							
Report all strings set-conductor, surface, intermediate, production, etc.							
Purpose of String	Size Hole Drilled	Size Casing Set (In O.D.)	Weight Lbs. / Ft.	Setting Depth	Type of Cement	# Sacks Used	Type and Percent Additives
Surface	12.25	8.625	24	219	Common	175	3%cc,2% gel
Production	7.875	4.5	10.5	4669	OWC	225	10%sat,2%gel,5%cc Xol-Seal,1/4% OVA

ADDITIONAL CEMENTING / SQUEEZE RECORD				
Purpose:	Depth Top Bottom	Type of Cement	# Sacks Used	Type and Percent Additives
<input type="checkbox"/> Perforate				
<input type="checkbox"/> Protect Casing	-			
<input type="checkbox"/> Plug Back TD				
<input type="checkbox"/> Plug Off Zone	-			

Did you perform a hydraulic fracturing treatment on this well? Yes No *(If No, skip questions 2 and 3)*

Does the volume of the total base fluid of the hydraulic fracturing treatment exceed 350,000 gallons? Yes No *(If No, skip question 3)*

Was the hydraulic fracturing treatment information submitted to the chemical disclosure registry? Yes No *(If No, fill out Page Three of the ACO-1)*

Shots Per Foot	PERFORATION RECORD - Bridge Plugs Set/Type Specify Footage of Each Interval Perforated	Acid, Fracture, Shot, Cement Squeeze Record <i>(Amount and Kind of Material Used)</i>	Depth
4	4259-4271	1000 Gals 15% NE Acid w/Cla-Sta & 40 bio-soluble perf balls	

TUBING RECORD: Size: 2.375 Set At: 4632 Packer At: Liner Run: Yes No

Date of First, Resumed Production, SWD or ENHR. 10/7/2014 Producing Method: Flowing Pumping Gas Lift Other *(Explain)* _____

Estimated Production Per 24 Hours	Oil Bbls. <u>3.34</u>	Gas Mcf <u> </u>	Water Bbls. <u>0.01</u>	Gas-Oil Ratio <u> </u>	Gravity <u>29</u>
-----------------------------------	-----------------------	------------------	-------------------------	------------------------	-------------------

DISPOSITION OF GAS: <input type="checkbox"/> Vented <input type="checkbox"/> Sold <input type="checkbox"/> Used on Lease <i>(If vented, Submit ACO-18.)</i>	METHOD OF COMPLETION: <input type="checkbox"/> Open Hole <input type="checkbox"/> Perf. <input type="checkbox"/> Dually Comp. <input checked="" type="checkbox"/> Commingled <i>(Submit ACO-5)</i> <i>(Submit ACO-4)</i> <input type="checkbox"/> Other <i>(Specify)</i> _____	PRODUCTION INTERVAL: _____ _____
---	---	--

Form	ACO1 - Well Completion
Operator	Ritchie Exploration, Inc.
Well Name	Bartlett 2D 1
Doc ID	1230074

Tops

Name	Top	Datum
Anhydrite	2435	+562
B/Anhydrite	2452	+545
Heebner	3863	+1
Toronto	3882	+7
Lansing	3903	+9
Muncie Shale	4054	+10
Stark Shale	4152	-2
Hush	4192	-1195
BKC	4236	-1239
Marmaton	4250	-1253
Altamont	4263	-1266
Pawnee	4346	-1349
Myrick	4387	-1390
Fort Scott	4402	-1405
Cherokee Shale	4435	-1438
Johnson	4481	-1484
Morrow Sand	4560	-1563
Mississippian	4581	-1584

Conservation Division
266 N. Main St., Ste. 220
Wichita, KS 67202-1513



Phone: 316-337-6200
Fax: 316-337-6211
<http://kcc.ks.gov/>

Jay Scott Emler, Chairman
Shari Feist Albrecht, Commissioner
Pat Apple, Commissioner

Sam Brownback, Governor

July 14, 2016

Peter Fiorini
Ritchie Exploration, Inc.
P.O. Box 783188
Wichita, KS 67278-3188

RE: Approved Commingling CO071603
Bartlett 2D 1
API No. 15-109-21278-00-01

Dear Mr. Fiorini:

Your Application for Commingling (ACO-4) for the above described well has been reviewed and approved by the Kansas Corporation Commission (KCC) per K.A.R. 82-3-123. Notice was examined and found to be proper per K.A.R. 82-3-135a. No protest had been filed within the 15-day protest period.

Based upon the depth of the Johnson formation perforations, total oil production shall not exceed 200 BOPD and total gas production shall not exceed 50% of the absolute open flow (AOF).

Sincerely,

Rick Hestermann
Production Department