



00-14s32w-tri
CRD NO.

21-14s32w
DMT NO.

PRO-STAKE

LLC

Construction Site Staking

14163

INVOICE NO.



Shakespeare Oil Company, Inc.

OPERATOR

Logan County, KS

COUNTY

Ottley #4-27

LEASE NAME

2235' FNL - 520' FWL

LOCATION SPOT

2664.6'

GR ELEVATION

38.808963764

NAD 83 LAT

100.871232007

NAD 83 LONG

27 14s 32w
Sec. Twp. Rng.

SCALE: 1" = 1000'
DATE STAKED: February 25th, 2019
MEASURED BY: Pierce R.
DRAWN BY: Pierce R.
AUTHORIZED BY: Alex B.
DATE REVISED:

P.O. Box 2324 Garden City, Kansas 67846
Office/Fax: (620) 276-6159 - Cell: (620) 272-1499
burt@prostakellc.com

LEGEND

- ⊙ irr. well
- ⊕ water hydrant
- ⊙ tank battery
- ⊙ staked loc.
- ⊙ prod. well/ aband. well
- house
- building
- gas line
- W— water line
- E— transmission powerline
- 3 phase powerline
- single phase powerline
- x—x—x— fence
- ▬▬▬▬ gravel / sand rd.
- ▬▬▬▬ gravel trail / lease rd.
- ▬▬▬▬ dirt rd.
- ▬▬▬▬ dirt trail / lease rd.
- ▬▬▬▬ Hwy / blacktop rd.

DIRECTIONS: From the South side of Oakley, KS at the intersection of Hwy. 4 & Hwy. 83 - Now go 20 miles South on Hwy. 83 Now go 1 mile West & NW on Jayhawk Rd- Now go approx. .4 miles South on 340 Ave /lease road (you will cross a cattle guard approx. 0.8 miles) to ingress stake South into near tank battery Now go approx. 0.27 miles South lease road to ingress stake into near producing well Now go approx 0.1 mile South through pasture into staked location

Final ingress must be verified with landowner or operator.

This drawing does not constitute a monumented survey or a land survey plat. This drawing is for construction purposes only.

LANDOWNER/CONTACT:

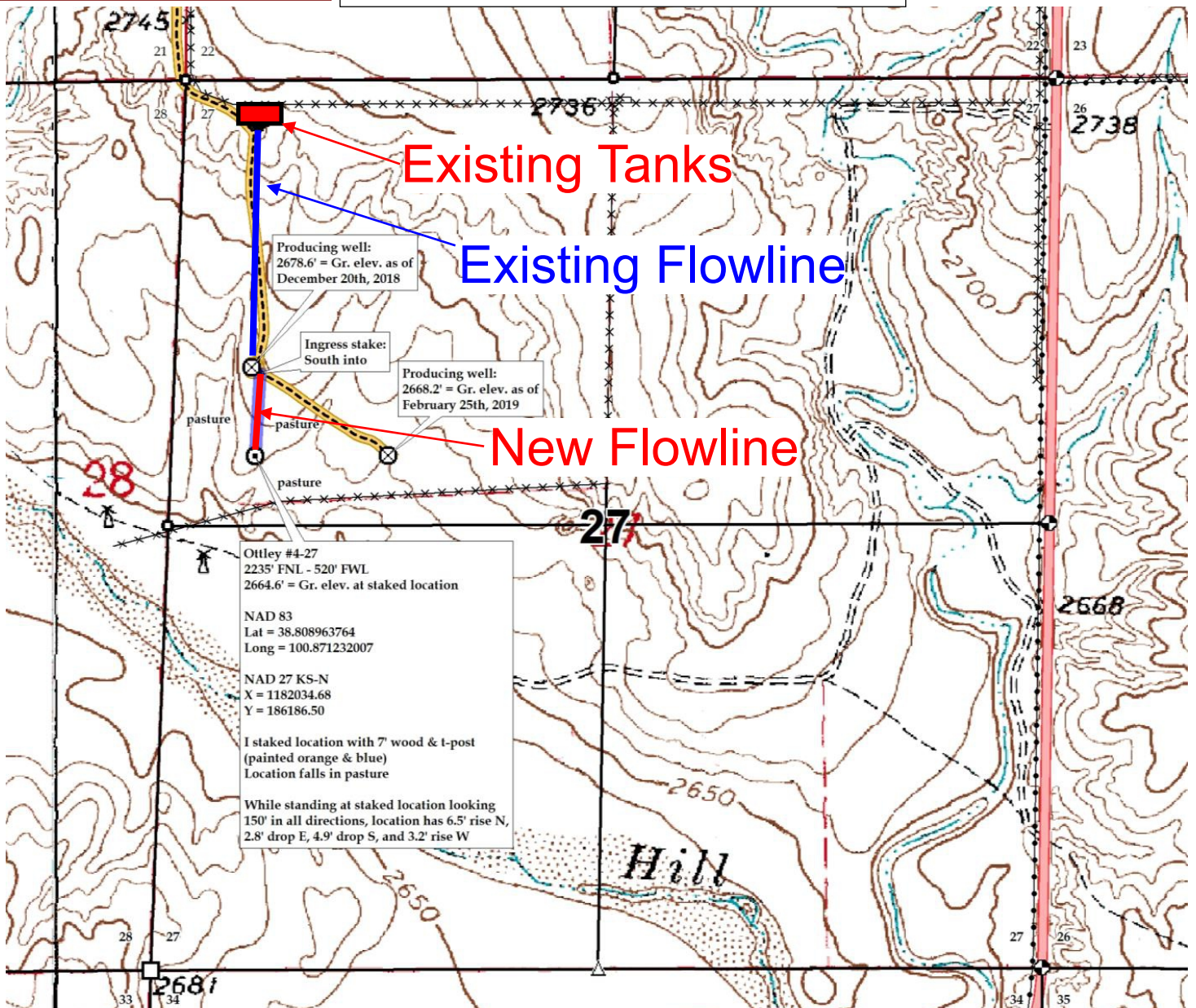
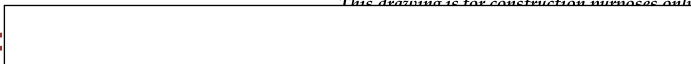

Preliminary, non-binding estimate of flowlines and tanks