



00-14s32w-tri
CRD NO.

21-14s32w
DMT NO.

PRO-STAKE LLC

Construction Site Staking

14164
INVOICE NO.



Shakespeare Oil Company, Inc.
OPERATOR

Logan County, KS
COUNTY

Ottley #5-27
LEASE NAME

2299' FNL - 2100' FWL
LOCATION SPOT

2687.6'
GR ELEVATION

38.808832565
NAD 83 LAT

100.865689691
NAD 83 LONG

27 14s 32w
Sec. Twp. Rng.

SCALE: 1" = 1000'
DATE STAKED: February 25th, 2019
MEASURED BY: Pierce R.
DRAWN BY: Pierce R.
AUTHORIZED BY: Alex B.
DATE REVISED:

P.O. Box 2324 Garden City, Kansas 67846
Office/Fax: (620) 276-6159 – Cell: (620) 272-1499
burt@prostakellc.com

LEGEND

- ⊙ irr. well
- ⊕ water hydrant
- ⊙ tank battery
- ⊙ staked loc.
- ⊙ prod. well/ aband. well
- ⊙ house
- building
- ⊖ gas line
- ⊖ W water line
- ⊖ E transmission powerline
- ⊖ 3 phase powerline
- ⊖ single phase powerline
- ⊖ x x x x fence
- ⊖ gravel / sand rd.
- ⊖ gravel trail / lease rd.
- ⊖ dirt rd.
- ⊖ dirt trail / lease rd.
- ⊖ Hwy / blacktop rd.



DIRECTIONS: From the South side of Oakley, KS at the intersection of Hwy. 4 & Hwy. 83 – Now go 20 miles South on Hwy. 83 Now go 1 mile West & NW on Jayhawk Rd- Now go approx. .4 miles South on 340 Ave /lease road (you will cross a cattle guard approx. 0.8 miles) to ingress stake South into near tank battery Now go approx. 0.27 miles South lease road to producing well- Now go approx. 0.2 miles SE on lease road to ingress stake East into near producing well – Now go approx. 750' East through pasture into staked location

Final ingress must be verified with landowner or operator.

*This drawing does not constitute a monumented survey or a land survey plat.
This drawing is for construction purposes only.*

LANDOWNER/CONTACT:

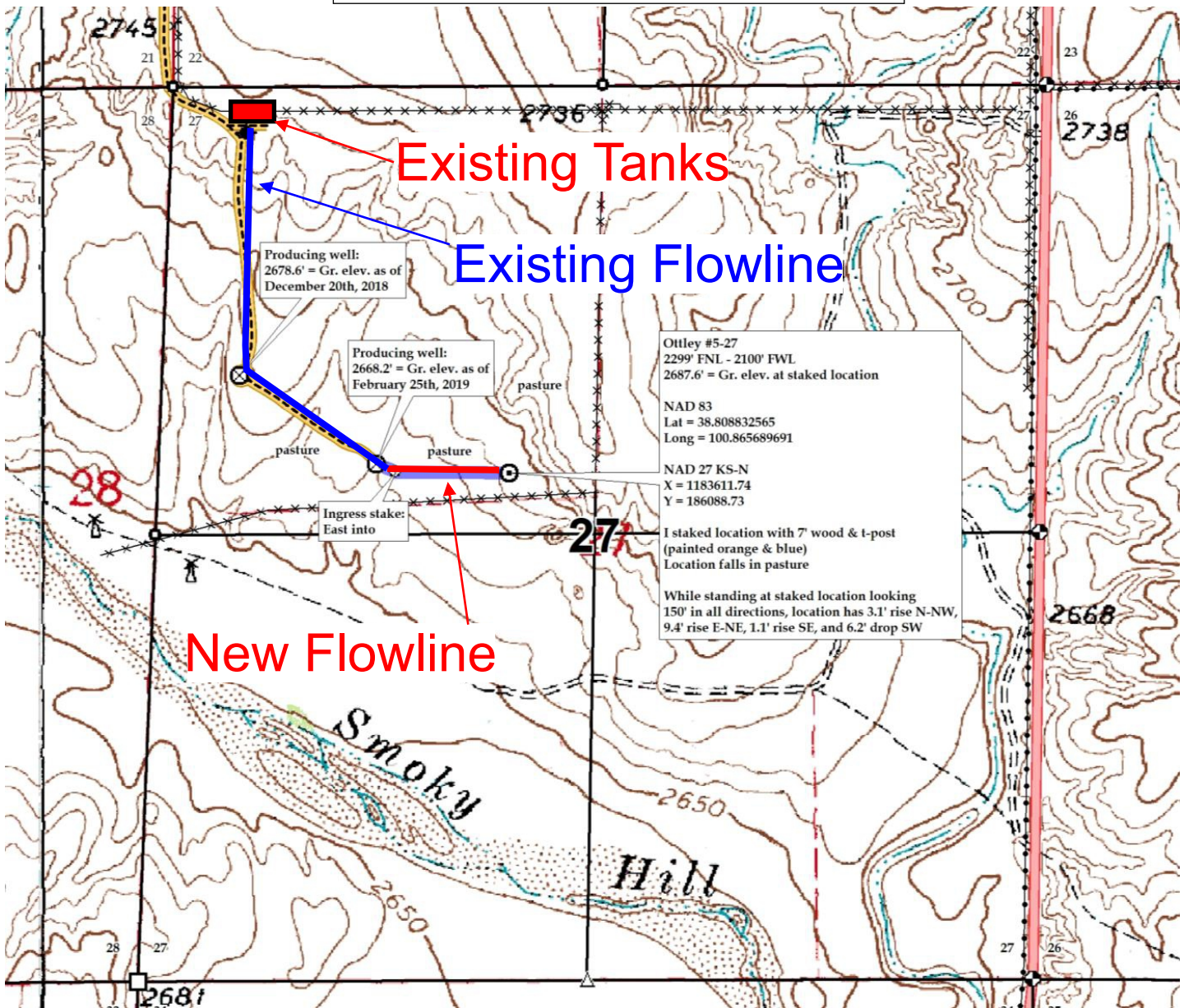
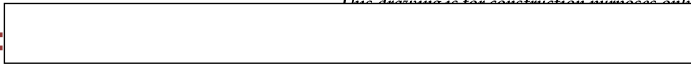

Ottley #5-27
2299' FNL - 2100' FWL
2687.6' = Gr. elev. at staked location
NAD 83
Lat = 38.808832565
Long = 100.865689691

NAD 27 KS-N
X = 1183611.74
Y = 186088.73
1 staked location with 7' wood & t-post
(painted orange & blue)
Location falls in pasture

While standing at staked location looking
150' in all directions, location has 3.1' rise N-NW,
9.4' rise E-NE, 1.1' rise SE, and 6.2' drop SW

Preliminary, non-binding estimate of flowlines and tanks