

KANSAS CORPORATION COMMISSION
OIL & GAS CONSERVATION DIVISION

Form ACO-4
Form must be typed
March 2009

APPLICATION FOR COMMINGLING OF PRODUCTION (K.A.R. 82-3-123) OR FLUIDS (K.A.R. 82-3-123a) *Commingling ID #* _____

OPERATOR: License # _____ API No. 15 - _____
Name: _____ Spot Description: _____
Address 1: _____ - - - - - Sec. _____ Twp. _____ S. R. _____ East West
Address 2: _____ Feet from North / South Line of Section
City: _____ State: _____ Zip: _____ + _____ Feet from East / West Line of Section
Contact Person: _____ County: _____
Phone: (_____) _____ Lease Name: _____ Well #: _____

1. Name and upper and lower limit of each production interval to be commingled:
Formation: _____ (Perfs): _____
Formation: _____ (Perfs): _____
Formation: _____ (Perfs): _____
Formation: _____ (Perfs): _____
Formation: _____ (Perfs): _____

2. Estimated amount of fluid production to be commingled from each interval:
Formation: _____ BOPD: _____ MCFPD: _____ BWPD: _____
Formation: _____ BOPD: _____ MCFPD: _____ BWPD: _____
Formation: _____ BOPD: _____ MCFPD: _____ BWPD: _____
Formation: _____ BOPD: _____ MCFPD: _____ BWPD: _____
Formation: _____ BOPD: _____ MCFPD: _____ BWPD: _____

3. Plat map showing the location of the subject well, all other wells on the subject lease, and all wells on offsetting leases within a 1/2 mile radius of the subject well, and for each well the names and addresses of the lessee of record or operator.

4. Signed certificate showing service of the application and affidavit of publication as required in K.A.R. 82-3-135a.

For Commingling of PRODUCTION ONLY, include the following:

- 5. Wireline log of subject well. Previously Filed with ACO-1: Yes No
- 6. Complete Form ACO-1 (*Well Completion form*) for the subject well.

For Commingling of FLUIDS ONLY, include the following:

- 7. Well construction diagram of subject well.
- 8. Any available water chemistry data demonstrating the compatibility of the fluids to be commingled.

AFFIDAVIT: I am the affiant and hereby certify that to the best of my current information, knowledge and personal belief, this request for commingling is true and proper and I have no information or knowledge, which is inconsistent with the information supplied in this application.

Submitted Electronically

KCC Office Use Only
 Denied Approved
15-Day Periods Ends: _____
Approved By: _____ Date: _____

Protests may be filed by any party having a valid interest in the application. Protests must be in writing and comply with K.A.R. 82-3-135b and must be filed within 15 days of publication of the notice of application.

SITES 16

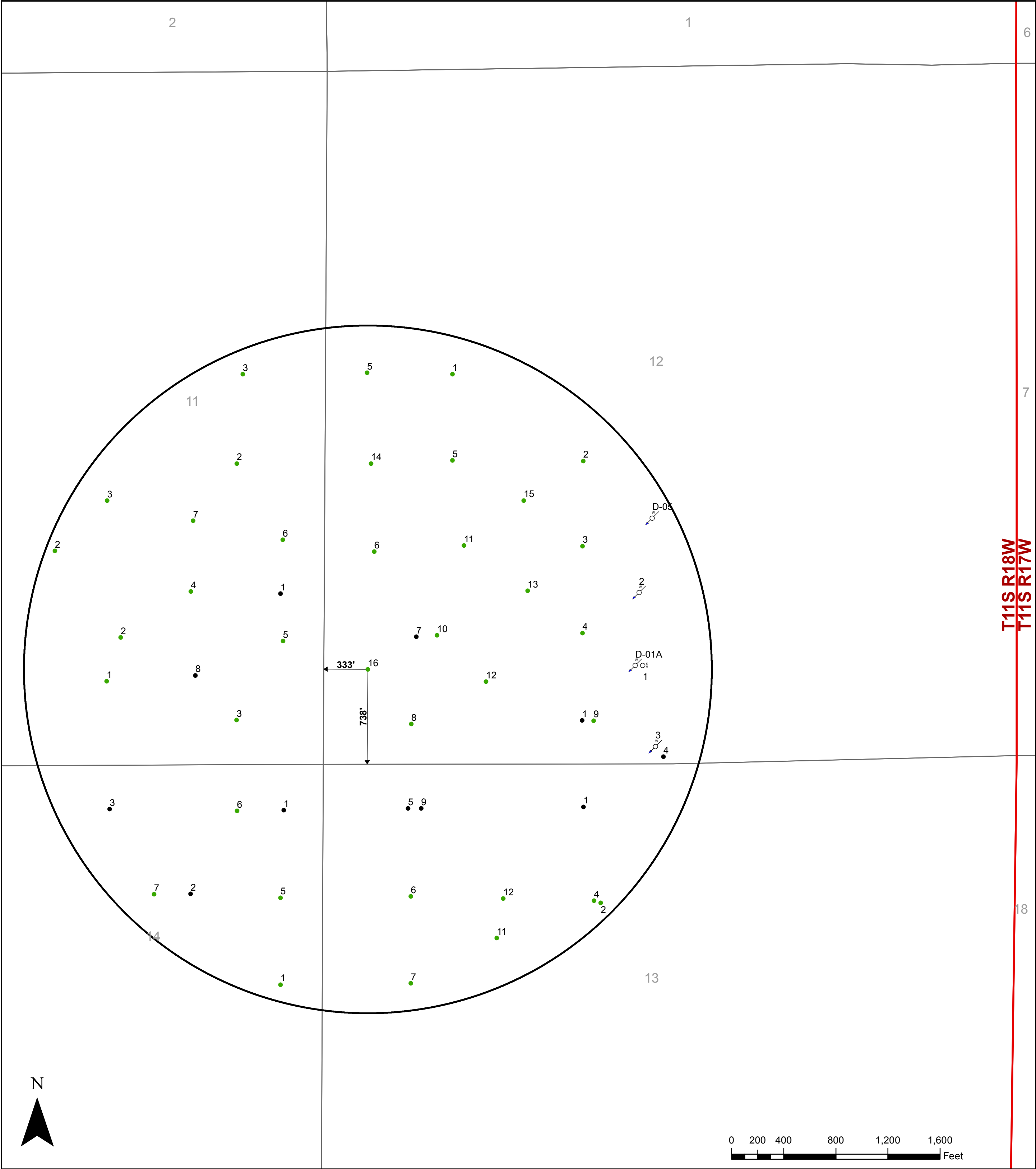

●	PA	☀	GAS	—○—	JNK		TOWNSHIPS
●	OIL	⊕	TA	○	LOC		SECTIONS
⊕	DRY	↙	INJ	○	SRV		



Ellis County, Kansas
SITES 16
 API - 1505125366
 738'N 333'E SWc
 S12 11S 18W SE NE SW SW

Sites 16 - OFFSET OPERATOR CHECK

Section 12-11S-18W, Ellis County, Kansas

738' FNL and 333' FEL of SW/4

TRACT: SW/4 of Section 12-11S-18W, Ellis County, Kansas

SURFACE OWNER: Brenda L. Tucker Revocable Trust 50%
 1856 Saline River Road
 Plainville, KS 67663

Paula J. Moore Revocable Living Trust 50%
 1856 Saline River Road
 Plainville, KS 67663

API	Well Name	Operator Name	Operator Address	Legal Description	County	Footing	Character of Well
15 wells operated by Citation							

TRACT: NW/4 of Section 12-11S-18W, Ellis County, Kansas

SURFACE OWNER: Parker Family Trust
 32601 Balearic Road
 Dana Point, CA 92629

PRODUCING WELLS IN SECTION 12-11S-18W:

API	Well Name	Operator Name	Operator Address	Legal Description	County	Footing	Character of Well
15-051-25369	Ridler West 'A' 5	Venture Resources, Inc.	PO Box 101234 Denver, CO 80250	SW SW NW of 12-11S-18W	Ellis	2310' FSL - 330' FEL of NW	Oil
15-051-25442	Kempe South 9	Venture Resources, Inc.	PO Box 101234 Denver, CO 80250	SW SE NW of 12-11S-18W	Ellis	2310' FSL - 1650' FEL of NW	Oil

TRACT: E/2 SE/4 of Section 11-11S-18W, Ellis County, Kansas

Sites 16 - OFFSET OPERATOR CHECK

Section 12-11S-18W, Ellis County, Kansas

738' FNL and 333' FEL of SW/4

SURFACE OWNER: H. Wayne and Barbara Lynn Carmichael
706 SW 9th Street
Plainville, KS 67663

PRODUCING WELLS IN SECTION 11-11S-18W:

API	Well Name	Operator Name	Operator Address	Legal Description	County	Footing	Character of Well
6 wells operated by Citation							

TRACT: SE/4 NE/4, W/2 SE/4 of Section 11-11S-18W, Ellis County, Kansas

SURFACE OWNER: H. Wayne and Barbara Lynn Carmichael

PRODUCING WELLS IN SECTION 11-11S-18W:

API	Well Name	Operator Name	Operator Address	Legal Description	County	Footing	Character of Well
15-051-04943	Carmichael 3	Nadel and Gussman LLC	15 E. 5th Street, Suite 3200 Tulsa, OK 74103	S2 SE NE of 11-11S-18W	Ellis	2310' FSL - 660' FWL of NE	Oil
15-051-04939	Carmichael 2	Hoffman Resources LLC	PO Box 387 Hoisington, KS 67544	S2 NW SE of 11-11S-18W	Ellis	1650' FNL - 1980' FWL of SE	Oil
15-051-25105	Carmichael 3	Hoffman Resources LLC	PO Box 387 Hoisington, KS 67544	SE NE NW SE of 11-11S-18W	Ellis	1981' FNL - 1545' FWL of SE	Oil
15-051-25206	Carmichael South 2	Hoffman Resources LLC	PO Box 387 Hoisington, KS 67544	NE NE SW SE of 11-11S-18W	Ellis	991' FNL - 1544' FWL of SE	Oil

TRACT: NW/4 of Section 13-11S-18W, Ellis County, Kansas

SURFACE OWNER: Hadley Foundation Inc.
PO Box 327
Hays, KS 67601

Sites 16 - OFFSET OPERATOR CHECK

Section 12-11S-18W, Ellis County, Kansas
738' FNL and 333' FEL of SW/4

PRODUCING WELLS IN SECTION 13-11S-18W:

API	Well Name	Operator Name	Operator Address	Legal Description	County	Footing	Character of Well
15-051-01636	B. C. Hadley 6	Murfin Drilling Company, Inc.	250 N. Water, Suite 300 Wichita, KS 67020	S2 NW NW of 13-11S-18W	Ellis	4290' FNL - 4620' FWL of SE	Oil
15-051-06476	B. C. Hadley 7	Murfin Drilling Company, Inc.	250 N. Water, Suite 300 Wichita, KS 67020	N2 SW NW of 13-11S-18W	Ellis	3630' FNL - 4620' FWL of SE	Oil
15-051-24361	B. C. Hadley 11	Murfin Drilling Company, Inc.	250 N. Water, Suite 300 Wichita, KS 67020	W2 E2 NW of 13-11S-18W	Ellis	3960' FNL - 3931' FWL of SE	Oil
15-051-24362	B. C. Hadley 12	Murfin Drilling Company, Inc.	250 N. Water, Suite 300 Wichita, KS 67020	SW NE NW of 13-11S-18W	Ellis	4260' FNL - 3886' FWL of SE	Oil

TRACT: S/2 NE/4 of Section 14-11S-18W, Ellis County, Kansas

SURFACE OWNER: Virginia F. Carmichael, Life Estate
706 SW 9th Street
Plainville, KS 67663

TRACT: N/2 NE/4 less tract listed below of Section 14-11S-18W, Ellis County, Kansas

SURFACE OWNER: Helen D. Mosser 67%
433 S Charter Street
Monticello, IL 61856

Amy A. Mosser 33%
433 S Charter Street
Monticello, IL 61856

Sites 16 - OFFSET OPERATOR CHECK

Section 12-11S-18W, Ellis County, Kansas

738' FNL and 333' FEL of SW/4

TRACT: A tract beginning 1109.03 ' West and 33' South of NE Corner; thence South 596.58 ' ; thence West 127.7'; thence South 67.37'; thence West 110.97'; thence North 658.71'; thence East 267.02' to point of beginning of Section 14-11S-18W, Ellis County, Kansas, containing 3.6 acres

SURFACE OWNER:	Wayne Carmichael	50%
	706 SW 9th Street	
	Plainville, KS 67663	
	Doug W. Carmichael	50%
	706 SW 9th Street	
	Plainville, KS 67663	

Sites 16 - OFFSET OPERATOR CHECK

Section 12-11S-18W, Ellis County, Kansas

738' FNL and 333' FEL of SW/4

PRODUCING WELLS IN SECTION 14-11S-18W:

API	Well Name	Operator Name	Operator Address	Legal Description	County	Footing	Character of Well
15-051-25174	Deane 5	Venture Resources, Inc.	PO Box 101234 Denver, CO 80250	SE NE NE of 14-11S-18W	Ellis	990' FSL - 330' FWL of NE	Oil
15-051-25255	Carmichael 1	Venture Resources, Inc.	PO Box 101234 Denver, CO 80250	NE SE NE of 14-11S-18W	Ellis	1650' FSL - 330' FWL of NE	Oil
15-051-25333	Deane 6	Venture Resources, Inc.	PO Box 101234 Denver, CO 80250	N2 NE NE of 14-11S-18W	Ellis	330' FSL - 660' FSL of NE	Oil

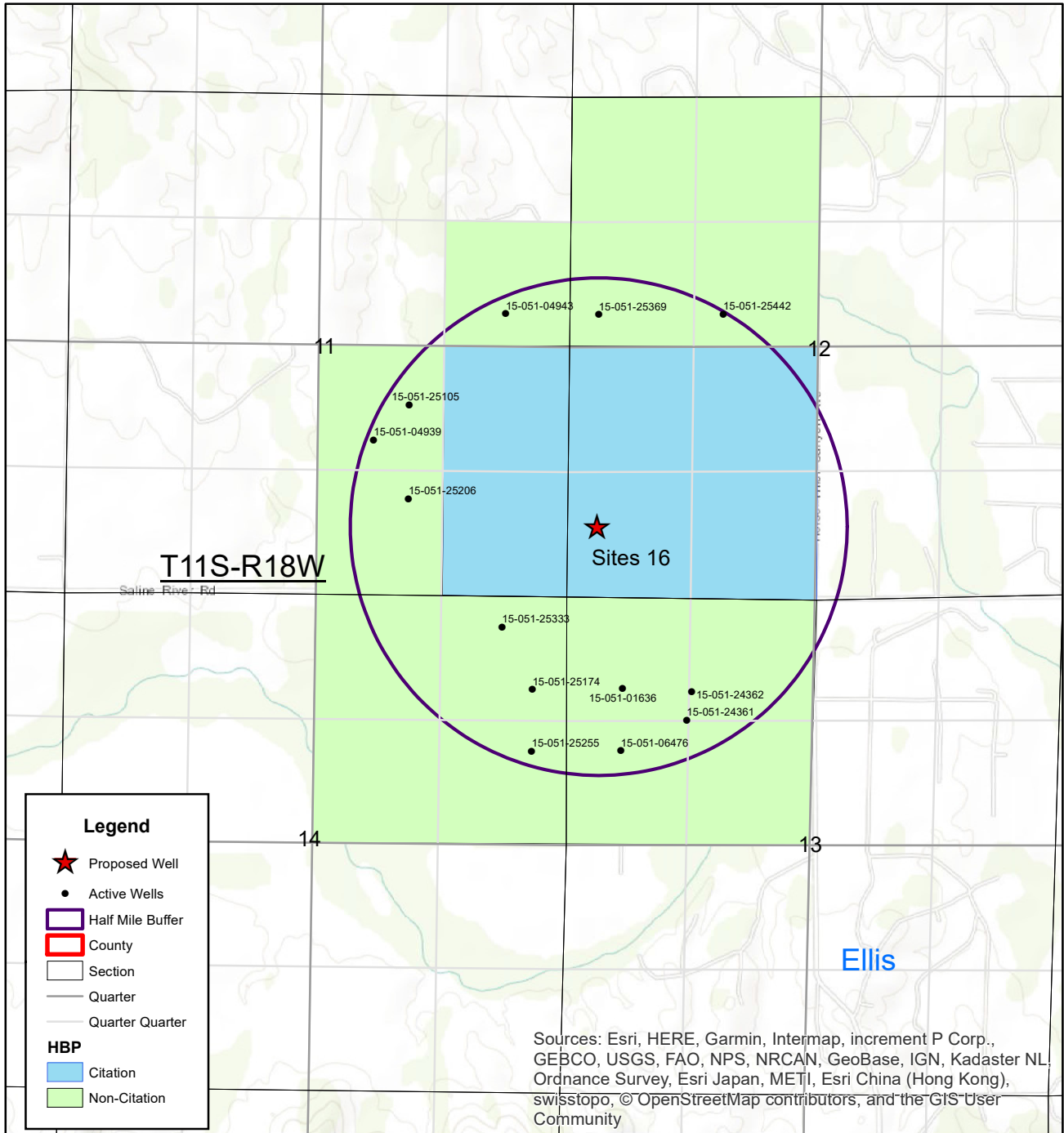

Sites 16
 Offset Operator Plat
 (1/2 mile radius)

Section 12-11S-18W
 Ellis County, Kansas

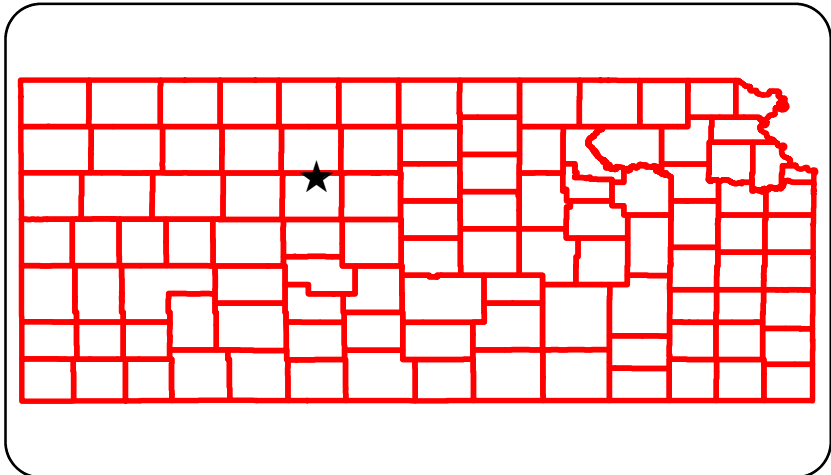

AFFIDAVIT OF PUBLICATION

State of Kansas, Ellis County, ss:

Christopher Dechant

being first duly sworn, deposes and says:

That he/she is Ad Services Supervisor of THE HAYS DAILY NEWS, a daily newspaper printed in the State of Kansas, and published in and of general circulation in Ellis County, Kansas, with a general paid circulation on a yearly basis in Ellis County, Kansas, and that said newspaper is not a trade, religious or fraternal publication.

Said newspaper is published daily, except Monday and Saturday, is published at least weekly 50 times a year; has been so published continuously and uninterrupted in said county and state for a period of more than five years prior to the first publication of said notice; and has been admitted at the post office of Hays in said county as second class matter.

That the attached notice is a true copy thereof and was published in the regular and entire issue of said newspaper for one consecutive week, the first publication thereof being made as aforesaid on the 5th day of April, 2019, with subsequent publications being made on the following dates:

____, 20__ ____ , 20__
____, 20__ ____ , 20__
____, 20__ ____ , 20__



Subscribed and sworn to before me this 5th day of April, 2019.



Notary Public

My Appointment expires 6/7/22
Printer's Fee\$ ____
Additional copies.....\$ ____
Total Fee.....\$59.80

(Published in The Hays Daily News April 5, 2019)

BEFORE THE STATE CORPORATION COMMISSION OF THE STATE OF KANSAS NOTICE OF FILING APPLICATION

RE: Citation Oil & Gas Corp. -- Application for a permit to authorize the downhole commingling of the Topeka D and LKC zones in the Sites 16 well located in Ellis County, Kansas.

TO: All Oil and Gas Producers, Unleased Mineral Interest Owners, Landowners, and all persons whomever concerned.

You, and each of you, are hereby notified that Citation Oil & Gas Corp. has filed an application to commence the downhole commingling of the Topeka D and LKC Formations in the Sites 16 well, located in the SE NW SW SW of Section 12, Township 11 South, Range 18 West, Ellis County, Kansas.

Any persons who object to or protest this application shall be required to file their objections or protests with the Conservation Division of the State Corporation Commission of the State of Kansas within fifteen (15) days from the date of this publication. These protests shall be filed pursuant to Commission regulations and must state specific reasons why the grant of the application may cause waste, violate correlative rights or pollute the natural resources of the state of Kansas.

All persons interested or concerned shall take notice of the foregoing and shall govern themselves accordingly. Citation Oil & Gas Corp. P.O. Box 690688 Houston, Texas 77269 Phone: 281-891-1000

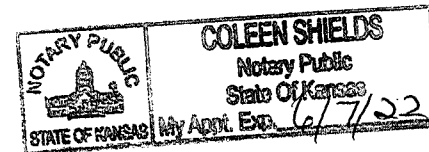

Offset Operators, Unleased Mineral Owners and Landowners acreage

(Attach additional sheets if necessary)

Sites 16

Name:

Legal Description of Leasehold:

Brenda L. Tucker and Paula J. Moore Rev Trust -Surface

Hadley Foundation Inc. - Surface

Helen D and Amy A. Mosser - Surface

Hoffman Resources LLC - Operator

Murfin Drilling Company, Inc. - Operator

Nadel and Gussman LLC - Operator

Parker Family Trust -Surface

Venture Resources, Inc. Operator

Wayne, Barbara Carmichael - Surface

Virginia Carmichael - Surface

Doug W, Virginia Carmichael - Surface

SW/4 Sec 12-11S-18W Ellis County, KS

NW/4 Sec 13-11S-18W Ellis County, KS

N/2 NE/4 less 3.6 acres Sec 14-11S-18W Ellis County, KS

SE/4 Sec 11-11S-18W Ellis County, KS

NW/4 Sec 13-11S-18W Ellis County, KS

NE/4 Sec 11-11S-18W Ellis County, KS

NW/4 Sec 12-11S-18W Ellis County, KS

NW/4 Sec. 12-11S-18W Ellis County, KS

E/2 SE/4; SE/4 NE/4, W/2 SE/4Sec 11-11S-18W & 3.6 acres Sec 14-11S-18W Ellis County, KS

S/2 NE/4 Sec 14-11S-18W Ellis County, KS

3.6 acres Sec 14-11S-18W

I hereby certify that the statements made herein are true and correct to the best of my knowledge and belief.

Sharon Ward

Applicant or Duly Authorized Agent

Subscribed and sworn before me this 30 day of April, 2019

Crystal Cornelius

Notary Public

My Commission Expires:

11-24-2022

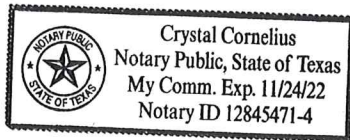

Instructions:

1. Fully complete application, including page 4 (*plat map*) showing subject well and all known oil, gas and input wells, including wells being drilled, inactive wells, or dry holes, within one-half mile. Show lease names and operators or unleased mineral rights owners of all lands within one-half mile. Show well numbers and elevations of producing formation tops.
2. Attach some type of log (*drillers log, electric log, etc.*).
3. Attach some type of verification of cementing for surface casing, longstring, D.V. tool, perforations, etc. (*Cement ticket and job log, bond log, etc.*)
4. Attach Affidavit of Notice.
5. Fill in schematic drawing of subsurface facilities including: size, setting depth, amount of cement, measured or calculated tops of cement for each of surface, intermediate (*if any*) and production casing; size and setting depth of tubing and packer; geological zone of injection showing top and bottom of injection interval.
6. The original and one copy of the application and all attachments shall be mailed to the State Corporation Commission, Conservation Division.
7. Deliver or mail one (*1*) copy of the application to the landowner on whose land the injection well is located and to each operator or lessee of record and each unleased mineral rights owner within one-half mile of the applicant well.
8. Approval of this application, if granted, is valid only as long as there are no substantial changes in operation set forth in the application. A substantial change requires the approval of a new application. **No injection well may be used without prior written authorization.**
9. All application fees must accompany the application.

Affidavit of Notice Served

Re: Application for: Commingling
Well Name: Sites 16 Legal Location: _____

The undersigned hereby certifies that he / she is a duly authorized agent for the applicant, and that on the day 3 of April, 2019, a true and correct copy of the application referenced above was delivered or mailed to the following parties:

Note: A copy of this affidavit must be served as a part of the application.

Name	Address (Attach additional sheets if nece
Brenda L. Tucker and Paula J. Moore Revocable Trust	1856 Saline River Road Plainville, KS 67663
Hadley Foundation Inc.	PO Box 327 Hays, KS 67601
Helen D and Amy A. Mosser	433 S Charter Street Monticello, IL 61856
Hoffman Resources LLC	PO Box 387 Hoisington, KS 67544
Murfin Drilling Company, Inc.	250 N. Water, Suite 300 Wichita, KS 67020
Nadel and Gussman LLC	15 E. 5th Street, Suite 3200 Tulsa, OK 74103
Parker Family Trust	32601 Balearic Road Dana Point, CA 92629
Venture Resources, Inc.	PO Box 101234 Denver, CO 80250
Wayne, Barbara, Doug W, Virginia Carmichael	706 SW 9th Street Plainville, KS 67663

I further attest that notice of the filing of this application was published in the The Hays Daily News, the official county publication of Ellis county. A copy of the affidavit of this publication is attached.

Signed this 5 day of April, 2019

Sharon Ward
Applicant or Duly Authorized Agent

Subscribed and sworn to before me this 30 day of April, 2019

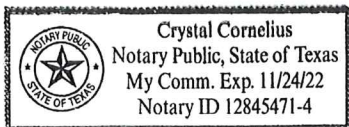

Crystal Cornelius
Notary Public
My Commission Expires: 11-24-2022

Protests may be filed by any party having a valid interest in the application. Petitions for protests shall be in writing and shall clearly identify the name and address of the protestant and the title of the application. The petition shall include a clear and concise statement of the direct and substantial interest of the protestant in the proceedings, including the manner in which the protestant may be affected, and the nature, extent, character and grounds of the protest. Protestants shall serve the protest upon the applicant by mail or personal service at the same time or before the protestant files the protest with the Conservation Division. Protests must be filed within 30 days of the publication notice of the application.

LEGAL PROOF OF PUBLICATION

Account #	Ad Number	Identification	PO	Amount	Cols	Lines
516230	0004196923	BEFORE THE STATE CORPORATION COMMIS		\$236.13	1	39

Attention: Sharon Ward

CITATION OIL & GAS CORP.
 14077 CUTTEN RD
 HOUSTON, TX 770692212

**BEFORE THE STATE CORPORATION
 COMMISSION OF THE STATE OF KANSAS
 NOTICE OF FILING APPLICATION**

RE: Citation Oil & Gas Corp. -- Application for a permit to authorize the downhole commingling of the Topeka D and LKC zones in the Sites 16 well located in Ellis County, Kansas.

TD: All Oil and Gas Producers, Unleased Mineral Interest Owners, Landowners, and all persons whomever concerned.

You, and each of you, are hereby notified that Citation Oil & Gas Corp. has filed an application to commence the downhole commingling of the Topeka D and LKC Formations in the Sites 16 well, located in the SE NW SW SW of Section 12, Township 11 South, Range 18 West, Ellis County, Kansas.

Any persons who object to or protest this application shall be required to file their objections or protests with the Conservation Division of the State Corporation Commission of the State of Kansas within fifteen (15) days from the date of this publication. These protests shall be filed pursuant to Commission regulations and must state specific reasons why the grant of the application may cause waste, violate correlative rights or pollute the natural resources of the state of Kansas.

All persons interested or concerned shall take notice of the foregoing and shall govern themselves accordingly.

Citation Oil & Gas Corp.
 P.O. Box 690688
 Houston, Texas 77269
 Phone: 281-891-1000

In The STATE OF KANSAS
 In and for the County of Sedgwick
 AFFIDAVIT OF PUBLICATION

1 Insertions

Beginning issue of: 04/30/2019

Ending issue of: 04/30/2019

STATE OF KANSAS)
 .SS
 County of Sedgwick)

Dale Seiwert, of lawful age, being first duly sworn, deposeth and saith: That he is Record Clerk of The Wichita Eagle, a daily newspaper published in the City of Wichita, County of Sedgwick, State of Kansas, and having a general paid circulation on a daily basis in said County, which said newspaper has been continuously and uninterruptedly published in said County for more than one year prior to the first publication of the notice hereinafter mentioned, and which said newspaper has been entered as second class mail matter at the United States Post Office in Wichita, Kansas, and which said newspaper is not a trade, religious or fraternal publication and that a notice of a true copy is hereto attached was published in the regular and entire Morning issue of said The Wichita Eagle from 4/30/2019 to 04/30/2019.

I certify (or declare) under the penalty of perjury that the foregoing is true and correct.

Dale Seiwert

(Signature of Principal Clerk)
 DATED: 4/30/2019

JS

Notary Public Sedgwick County, Kansas

JENNIFER RAE BAILEY
 Notary Public - State of Kansas
 My Appt. Expires 6/4/2021

Conservation Division
266 N. Main St., Ste. 220
Wichita, KS 67202-1513



Phone: 316-337-6200
Fax: 346-337-6211
<http://kcc.ks.gov/>

Dwight D. Keen, Chair
Shari Feist Albrecht, Commissioner
Susan K. Duffy, Commissioner

Laura Kelly, Governor

May 15, 2019

Sharon Ward
Citation Oil & Gas Corp
14077 Cutten Rd
Houston, TX 77269-0688

RE: Approved Commingling CO051902
Sites 16
API No. 15-051-25366-00-00

Dear Ms. Ward:

Your Application for Commingling (ACO-4) for the above described well has been reviewed and approved by the Kansas Corporation Commission (KCC) per K.A.R. 82-3-123. Notice was examined and found to be proper per K.A.R. 82-3-135a. No protest had been filed within the 15-day protest period.

Based upon the depth of the LKC formation perforations, total oil production shall not exceed 100 BOPD and total gas production shall not exceed 50% of the absolute open flow (AOF).

File form ACO-1 upon completion of the well to commingle.

Sincerely,

Rick Hestermann
Production Department