

For KCC Use:

Effective Date: _____

District # _____

SGA? Yes No

KANSAS CORPORATION COMMISSION
OIL & GAS CONSERVATION DIVISION

Form C-1

March 2010

Form must be Typed
Form must be Signed
All blanks must be Filled

NOTICE OF INTENT TO DRILL

Must be approved by KCC five (5) days prior to commencing well

Form KSONA-1, Certification of Compliance with the Kansas Surface Owner Notification Act, MUST be submitted with this form.

Expected Spud Date: _____
month day year

OPERATOR: License# _____

Name: _____

Address 1: _____

Address 2: _____

City: _____ State: _____ Zip: _____ + _____

Contact Person: _____

Phone: _____

CONTRACTOR: License# _____

Name: _____

Well Drilled For:

Well Class:

Type Equipment:

- | | | | |
|---|-----------------------------------|------------------------------------|-------------------------------------|
| <input type="checkbox"/> Oil | <input type="checkbox"/> Enh Rec | <input type="checkbox"/> Infield | <input type="checkbox"/> Mud Rotary |
| <input type="checkbox"/> Gas | <input type="checkbox"/> Storage | <input type="checkbox"/> Pool Ext. | <input type="checkbox"/> Air Rotary |
| | <input type="checkbox"/> Disposal | <input type="checkbox"/> Wildcat | <input type="checkbox"/> Cable |
| <input type="checkbox"/> Seismic ; _____ # of Holes | <input type="checkbox"/> Other | | |
| <input type="checkbox"/> Other: _____ | | | |

If OWWO: old well information as follows:

Operator: _____

Well Name: _____

Original Completion Date: _____ Original Total Depth: _____

Directional, Deviated or Horizontal wellbore? Yes No

If Yes, true vertical depth: _____

Bottom Hole Location: _____

KCC DKT #: _____

Spot Description: _____

_____ - _____ - _____ Sec. _____ Twp. _____ S. R. _____ E W
(Q/Q/Q/Q) _____ feet from N / S Line of Section

_____ feet from E / W Line of Section

Is SECTION: Regular Irregular?

(Note: Locate well on the Section Plat on reverse side)

County: _____

Lease Name: _____ Well #: _____

Field Name: _____

Is this a Prorated / Spaced Field? Yes No

Target Formation(s): _____

Nearest Lease or unit boundary line (in footage): _____

Ground Surface Elevation: _____ feet MSL

Water well within one-quarter mile: Yes No

Public water supply well within one mile: Yes No

Depth to bottom of fresh water: _____

Depth to bottom of usable water: _____

Surface Pipe by Alternate: I II

Length of Surface Pipe Planned to be set: _____

Length of Conductor Pipe (if any): _____

Projected Total Depth: _____

Formation at Total Depth: _____

Water Source for Drilling Operations:

Well Farm Pond Other: _____

DWR Permit #: _____

(Note: Apply for Permit with DWR)

Will Cores be taken? Yes No

If Yes, proposed zone: _____

AFFIDAVIT

The undersigned hereby affirms that the drilling, completion and eventual plugging of this well will comply with K.S.A. 55 et. seq.

It is agreed that the following minimum requirements will be met:

1. Notify the appropriate district office **prior** to spudding of well;
2. A copy of the approved notice of intent to drill **shall be** posted on each drilling rig;
3. The minimum amount of surface pipe as specified below **shall be set** by circulating cement to the top; in all cases surface pipe **shall be set** through all unconsolidated materials plus a minimum of 20 feet into the underlying formation.
4. If the well is dry hole, an agreement between the operator and the district office on plug length and placement is necessary **prior to plugging**;
5. The appropriate district office will be notified before well is either plugged or production casing is cemented in;
6. If an ALTERNATE II COMPLETION, production pipe shall be cemented from below any usable water to surface within **120 DAYS** of spud date. Or pursuant to Appendix "B" - Eastern Kansas surface casing order #133,891-C, which applies to the KCC District 3 area, alternate II cementing must be completed within 30 days of the spud date or the well shall be plugged. **In all cases, NOTIFY district office** prior to any cementing.

Submitted Electronically

For KCC Use ONLY

API # 15 - _____

Conductor pipe required _____ feet

Minimum surface pipe required _____ feet per ALT. I II

Approved by: _____

This authorization expires: _____
(This authorization void if drilling not started within 12 months of approval date.)

Spud date: _____ Agent: _____

Remember to:

- File Certification of Compliance with the Kansas Surface Owner Notification Act (KSONA-1) with Intent to Drill;
- File Drill Pit Application (form CDP-1) with Intent to Drill;
- File Completion Form ACO-1 within 120 days of spud date;
- File acreage attribution plat according to field proration orders;
- Notify appropriate district office 48 hours prior to workover or re-entry;
- Submit plugging report (CP-4) after plugging is completed (within 60 days);
- Obtain written approval before disposing or injecting salt water.
- If well will not be drilled or permit has expired (See: authorized expiration date) please check the box below and return to the address below.

Well will not be drilled or Permit Expired Date: _____
Signature of Operator or Agent:

E
 W

For KCC Use ONLY

API # 15 - _____

IN ALL CASES PLOT THE INTENDED WELL ON THE PLAT BELOW

In all cases, please fully complete this side of the form. Include items 1 through 5 at the bottom of this page.

Operator: _____

Lease: _____

Well Number: _____

Field: _____

Number of Acres attributable to well: _____

QTR/QTR/QTR of acreage: _____ - _____ - _____ - _____

Location of Well: County: _____

_____ feet from N / S Line of Section

_____ feet from E / W Line of Section

Sec. _____ Twp. _____ S. R. _____ E W

Is Section: Regular or Irregular

If Section is Irregular, locate well from nearest corner boundary.

Section corner used: NE NW SE SW

PLAT

Show location of the well. Show footage to the nearest lease or unit boundary line. Show the predicted locations of lease roads, tank batteries, pipelines and electrical lines, as required by the Kansas Surface Owner Notice Act (House Bill 2032). You may attach a separate plat if desired.

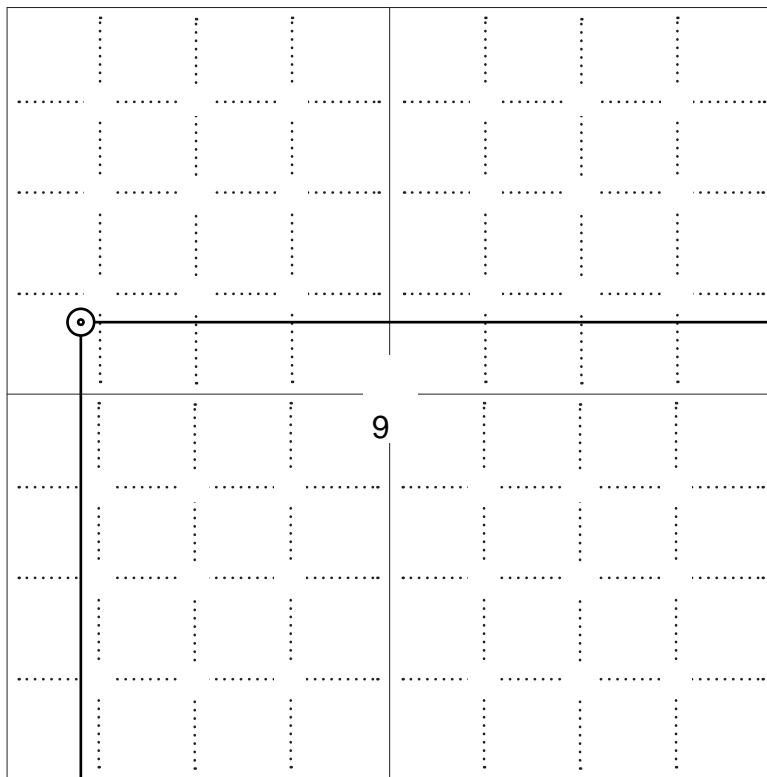

LEGEND

- Well Location
- Tank Battery Location
- Pipeline Location
- Electric Line Location
- Lease Road Location

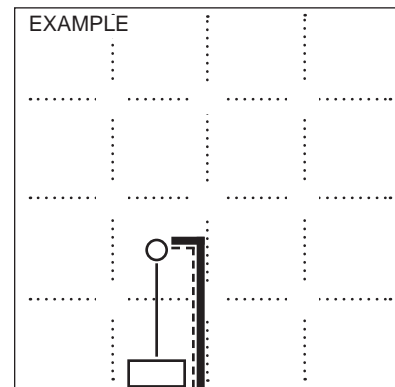

NOTE: In all cases locate the spot of the proposed drilling location.

3126 ft.

In plotting the proposed location of the well, you must show:

1. The manner in which you are using the depicted plat by identifying section lines, i.e. 1 section, 1 section with 8 surrounding sections, 4 sections, etc.
2. The distance of the proposed drilling location from the south / north and east / west outside section lines.
3. The distance to the nearest lease or unit boundary line (in footage).
4. If proposed location is located within a prorated or spaced field a certificate of acreage attribution plat must be attached: (C0-7 for oil wells; CG-8 for gas wells).
5. The predicted locations of lease roads, tank batteries, pipelines, and electrical lines.

**KANSAS CORPORATION COMMISSION
OIL & GAS CONSERVATION DIVISION
APPLICATION FOR SURFACE PIT**

Form CDP-1
May 2010
Form must be Typed

Submit in Duplicate

Operator Name: _____		License Number: _____	
Operator Address: _____			
Contact Person: _____		Phone Number: _____	
Lease Name & Well No.: _____		Pit Location (QQQQ): _____-_____-_____-_____	
Type of Pit: <input type="checkbox"/> Emergency Pit <input type="checkbox"/> Burn Pit <input type="checkbox"/> Settling Pit <input type="checkbox"/> Drilling Pit <input type="checkbox"/> Workover Pit <input type="checkbox"/> Haul-Off Pit <i>(If WP Supply API No. or Year Drilled)</i>		Pit is: <input type="checkbox"/> Proposed <input type="checkbox"/> Existing If Existing, date constructed: _____ Pit capacity: _____ (bbls)	
Is the pit located in a Sensitive Ground Water Area? <input type="checkbox"/> Yes <input type="checkbox"/> No		Chloride concentration: _____ mg/l <i>(For Emergency Pits and Settling Pits only)</i>	
Is the bottom below ground level? <input type="checkbox"/> Yes <input type="checkbox"/> No		Artificial Liner? <input type="checkbox"/> Yes <input type="checkbox"/> No	
How is the pit lined if a plastic liner is not used? _____			
Pit dimensions (all but working pits): _____ Length (feet) _____ Width (feet) <input type="checkbox"/> N/A: Steel Pits Depth from ground level to deepest point: _____ (feet) <input type="checkbox"/> No Pit			
If the pit is lined give a brief description of the liner material, thickness and installation procedure.		Describe procedures for periodic maintenance and determining liner integrity, including any special monitoring.	
Distance to nearest water well within one-mile of pit: _____ feet Depth of water well _____ feet		Depth to shallowest fresh water _____ feet. Source of information: <input type="checkbox"/> measured <input type="checkbox"/> well owner <input type="checkbox"/> electric log <input type="checkbox"/> KDWR	
Emergency, Settling and Burn Pits ONLY: Producing Formation: _____ Number of producing wells on lease: _____ Barrels of fluid produced daily: _____ Does the slope from the tank battery allow all spilled fluids to flow into the pit? <input type="checkbox"/> Yes <input type="checkbox"/> No		Drilling, Workover and Haul-Off Pits ONLY: Type of material utilized in drilling/workover: _____ Number of working pits to be utilized: _____ Abandonment procedure: _____ _____ Drill pits must be closed within 365 days of spud date.	
<h2>Submitted Electronically</h2>			

KCC OFFICE USE ONLY			
		<input type="checkbox"/> Liner <input type="checkbox"/> Steel Pit <input type="checkbox"/> RFAC <input type="checkbox"/> RFAS	
Date Received: _____	Permit Number: _____	Permit Date: _____	Lease Inspection: <input type="checkbox"/> Yes <input type="checkbox"/> No

KANSAS CORPORATION COMMISSION
OIL & GAS CONSERVATION DIVISION

Form KSONA-1
January 2014
Form Must Be Typed
Form must be Signed
All blanks must be Filled

**CERTIFICATION OF COMPLIANCE WITH THE
KANSAS SURFACE OWNER NOTIFICATION ACT**

This form must be submitted with all Forms C-1 (Notice of Intent to Drill); CB-1 (Cathodic Protection Borehole Intent); T-1 (Request for Change of Operator Transfer of Injection or Surface Pit Permit); and CP-1 (Well Plugging Application). Any such form submitted without an accompanying Form KSONA-1 will be returned.

Select the corresponding form being filed: C-1 (Intent) CB-1 (Cathodic Protection Borehole Intent) T-1 (Transfer) CP-1 (Plugging Application)

OPERATOR: License # _____
Name: _____
Address 1: _____
Address 2: _____
City: _____ State: _____ Zip: _____ + _____
Contact Person: _____
Phone: (_____) _____ Fax: (_____) _____
Email Address: _____

Well Location:
____ - ____ - ____ - ____ Sec. ____ Twp. ____ S. R. ____ East West
County: _____
Lease Name: _____ Well #: _____

If filing a Form T-1 for multiple wells on a lease, enter the legal description of the lease below:

Surface Owner Information:

Name: _____
Address 1: _____
Address 2: _____
City: _____ State: _____ Zip: _____ + _____

When filing a Form T-1 involving multiple surface owners, attach an additional sheet listing all of the information to the left for each surface owner. Surface owner information can be found in the records of the register of deeds for the county, and in the real estate property tax records of the county treasurer.

If this form is being submitted with a Form C-1 (Intent) or CB-1 (Cathodic Protection Borehole Intent), you must supply the surface owners and the KCC with a plat showing the predicted locations of lease roads, tank batteries, pipelines, and electrical lines. The locations shown on the plat are preliminary non-binding estimates. The locations may be entered on the Form C-1 plat, Form CB-1 plat, or a separate plat may be submitted.

Select one of the following:

- I certify that, pursuant to the Kansas Surface Owner Notice Act (House Bill 2032), I have provided the following to the surface owner(s) of the land upon which the subject well is or will be located: 1) a copy of the Form C-1, Form CB-1, Form T-1, or Form CP-1 that I am filing in connection with this form; 2) if the form being filed is a Form C-1 or Form CB-1, the plat(s) required by this form; and 3) my operator name, address, phone number, fax, and email address.
- I have not provided this information to the surface owner(s). I acknowledge that, because I have not provided this information, the KCC will be required to send this information to the surface owner(s). To mitigate the additional cost of the KCC performing this task, I acknowledge that I must provide the name and address of the surface owner by filling out the top section of this form and that I am being charged a \$30.00 handling fee, payable to the KCC, which is enclosed with this form.

If choosing the second option, submit payment of the \$30.00 handling fee with this form. If the fee is not received with this form, the KSONA-1 form and the associated Form C-1, Form CB-1, Form T-1, or Form CP-1 will be returned.

I Submitted Electronically

I

FAULKNER #1-1

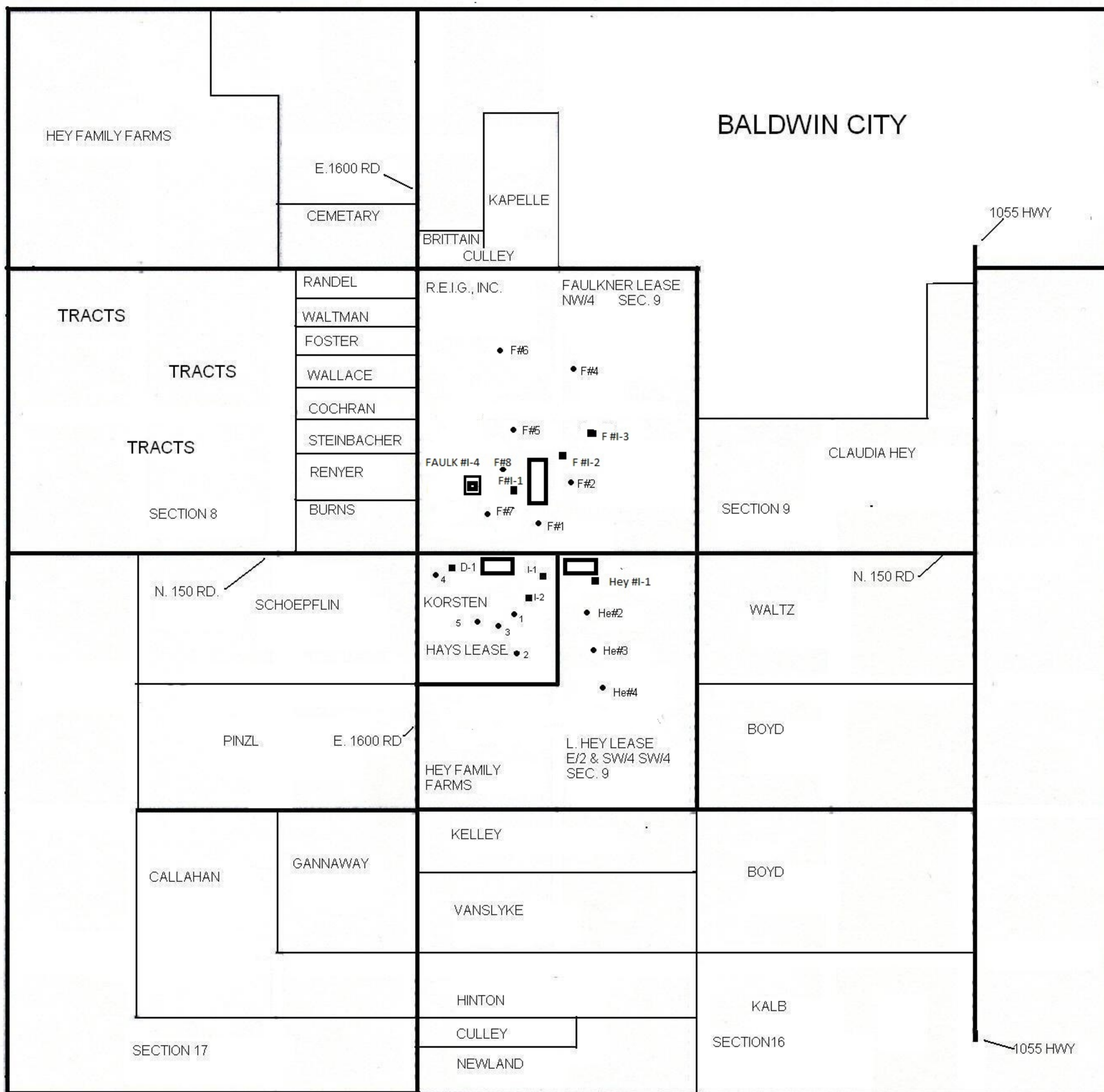

- PRODUCING WELL
- INJECTION WELL
- ◻ APPLICANT WELL
- ▭ TANKS

3/7/19

Dear Landowner.

Please be advised that Tauy Oil Inc. has proposed to drill a producing oil well Faulkner #9 within 660 feet of the fresh water well on your property.

If you wish to protest this matter please contact the Kansas Corporation Commission/Oil & Gas Conservation Division within 15 days of receiving this letter to schedule a hearing.

Sincerely,

Daniel Martin

Taui Oil, Inc
PO BOX 973
BALDWIN, KS 66006

tauyoilinc@yahoo.com

ENCL: Notice Of Intent To drill and Plat Map

ATTN:

Edward J. Steinbacher/169 E. 1600 Rd/Baldwin, KS/66006
Katherine A. Renyer/165 E. 1600 Rd/Baldwin, KS/66006
John L. Burns/159 E. 1600 Rd/Baldwin, KS/66006



Conservation Division
266 N. Main St., Ste. 220
Wichita, KS 67202-1513

Phone: 316-337-6200
Fax: 346-337-6211
<http://kcc.ks.gov/>

Dwight D. Keen, Chair
Shari Feist Albrecht, Commissioner
Jay Scott Emler, Commissioner

Laura Kelly, Governor

**NOTICE TO OPERATORS FILING INTENT TO DRILL
FOR DISPOSAL OR ENHANCED RECOVERY
INJECTION WELLS, (CLASS II INJECTION WELL)**

The attached approved Notice of Intent to Drill indicates the proposed well is to be used for injection. An approved "Intent to Drill" does not approve injection authority as a Class II Injection Well in Kansas.

Before any well is used for injection purposes, the operator must file an application for injection authority in accordance with K.A.R. 82-3-401 and provide notice in accordance with K.A.R. 82-3-402. The Conservation Division must issue a written permit granting the application before commencement of injection.

The Conservation Division requirements and restrictions associated with Class II Injection are identified in K.A.R. 82-3-400 et seq of our regulations. Associated regulations governing drilling, completion and injection applications may be found in K.A.R. 82-3-135, Table I, Table II, in the Cedar Hills Sandstone Moratorium, (Docket #156,397-C), and the Eastern Kansas Surface Casing Order, (Docket #133,891-C).

If you have questions regarding the approval of injection authority, an injection application may be filed as a "Design Approval" before actual drilling and completion of the well occurs. If you have any questions or concerns regarding Class II injection wells or regulations, call the Underground Injection Control Department at 316-337-6200.

Failure to obtain commission approval before beginning injection is punishable by a penalty, shut-in of the well or both.



Conservation Division
266 N. Main St., Ste. 220
Wichita, KS 67202-1513

Phone: 316-337-6200
Fax: 346-337-6211
<http://kcc.ks.gov/>

Dwight D. Keen, Chair
Shari Feist Albrecht, Commissioner
Jay Scott Emler, Commissioner

Laura Kelly, Governor

March 07, 2019

Daniel Martin
Tauy Oil, Inc
1621 N 150TH RD
PO BOX 973
BALDWIN CITY, KS 66006-0973

Re: Notice of Intent to Drill
FAULKNER I-4
NW/4 Sec.09-15S-20E
Douglas County, Kansas

Dear Mr. Martin:

Records indicate that a domestic water well is located less than 660 feet from this proposed location. Eastern Kansas Surface Casing Order #133,891-C for Area 3, paragraph 2 states, "No well shall be drilled closer than 660 feet of an existing domestic or municipal water well without written owner notification, a copy of which must be attached to the drilling intent form during filing. Special casing and cementing requirements may be imposed in those areas producing fresh and usable water."

Please provide us with a copy of the owner notification to further the processing of your notice of intent to drill. A copy of the water well record is attached.

I may be contacted at 316-337-6200 if you need additional information.

Rick Hestermann

WATER WELL RECORD

Form WWC-5

Division of Water Resources App. No.

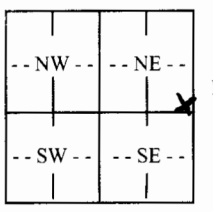
<p>1 LOCATION OF WATER WELL: County: <u>Douglas</u> Street/Rural Address of Well Location; if unknown, distance & direction from nearest town or intersection: If at owner's address, check here <input checked="" type="checkbox"/> </p>	<p>Fraction <u>SE 1/4 SE 1/4 NE 1/4</u> </p>	<p>Section Number <u>8</u> </p>	<p>Township No. T <u>15</u> S </p>	<p>Range Number R <u>20</u> <input checked="" type="checkbox"/> E <input type="checkbox"/> W </p>	
<p>2 WATER WELL OWNER: <u>Aaron Klissen</u> RR#, Street Address, Box #: <u>1594 N. 150 Rd</u> City, State, ZIP Code: <u>Baldwin City, KS, 66006</u> </p>		<p>Global Positioning System (GPS) information: Latitude: (in decimal degrees) Longitude: (in decimal degrees) Elevation: Datum: <input type="checkbox"/> WGS 84, <input type="checkbox"/> NAD 83, <input type="checkbox"/> NAD 27 Collection Method: <input type="checkbox"/> GPS unit (Make/Model:) <input type="checkbox"/> Digital Map/Photo, <input type="checkbox"/> Topographic Map, <input type="checkbox"/> Land Survey Est. Accuracy: <input type="checkbox"/> <3 m, <input type="checkbox"/> 3-5 m, <input type="checkbox"/> 5-15 m, <input type="checkbox"/> >15 m </p>			
<p>3 LOCATE WELL WITH AN "X" IN SECTION BOX: N  W E S -----1 mile----- </p>	<p>4 DEPTH OF COMPLETED WELL ft. Depth(s) Groundwater Encountered (1) <u>53.9</u> ft. (2) ft. (3) ft. WELL'S STATIC WATER LEVEL <u>46</u> ft. below land surface measured on mo/day/yr. <u>6-1-12</u> Pump test data: Well water was ft. after hours pumping gpm EST. YIELD <u>10</u> gpm, Well water was ft. after hours pumping gpm Bore Hole Diameter <u>8 3/4</u> in. to <u>10.2</u> ft., and in. to ft. WELL WATER TO BE USED AS: <input type="checkbox"/> Public water supply <input type="checkbox"/> Geothermal <input type="checkbox"/> Injection well <input checked="" type="checkbox"/> Domestic <input type="checkbox"/> Feedlot <input type="checkbox"/> Oil field water supply <input type="checkbox"/> Dewatering <input type="checkbox"/> Other (Specify below) <input type="checkbox"/> Irrigation <input type="checkbox"/> Industrial <input type="checkbox"/> Domestic-lawn & garden <input type="checkbox"/> Monitoring well Was a chemical/bacteriological sample submitted to Department? <input type="checkbox"/> Yes <input checked="" type="checkbox"/> No If yes, mo/day/yr sample was submitted..... Water well disinfected? <input checked="" type="checkbox"/> Yes <input type="checkbox"/> No </p>				
<p>5 TYPE OF CASING USED: <input type="checkbox"/> Steel <input checked="" type="checkbox"/> PVC <input type="checkbox"/> Other CASING JOINTS: <input checked="" type="checkbox"/> Glued <input type="checkbox"/> Clamped <input type="checkbox"/> Welded <input type="checkbox"/> Threaded Casing diameter <u>5</u> in. to <u>7.0</u> ft., Diameter <u>5</u> in. to <u>9.0-10.0</u> ft., Diameter in. to ft. Casing height above land surface <u>30</u> in., Weight <u>5.226</u> lbs./ft., Wall thickness or gauge No. <u>160.851</u> TYPE OF SCREEN OR PERFORATION MATERIAL: <input type="checkbox"/> Steel <input type="checkbox"/> Stainless Steel <input checked="" type="checkbox"/> PVC <input type="checkbox"/> Other (Specify) <input type="checkbox"/> Brass <input type="checkbox"/> Galvanized Steel <input type="checkbox"/> None used (open hole) SCREEN OR PERFORATION OPENINGS ARE: <input type="checkbox"/> Continuous slot <input type="checkbox"/> Mill slot <input type="checkbox"/> Gauze wrapped <input type="checkbox"/> Torch cut <input type="checkbox"/> Drilled holes <input type="checkbox"/> None (open hole) <input type="checkbox"/> Louvered shutter <input type="checkbox"/> Key punched <input type="checkbox"/> Wire wrapped <input checked="" type="checkbox"/> Saw cut <input type="checkbox"/> Other (specify) SCREEN-PERFORATED INTERVALS: From <u>7.0</u> ft. to <u>9.0</u> ft., From ft. to ft. From ft. to ft., From ft. to ft. GRAVEL PACK INTERVALS: From ft. to ft., From ft. to ft. From ft. to ft., From ft. to ft. </p>					
<p>6 GROUT MATERIAL: <input type="checkbox"/> Neat cement <input type="checkbox"/> Cement grout <input checked="" type="checkbox"/> Bentonite <input type="checkbox"/> Other Grout Intervals: From <u>46</u> ft. to <u>3</u> ft., From ft. to ft., From ft. to ft. What is the nearest source of possible contamination: <input checked="" type="checkbox"/> Septic tank <input checked="" type="checkbox"/> Lateral lines <input type="checkbox"/> Pit privy <input type="checkbox"/> Livestock pens <input type="checkbox"/> Insecticide storage <input type="checkbox"/> Other (specify below) <input type="checkbox"/> Sewer lines <input type="checkbox"/> Cesspool <input type="checkbox"/> Sewage lagoon <input type="checkbox"/> Fuel storage <input type="checkbox"/> Abandoned water well <input type="checkbox"/> Watertight sewer lines <input type="checkbox"/> Seepage pit <input type="checkbox"/> Feedyard <input type="checkbox"/> Fertilizer storage <input type="checkbox"/> Oil well/gas well Direction from well <u>W</u> Distance from well <u>100</u> </p>					
FROM	TO	LITHOLOGIC LOG	FROM	TO	LITHO. LOG (cont.) or PLUGGING INTERVALS
0	4	soil + Clay			
4	32	Sandstone			
32	34	Sandy shale			
34	36	Sandstone			
36	53	Sandy shale			
53	82	White Sandstone			
82	92	Limey Sandstone			
92	100	Shale			
<p>7 CONTRACTOR'S OR LANDOWNER'S CERTIFICATION: This water well was <input checked="" type="checkbox"/> constructed, <input type="checkbox"/> reconstructed, or <input type="checkbox"/> plugged under my jurisdiction and was completed on (mo/day/year) <u>6-1-12</u> and this record is true to the best of my knowledge and belief. Kansas Water Well Contractor's License No. <u>56.1</u> This Water Well Record was completed on (mo/day/year) <u>6-5-12</u> under the business name of <u>EMART Energy, Inc.</u> by (signature) <u>[Signature]</u> </p>					
<p>INSTRUCTIONS: Use typewriter or ball point pen. <u>PLEASE PRESS FIRMLY</u> and <u>PRINT</u> clearly. Please fill in blanks and check the correct answers. Send three copies (white, blue, pink) to Kansas Department of Health and Environment, Bureau of Water, Geology Section, 1000 SW Jackson St., Suite 420, Topeka, Kansas 66612-1367. Telephone 785-296-5524. Send one copy to WATER WELL OWNER and retain one for your records. Include fee of \$5.00 for each constructed well. Visit us at http://www.kdheks.gov/waterwell/index.html.</p>					

March 25, 2019

Daniel Martin
Tauy Oil, Inc
1621 N 150TH RD
PO BOX 973
BALDWIN CITY, KS 66006-0973

Re: Drilling Pit Application
FAULKNER I-4
NW/4 Sec.09-15S-20E
Douglas County, Kansas

Dear Daniel Martin:

District staff has inspected the above referenced location and has determined that the reserve pit shall be constructed **without slots**, the bottom shall be flat and reasonably level, and the free fluids must be removed. The fluids are to be removed from the reserve pit as soon as practical after drilling operations have ceased.

If production casing is set all completion fluids shall be removed from the working pits daily. NO completion fluids or non-exempt wastes shall be placed in the reserve pit.

The fluids should be taken to an authorized disposal well. Please call the District Office at (620) 902-6450 when the fluids have been removed. Please file form CDP-5 (August 2008), Exploration and Production Waste Transfer, through KOLAR within 30 days of fluid removal.

A copy of this letter should be posted in the doghouse along with the approved Intent to Drill. If you have any questions or concerns please feel free to contact the District Office at (620) 902-6450.



Conservation Division
266 N. Main St., Ste. 220
Wichita, KS 67202-1513

Phone: 316-337-6200
Fax: 346-337-6211
<http://kcc.ks.gov/>

Dwight D. Keen, Chair
Shari Feist Albrecht, Commissioner
Jay Scott Emler, Commissioner

Laura Kelly, Governor

March 25, 2019

R.E.I.G, Inc./CO Diane Dietz
PO Box 4
Baldwin City, KS 66006-7118

RE: Kansas Surface Owners Notice Act
Form C-1, Faulkner #9, 10, & I-4
API # 15-045-22296-00-00
15-045-22297-00-00
15-045-22298-00-00

The 2009 Legislature passed House Bill 2032, known as the Kansas Surface Owners Notice Act. This Act requires the KCC to provide copies of drilling intents, operator transfers, and well plugging applications to the surface owner, if they are not provided by the lease operator. The operator has advised us they have not provided you with a copy of the attached form. Therefore, this letter and the attached form shall serve as notice of the operator's action. You do not need to respond to the KCC. Please contact the operator listed on the form if you have any questions.

cc: Tauy Oil, Inc.