



For KCC Use ONLY

API # 15 - \_\_\_\_\_

**IN ALL CASES PLOT THE INTENDED WELL ON THE PLAT BELOW**

In all cases, please fully complete this side of the form. Include items 1 through 5 at the bottom of this page.

Operator: \_\_\_\_\_

Lease: \_\_\_\_\_

Well Number: \_\_\_\_\_

Field: \_\_\_\_\_

Number of Acres attributable to well: \_\_\_\_\_

QTR/QTR/QTR/QTR of acreage: \_\_\_\_\_ - \_\_\_\_\_ - \_\_\_\_\_ - \_\_\_\_\_

Location of Well: County: \_\_\_\_\_

\_\_\_\_\_ feet from ☐ N / ☐ S Line of Section\_\_\_\_\_ feet from ☐ E / ☐ W Line of SectionSec. \_\_\_\_\_ Twp. \_\_\_\_\_ S. R. \_\_\_\_\_ ☐ E ☐ WIs Section: ☐ Regular or ☐ Irregular**If Section is Irregular, locate well from nearest corner boundary.**Section corner used: ☐ NE ☐ NW ☐ SE ☐ SW**PLAT**

Show location of the well. Show footage to the nearest lease or unit boundary line. Show the predicted locations of lease roads, tank batteries, pipelines and electrical lines, as required by the Kansas Surface Owner Notice Act (House Bill 2032).  
You may attach a separate plat if desired.

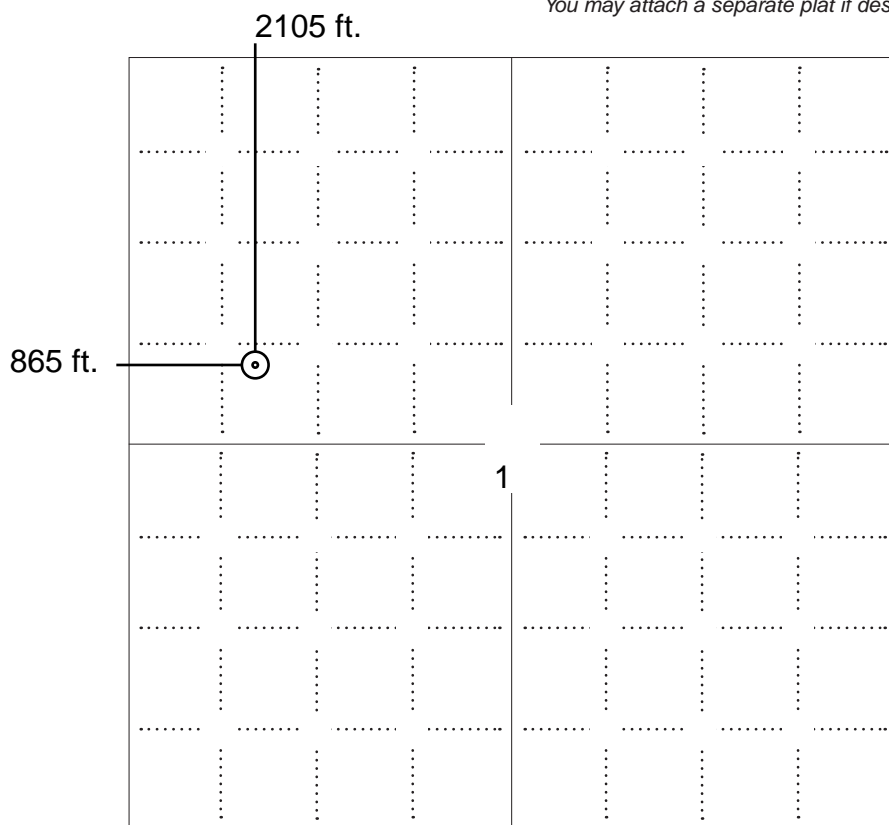
**LEGEND**

- ☐ Well Location
- ☐ Tank Battery Location
- ☐ Pipeline Location
- ☐ Electric Line Location
- ☐ Lease Road Location

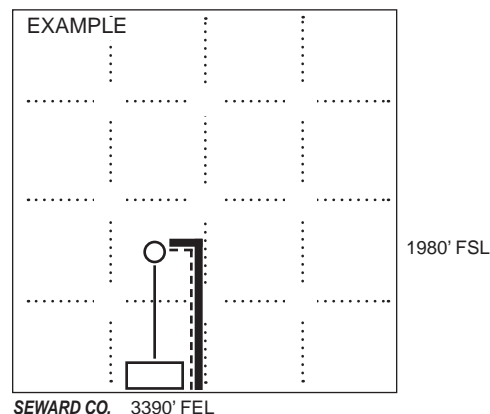
**NOTE: In all cases locate the spot of the proposed drilling locaton.****In plotting the proposed location of the well, you must show:**

1. The manner in which you are using the depicted plat by identifying section lines, i.e. 1 section, 1 section with 8 surrounding sections, 4 sections, etc.
2. The distance of the proposed drilling location from the south / north and east / west outside section lines.
3. The distance to the nearest lease or unit boundary line (in footage).
4. If proposed location is located within a prorated or spaced field a certificate of acreage attribution plat must be attached: (C0-7 for oil wells; CG-8 for gas wells).
5. The predicted locations of lease roads, tank batteries, pipelines, and electrical lines.

**KANSAS CORPORATION COMMISSION  
OIL & GAS CONSERVATION DIVISION  
APPLICATION FOR SURFACE PIT**

Form CDP-1  
May 2010  
Form must be Typed

*Submit in Duplicate*

Operator Name: _____		License Number: _____	
Operator Address: _____			
Contact Person: _____		Phone Number: _____	
Lease Name & Well No.: _____		Pit Location (QQQQ): _____-_____-_____-_____ Sec. _____ Twp. _____ R. _____ <input type="checkbox"/> East <input type="checkbox"/> West _____-_____-Feet from <input type="checkbox"/> North / <input type="checkbox"/> South Line of Section _____-_____-Feet from <input type="checkbox"/> East / <input type="checkbox"/> West Line of Section _____-_____-County	
Type of Pit: <input type="checkbox"/> Emergency Pit <input type="checkbox"/> Burn Pit <input type="checkbox"/> Settling Pit <input type="checkbox"/> Drilling Pit <input type="checkbox"/> Workover Pit <input type="checkbox"/> Haul-Off Pit <i>(If WP Supply API No. or Year Drilled)</i>	Pit is: <input type="checkbox"/> Proposed <input type="checkbox"/> Existing If Existing, date constructed: _____ Pit capacity: _____ (bbls)		
Is the pit located in a Sensitive Ground Water Area? <input type="checkbox"/> Yes <input type="checkbox"/> No		Chloride concentration: _____ mg/l <i>(For Emergency Pits and Settling Pits only)</i>	
Is the bottom below ground level? <input type="checkbox"/> Yes <input type="checkbox"/> No	Artificial Liner? <input type="checkbox"/> Yes <input type="checkbox"/> No	How is the pit lined if a plastic liner is not used?	
Pit dimensions (all but working pits): _____ Length (feet) _____ Width (feet) <input type="checkbox"/> N/A: Steel Pits Depth from ground level to deepest point: _____ (feet) <input type="checkbox"/> No Pit			
If the pit is lined give a brief description of the liner material, thickness and installation procedure.		Describe procedures for periodic maintenance and determining liner integrity, including any special monitoring.	
Distance to nearest water well within one-mile of pit: _____ feet    Depth of water well _____ feet		Depth to shallowest fresh water _____ feet. Source of information: <input type="checkbox"/> measured <input type="checkbox"/> well owner <input type="checkbox"/> electric log <input type="checkbox"/> KDWR	
<b>Emergency, Settling and Burn Pits ONLY:</b>  Producing Formation: _____ Number of producing wells on lease: _____ Barrels of fluid produced daily: _____  Does the slope from the tank battery allow all spilled fluids to flow into the pit? <input type="checkbox"/> Yes <input type="checkbox"/> No		<b>Drilling, Workover and Haul-Off Pits ONLY:</b>  Type of material utilized in drilling/workover: _____ Number of working pits to be utilized: _____ Abandonment procedure: _____  Drill pits must be closed within 365 days of spud date.	
Submitted Electronically			

**KCC OFFICE USE ONLY**

☐ Liner    ☐ Steel Pit    ☐ RFAC    ☐ RFAS

Date Received: \_\_\_\_\_ Permit Number: \_\_\_\_\_ Permit Date: \_\_\_\_\_ Lease Inspection: ☐ Yes ☐ No

KANSAS CORPORATION COMMISSION  
OIL & GAS CONSERVATION DIVISION

Form KSONA-1  
January 2014  
**Form Must Be Typed**  
**Form must be Signed**  
**All blanks must be Filled**

**CERTIFICATION OF COMPLIANCE WITH THE  
KANSAS SURFACE OWNER NOTIFICATION ACT**

*This form must be submitted with all Forms C-1 (Notice of Intent to Drill); CB-1 (Cathodic Protection Borehole Intent); T-1 (Request for Change of Operator Transfer of Injection or Surface Pit Permit); and CP-1 (Well Plugging Application). Any such form submitted without an accompanying Form KSONA-1 will be returned.*

Select the corresponding form being filed: ☐ **C-1** (Intent) ☐ **CB-1** (Cathodic Protection Borehole Intent) ☐ **T-1** (Transfer) ☐ **CP-1** (Plugging Application)

OPERATOR: License # \_\_\_\_\_

Name: \_\_\_\_\_

Address 1: \_\_\_\_\_

Address 2: \_\_\_\_\_

City: \_\_\_\_\_ State: \_\_\_\_\_ Zip: \_\_\_\_\_ + \_\_\_\_\_

Contact Person: \_\_\_\_\_

Phone: ( \_\_\_\_\_ ) \_\_\_\_\_ Fax: ( \_\_\_\_\_ ) \_\_\_\_\_

Email Address: \_\_\_\_\_

Well Location:

\_\_\_\_ - \_\_\_\_ - \_\_\_\_ Sec. \_\_\_\_ Twp. \_\_\_\_ S. R. \_\_\_\_ ☐ East ☐ West

County: \_\_\_\_\_

Lease Name: \_\_\_\_\_ Well #: \_\_\_\_\_

*If filing a Form T-1 for multiple wells on a lease, enter the legal description of the lease below:*

**Surface Owner Information:**

Name: \_\_\_\_\_

Address 1: \_\_\_\_\_

Address 2: \_\_\_\_\_

City: \_\_\_\_\_ State: \_\_\_\_\_ Zip: \_\_\_\_\_ + \_\_\_\_\_

*When filing a Form T-1 involving multiple surface owners, attach an additional sheet listing all of the information to the left for each surface owner. Surface owner information can be found in the records of the register of deeds for the county, and in the real estate property tax records of the county treasurer.*

*If this form is being submitted with a Form C-1 (Intent) or CB-1 (Cathodic Protection Borehole Intent), you must supply the surface owners and the KCC with a plat showing the predicted locations of lease roads, tank batteries, pipelines, and electrical lines. The locations shown on the plat are preliminary non-binding estimates. The locations may be entered on the Form C-1 plat, Form CB-1 plat, or a separate plat may be submitted.*

**Select one of the following:**

- ☐ I certify that, pursuant to the Kansas Surface Owner Notice Act (House Bill 2032), I have provided the following to the surface owner(s) of the land upon which the subject well is or will be located: 1) a copy of the Form C-1, Form CB-1, Form T-1, or Form CP-1 that I am filing in connection with this form; 2) if the form being filed is a Form C-1 or Form CB-1, the plat(s) required by this form; and 3) my operator name, address, phone number, fax, and email address.
- ☐ I have not provided this information to the surface owner(s). I acknowledge that, because I have not provided this information, the KCC will be required to send this information to the surface owner(s). To mitigate the additional cost of the KCC performing this task, I acknowledge that I must provide the name and address of the surface owner by filling out the top section of this form and that I am being charged a \$30.00 handling fee, payable to the KCC, which is enclosed with this form.

*If choosing the second option, submit payment of the \$30.00 handling fee with this form. If the fee is not received with this form, the KSONA-1 form and the associated Form C-1, Form CB-1, Form T-1, or Form CP-1 will be returned.*

I Submitted Electronically

I





# CHARTER ENERGY, INC.

P.O. BOX 252  
GREAT BEND, KS 67530  
(316) 793-9090

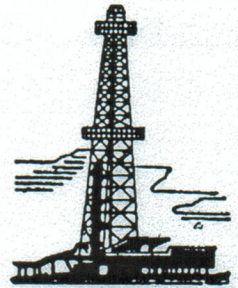

Township 21 Range 14 County Stafford State KS

0'	330'	660'	990'	1320'	1650'	1980'	2310'	2640'	2970'	3300'	3630'	3960'	4290'	4620'	4950'	5280'
330'	Nw Nw Nw Ne Nw Nw				Nw Ne Nw Ne Ne Nw				Nw Nw Ne Ne Nw Ne				Nw Ne Ne Ne Ne Ne			
660'	C Nw Nw				C Ne Nw				C Nw Ne				C Ne Ne			
990'	Sw Nw Nw Se Nw Nw				Sw Ne Nw Se Ne Nw				Sw Nw Ne Se Nw Ne				Sw Ne Ne Se Ne Ne			
1320'	NW				NE											
1650'	Nw Sw Nw Ne Sw Nw				Nw Se Nw Ne Se Nw				Nw Sw Ne Ne Sw Ne				Nw Se Ne Ne Se Ne			
1980'	Proposed Lease Road				C Se Nw				C Sw Ne				C Se Ne			
2310'	C Sw Nw				Morrison Trust #1											
2640'	Sw Sw Nw Se Sw Nw				Sw Se Nw Se Se Nw				Sw Sw Ne Se Sw Ne				Sw Se Ne Se Se Ne			
2970'	Proposed Tank Battery															
3300'	Nw Nw Sw Ne Nw Sw				Nw Ne Sw Ne Ne Sw				Nw Nw Se Ne Nw Se				Nw Ne Se Ne Ne Se			
3630'	C Nw Sw				C Ne Sw				C Nw Se				C Ne Se			
3960'	Sw Nw Sw Se Nw Sw				Sw Ne Sw Se Ne Sw				Sw Nw Se Se Nw Se				Sw Ne Se Se Ne Se			
4290'	SW				SE											
4620'	Nw Sw Sw Ne Sw Sw				Nw Se Sw Ne Se Sw				Nw Sw Se Ne Sw Se				Nw Se Se Ne Se Se			
4950'	C Sw Sw				C Se Sw				C Sw Se				C Se Se			
5280'	Sw Sw Sw Se Sw Sw				Sw Se Sw Se Se Sw				Sw Sw Se Se Sw Se				Sw Se Se Se Se Se			
5280'	4950'	4620'	4290'	3960'	3630'	3300'	2970'	2640'	2310'	1980'	1650'	1320'	990'	660'	330'	



KANSAS CORPORATION COMMISSION  
OIL & GAS CONSERVATION DIVISION  
**APPLICATION FOR SURFACE PIT**

Form CDP-1  
May 2010  
Form must be Typed

Submit in Duplicate

Operator Name: Charter Energy, Inc.		License Number: 9090	
Operator Address: Box 252		GREAT BEND KS 67530	
Contact Person: Steve Baize		Phone Number: 6207939090	
Lease Name & Well No.: Morrison Trust 1		Pit Location (QQQQ): SW - SW - SW - NW Sec. 1 Twp. 21 R. 14 <input type="checkbox"/> East <input checked="" type="checkbox"/> West 2540 Feet from <input checked="" type="checkbox"/> North / <input type="checkbox"/> South Line of Section 100 Feet from <input type="checkbox"/> East / <input checked="" type="checkbox"/> West Line of Section Stafford County	
Type of Pit: <input type="checkbox"/> Emergency Pit <input type="checkbox"/> Burn Pit <input type="checkbox"/> Settling Pit <input type="checkbox"/> Drilling Pit <input type="checkbox"/> Workover Pit <input checked="" type="checkbox"/> Haul-Off Pit (If WP Supply API No. or Year Drilled)	Pit is: <input checked="" type="checkbox"/> Proposed <input type="checkbox"/> Existing If Existing, date constructed: Pit capacity: 3491 (bbls)		
Is the pit located in a Sensitive Ground Water Area? <input checked="" type="checkbox"/> Yes <input type="checkbox"/> No		Chloride concentration: mg/l (For Emergency Pits and Settling Pits only)	
Is the bottom below ground level? <input checked="" type="checkbox"/> Yes <input type="checkbox"/> No		Artificial Liner? <input type="checkbox"/> Yes <input checked="" type="checkbox"/> No How is the pit lined if a plastic liner is not used? Bentonite	
Pit dimensions (all but working pits): 70 Length (feet) 70 Width (feet) <input type="checkbox"/> N/A: Steel Pits Depth from ground level to deepest point: 4 (feet) <input type="checkbox"/> No Pit			
If the pit is lined give a brief description of the liner material, thickness and installation procedure.		Describe procedures for periodic maintenance and determining liner integrity, including any special monitoring.	
Distance to nearest water well within one-mile of pit: 435 feet Depth of water well 60 feet		Depth to shallowest fresh water 21 feet. Source of information: <input type="checkbox"/> measured <input type="checkbox"/> well owner <input type="checkbox"/> electric log <input checked="" type="checkbox"/> KDWR	
<b>Emergency, Settling and Burn Pits ONLY:</b> Producing Formation: Number of producing wells on lease: Barrels of fluid produced daily: Does the slope from the tank battery allow all spilled fluids to flow into the pit? <input type="checkbox"/> Yes <input type="checkbox"/> No		<b>Drilling, Workover and Haul-Off Pits ONLY:</b> Type of material utilized in drilling/workover: Fresh Drilling Mud Number of working pits to be utilized: 4 Abandonment procedure: Will allow to air dry and backfill Drill pits must be closed within 365 days of spud date.	
I hereby certify that the above statements are true and correct to the best of my knowledge and belief.  Date Signature of Applicant or Agent			

KCC OFFICE USE ONLY

☐ Liner ☐ Steel Pit ☐ RFAC ☐ RFAS

Date Received: 04/05/2019 Permit Number: Permit Date: Lease Inspection: ☐ Yes ☒ No



# Kansas Corporation Commission Oil & Gas Conservation Division

## HAUL-OFF PIT APPLICATION FILING REQUIREMENTS

### 82-3-607. DISPOSAL OF DIKE AND PIT CONTENTS.

- (a) Each operator shall perform one of the following when disposing of dike or pit contents:
- (1) Remove the liquid contents to a disposal well or other oil and gas operation approved by the commission or to road maintenance or construction locations approved by the department;
  - (2) dispose of reserve pit waste down the annular space of a well completed according to the alternate I requirements of K.A.R. 82-3-106, if the waste to be disposed of was generated during the drilling and completion of the well; or
  - (3) dispose of the remaining solid contents in any manner required by the commission. The requirements may include any of the following:
    - (A) Burial in place, in accordance with the grading and restoration requirements in K.A.R. 82-3-602 (f);
    - (B) removal and placement of the contents in an on-site disposal area approved by the commission;
    - (C) removal and placement of the contents in an off-site disposal area on acreage owned by the same landowner or to another producing lease or unit operated by the same operator, if prior written permission from the landowner has been obtained; or
    - (D) removal of the contents to a permitted off-site disposal area approved by the department.
- (b) Each violation of this regulation shall be punishable by the following:
- (1) A \$1,000 penalty for the first violation;
  - (2) a \$2,500 penalty for the second violation; and
  - (3) a \$5,000 penalty and an operator license review for the third violation.

### **Complete and return with Haul-Off Pit Application, Form CDP1(2004)**

Haul-off pit will be located in an on-site disposal area: ☒ Yes ☐ No

Haul-off pit is located in an off-site disposal area on acreage owned by the same landowner:

☐ Yes ☐ No If yes, written permission from the land owner must be obtained. Attach written permission to haul-off pit application.

Haul-off pit is located in an off-site disposal area on another **producing** lease or unit operated by the same operator: ☐ Yes ☐ No If yes, written permission from the land owner must be obtained. Attach permission and a copy of the lease assignment that covers the acreage where the haul-off pit is to be located, to the haul-off pit application.

#### CONSERVATION DIVISION

Finney State Office Building, 130 S. Market, Room 2078, Wichita, KS 67202-3802  
(316) 337-6200 • Fax: (316) 337-6211 • <http://kcc.ks.gov/>

Dwight D. Keen, Chair  
Shari Feist Albrecht, Commissioner  
Jay Scott Emler, Commissioner

Laura Kelly, Governor

April 09, 2019

Steve Baize  
Charter Energy, Inc.  
PO BOX 252  
GREAT BEND, KS 67530-0252

Re: Drilling Pit Application  
Morrison Trust 1  
NW/4 Sec.01-21S-14W  
Stafford County, Kansas

Dear Steve Baize:

District staff has inspected the above referenced location and has determined that an unsealed condition will present a pollution threat to water resources.

District staff has recommended that the reserve pit be lined with bentonite or native clay, constructed **without slots**, the bottom shall be flat and reasonably level and the free fluids must be removed. The fluids are to be removed from the reserve pit as soon as the Hutchinson Salt section has been drilled through and displacement of the fluids into the reserve pit has occurred. The fluids should be removed again within 72 hours after drilling operations have ceased.

**If production casing is set all completion fluids shall be removed from the working pits daily. NO completion fluids or non-exempt wastes shall be placed in the reserve pit.**

The fluids should be taken to an authorized disposal well. Please call the District Office at (620) 682-7933 when the fluids have been removed. Please file form CDP-5 (August 2008), Exploration and Production Waste Transfer, through KOLAR within 30 days of fluid removal.

**A copy of this letter should be posted in the doghouse along with the approved Intent to Drill.** If you have any questions or concerns please feel free to contact the District Office at (620) 682-7933.