

Mull Drilling Company, Inc.
Proposed Location of Roads, Lines and Tank Battery

Well Name:	Schmitt #1-10
Well Location:	602' FNL & 2151' FWL
	Section 10-T17S-R32W
	Scott County, KS

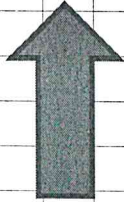

North

NW/4 Section 10-T17S-R32W

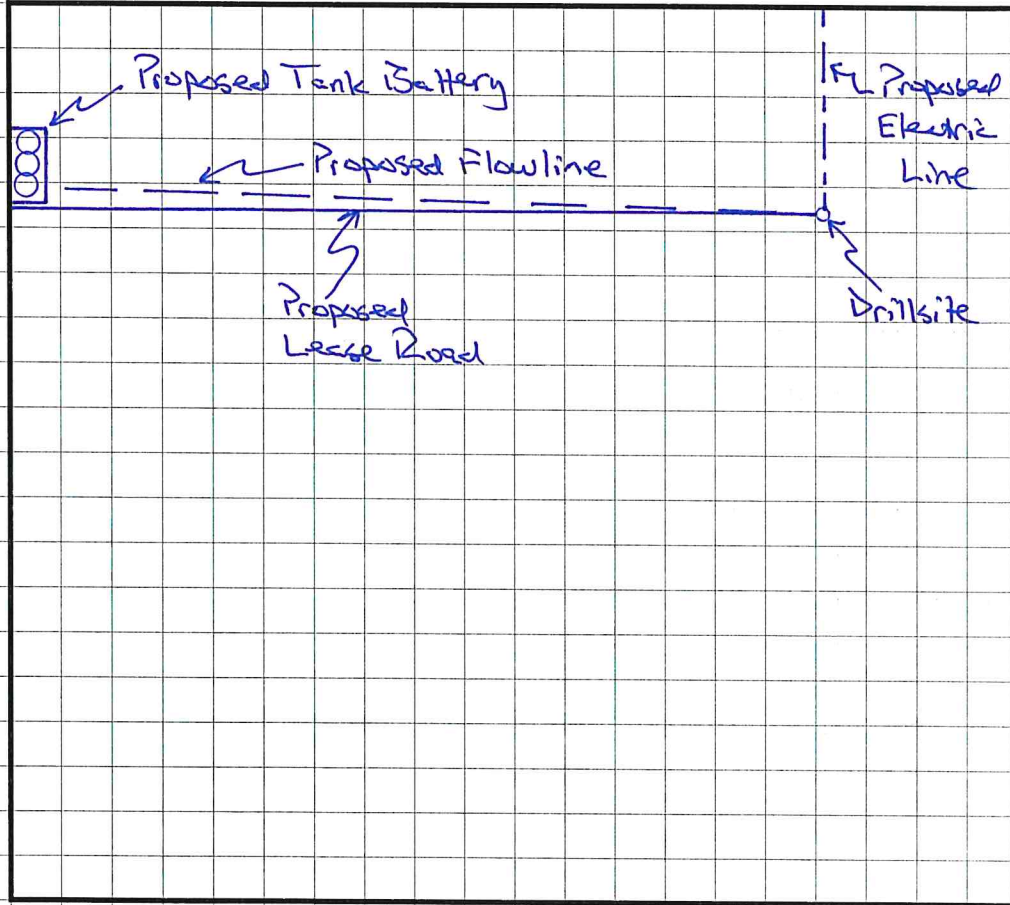

Scale



660'



00-17s-32w-999
CRD NO.

00-17s-32w
DMT NO.

PRO-STAKE

Construction Site Staking

LLC

14193

INVOICE NO.



Mull Drilling Company, Inc.

OPERATOR

Scott County, KS

COUNTY

Schmitt #1-10

LEASE NAME

602' FNL - 2151' FWL

LOCATION SPOT

2988.5'

GR ELEVATION

38.597366387

NAD 83 LAT

100.844892810

NAD 83 LONG

10 **17s** **32w**
Sec. **Twp.** **Rng.**

SCALE: 1" = 1000'
DATE STAKED: March 28th, 2019
MEASURED BY: Pierce R.
DRAWN BY: Pierce R.
AUTHORIZED BY: Tannis T.
DATE REVISED:

P.O. Box 2324 Garden City, Kansas 67846
Office/Fax: (620) 276-6159 – Cell: (620) 272-1499
burt@prostakellc.com

LEGEND

- ⊕ irr. well
- ⊕ water hydrant
- ⊕ tank battery
- ⊕ staked loc.
- ⊕ prod. well/aband. well
- house
- building
- G- gas line
- W- water line
- E- transmission powerline
- 3 phase powerline
- * * single phase powerline
- x-x-x- fence
- gravel / sand rd.
- gravel trail / lease rd.
- dirt rd.
- dirt trail / lease rd.
- Hwy / blacktop rd.



DIRECTIONS: From Scott City, KS at the intersection of Hwy. 83 & Hwy. 96 – Now go 8 miles North on Hwy. 83 – Now go 3 miles East on Hwy. 4 to the NW corner of section 10-17s-32w – Now go approx. 0.1 mile South on Omaha Rd. to ingress stake East into – Now go approx. 0.4 miles East through wheat with corn stubble into staked location

Final ingress must be verified with landowner or operator.
This drawing does not constitute a monumented survey or a land survey plat.
This drawing is for construction purposes only.

LANDOWNER/CONTACT: Joyce M. Schmitt: 620-872-3896

