

26-16s-34w-L-999
CRD NO.

00-16s-34w
DMT NO.

PRO-STAKE

LLC

Construction Site Staking

14192

INVOICE NO.



Shakespeare Oil Company, Inc.

OPERATOR

Scott County, KS

COUNTY

Nichols #3-15

LEASE NAME

15 16s 34w
Sec. Twp. Rng.

MAIN: 1350' FSL - 460' FEL

ALT: 1351' FSL - 392' FEL

LOCATION SPOT

MAIN: 3119.7'

ALT: 3119.7'

GR ELEVATION

MAIN: 38.659751857

ALT: 38.659754802

NAD 83 LAT

MAIN: 101.056577787

ALT: 101.056338627

NAD 83 LONG

SCALE: 1" = 1000'
DATE STAKED: March 27th, 2019
MEASURED BY: Pierce R.
DRAWN BY: Pierce R.
AUTHORIZED BY: Alex B.
DATE REVISED:



LEGEND

- ⊙ irr. well
- ⊕ water hydrant
- ⬢ tank battery
- ⊙ staked loc.
- ⊙ prod. well/aband. well
- house
- building
- G— gas line
- W— water line
- E— transmission powerline
- 3 phase powerline
- single phase powerline
- x—x— fence
- ▬▬▬▬ gravel / sand rd.
- ▬▬▬▬ gravel trail / lease rd.
- ▬▬▬▬ dirt rd.
- ▬▬▬▬ dirt trail / lease rd.
- ▬▬▬▬ Hwy / blacktop rd.

DIRECTIONS: From Pence, KS at the intersection of 270 Rd. & Cherokee Rd. – Now go 1 mile East on 270 Rd. to ingress stake North into at the SE corner of section 15-16s-34w – Now go approx. 0.25 miles North to ingress stake West into – Now go approx. 460' West through irrigated corn stubble into staked location

Final ingress must be verified with landowner or operator.

This drawing does not constitute a monumented survey or a land survey plat. This drawing is for construction purposes only.

LANDOWNER/CONTACT: N/A

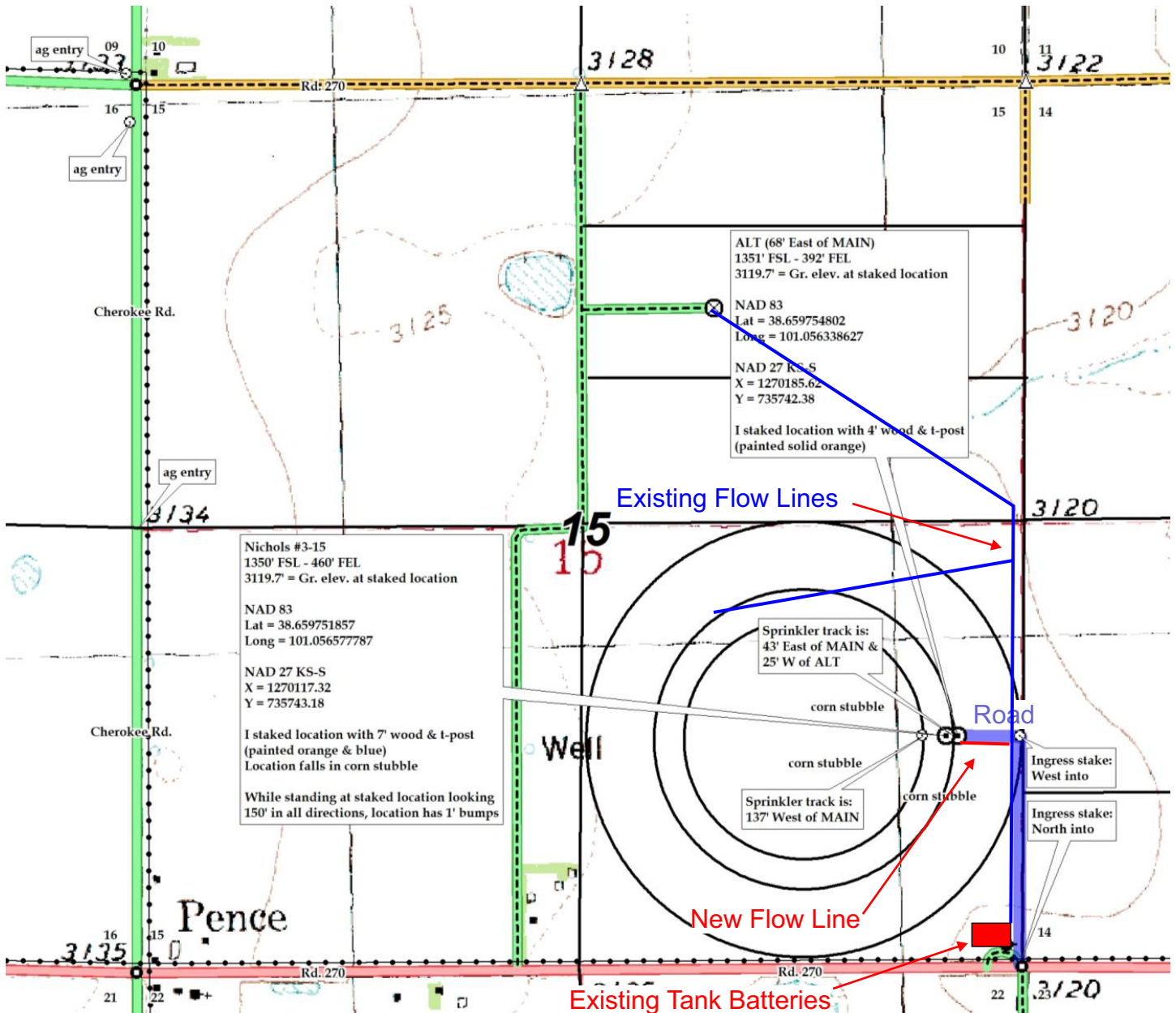

Preliminary Non-binding estimate of Lease Road, Flowline and Tanks